

Drawing name: A:\PROJECTS\123020 Denbora Bay III\Drawings\3020_DISP.dwg L 1.01 Mar 18, 2024 8:53pm by: ardu

N51°03'E(M&C)
140.00'(R&M)

S51°39'21"E
140.00'(R&M)

S50°00'42"W(M&C)
140.00'(R&M)

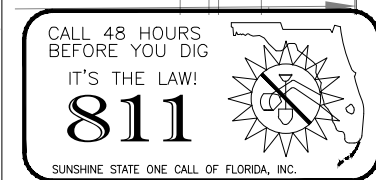

PROJECT
DENBORA BAY III

ADDRESS
**2125 BAY DRIVE
MIAMI BEACH, FLORIDA 33141**

DRAWING
TREE DISPOSITION

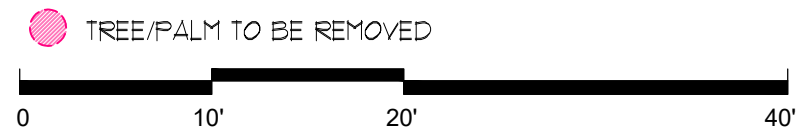

SHEET NO.
L 1.01

DATE
OCT 16, 2023

REVISIONS
#1 24/03/20

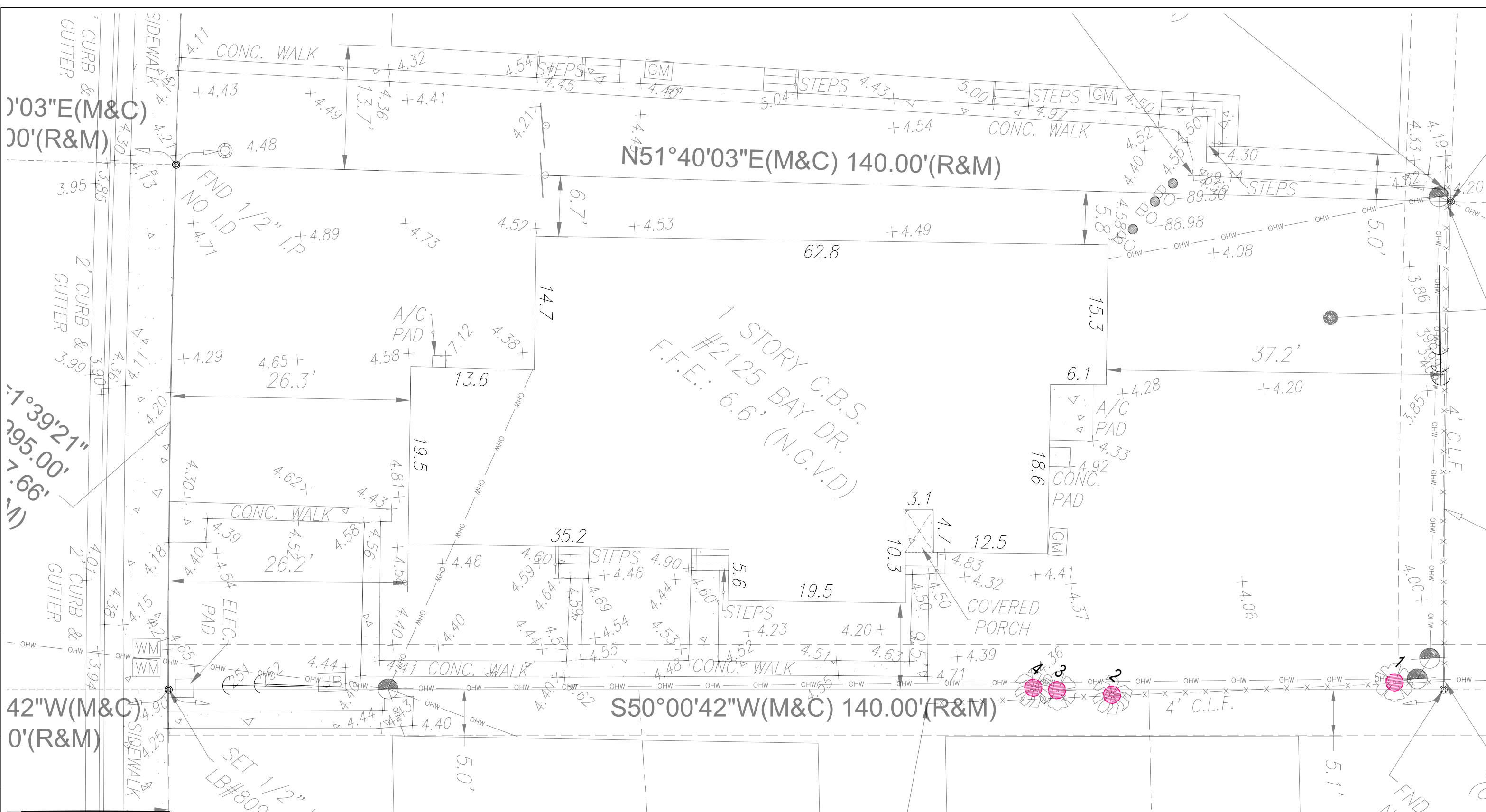

TREE DISPOSITION TABLE

| NO. | BOTANICAL NAME | COMMON NAME | DISPOSITION | CONDITION/ REMARKS | DBH (in) | HEIGHT(ft) | SPREAD.ft) | REMOVAL/MITIGATION | |
|-----|-------------------------|-------------------|-------------|-----------------------|----------|------------|------------|--------------------|-----|
| | | | | | | | | PALM (1:1) | DBH |
| 1 | SCHINUS TEREBINTHIFOLIA | BRAZILLIAN PEPPER | REMOVE | INVASIVE | 14 | 30 | 25 | | 14 |
| 2 | PTYCHOSPERMA ELEGANS | SOLITAIRE PALM | REMOVE | FAIR | 4 | 30 | 5 | 1 | |
| 3 | SCHEFFLERA ACTINOPHYLLA | UMBRELLA TREE | REMOVE | INVASIVE | 10 | 25 | 20 | | 10 |
| 2 | VEITCHIA PALM | MONTGOMERY PALM | REMOVE | FAIR | 4 | 10 | 3 | 1 | |

| | REMAIN | REMOVE | TOTAL TREES | TOTAL PALMS |
|---|--------|--------|-------------|-------------|
| TREES | 0 | 2 | 2 | |
| PALMS | 0 | 2 | | 2 |
| TOTAL PALMS TO BE REMOVED | | 2 | | |
| TOTAL TREES TO BE REMOVED IN DBH | | 24 | | |
| ESTIMATED REQUIREMENTS (2" CAL./12'HT MIN. BY CODE) | | | | |
| ESTIMATED REQUIREMENTS 3" CALIPER TREES | | 8 | | |
| TOTAL PROPOSED 3" CALIPER REPLACEMENT TREES | | 8 | | |
| TOTAL PROPOSED REPLACEMENT PALMS | | 2 | | |

TREE DISPOSITION NOTES

1. TREE DISPOSITION PLAN IS BASED ON ALL AVAILABLE INFORMATION. CONTRACTOR TO REPORT ALL DISCREPANCIES TO LANDSCAPE ARCHITECT FOR REVIEW PRIOR TO CONSTRUCTION/DEMOLITION.
2. ALL PITS TO BE FILLED THE SAME DAY OF REMOVAL OF TREES AND/OR PALMS. RESTORE SURFACE WITH SOD OR MULCH TO MATCH EXISTING CONDITIONS.
3. CONTRACTOR SHALL VERIFY ALL EXISTING ABOVE AND UNDERGROUND UTILITIES 48 HOURS PRIOR TO ANY ON-SITE EXCAVATION.
4. TREE SURVEY DATED 09/09/2023, PROVIDED BY: J. HERNANDEZ & ASSOCIATES INC.

3300 NW 112TH AVE, SUITE 10

DORAL, FL 33172

PHONE: 305 526 0606

PROJECT

DENBORA BAY III

2125 BAY DRIVE
MIAMI BEACH, FLORIDA 33141

DRAWING

TREE DISPOSITION SCHEDULE

SHEET NO.

L 1.02

DATE
OCT 16, 2023

REVISIONS
#1 24/03/20



DULAND
DESIGN
land planners
landscape architects



LA 6666948

Drawing name: A:\PROJECTS\123020 Denbora Bay III\drawings\3020_DISP.dwg L 1.02 Mar 18, 2024 8:53pm by: ardu

Drawing name: A:\PROJECTS\123020 Denbora Bay III\drawings\3020_PLINT.dwg L 2.01 Apr 05, 2024 3:18pm by: arodu

BAY DRIVE - 60' R.O.W.

SIDEWALK

PROPERTY LINE

PROPERTY LINE

PROPOSED BUILDING

PROPERTY LINE

PROPOSED PALM

PROPOSED TREE

PROPOSED SMALL TREE

LANDSCAPE AREAS

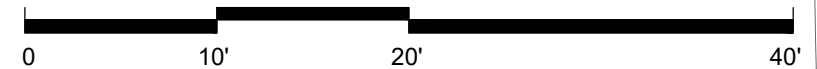

PROJECT

DENBORA BAY III

ADDRESS

2125 BAY DRIVE
MIAMI BEACH, FLORIDA 33141

DRAWING

TREE & PALM PLANTING PLAN

SHEET NO.

L 2.01

DATE

OCT 16, 2023

REVISIONS

#1 24/03/20

#2 24/04/05



DULAND
DESIGN
land planners
landscape architects



LA 6666948

Drawing name: A:\PROJECTS\123020 Denbora Bay III\drawings\3020_PLINT.dwg L 2.02 Apr 05, 2024 3:19pm by: arodu

BAY DRIVE - 60' R.O.W.

SIDEWALK

14 SOD
SF

15 DIB

49 SCA

226 SOD
SF
PROPERTY LINE

15 MSA

7 HYL

15 ASE

140 SOD
SF

7 FMG

23 ASE

14 FMG

472 SOD
SF

18 HYL

10 FMG

12 HYL

12 FMG

32 MSA

21 ASE

15 MSA

39 FMG

21 ASE

20 VIO

20 SOD
SF

12 DIB

PROPERTY LINE

46 CHR

PROPERTY LINE

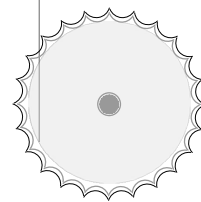

PROPOSED PALM

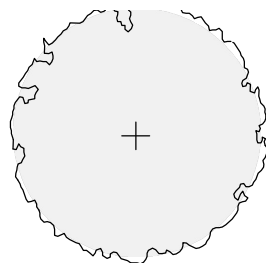

PROPOSED TREE

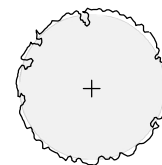

PROPOSED SMALL TREE



PROPOSED SHRUBS

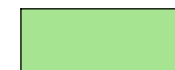

PROPOSED GROUNDCOVER



PROPOSED SOD



PROJECT

DENBORA BAY III

ADDRESS

2125 BAY DRIVE
MIAMI BEACH, FLORIDA 33141

DRAWING

UNDERSTORY PLANTING PLAN

SHEET NO.

L 2.02

DATE

OCT 16, 2023

REVISIONS

#1 24/03/20
#2 24/04/05



DULAND
DESIGN
land planners
landscape architects

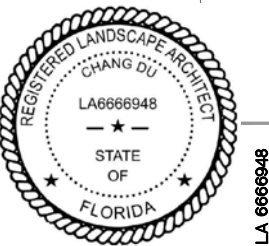

LA 6666948

TREE AND PALM PALETTE



CG
BRIDALVEIL TREE CAESALPINIA GRANADILLO



CR
AUTOGRAPH TREE CLUSIA ROSIA



GL
CRABWOOD GYMNANTHES LUCIDA



PD
ALLSPICE PIMENTA DIOICA



PEX
SOLITAIRE PALM PTYCHOSPERMA ELEGANS

SHURB AND GROUNDCOVER PALETTE



ASE
CAST-IRON PLANT ASPIDISTRA ELATIOR



CHR
RED TIP COCOPLUM CHRYSOBALANUS ICACO "RED TIP"



SCA
GREEN SCHEFFLERA SCHEFFLERA ARBORICOLA



VIO
WALTER'S VIBURNUM VIBURNUM OBOVATUM



GL
CRABWOOD GYMNANTHES LUCIDA



PD
ALLSPICE PIMENTA DIOICA



PEX
SOLITAIRE PALM PTYCHOSPERMA ELEGANS



HYL
SPIDER LILY HYMENOCALLIS LATIFOLIA



DIB
AFRICAN IRIS DIETES BICOLOR



FMG
GREEN ISLAND FICUS FICUS MICROCARPA 'GREEN ISLAND'



SOD
ST AUGUSTINE STENOTAPHRUM SECCUNDATUM

PLANTING SCHEDULE

| Plants installed pursuant to this Code shall conform to, or exceed, the minimum standards for Florida Number One as provided in the most current edition of "Grades and Standards for Nursery Plants, Part I and II," prepared by the State of Florida Department of Agriculture and Consumer Services. | | | | |
|---|--------|----------------------------------|--------------------|---|
| All landscape planting ares shall be irrigated by 100% coverage automatic sprinkler system designed and constructed in accordance with the City of Miami Beach Code of Ordinances. | | | | |
| QUANTITY | SYMBOL | BOTANICAL NAME | COMMON NAME | SPECIFICATIONS |
| TREES | | | | |
| 4 | CG | CAESALPINIA GRANADILLO | BRIDALVEIL TREE | 65GAL/14' PLANTED HT. MIN./ 6' SP/3" CAL./ SINGLE TRUNK/ CLEAR TRUNK 4'/ AS SHOWN |
| 4 | CR | * CLUSIA ROSIA | AUTOGRAPH TREE | 65 GAL/12' HT. / 5' SP./3" CAL./SINGLE TRUNK/ CLEAR TRUNK 4'/AS SHOWN |
| SMALL TREES | | | | |
| 7 | GL | * GYMNANTHES LUCIDA | CRABWOOD | 45 GAL/10' PLANTED HT. MIN./ 5' SP. |
| 2 | PD | PIMENTA DIOICA | ALLSPICE | 45 GAL/10' PLANTED HT. MIN./ 5' SP. |
| PALMS | | | | |
| 2 | PEX | PTYCHOSPERMA ELEGANS | SOLITAIRE PALM | MIN. 8' HEIGHT GW/ FG/ TRIPLE TRUNK/ AS SHOWN |
| SHRUBS | | | | |
| 46 | CHR | * CHRYSOBALANUS ICACO 'RED TIP' | RED TIP COCOPLUM | 15 GAL/ 48" HT. / FULL TO BASE/ 36" O.C. |
| 49 | SCA | SCHEFFLERA ARBORICOLA | GREEN SCHEFFLERA | 15 GAL/ 48" HT. / FULL TO BASE/ 36" O.C. |
| 20 | VIO | * VIBURNUM OBOVATUM | WALTER'S VIBURNUM | 15 GAL/ 48" HT. / FULL TO BASE/ 36" O.C. |
| GRASS & GROUNDCOVERS | | | | |
| 80 | ASE | ASPIDISTRA ELATIOR | CAST-IRON PLANT | 3 GAL/ 24" O.A/ FULL TO BASE/ 24" O.C. |
| 27 | DIB | DIETES BICOLOR | AFRICAN IRIS | 3 GAL/ 18" O.A/ FULL TO BASE/ 24" O.C. |
| 37 | HYL | * HYMENOCALLIS LATIFOLIA | SPIDERLILY | 3 GAL/ 24" O.A/ FULL TO BASE/ 30" O.C. |
| 82 | FMG | FICUS MICROCARPA ' GREEN ISLAND' | GREEN ISLAND FICUS | 3 GAL/ 18" O.A/ FULL TO BASE/ 24" O.C. |
| 57 | MSA | MISCANTHUS SINENSIS 'ADAGIO' | ADAGIO GRASS | 3 GAL/ 18" O.A/ FULL TO BASE/ 24" O.C. |
| MISCELLANEOUS | | | | |
| 872 | SOD | STENOTAPHRUM SECCUNDATUM | ST AUGUSTINE | STAGGERED PANELS (34 SF IN ROW) |

PROJECT

DENBORA BAY III
2125 BAY DRIVE
MIAMI BEACH, FLORIDA 33141

ADDRESS

DRAWING

PLANTING SCHEDULE

SHEET NO.

L 3.01

DATE

OCT 16, 2023

REVISIONS

#1 24/03/20
#2 24/04/05



DULAND
DESIGN
land planners
landscape architects



LA 6666948

Drawing name: A:\PROJECTS\123020 Denbora Bay III\drawings\3200_PLINT.dwg L 3.01 Apr 05, 2024 3:20pm by: aradu

Drawing name: A:\PROJECTS\123020 Denbora Bay III\drawings\3020_PLINT.dwg L 3.02 Apr 05, 2024 3:22pm by: aradu

PROJECT

DENBORA BAY III

ADDRESS

2125 BAY DRIVE
MIAMI BEACH, FLORIDA 33141

DRAWING

LANDSCAPE LEGEND

MUNICIPALITY City of Miami Beach
ZONING CLASS RM-1
TOTAL SITE (SF/AC) 7,789 0.18

| OPEN SPACE | | REQUIRED/ ALLOWED | PROVIDED |
|------------------------------|-------|----------------------|----------|
| A. SF of required Open Space | | 2,337 | 2,845 |
| Lot Area | 7,789 | | |
| Multiplier | 30% | | |

| LAWN AREA | | | |
|-------------------------------|-------|-------|-------|
| A. SF of landscape Open Space | | 2,337 | 2,845 |
| B. Maximum Lawn Area (SOD) | | 1,168 | 838 |
| Open Space required | 2,337 | | |
| Multiplier | 50% | | |

| LOT TREES | | | |
|--|-------|---|---|
| A. Trees required per lot, less existing trees | | 5 | 5 |
| Required trees per acre | 28 | | |
| Net lot acres | 0.179 | | |
| Required trees | 5 | | |
| Existing trees | 0 | | |
| B. % Palms allowed | | - | 2 |
| Trees required | 5 | | |
| Multiplier | 0% | | |
| Existing palms | 0 | | |
| PALMS DO NOT COUNT TOWARDS MIN. TREE REQUIREMENTS | | | |
| C. % Native required | | 2 | 3 |
| Trees provided | 5 | | |
| Multiplier | 30% | | |
| D. % Drought tolerant and low maintenance species required | | 3 | 5 |
| Trees provided | 5 | | |
| Multiplier | 50% | | |

| STREET TREES | | | |
|--|----|---|---|
| A. Street trees (max. average spacing at 20' o.c.) | | 3 | 3 |
| LF of street frontage | 57 | | |
| Multiplier/max. spacing | 20 | | |
| Existing street trees | 0 | | |

| SHRUBS | | | |
|------------------------------|-----|----|-----|
| A. Number of shrubs required | | 94 | 115 |
| Lot + street trees required | 8 | | |
| Multiplier | 12 | | |
| B. % Native required | | 58 | 66 |
| Shrubs provided | 115 | | |
| Multiplier | 50% | | |

| SMALL TREES OR LARGE SHRUBS | | | |
|-----------------------------------|-----|---|---|
| A. Number of small trees required | | 9 | 9 |
| Shrubs required | 94 | | |
| Multiplier | 10% | | |
| B. % Native required | | 5 | 7 |
| Small trees provided | 9 | | |
| Multiplier | 50% | | |



DULAND
DESIGN
land planners
landscape architects



LA 6666948

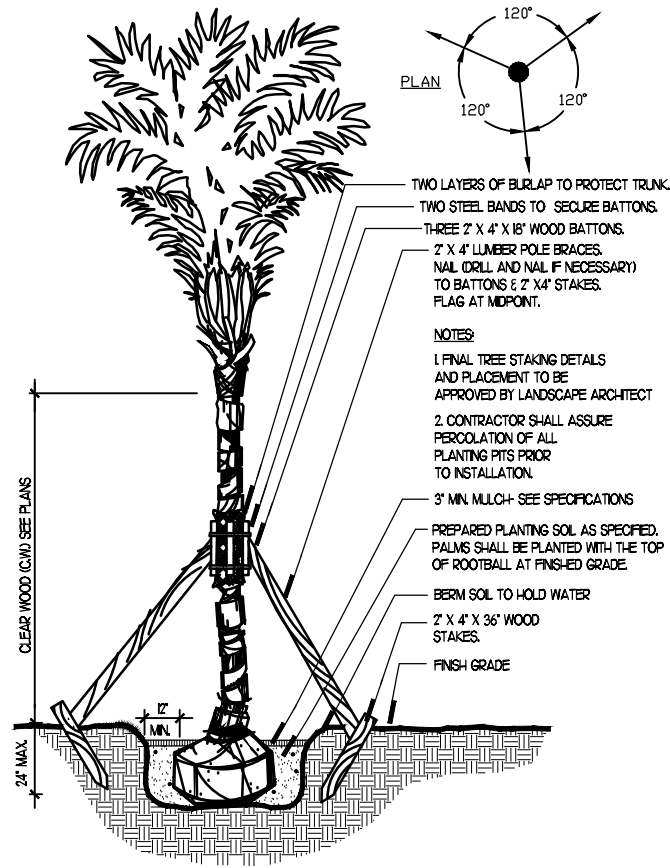

1 PALM
SECTION
DL\118018\13.dwg
SCALE: N.T.S.

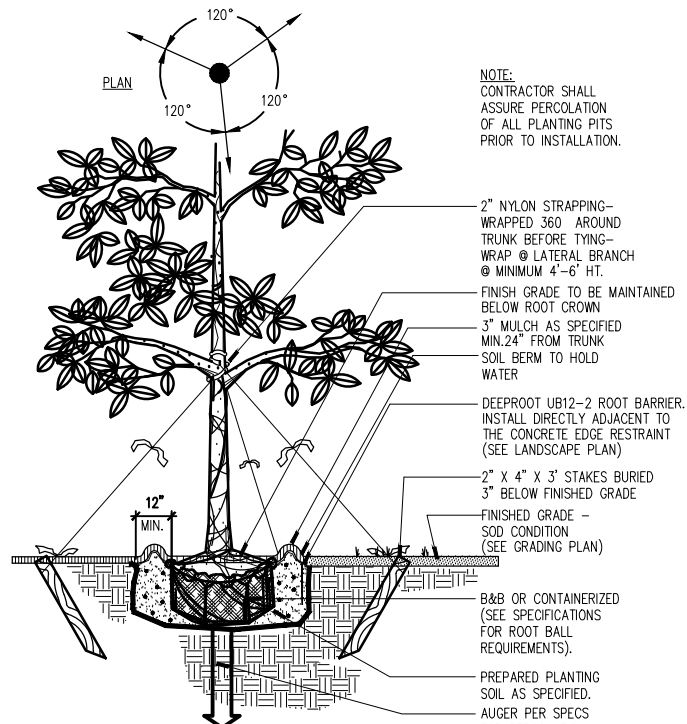

2 SHADE TREE
SECTION
DL\118018_4.dwg
SCALE: N.T.S.

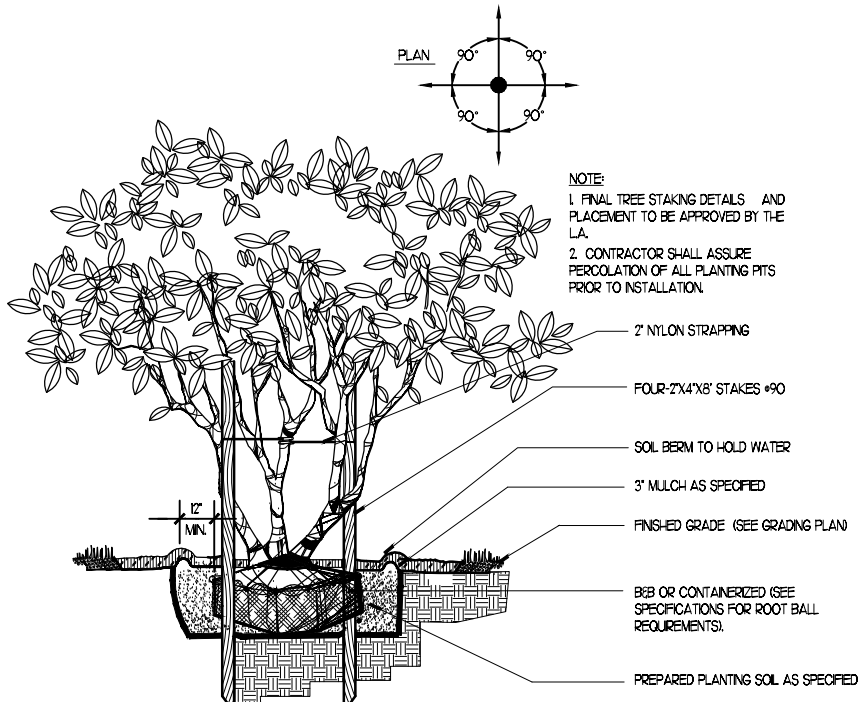

3 MULTI-TRUNK TREE
SECTION
DL\118018\5.dwg
SCALE: N.T.S.

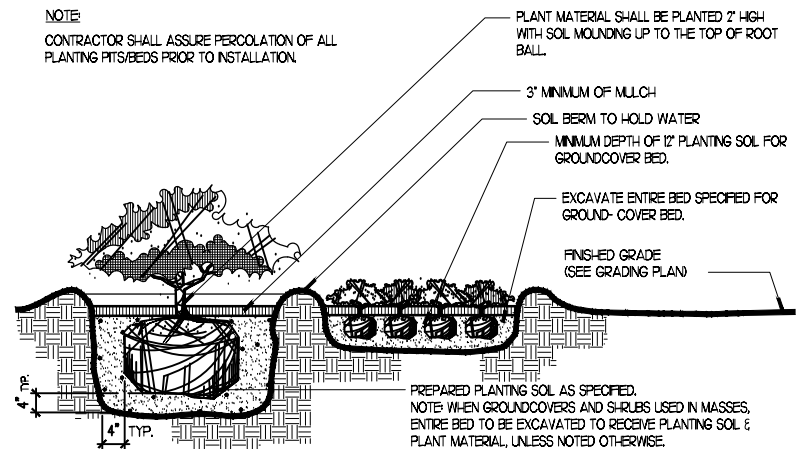

4 SHRUB AND GROUNDCOVER
SECTION
DL\118018\3.dwg
SCALE: N.T.S.

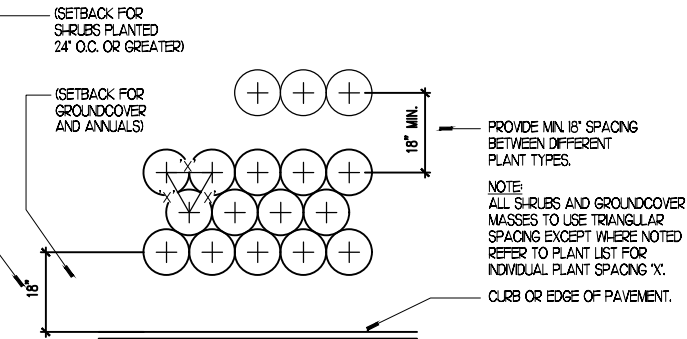

5 TYPICAL PLANT SPACING
PLAN
DL\118018\2.dwg
SCALE: N.T.S.

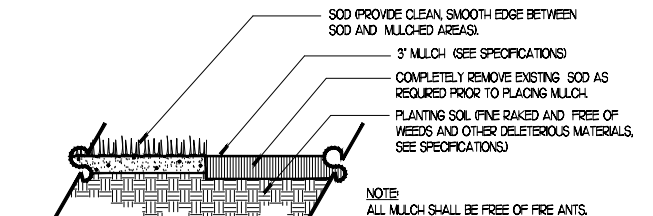

6 MULCH
SECTION
DL\118018\6.dwg
SCALE: N.T.S.

Drawing name: A:\PROJECTS\123020 Denbora Bay III\drawings\3020_PLANT.dwg L 3.03 Mar 18, 2024 8:51pm by: aroldu

PROJECT
DENBORA BAY III

ADDRESS
2125 BAY DRIVE
MIAMI BEACH, FLORIDA 33141

DRAWING
PLANTING DETAILS

SHEET NO.
L 3.03

DATE
OCT 16, 2023

REVISIONS
#1 24/03/20

DL
DULAND
DESIGN
land planners
landscape architects

RED OCTOPUS LLC



LA 6666948