

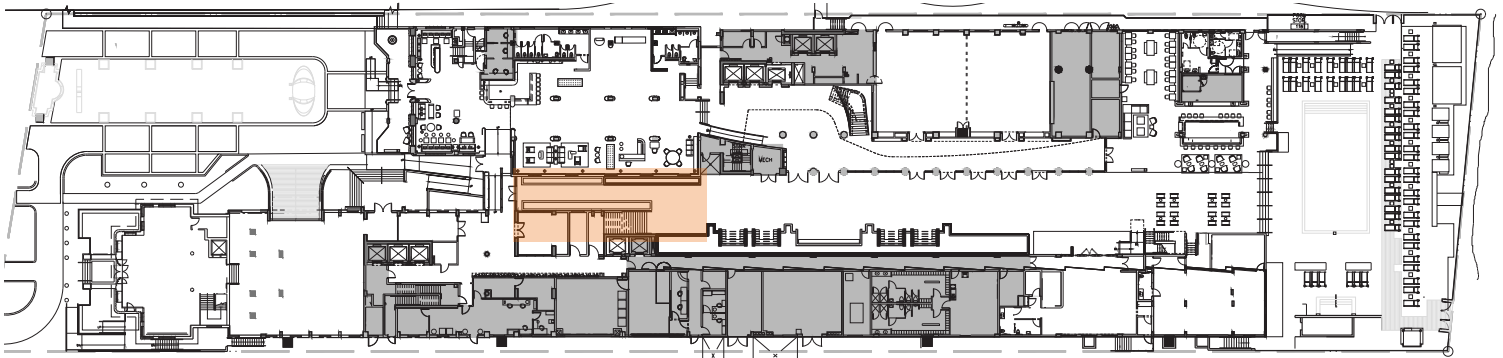

BREEZEWAY BETWEEN LANAI TOWER AND HISTORIC TOWER  
1/30/2024 SITE IMAGES







POOL RESTAURANT  
1/30/2024 SITE IMAGES



ROYAL PALM HOTEL, MIAMI BEACH  
1545 COLLINS AVE., MIAMI BEACH, FL 33139  
HPB SET

AUGUST / 04 / 2024: FINAL SUBMITTAL

E o A , I n c | 1929 Ponce de Leon Blvd., Coral Gables, Florida 33146 | 3 0 5 . 4 4 4 . 0 9 9 0 | State of Florida Architect of Record Malcolm Berg, AIA License No. AR94424

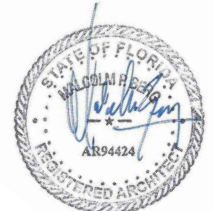

sheet no.  
**ID-2.23**  
SCALE: AS NOTED



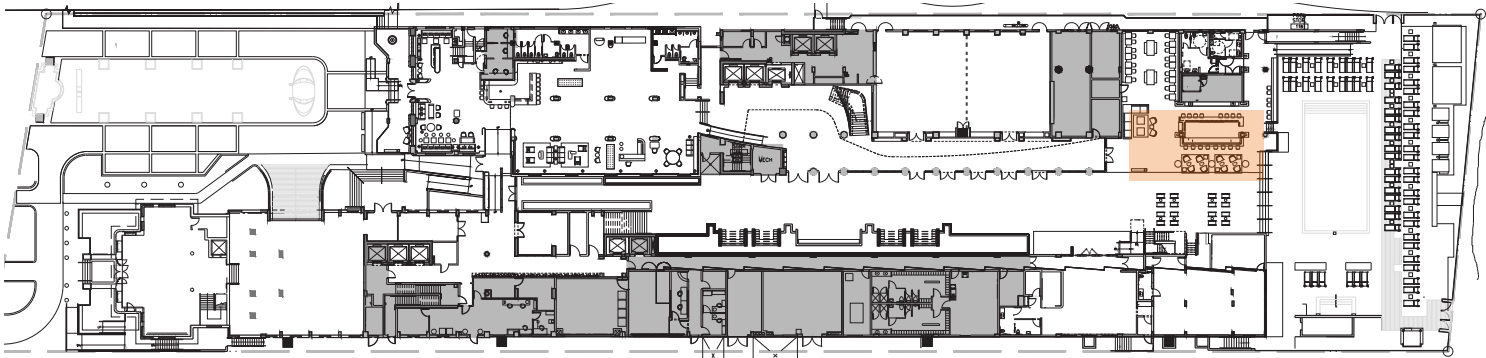

POOL RESTAURANT  
1/30/2024 SITE IMAGES



ROYAL PALM HOTEL, MIAMI BEACH  
1545 COLLINS AVE., MIAMI BEACH, FL 33139  
HPB SET

AUGUST / 04 / 2024: FINAL SUBMITTAL

E o A , I n c | 1929 Ponce de Leon Blvd., Coral Gables, Florida 33146 | 3 0 5 . 4 4 4 . 0 9 9 0 | State of Florida Architect of Record Malcolm Berg, AIA License No. AR94424

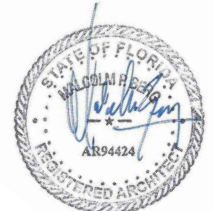

sheet no.  
**ID-2.24**  
SCALE: AS NOTED



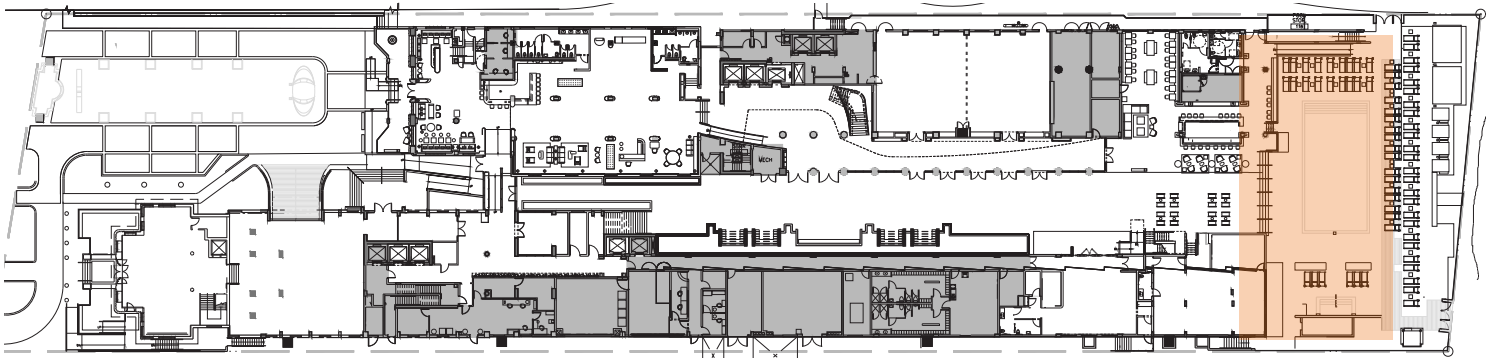

POOL AND POOL RESTAURANT  
1/30/2024 SITE IMAGES



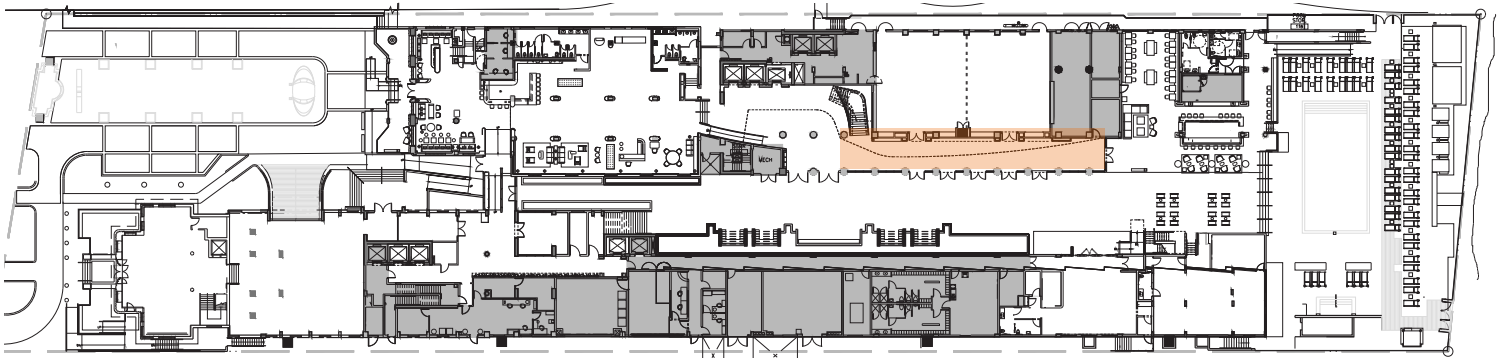

POOL OVERVIEW FROM COOKERY TERRACE  
1/30/2024 SITE IMAGES

**EoA**  
ARCHITECTURE | INTERIORS | BRANDING | MASTER PLANNING | LANDSCAPE

**Gensler**  
**Kimley»Horn**

ROYAL PALM HOTEL, MIAMI BEACH  
1545 COLLINS AVE., MIAMI BEACH, FL 33139  
HPB SET

AUGUST / 04 / 2024: FINAL SUBMITTAL

E o A , I n c | 1929 Ponce de Leon Blvd., Coral Gables, Florida 33146 | 3 0 5 . 4 4 4 . 0 9 9 0 | State of Florida Architect of Record Malcolm Berg, AIA License No. AR94424

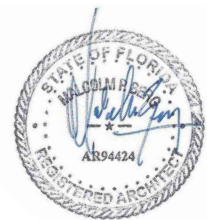

sheet no.

**ID-2.26**

SCALE: AS NOTED





TOWEL CABANA AND JACUZZI  
1/30/2024 SITE IMAGES

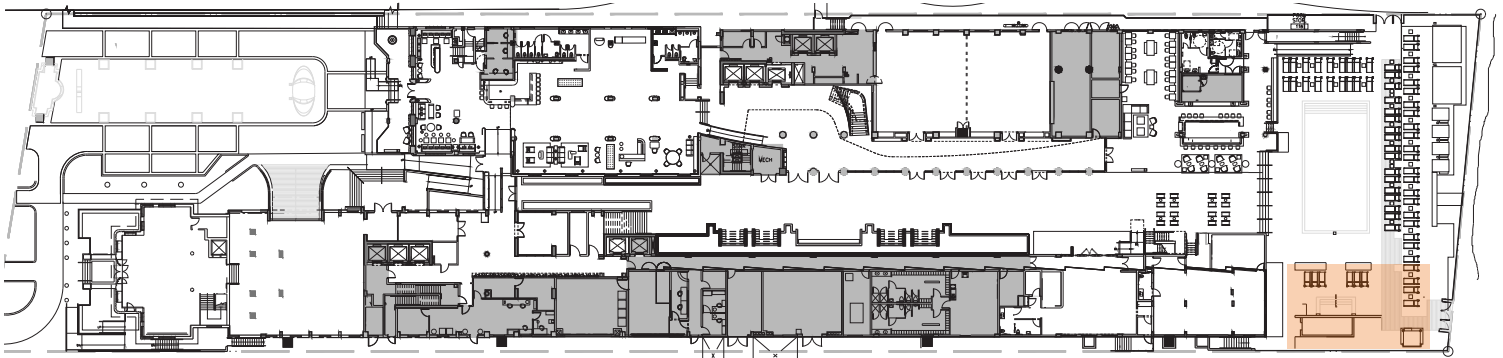

**EoA**  
ARCHITECTURE | INTERIORS | BRANDING | MASTER PLANNING | LANDSCAPE

**Gensler**  
**Kimley»Horn**

ROYAL PALM HOTEL, MIAMI BEACH  
1545 COLLINS AVE., MIAMI BEACH, FL 33139  
HPB SET

AUGUST / 04 / 2024: FINAL SUBMITTAL

E o A , I n c | 1929 Ponce de Leon Blvd., Coral Gables, Florida 33146 | 3 0 5 . 4 4 4 . 0 9 9 0 | State of Florida Architect of Record Malcolm Berg, AIA License No. AR94424

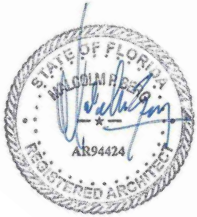

sheet no.

**ID-2.27**

SCALE: AS NOTED