

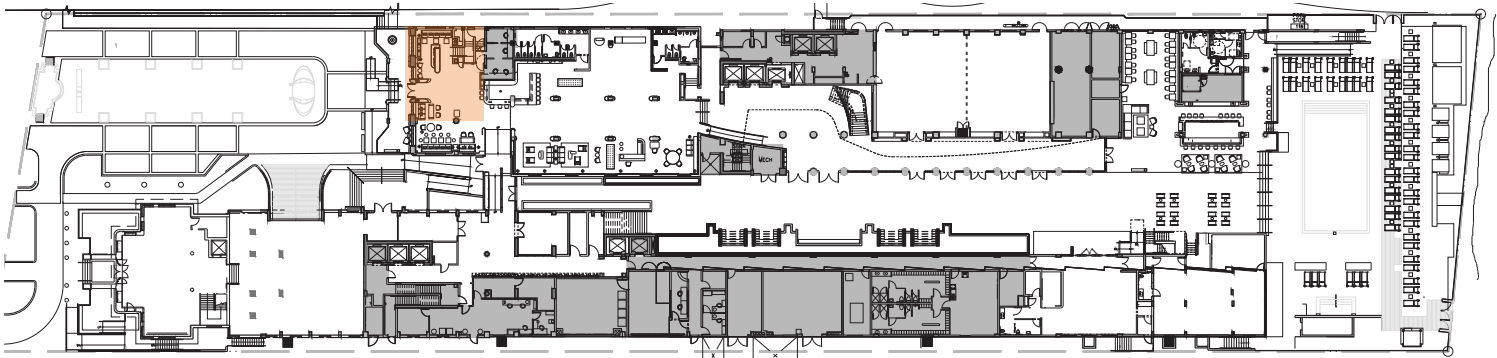

MAIN ENTRY - RECEPTION LOBBY
1/30/2024 SITE IMAGES



ROYAL PALM HOTEL, MIAMI BEACH
1545 COLLINS AVE., MIAMI BEACH, FL 33139
HPB SET

AUGUST / 04 / 2024: FINAL SUBMITTAL

E o A , I n c | 1929 Ponce de Leon Blvd., Coral Gables, Florida 33146 | 3 0 5 . 4 4 4 . 0 9 9 0 | State of Florida Architect of Record Malcolm Berg, AIA License No. AR94424

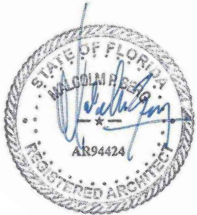

sheet no.

ID-2.04

SCALE: AS NOTED

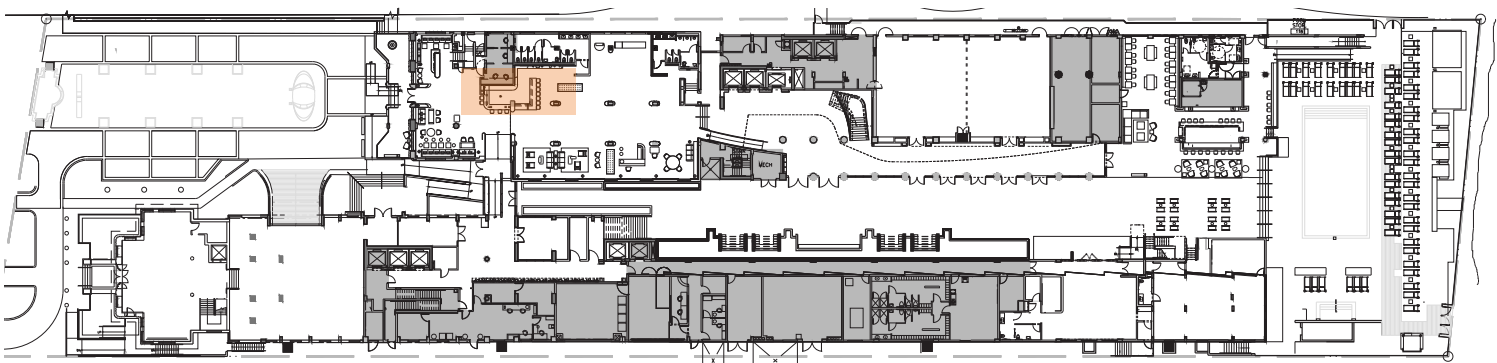

COMPASS ROSE BAR
1/30/2024 SITE IMAGES

EoA
ARCHITECTURE | INTERIORS | BRANDING | MASTER PLANNING | LANDSCAPE

Gensler
Kimley»Horn

ROYAL PALM HOTEL, MIAMI BEACH
1545 COLLINS AVE., MIAMI BEACH, FL 33139
HPB SET

AUGUST / 04 / 2024: FINAL SUBMITTAL

E o A , I n c | 1929 Ponce de Leon Blvd., Coral Gables, Florida 33146 | 3 0 5 . 4 4 4 . 0 9 9 0 | State of Florida Architect of Record Malcolm Berg, AIA License No. AR94424

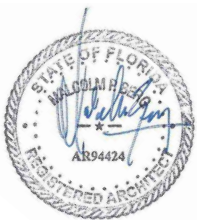

sheet no.

ID-2.05

SCALE: AS NOTED

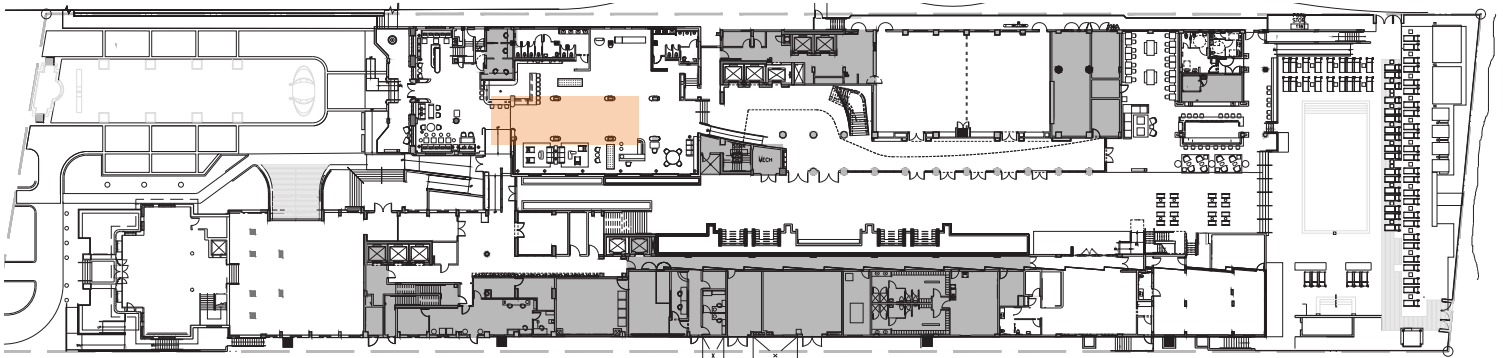

LOBBY
1/30/2024 SITE IMAGES

EoA
ARCHITECTURE | INTERIORS | BRANDING | MASTER PLANNING | LANDSCAPE

Gensler
Kimley»Horn

ROYAL PALM HOTEL, MIAMI BEACH
1545 COLLINS AVE., MIAMI BEACH, FL 33139
HPB SET

AUGUST / 04 / 2024: FINAL SUBMITTAL

E o A , I n c | 1929 Ponce de Leon Blvd., Coral Gables, Florida 33146 | 3 0 5 . 4 4 4 . 0 9 9 0 | State of Florida Architect of Record Malcolm Berg, AIA License No. AR94424

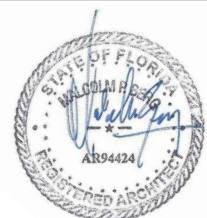

sheet no.

ID-2.06

SCALE: AS NOTED

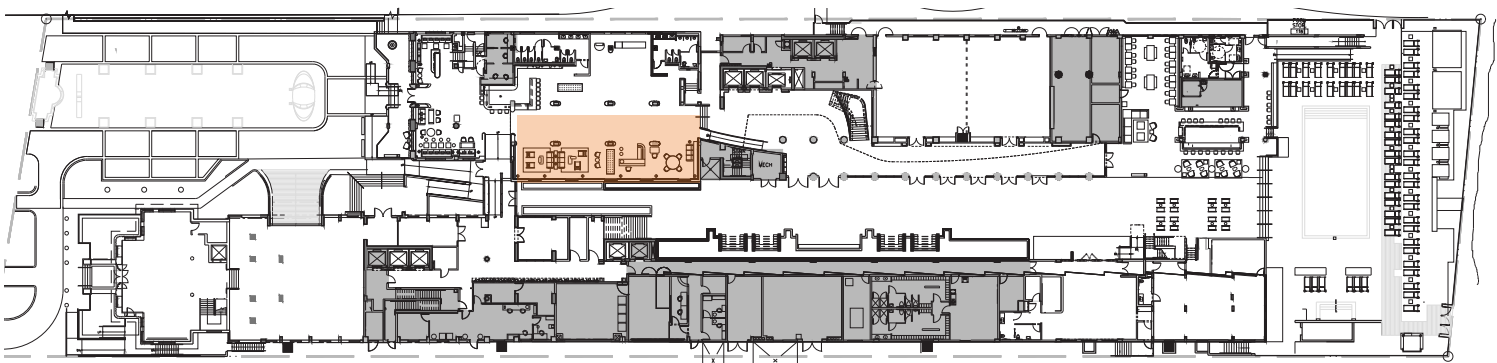

LOBBY LOUNGE
1/30/2024 SITE IMAGES

EoA
ARCHITECTURE | INTERIORS | BRANDING | MASTER PLANNING | LANDSCAPE

Gensler
Kimley»Horn

ROYAL PALM HOTEL, MIAMI BEACH
1545 COLLINS AVE., MIAMI BEACH, FL 33139
HPB SET

AUGUST / 04 / 2024: FINAL SUBMITTAL

E o A , I n c | 1929 Ponce de Leon Blvd., Coral Gables, Florida 33146 | 3 0 5 . 4 4 4 . 0 9 9 0 | State of Florida Architect of Record Malcolm Berg, AIA License No. AR94424

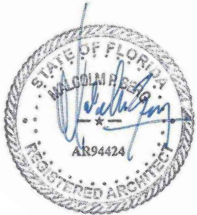

sheet no.

ID-2.07

SCALE: AS NOTED

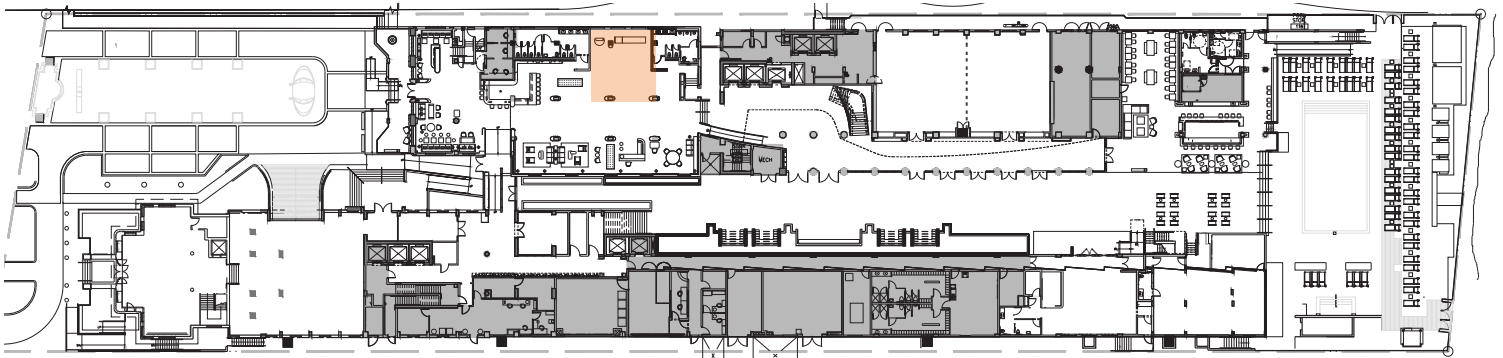

RECEPTION DESK
1/30/2024 SITE IMAGES

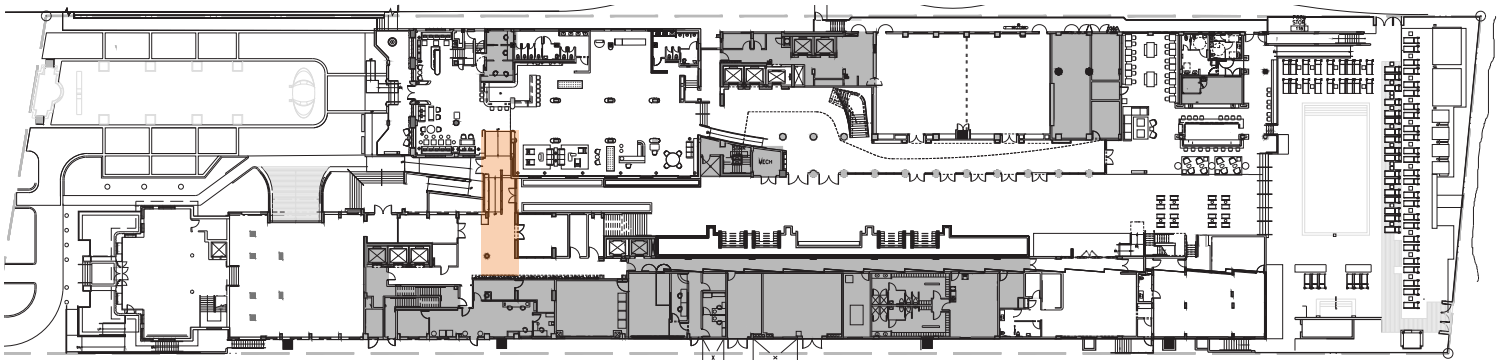

CORRIDOR FROM MAIN LOBBY
1/30/2024 SITE IMAGES

EoA
ARCHITECTURE | INTERIORS | BRANDING | MASTER PLANNING | LANDSCAPE

Gensler
Kimley»Horn

ROYAL PALM HOTEL, MIAMI BEACH
1545 COLLINS AVE., MIAMI BEACH, FL 33139
HPB SET

AUGUST / 04 / 2024: FINAL SUBMITTAL

E o A , I n c | 1929 Ponce de Leon Blvd., Coral Gables, Florida 33146 | 3 0 5 . 4 4 4 . 0 9 9 0 | State of Florida Architect of Record Malcolm Berg, AIA License No. AR94424

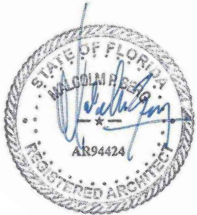

sheet no.

ID-2.09

SCALE: AS NOTED

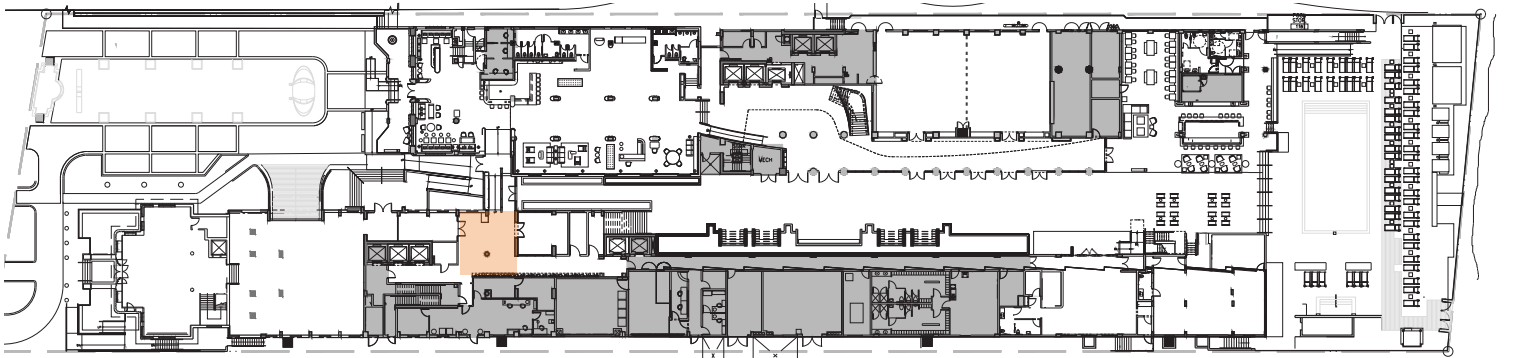

FOYER TO ELEVATOR LOBBIES
1/30/2024 SITE IMAGES



SUNDRY AND CAFE
1/30/2024 SITE IMAGES

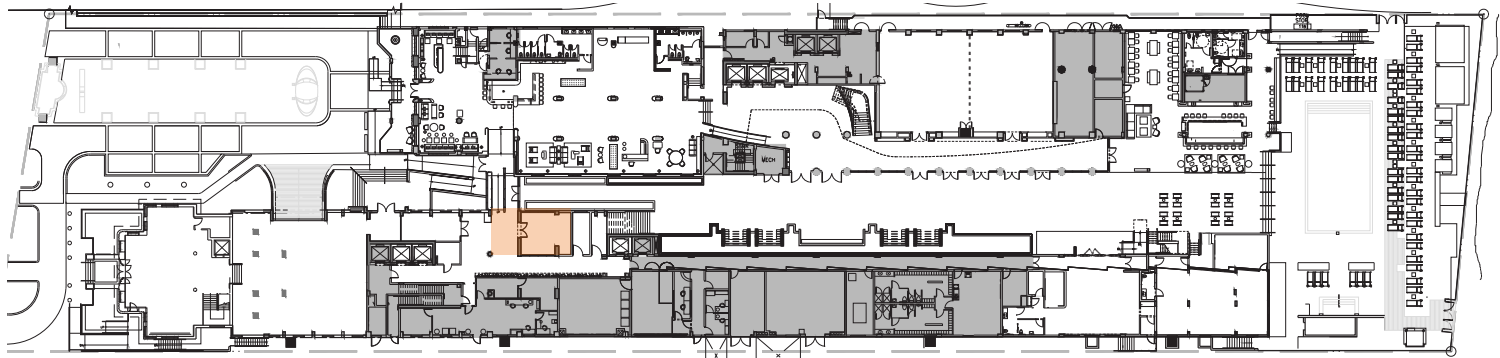

EoA
ARCHITECTURE | INTERIORS | BRANDING | MASTERPLANNING | LANDSCAPE

Gensler
Kimley»Horn

ROYAL PALM HOTEL, MIAMI BEACH
1545 COLLINS AVE., MIAMI BEACH, FL 33139
HPB SET

AUGUST / 04 / 2024: FINAL SUBMITTAL

E o A , I n c | 1929 Ponce de Leon Blvd., Coral Gables, Florida 33146 | 3 0 5 . 4 4 4 . 0 9 9 0 | State of Florida Architect of Record Malcolm Berg, AIA License No. AR94424

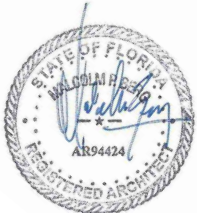

sheet no.

ID-2.11

SCALE: AS NOTED

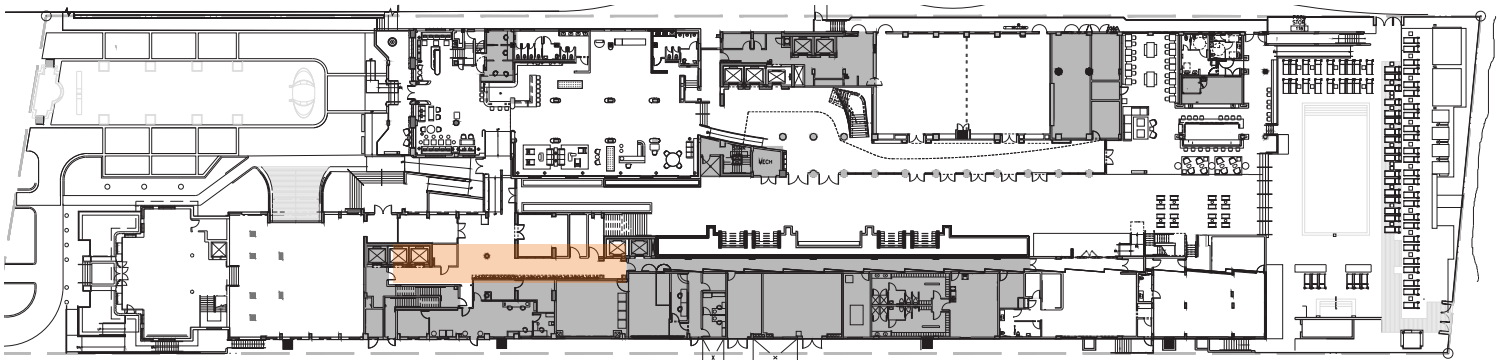

ELEVATOR LOBBY
1/30/2024 SITE IMAGES



ROYAL PALM HOTEL, MIAMI BEACH
1545 COLLINS AVE., MIAMI BEACH, FL 33139
HPB SET

AUGUST / 04 / 2024: FINAL SUBMITTAL

E o A , I n c | 1929 Ponce de Leon Blvd., Coral Gables, Florida 33146 | 3 0 5 . 4 4 4 . 0 9 9 0 | State of Florida Architect of Record Malcolm Berg, AIA License No. AR94424

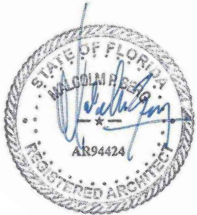

sheet no.

ID-2.12

SCALE: AS NOTED