

4-6-25 Design Review Board Final Submittal

DRB24-1059

1425 Marseille Dr

Residential

1425 Marseille Dr, Miami Beach, FL 33141

DRAWING INDEX

Sheet No.	Sheet Title
L-101	TREE DISPOSITION PLAN
L-102	LANDSCAPE PLAN
L-102.1	LANDSCAPE PLAN (RENDERED)
L-102.2	LANDSCAPE PLAN (1st FLOOR)
L-102.3	LANDSCAPE PLAN (2nd FLOOR)
L-103	LANDSCAPE DETAILS AND NOTES
L-104	PLANT MATERIAL

PARAMETRIKA LAND & DESIGN

Gabriela Albomoz

Valeria Quintanilla LA6667640



1425 Marseille Dr

1425 Marseille Dr

Miami Beach, FL 33141

☒ Rev #3: 04/05/2025

☐

SHEET TITLE

Cover sheet

ISSUE DATE

03/30/2024

REVISION

March, 2024

DESIGN

GA

DRAWN

TY

SCALE

SEAL

VALERIA QUINTANILLA

LA6667640

SHEET NUMBER

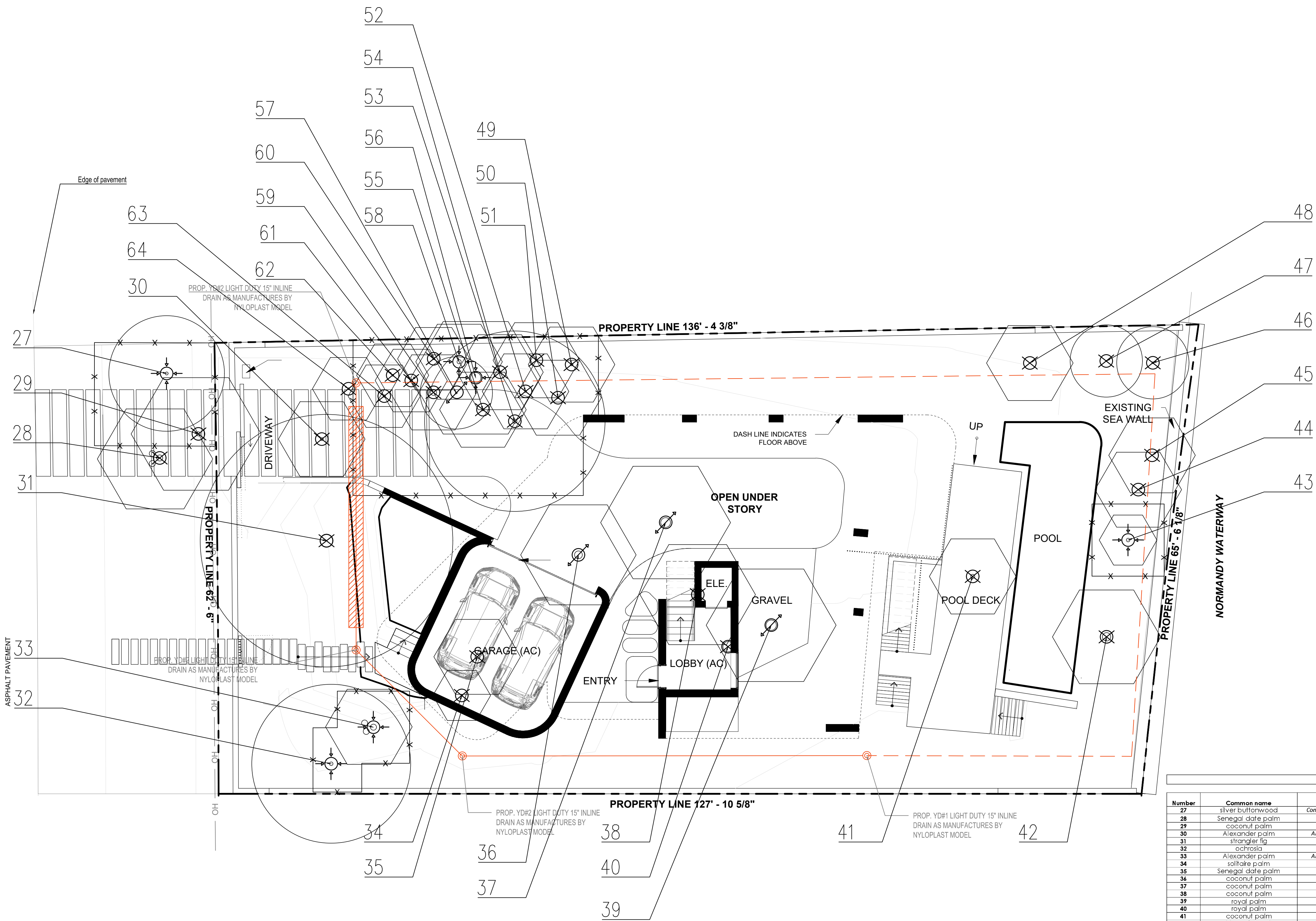

Tree/ Palm protection fences shall be constructed prior to any construction activity including grubbing for all trees/Palms that are to remain, be protected or be relocated.

No activity or disturbance should occur within the fenced areas, including vehicle use, storage of materials, dumping of liquids or materials, grade changes, grubbing, and mechanical trenching for irrigation, electrical, lighting, etc.

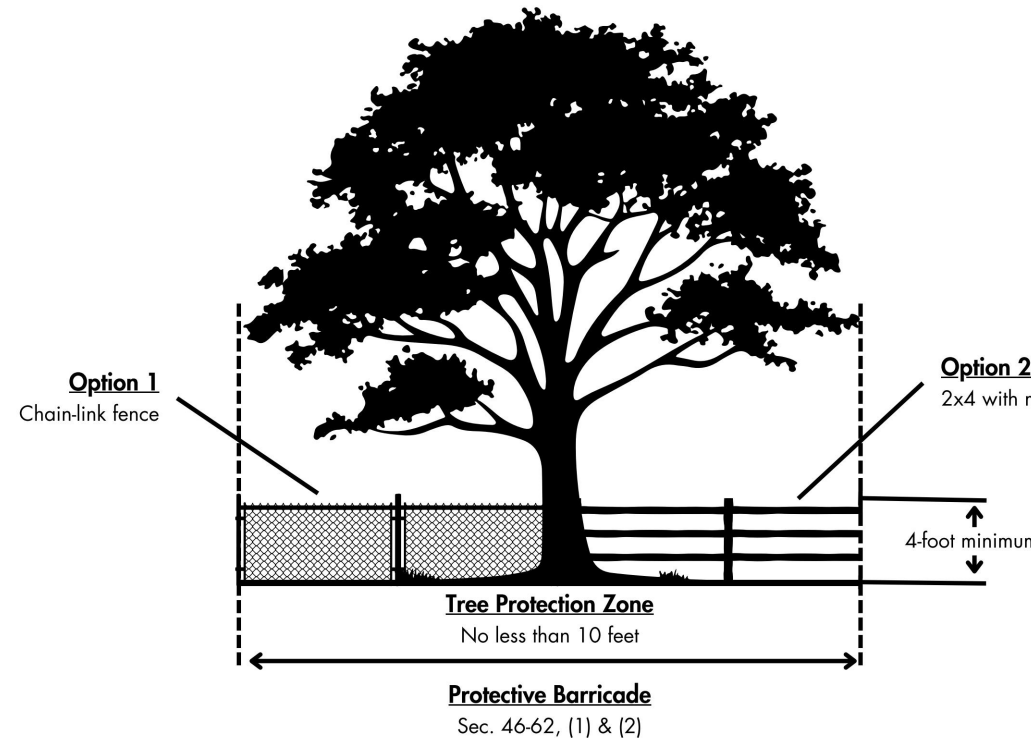

**Protection detail note:**  
The contractor shall install tree protection fence barriers around all existing trees or palms at the start of the project. Barriers shall remain in place throughout the project and should not be removed or dropped without authorization from the City of Miami Beach Urban Forestry Division.

MIAMI BEACH  
RISING  
ABOVE

## LEGEND

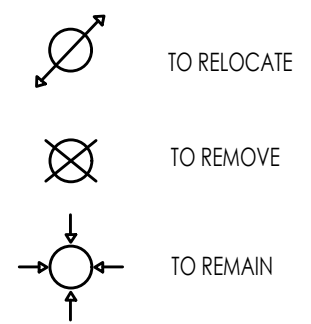

ANSI TREE PROTECTION ZONE  
(FOR EVERY INCH (") OF TRUNK DIA. THERE WILL BE  
1' (FT.) OF DISTANCE OUT FROM THE TRUNK)

## EXISTING TREES &amp; PALMS

Number	Common name	Botanical Name	Height (')	DBH (")	Number of stems	Spread (')	Condition	Critical Root Zone Radius'	Prohibited?	Specimen?	Disposition	Mitigation
27	silver buttonwood	Conocarpus erectus var. sericeus	18	5	1	16	Good	10			To remain	
28	Senegal date palm	Phoenix reclinata	15	cluster	1	16	Good	10			To remove	N/A
29	coconut palm	Cocos nucifera	25	7	1	18	Good	10			To remove	N/A
30	Alexander palm	Archontophoenix alexandriae	18	5	1	12	Good	N/A			To remove	N/A
31	strangler fig	Ficus aurea	30	22	1	35	Good	15		Yes	To remove	N/A (invasive)
32	ochrosia	Ochrosia elliptica	22	6	1	22	Good	10			To remain	
33	Alexander palm	Archontophoenix alexandriae	25	cluster	1	12	Good	10			To remain	
34	solitaire palm	Pythosperma elegans	35	3	1	8	Good	N/A			To remove	N/A
35	Senegal date palm	Phoenix reclinata	42	7	1	12	Good	10			To remove	N/A
36	coconut palm	Cocos nucifera	42	13	1	16	Good	10		Yes	To relocate	
37	coconut palm	Cocos nucifera	60	16	1	18	Good	11		Yes	To relocate	*
38	coconut palm	Cocos nucifera	35	8	1	16	Fair	10			To remove	
39	royal palm	Roystonea regia	35	17	1	18	Fair	11		Yes	To relocate	
40	royal palm	Roystonea regia	25	17	1	0	Poor	11		Yes	To remove	N/A
41	coconut palm	Cocos nucifera	16	7	1	12	Good	10			To remove	
42	Chinese fan palm	Livistana chinensis	60	14	1	15	Good	10		Yes	To remove	N/A
43	coconut palm	Cocos nucifera	16	6	1	8	Poor	10			To remain	
44	coconut palm	Cocos nucifera	15	0	1	12	Poor	N/A			To remove	N/A
45	coconut palm	Cocos nucifera	15	0	1	12	Poor	N/A			To remove	N/A
46	seagrape	Coccoloba uvifera	10	3	2	10	Poor	10			To remove	N/A
47	Madagascar olive	Nothofagus emarginata	10	2	3	10	Poor	10			To remove	N/A
48	coconut palm	Cocos nucifera	12	0	1	12	Poor	N/A			To remove	N/A
49	Montgomery palm	Veitchia arecina	22	4.4	1	12	Good	N/A			To remove	N/A
50	Montgomery palm	Veitchia arecina	22	3	1	12	Good	N/A			To remove	N/A
51	Montgomery palm	Veitchia arecina	22	3	1	12	Good	N/A			To remove	N/A
52	Montgomery palm	Veitchia arecina	20	3	1	12	Good	N/A			To remove	N/A
53	minuosa	Minusa elegans	35	7	1	25	Good	10			To remove	7
54	Montgomery palm	Veitchia arecina	25	4	1	12	Good	N/A			To remove	N/A
55	Montgomery palm	Veitchia arecina	25	4	1	12	Good	N/A			To remove	N/A
56	royal palm	Roystonea regia	60	17	1	18	Good	11		Yes	To remove	*
57	minuosa	Minusa elegans	22	3	1	10	Good	10			To relocate	
58	Alexander palm	Archontophoenix alexandriae	35	7	1	12	Good	10			To remain	
59	Alexander palm	Archontophoenix alexandriae	28	5	1	12	Good	10			To remove	N/A
60	solitaire palm	Pythosperma elegans	28	3	1	10	Good	N/A			To remove	N/A
61	solitaire palm	Pythosperma elegans	28	3.3	1	10	Good	N/A			To remove	N/A
62	solitaire palm	Pythosperma elegans	28	3	1	10	Good	N/A			To remove	N/A
63	solitaire palm	Pythosperma elegans	28	4	1	10	Good	N/A			To remove	N/A
64	solitaire palm	Pythosperma elegans	26	3	1	10	Good	N/A			To remove	N/A
TOTAL DBH REMOVED											0	
TOTAL PALMS REMOVED											3	

REPLACEMENT					
PALMS					
Qty.	Botanical Name	Common name	Height (')	DBH (")	Canopy (')
3	Pythosperma elegans	Alexander Palm	16	4	10

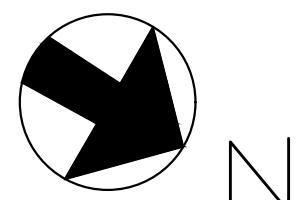



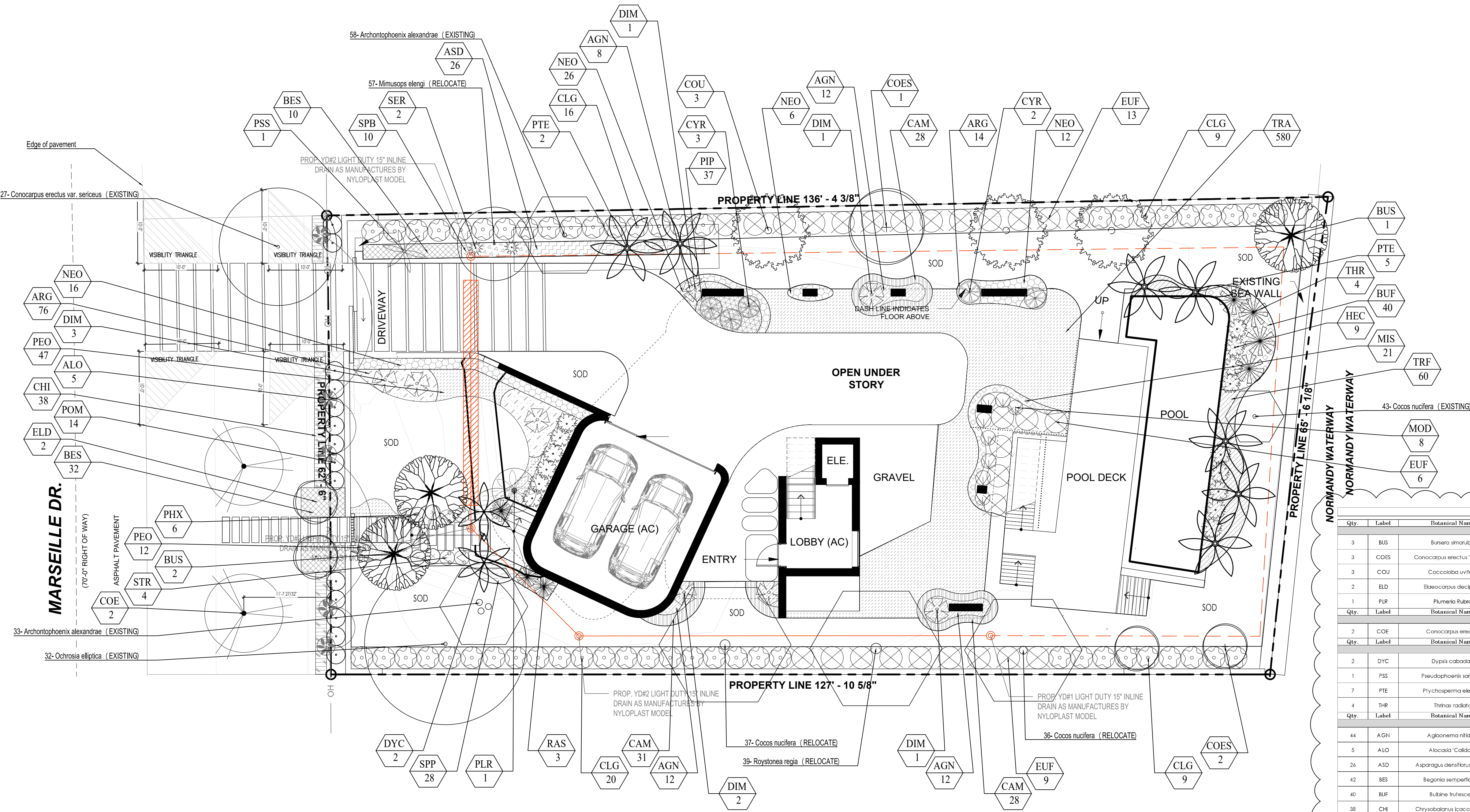

PLANT LIST									
Qty.	Label	Botanical Name	Common name	Height	DBH	Spread	Native	Drought tolerance	Specifications
TREES									
3	BUS	Burretia imrayba	Gumbo Limbo	16'	2"	10'	YES	Tolerant	
3	COES	Conocarpus erectus 'sericeus'	Silver Buttonwood	16'	2"	10'	YES	Tolerant	
3	COU	Coccoloba uvifera	Seagrape	16'	2"	10'	YES	Tolerant	
2	ELD	Elaeagnus argentea	Japanese blueberry	12'	2"	6'	NO	Tolerant	
1	PIP	Plumbago indica	Frangipani	6'	1 1/2"	6'	NO	Tolerant	
Qty.	Label	Botanical Name	Common name	Height	DBH	Spread	Native	Drought tolerance	Specifications
SHRUBS									
2	COE	Conocarpus erectus	Green Buttonwood	16'	2"	10'	YES	Tolerant	
Qty.	Label	Botanical Name	Common name	Height	DBH	Spread	Native	Drought tolerance	Specifications
PALMS									
2	DYC	Dypsis cabobabo	Cabobabo Palm	10'		8'	NO	Tolerant	
1	PSS	Pseudophoenix sargentii	Buccanier Palm	6'		6'	YES	Tolerant	
7	PTE	Phycosperma elegans	Alexander Palm	16'	4"	10'	NO	Tolerant	12" Clear trunk
4	THR	Thrinax radiata	Thatch Palm	4'		4'	YES	Tolerant	
Qty.	Label	Botanical Name	Common name	Height		Spread	Native	Drought tolerance	Specifications
SHRUBS									
44	AGN	Agave americana	Agave	24"		24"	NO	Tolerant	24" o.c.
5	ALO	Alcaeus 'Caldora'	Alcaeus	24"		24"	NO	Tolerant	
26	ASD	Asparagus densiflorus 'Myers'	Fox tail Fern	24"		24"	NO	Tolerant	24" o.c.
42	BES	Begonia semperflorens	White begonia	24"		24"	NO	Tolerant	24" o.c.
40	BUF	Bubbia frutescens	Bubbia	24"		24"	NO	Tolerant	24" o.c.
38	CHI	Chrysobalanus icaco 'Green'	Green Coccoloba	24"		24"	YES	Tolerant	18" o.c.
5	CYR	Cycas revoluta	Sago Palm	3'		3'	NO	Tolerant	
8	DIM	Dioon majas	Palm tree	24"		24"	NO	Tolerant	
9	HEC	Heliconia caribaea	Heliconia	36"		36"	NO	Tolerant	36" o.c.
21	MIS	Microsorium scolopendrium	Wart Fern	24"		24"	NO	Tolerant	18" o.c.
8	MOD	Monstera deliciosa	Swiss Cheese Plant	24"		24"	NO	Tolerant	24" o.c.
60	NEO	Nephrolepis obliterata	Kimberly Fern	24"		24"	NO	Tolerant	24" o.c.
59	PEO	Pennisetum orientale	White fountain grass	24"		24"	NO	Tolerant	24" o.c.
6	PHX	Philodendron variegatum	Xanadu	24"		24"	NO	Tolerant	24" o.c.
14	POM	Podocarpus macrophyllus	Podocarpus	36"		36"	NO	Tolerant	36" o.c.
3	RAS	Radermachera sinica	Radermachera	4'		4'	NO	Tolerant	48" o.c.
2	SER	Serenoa repens	Saw Palmetto	24"		24"	YES	Tolerant	
10	SPB	Spartina bakeri	Sand Cordgrass	18"		18"	YES	Tolerant	18" o.c.
4	STR	Strelitzia reginae	Bird of Paradise	24"		24"	NO	Tolerant	24" o.c.
28	SPP	Spathoglottis plicata	Ground Orchid	18"		18"	NO	Tolerant	18" o.c.
60	TRF	Trichostema grandifolium	Dwarf Fuchsia	18"		18"	YES	Tolerant	24" o.c.
Qty.	Label	Botanical Name	Common name	Height		Spread	Native	Drought tolerance	Specifications
LARGE SHRUBS									
54	CLG	Clusia guifera	Small Leaf Clusia	6'		3'	NO	Tolerant	3'
28	BUF	Eugenia toefida	Spanish Stopper	6'		4'	YES	Tolerant	4' o.c.
Qty.	Label	Botanical Name	Common name	Height		Spread	Native	Drought tolerance	Specifications
GROUND COVER									
90	ARG	Arachis glabrata	Ornamental peanuts	12"		12"	NO	Tolerant	12" o.c.
87	CAM	Carlisa macrocarpa	Natal plum	12"		12"	NO	Tolerant	12" o.c.
37	PIP	Pilea peperomioides	Pilea	12"		12"	NO	Tolerant	12" o.c.
580	TRA	Trachelospermum asiaticum	Asiatic jasmine	12"		12"	YES	Tolerant	12" o.c.
Qty.	Label	Botanical Name	Common name	Height		Spread	Native	Drought tolerance	Specifications
SOD									
2,150 sq ft	SOD	Zoysia lawn	Zoysia						

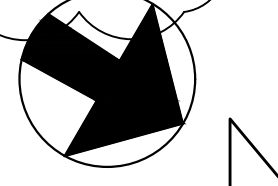

PARAMETRIKA LAND & DESIGN  
Gabriela Albanoz  
Valeria Quintanilla LA6667640



1425 Marseille Dr  
1425 Marseille Dr  
Miami Beach, FL 33141

SHEET TITLE  
Landscape plan

ISSUE DATE  
03/30/2024

REVISION  
March, 2024

DESIGN  
GA

DRAWN  
TY

SCALE  
1/8" = 1'-0"

SEAL  
VALERIA QUINTANILLA  
LA6667640

SHEET NUMBER  
L-102



MARSEILLE DR.

(70'-0" RIGHT OF WAY)

ASPHALT PAVEMENT

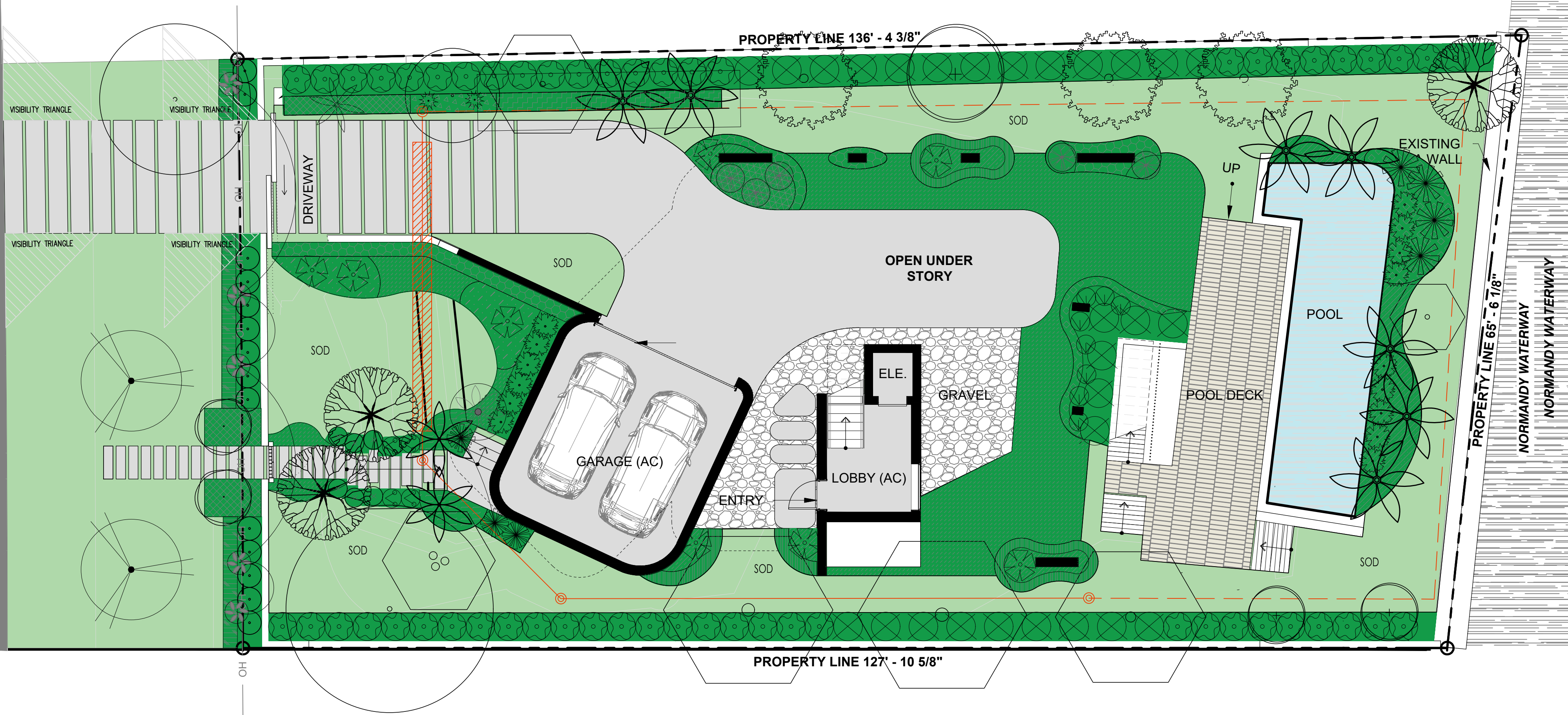

PLANT LIST									
Qty.	Label	Botanical Name	Common name	Height	DBH	Spread	Native	Drought tolerance	Specifications
TREES									
3	BUS	Bursera simaruba	Gumbo Limbo	16'	2"	10'	YES	Tolerant	
3	COE	Conocarpus erectus 'sericeus'	Silver Buttonwood	16'	2"	10'	YES	Tolerant	
3	COU	Coccoloba uvifera	Seagrape	16'	2"	10'	YES	Tolerant	
2	ELD	Elaeocarpus decipiens	Japanese blueberry	12'	2"	6'	NO	Tolerant	
1	PLR	Plumeria Rubra	Frangipani	6'	1 1/2"	6'	NO	Tolerant	
Qty.	Label	Botanical Name	Common name	Height	DBH	Spread	Native	Drought tolerance	Specifications
STREET TREES									
2	COE	Conocarpus erectus	Green Buttonwood	16'	2"	10'	YES	Tolerant	
Qty.	Label	Botanical Name	Common name	Height	DBH	Spread	Native	Drought tolerance	Specifications
PALMS									
2	DIY	Dyopsis caribbaea	Caballo Palm	10'		8'	NO	Tolerant	
1	PSS	Pseudophoenix sargentii	Buccaneer Palm	6'		6'	YES	Tolerant	
7	PTE	Phychoperma elegans	Alexander Palm	16'	4"	10'	NO	Tolerant	12' Clear trunk
4	THR	Thrinax radiata	Thatch Palm	4'		4'	YES	Tolerant	
Qty.	Label	Botanical Name	Common name	Height		Spread	Native	Drought tolerance	Specifications
SHRUBS									
44	AGN	Aglaonema nitidum	Aglaonema	24"		24"	NO	Tolerant	24" o.c.
5	ALO	Alcornoque 'Caldora'	Alcornoque	24"		24"	NO	Tolerant	
26	ASD	Asparagus densiflorus 'Myers'	Fox tail Fern	24"		24"	NO	Tolerant	24" o.c.
42	BES	Begonia semperflorens	White begonia	24"		24"	NO	Tolerant	24" o.c.
40	BUF	Bubbia frutescens	Bubbia	24"		24"	NO	Tolerant	24" o.c.
38	CHI	Chrysobalanus icaco 'Green'	Green Cocoplum	24"		24"	YES	Tolerant	18" o.c.
5	CYR	Cycas revoluta	Sago Palm	3'		3'	NO	Tolerant	
8	DIA	Dianella caerulea	Palmia tesante	24"		24"	NO	Tolerant	
9	HEC	Heliconia caribaea	Heliconia	36"		36"	NO	Tolerant	36" o.c.
21	MIS	Microsorium scolopendrium	Wart Fern	24"		24"	NO	Tolerant	18" o.c.
8	MOD	Monstera deliciosa	Swiss Cheese Plant	24"		24"	NO	Tolerant	24" o.c.
40	NEO	Nephrolepis obliterata	Kimberly fern	24"		24"	NO	Tolerant	24" o.c.
59	PEO	Pennisetum orientale	White fountain grass	24"		24"	NO	Tolerant	24" o.c.
6	PHX	Philodendron xanadu	Xanadu	24"		24"	NO	Tolerant	24" o.c.
14	POM	Podocarpus macrophyllus	Podocarpus	36"		36"	NO	Tolerant	36" o.c.
3	PAS	Rademachera sinica	Rademachera	4'		4'	NO	Tolerant	48" o.c.
2	SER	Serenoa repens	Saw Palmetto	24"		24"	YES	Tolerant	
10	SPB	Spartina bakeri	Sand Cordgrass	18"		18"	YES	Tolerant	18" o.c.
4	STR	Strelitzia reginae	Bird of Paradise	24"		24"	NO	Tolerant	24" o.c.
28	SPP	Spathoglottis plicata	Ground Orchid	18"		18"	NO	Tolerant	18" o.c.
40	TRF	Trissacum floridanum	Dwarf Fakahatchee	18"		18"	YES	Tolerant	24" o.c.
Qty.	Label	Botanical Name	Common name	Height		Spread	Native	Drought tolerance	Specifications
LARGE SHRUBS									
54	CLG	Cordia alliodora	Small Leaf Cordia	6'		3'	NO	Tolerant	3'
28	EUF	Eugenia foetida	Spanish Stagger	6'		4'	YES	Tolerant	4' o.c.
Qty.	Label	Botanical Name	Common name	Height		Spread	Native	Drought tolerance	Specifications
GROUND COVER									
90	ARG	Arachis glabra	Ornamental peanuts	12"		12"	NO	Tolerant	12" o.c.
87	CAM	Calypso macrocarpa	Natal plim	12"		12"	NO	Tolerant	12" o.c.
37	PIP	Pilea peperomioides	Pilea	12"		12"	NO	Tolerant	12" o.c.
580	TRA	Trachelospermum asiaticum	Asiatic Jasmine	12"		12"	YES	Tolerant	12" o.c.
Qty.	Label	Botanical Name	Common name	Height		Spread	Native	Drought tolerance	Specifications
SOD									
2,150 sq ft	SOD	Zoysia lawn	Zoysia						

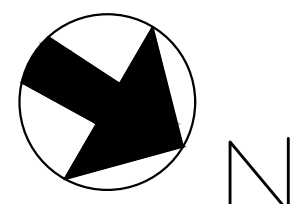

PARAMETRIKA LAND & DESIGN  
Gabriela Albornoz  
Valeria Quintanilla LA6667640



1425 Marseille Dr  
1425 Marseille Dr  
Miami Beach, FL 33141

Rev #3: 04/05/2025

SHEET TITLE  
Landscape plan (Rendered)

ISSUE DATE  
03/30/2024

REVISION  
March, 2024

DESIGN  
GA

DRAWN  
TY

SCALE  
1/8" = 1'-0"

SEAL  
VALERIA QUINTANILLA  
LA6667640

SHEET NUMBER  
L-102.1



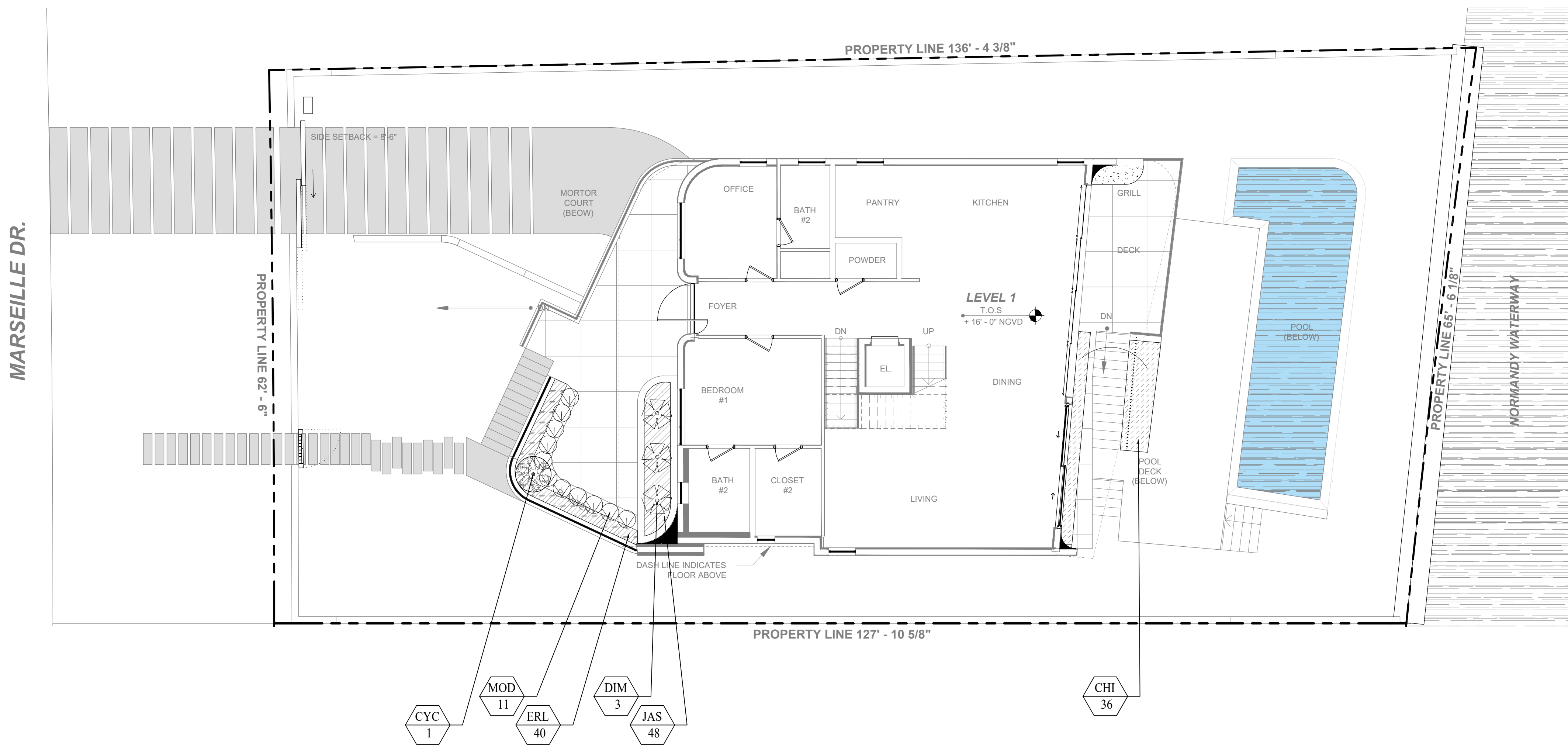

PLANT LIST								
Qty.	Label	Botanical Name	Common name	Height	Spread	Native	Drought tolerance	Specifications
SHRUBS								
36	CHI	Chrysobalanus icaco "Horizontal"	Cocoplum horizontalis	36"	36"	YES	Tolerant	36" o.c.
1	CYC	Cyathea cooperi	Australian Tree Fern	3'	3'	NO	Tolerant	
3	DIM	Dioon mejiae	Palma teosinte	24"	24"	NO	Tolerant	
11	MOD	Monstera deliciosa	Swiss Cheese Plant	24"	24"	NO	Tolerant	24" o.c.
Qty.	Label	Botanical Name	Common name	Height		Native	Drought tolerance	Specifications
GROUNDCOVER								
40	ERL	Ernodea littoralis Sw.	Beach Creeper	12"	12"	YES	Tolerant	12" o. c.
48	JAS	Jasminum simplicifolium	Wax Jasmin	12"	12"	NO	Tolerant	12" o.c.



*Chrysobalanus icaco*  
"Horizontal"



*Cyathea cooperi*



*Dioon mejiae*

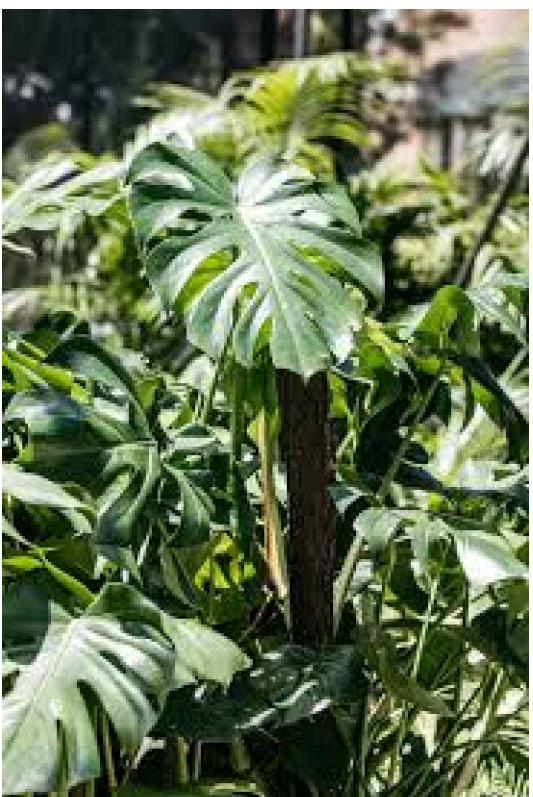

*Monstera deliciosa*



*Ernodea littoralis* Sw.



*Jasminum simplicifolium*

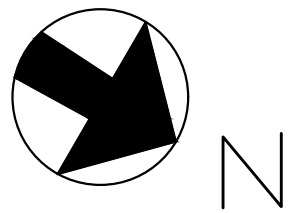

PARAMETRIKA LAND & DESIGN  
Gabriela Albomoz  
Valeria Quintanilla LA6667640



1425 Marseille Dr  
1425 Marseille Dr  
Miami Beach, FL 33141

Rev #3: 04/05/2025

SHEET TITLE  
Landscape plan (1st floor)

ISSUE DATE  
03/30/2024

REVISION  
March, 2024

DESIGN  
GA

DRAWN  
TY

SCALE  
1/8" = 1'-0"

SEAL  
VALERIA QUINTANILLA  
LA6667640

SHEET NUMBER  
L-102.2



MARSEILLE DR.

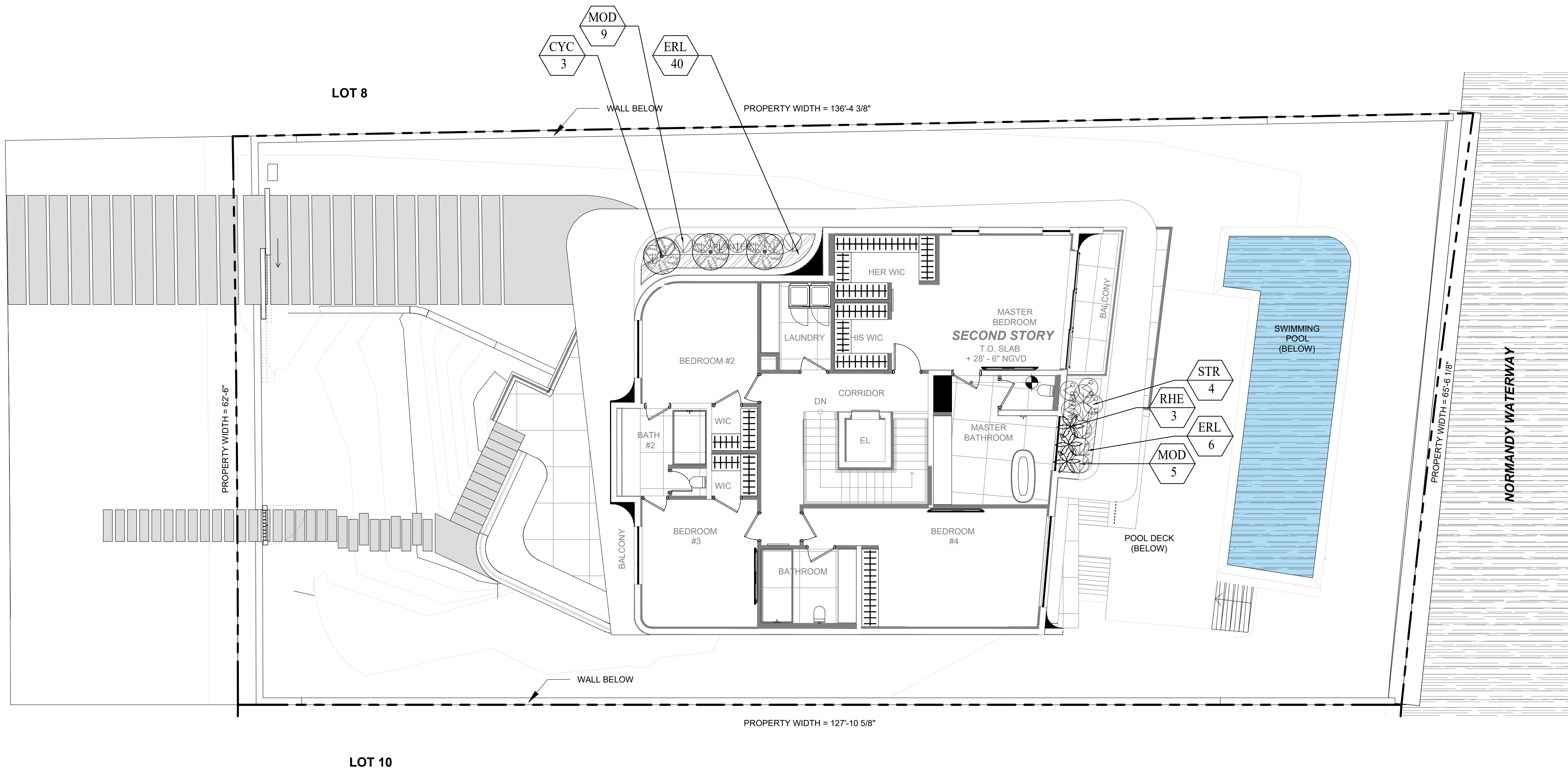

PLANT LIST								
Qty.	Label	Botanical Name	Common name	Height	Spread	Native	tought toleran	Specifications
SHRUBS								
3	CYC	Cyathea cooperi	Australian Tree Fern	3'	3'	NO	Tolerant	
14	MOD	Monstera deliciosa	Swiss Cheese Plant	24"	24"	NO	Tolerant	24" o.c.
3	RHE	Rhapis excelsa	Lady Palm	4'	4'	NO	Tolerant	
4	STR	Strelitzia reginae	Bird of Paradise	24"	24"	NO	Tolerant	24" o.c.
Qty.	Label	Botanical Name	Common name	Height	Spread	Native	tought toleran	Specifications
GROUNCOVER								
6	ERL	Emodea littoralis Sw.	Beach Creeper	12"	12"	YES	Tolerant	12" o. c.
14	JAS	Jasminum simplicifolium	Wax Jasmin	12"	12"	NO	Tolerant	12" o.c.



Cyathea cooperi



Monstera deliciosa



Rhapis excelsa



Strelitzia reginae

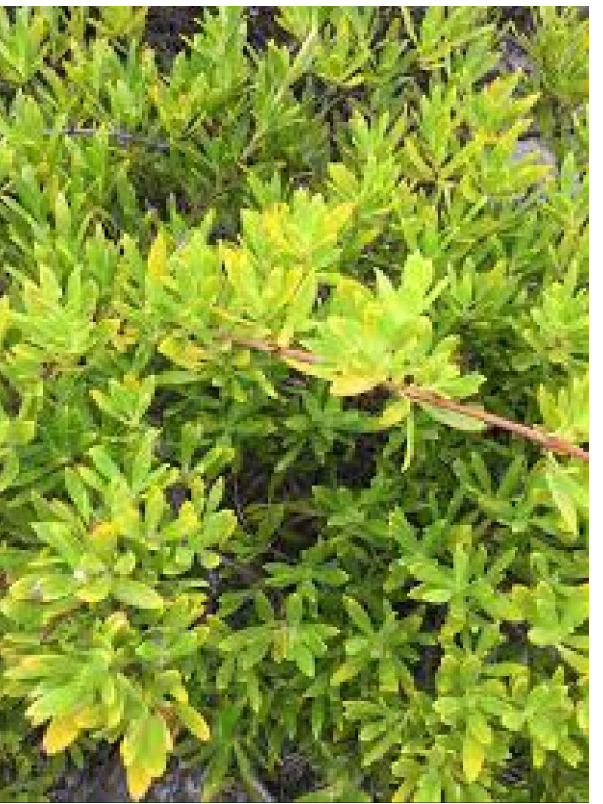

Ernodea littoralis Sw.



Jasminum simplicifolium



GRAPHIC SCALE



N

PARAMETRIKA LAND & DESIGN  
Gabriela Albomoz  
Valeria Quintanilla LA6667640



1425 Marseille Dr  
1425 Marseille Dr  
Miami Beach, FL 33141

Rev #3: 04/05/2025

SHEET TITLE  
Landscape plan (2nd floor)

ISSUE DATE  
03/30/2024

REVISION  
March, 2024

DESIGN  
GA

DRAWN  
TY

SCALE  
1/8" = 1'-0"

SEAL

VALERIA QUINTANILLA  
LA6667640

SHEET NUMBER  
L-102.3



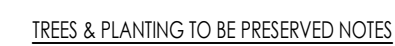
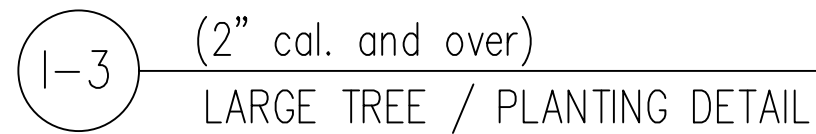
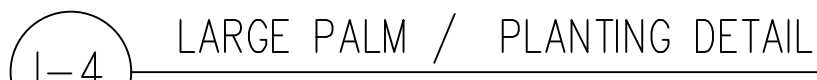
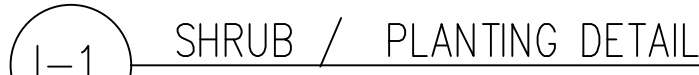

**PARAMETRIKA LAND & DESIGN**  
Gabriela Albornoz  
Valeria Quintanilla LA6667640



**1425 Marseille Dr**  
1425 Marseille Dr  
Miami Beach, FL 33141

☒ Rev #3: 04/05/2025

SHEET TILE

**Landscape details and notes**

ISSUE DATE  
03/30/2024

REVISION  
March, 2024

DESIGN  
GA

DRAWN  
TY

SCALE  
N/A

SEAL

VALERIA QUINTANILLA  
LA6667640

SHEET NUMBER

**L-103**

LANDSCAPE LEGEND					
INFORMATION REQUIRED TO BE PERMANENTLY AFFIXED TO PLANS					
Transect Zone:	RS-4	Lot Area	8,398.79	Acres	0.192
<u>OPEN SPACE</u>					REQUIRED/ PROVIDED ALLOWED
A. Square feet of required Open Space, as indicated on site plan: Lot Area = 8,398.79 x 1 x 50 % = 4,200					4,200 7,706
B. Square feet of parking lot open space required by Article 9, as indicated on site plan Number of parking spaces _____ x 10 x f.p. per parking space=					4,200 7,706
C. Total square feet of landscaped open space required: A+B=					4,200 7,706
<u>LAWN AREA CALCULATION</u>					
A. Square feet of landscaped open space required:					4,200 7,706
B. Maximum lawn area (sod) permitted = 50 % x 7,706 = f.f.					3,853 2,150
<u>TREES</u>					
A. Number of trees required per net lot acre, less existing number of trees meeting minimum requirements = _____ trees x _____ net lot acres – number of existing trees =					8 8 (2 ex.)
B. % Palms allowed: Number of trees provided x 30% =					2 10 (6 ex.)
C. % Natives required: Number of trees provided x 50% =					3 3
D. % Drought tolerant and low maintenance: Number of trees provided x 20% =					2 5
E. Street Trees (maximum average spacing of 20' o.c.): _____ 62 _____ linear feet along street / 20' =					3 3 (1 ex.)
% Palms permitted to count towards street trees on 1:1 basis x 30%:					
F. Street trees located directly beneath power lines: (maximum average spacing of 25' o.c.): _____ linear feet along street / 25 =					
<u>SHRUBS</u>					
A. Number of shrubs required: Number of trees required x 12 =					144 463
B. % Native shrubs required: Number of shrubs required x 50% =					75 108
<u>LARGE SHRUBS OR SMALL TREE</u>					
A. Number of large shrubs or small trees required: Number of shrubs required x 10% =					14 82
B. % Native large shrubs or small trees required: Number of large shrubs or small trees required x 50% =					7 28

3

## LANDSCAPE NOTES

2. Non Cypress variety mulch shall extend under all trees, shrubs and ground cover beneath to the closest hard edge or soil border, in a minimum of 3" depth. All Cypress shall meet the minimum standard of Florida No. 1 or better as specified in Grade and Standards for Nursery Plants as published by the Division of Plant Industry, Florida Department of Agriculture, latest edition.
3. All shrubs to be a minimum of 24", and ground covers a minimum of 12" from the edge of walks, building walls, pond's edge, etc.... Ixora Nana and Rhapsodiopsis should be planted 30" form edge of walkways.
4. All trees and palms over 8" in height shall be braced to prevent lateral movement for a period of six months from the date of planting. Either wood braces or shown in the planting detail, or the wire and turnbuckle method shall be used. No nails, screws, metal straps or wires are to be used directly against the trees or palms trunks.
5. All palms except for species such as Coccoth, Acoelorrhaphis, Rophis, and other mulittrunk palms, shall have straight trunks. free of scars, decay, or other damage caused by digging, transport or planting handling of the same.
6. All work by the Landscape Contractor shall be performed in a professional and sound manner in accordance with established standards of landscape installation practices and workmanship.
7. Landscape Contractor is responsible for verifying plant quantities prior to bidding. Quantities shown in the plans may vary due to actual site scope, job conditions, etc.... Landscape Architect assumes no responsibility for the actual plant count necessary for the successful completion of the work.
8. Landscape Contractor and his subcontractors shall be licensed and insured as required by the municipality, county, state or any other governmental agency requiring a license or insurance in order for the Landscape Contractor to perform his work.
9. All work shall conform to Miami-Dade County's landscape ordinance Chapter 18-A, ordinance 98-13, and any other municipal landscape ordinance in effect at the project's location, including street-trees.
10. Landscape Contractor is required to procure and obtain any necessary permits applicable for the successful completion of this project, if applicable.
11. Landscape material shall not be allowed to grow in such a manner as to impede streetfront line of visibility to property owner or neighbors, so as to materially impede vision between a height of 3 feet and 8 feet.
12. Landscape Contractor shall call Sunshine State One Call Center of Florida at 1-800-432-4770 [Toll Free] 48 hours before digging.
13. Landscape Contractor is responsible for inspecting the site and physically observing all the site conditions prior to entering into Agreements or Contract with Owner. Landscape Contractor shall coordinate his work with the General Contractor of Construction Manager in such a manner as to allow for a speedy and efficient completion of all work on the site.
14. Any excess soil, landscape materials and debris from the landscape Contractor's work shall be removed from the site immediately upon completion of his work.
15. Landscape Contractor shall coordinate the proposed planting in the Planting Plan with the work required in recoloring and removal of trees in sheet I-1 (Betting Trees).
16. One year warranty





Bursera simaruba



Conocarpus erectus  
'sericeus'



Coccoloba uvifera



Elaeocarpus  
decipiens

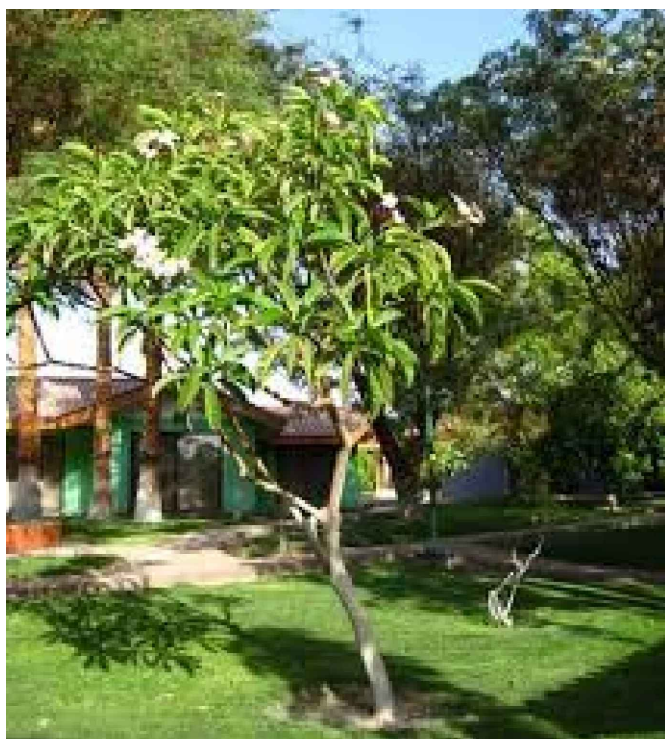

Plumeria  
Rubra



Conocarpus erectus



Dypsis cabadae



Pseudophoenix  
sargentii



Ptychosperma  
elegans



Thrinax radiata



Aglaonema nitidum



Alocasia 'Calidora'



Asparagus  
densiflorus 'Myers'



Begonia  
sempperflorens



Bulbine frutescens

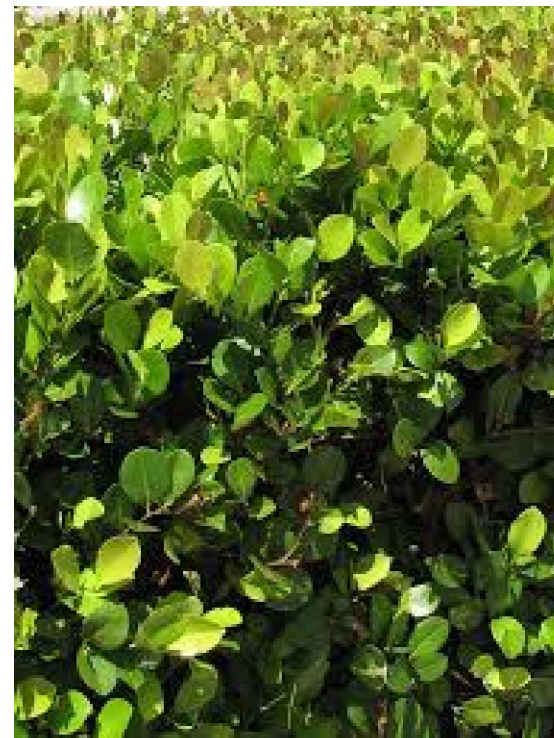

Chrysobalanus icaco  
'Green'



Cycas revoluta



Dioon mejiae



Heliconia caribea

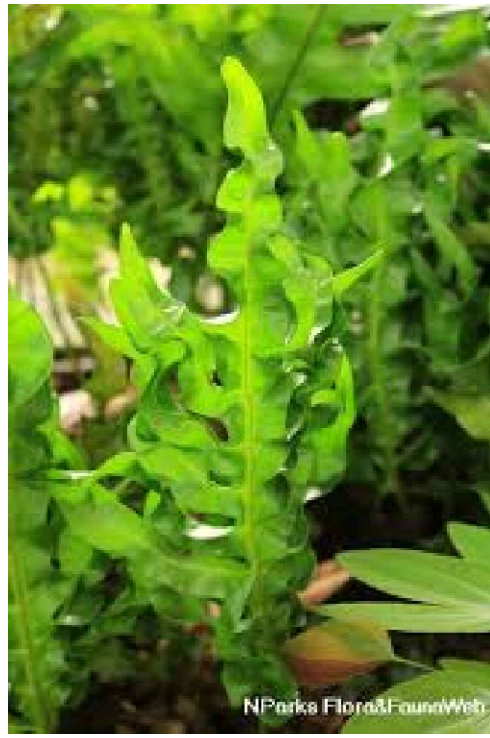

Microsorium  
scolopendrium

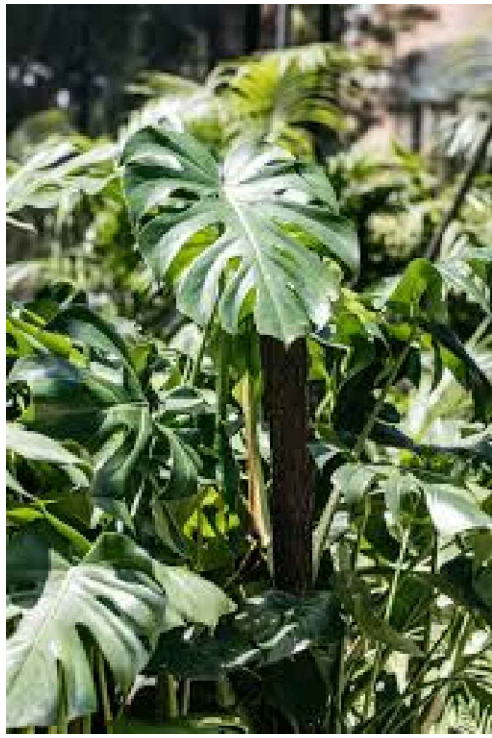

Monstera deliciosa



Nephrolepis  
oblitterata

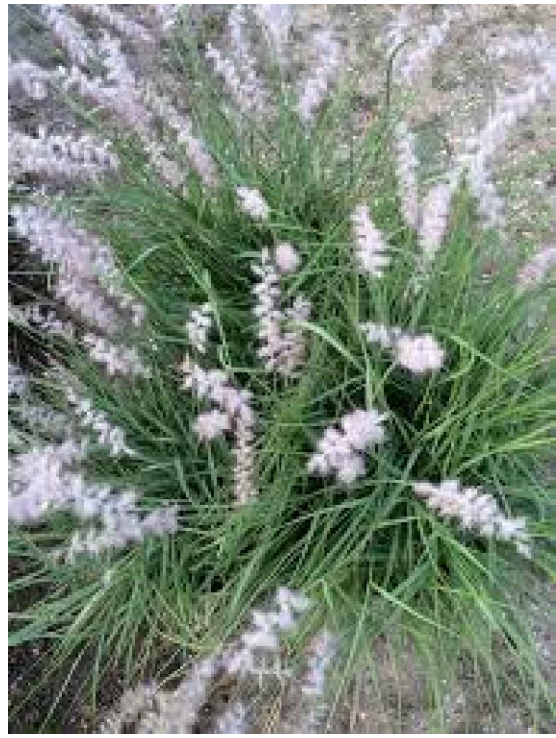

Pennisetum orientale



Philodendron xanadu



Podocarpus  
macrophyllus



Radermachera sinica



Serenoa repens



Spartina bakeri



Strelitzia reginae



Spathoglottis plicata



Tripsacum floridanum

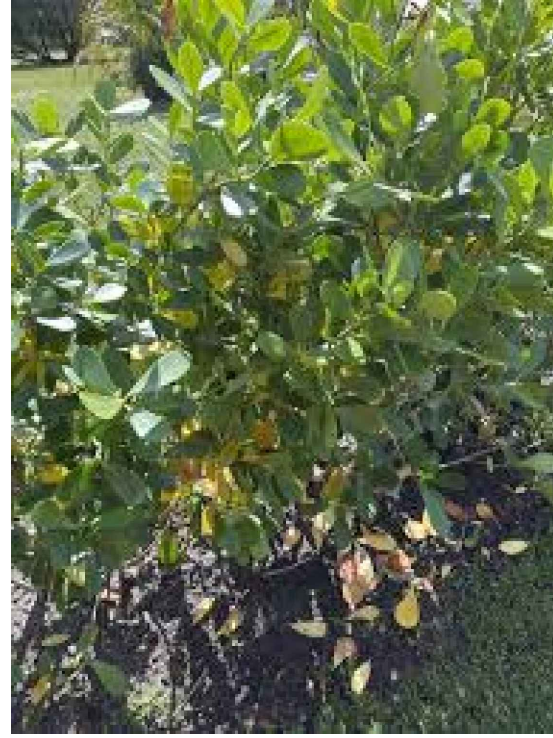

Clusia guttifera



Eugenia foetida

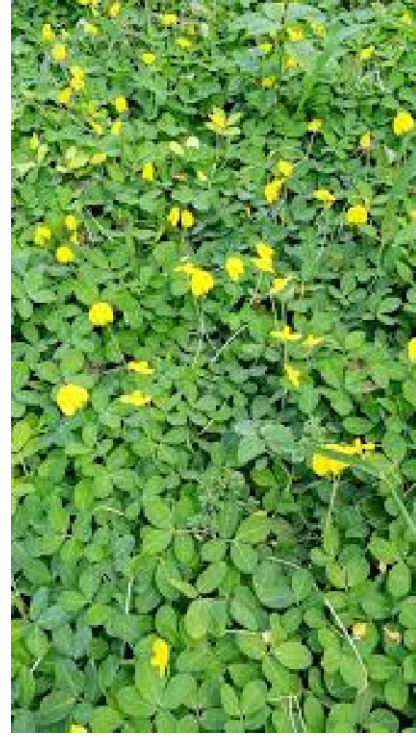

Arachis  
glabrata



Carissa macrocarpa

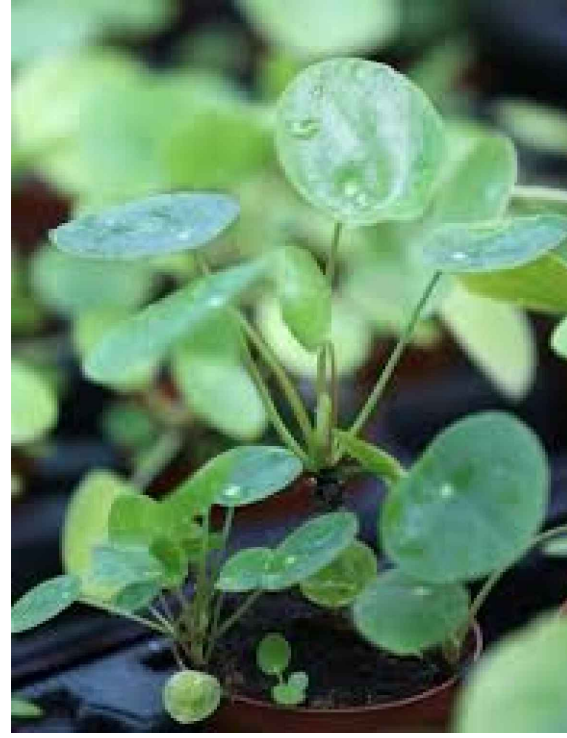

Pilea peperomioides

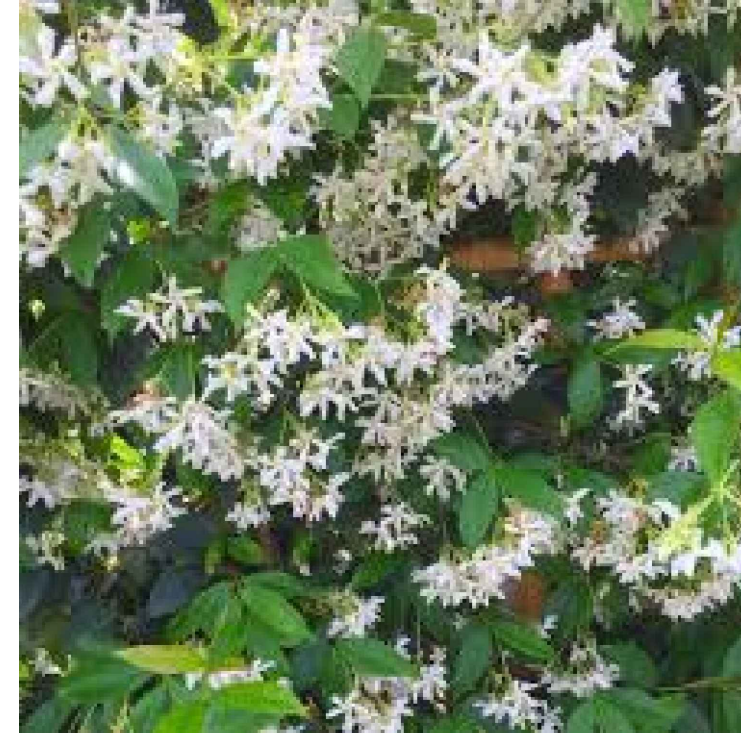

Trachelospermum  
asiaticum

PARAMETRIKA LAND & DESIGN  
Gabriela Albomoz  
Valeria Quintanilla LA6667640

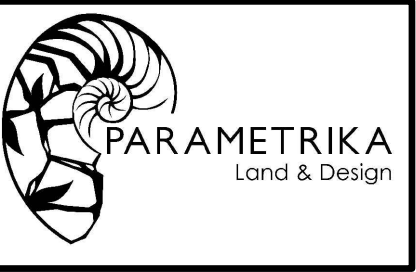

1425 Marseille Dr  
1425 Marseille Dr  
Miami Beach, FL 33141

SHEET TITLE  
Plant material

ISSUE DATE  
02/18/2024

REVISION  
FEBRUARY, 2024

DESIGN  
GA

DRAWN  
TY

SCALE  
N/A

SEAL  
VALERIA QUINTANILLA  
LA6667640

SHEET NUMBER  
L-104