

HISTORIC PRESERVATION BOARD LANDSCAPE SET

FOR

ROYAL PALM HOTEL

1545 COLLINS AVE , MIAMI BEACH, FL 33137
4 AUGUST 2024



SCALE: 1" = 40'

LANDSCAPE ARCHITECT:

Kimley»Horn

© 2022 KIMLEY-HORN AND ASSOCIATES, INC.
2 ALHAMBRA PLAZA, SUITE 500, MIAMI, FL, 33134
PHONE: 305-673-2025
WWW.KIMLEY-HORN.COM CA 00000696

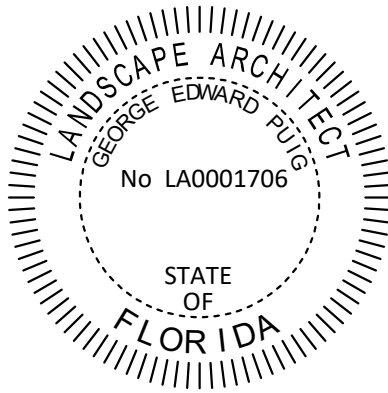

THIS ITEM HAS BEEN DIGITALLY SIGNED AND
SEALED BY GEORGE EDWARD PUIG, P.L.A.
LA0001706 ON DATE ADJACENT TO SEAL.
PRINTED COPIES OF THIS DOCUMENT ARE
NOT CONSIDERED SIGNED AND SEALED AND
THE SIGNATURE MUST BE VERIFIED ON ANY
ELECTRONIC COPIES.
THE SEAL APPEARING ON THIS DOCUMENT
WAS AUTHORIZED BY GEORGE EDWARD PUIG
LA0001706 ON THE DATE ADJACENT TO THE
SEAL.

EoA
ARCHITECTURE | INTERIORS | BRANDING | MASTER PLANNING | LANDSCAPE

Gensler
Kimley»Horn

ROYAL PALM HOTEL, MIAMI BEACH
1545 COLLINS AVE., MIAMI BEACH, FL 33139
HPB SET

AUGUST / 04 / 2024: FINAL SUBMITTAL

E o A , I n c | 1929 Ponce de Leon Blvd., Coral Gables, Florida 33146 | 3 0 5 . 4 4 4 . 0 9 9 0 | State of Florida Architect of Record Malcolm Berg, AIA License No. AR94424

COVER SHEET



sheet no.

L-000

SCALE: AS NOTED

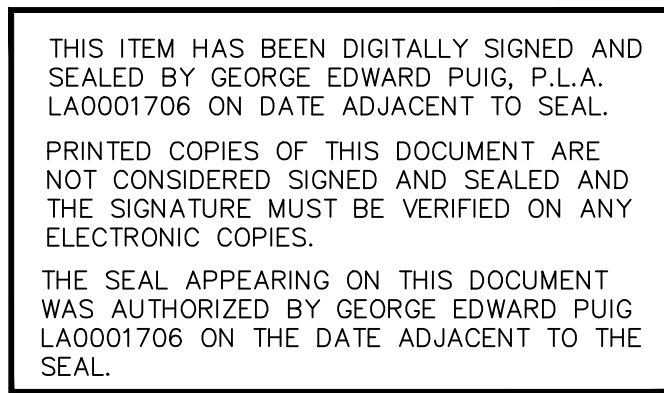

1. LIMITS OF SCOPE OF WORK IS TREE DISPOSITION, HARDSCAPE, AND PLANTING WITHIN THE SITE.
2. CONTRACTOR SHALL SCHEDULE A PRE-CONSTRUCTION MEETING WITH OWNERSHIP, ARCHITECT, AND LANDSCAPE ARCHITECT FOR PRIOR TO CONSTRUCTION.
3. CONTRACTOR SHALL BE RESPONSIBLE FOR VISITING SITE PRIOR TO BIDDING IN ORDER TO FAMILIARIZE THEMSELVES WITH ALL EXISTING CONDITIONS AFFECTING THE WORK, INCLUDING BUT NOT LIMITED TO, PRIVATE AND PUBLIC UTILITIES ON AND OFFSITE, EXISTING DRAINAGE, ETC.
4. CONTRACTOR SHALL NOTIFY OWNERSHIP AND THE LANDSCAPE ARCHITECT IN WRITING IMMEDIATELY OF ANY EXPECTED OR UNKNOWN CONDITIONS OR DISCREPANCIES OR AMBIGUITIES IN THE DRAWINGS OR SPECIFICATIONS, AS WELL AS ERRORS OR OMISSIONS ON THE DRAWINGS PRIOR TO PROCEEDING WITH THE WORK OR SHOP FABRICATION.
5. CONTRACTOR SHALL COORDINATE ABE IN COMPLIANCE WITH ALL STATE AND LOCAL CODES AS WARRANTED.
6. ANY DISCREPANCIES FOUND BETWEEN THE DRAWINGS AND SPECIFICATIONS AND EXISTING SITE CONDITIONS OR ANY INCONSISTENCIES OR AMBIGUITIES IN DRAWINGS OR SPECIFICATIONS SHALL BE IMMEDIATELY REPORTED TO THE LANDSCAPE ARCHITECT, IN WRITING, WHO SHALL PROMPTLY ADDRESS SUCH INCONSISTENCIES OR AMBIGUITIES. WORK DONE BY THE CONTRACTOR AFTER HIS DISCOVERY OF SUCH DISCREPANCIES, INCONSISTENCIES, OR AMBIGUITIES SHALL BE PERFORMED AT THE CONTRACTOR'S RISK.
7. DEVIATION FROM THESE PLANS AND NOTES WITHOUT THE PRIOR CONSENT OF THE OWNER, OR THE LANDSCAPE ARCHITECT, MAY BE CAUSE FOR THE WORK TO BE DESIGNATED UNACCEPTABLE.
8. THE CONTRACTOR ACKNOWLEDGES & AGREES THAT THE WORK IS ENTIRELY AT HIS RISK UNTIL SITE IS ACCEPTED, AND HE WILL BE HELD RESPONSIBLE FOR ITS SAFETY BY THE OWNER.
9. THE CONTRACTOR WILL BE HELD RESPONSIBLE FOR THE DAMAGE OR LOSS OF ANY REFERENCE POINTS AND HUBS DURING THE CONSTRUCTION OF HIS WORK, AND SHALL BEAR THE COST OF REPLACING SAME.
10. THE CONTRACTOR IS RESPONSIBLE FOR HORIZONTALLY AND VERTICALLY LOCATING AND PROTECTING ALL PUBLIC AND PRIVATE UTILITIES WHICH LIE IN OR ADJACENT TO THE CONSTRUCTION SITE AT LEAST 48 HOURS PRIOR TO ANY DEMOLITION, GRADING, OR CONSTRUCTION ACTIVITY (CALL SUNSHINE DIG/CALL - 811).
11. THE CONTRACTOR SHALL SALVAGE AND PROTECT ALL EXISTING POWER POLES, SIGNS, MANHOLES, TELEPHONE RISERS, WATER VALVES, ETC., DURING ALL CONSTRUCTION PHASES UNLESS NOTED OTHERWISE. THE CONTRACTOR SHALL REPAIR, AT HIS OWN EXPENSE, ANY EXISTING UTILITIES DAMAGED DURING CONSTRUCTION.
12. ANY FOREIGN ITEM FOUND DURING CONSTRUCTION IS THE PROPERTY OF THE OWNER. THIS INCLUDES, BUT IS NOT LIMITED TO, PRECIOUS METALS, COINS, PAPER CURRENCY, ARTIFACTS AND ANTIQUITIES.
13. ALL SURPLUS EXCAVATION SHALL BE TAKEN TO A SITE DESIGNATED BY OWNER, AT NO ADDITIONAL COST TO THE OWNER. IF OWNER CHOOSES, THE CONTRACTOR MAY TAKE POSSESSION OF SURPLUS EXCAVATION MATERIAL.
14. CONTRACTOR IS RESPONSIBLE FOR VERIFYING AND/OR OBTAINING ALL REQUIRED PERMITS AND APPROVALS PRIOR TO COMMENCING CONSTRUCTION.
15. CONTRACTOR IS TO MAINTAIN CONTROLLED PEDESTRIAN AND ADA ACCESS THROUGH ALL AREAS OF THE SITE THROUGHOUT CONSTRUCTION PERIOD.
16. MAINTAIN THE SITE IN A NEAT AND ORDERLY CONDITION AT ALL TIMES. DAILY, AND MORE OFTEN IF NECESSARY, INSPECT & AND PICK UP ALL SCRAP, DEBRIS, & WASTE MATERIAL.
17. IT IS THE RESPONSIBILITY OF THE CONTRACTOR TO REMOVE ALL MUD, DIRT, GRAVEL AND OTHER MATERIALS TRACKED ONTO ANY PRIVATE OR PUBLIC STREETS OR SIDEWALKS. THE CONTRACTOR MUST CLEAN THESE DAILY, IF NECESSARY. THE CONTRACTOR MUST USE WATER OR OTHER ACCEPTABLE METHODS TO KEEP AIRBORNE DUST TO A REQUIRED MINIMUM.
18. PROVIDE PROTECTION TO ALL FINISHED WORK. MAINTAIN SURFACES CLEAN, UNMARRED, AND SUITABLY PROTECTED UNTIL ACCEPTANCE BY OWNER.
19. THE CONTRACTOR SHALL BE RESPONSIBLE FOR REPAIRING ANY DAMAGE RESULTING FROM CONSTRUCTION ACTIVITY TO EXISTING ELEMENTS THAT ARE TO REMAIN.
20. EROSION CONTROL MEASURES (IE: SILT FENCING AND SEDIMENT CONTROL) SHALL BE MAINTAINED BY THE CONTRACTOR PER CIVIL SPECIFICATIONS. ANY EROSION CONTROL MEASURES DAMAGED BY THE CONTRACTOR SHALL BE REPLACED PER CIVIL SPECIFICATIONS.
21. CONTRACTOR SHALL VERIFY LOCATION, SIZE AND ELEVATION OF EXISTING UTILITIES, STRUCTURES, PIPES, PAVEMENTS, ETC. AS RELATED TO HIS WORK. NOTIFY LANDSCAPE ARCHITECT OF ANY CONFLICT AND/OR DISCREPANCIES IN THE CONSTRUCTION DOCUMENTS, PRIOR TO THE START OF CONSTRUCTION.
22. ALL GENERAL CONDITIONS, SUPPLEMENTARY GENERAL CONDITIONS AND TECHNICAL SPECIFICATIONS OF THE CONTRACT SHALL APPLY.
23. ALL AREAS OUTSIDE THE LIMITS OF CONSTRUCTION LINE OR TREE CRITICAL ROOT ZONES SHALL NOT BE CROSSED BY HEAVY EQUIPMENT OR USED FOR STORING ANY EQUIPMENT OR MATERIALS.

- ARCH. = ARCHITECT/ARCHITECTURE
- TG = TOP OF GRADE
- TW = TOP OF WALL
- TPW = TOP OF PLANTER WALL
- FF = FINISH FLOOR ELEVATION
- AFF = ABOVE FINISH FLOOR
- P.L. = PROPERTY LINE
- M.L. = MONUMENT LINE
- C.L. = CENTER LINE
- CONC. = CONCRETE
- STRUC. = STRUCTURAL / STRUCTURE
- ENG. = ENGINEER / ENGINEERING
- LA = LANDSCAPE ARCHITECT
- DWGS = DRAWINGS
- TYP = TYPICAL
- EXIST = EXISTING
- HSCP = HARDSCAPE
- LSCP = LANDSCAPE
- PLNT = PLANTING
- PLTR = PLANTER
- REF = REFER TO
- TOL = TOLERANCE
- DBH= DIAMETER AT BREAST HEIGHT
- CT = CLEAR TRUNK



E o A , I n c | 1929 Ponce de Leon Blvd., Coral Gables, Florida 33146 | 3 0 5 . 4 4 4 . 0 9 9 0 | State of Florida Architect of Record Malcolm Berg, AIA License No. AR94424

Sheet Number	Sheet Title
L-000	COVER SHEET
L-001	SHEET INDEX
L-200	OVERALL TREE DISPOSITION PLAN
L-201	PARTIAL TREE DISPOSITION PLAN
L-202	PARTIAL TREE DISPOSITION PLAN
L-203	PARTIAL TREE DISPOSITION PLAN
L-250	TREE DISPOSITION LIST AND CHARTS
L-251	TREE DISPOSITION NOTES AND DETAILS
L-300	OVERALL HARDSCAPE PLAN
L-301	ENLARGED HARDSCAPE PLAN
L-302	ENLARGED HARDSCAPE PLAN
L-303	ENLARGED HARDSCAPE PLAN
L-331	OCEANFRONT OVERLAY DIAGRAM
L-350	HARDSCAPE MATERIALS
L-400	OVERALL LANDSCAPE PLAN
L-401	ENLARGED LANDSCAPE PLAN
L-402	ENLARGED LANDSCAPE PLAN
L-403	ENLARGED LANDSCAPE PLAN
L-410	LANDSCAPE SCHEDULE AND LANDSCAPE LEGEND
L-450	LANDSCAPE MATERIALS

HARDSCAPE GRAPHIC LEGEND			
SYMBOL		DESCRIPTION	
		PLANTING AREA	
		VEHICULAR RATED FLAGSTONE PAVING	

2024.08.4 | HPB SET FIRST SUBMITTAL

SCALE: AS NOTED

L-201

L-202

L-203

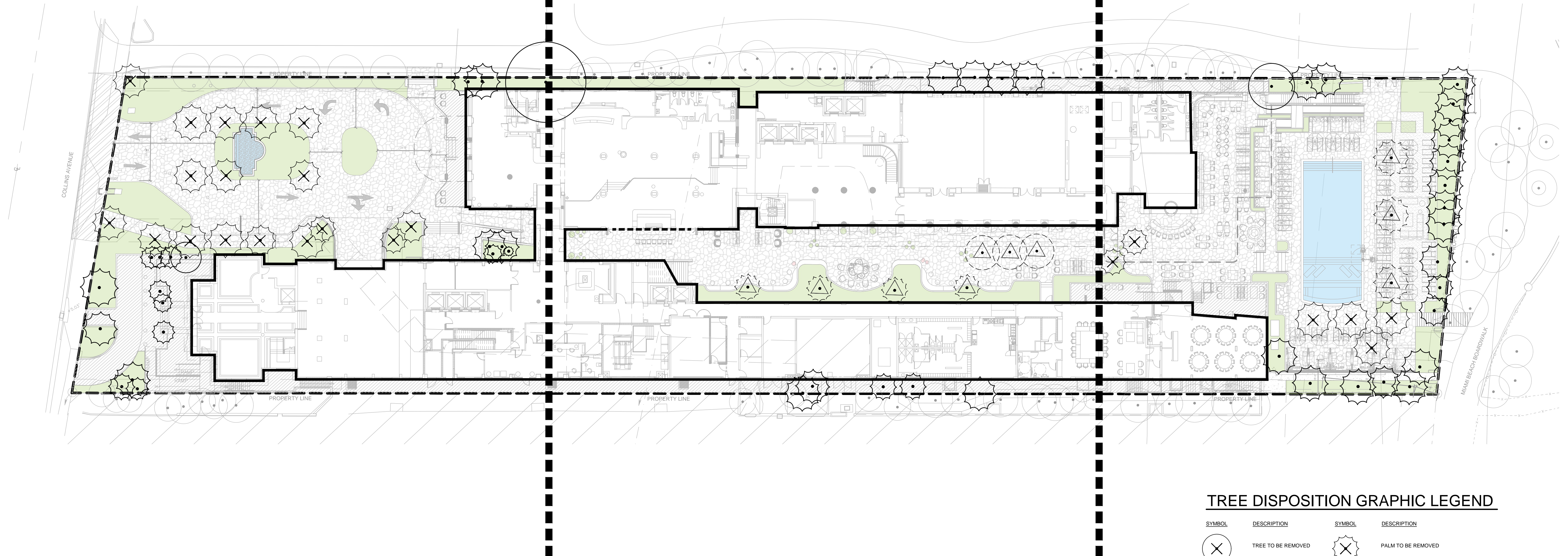

TREE DISPOSITION GRAPHIC LEGEND

SYMBOL	DESCRIPTION	SYMBOL	DESCRIPTION
	TREE TO BE REMOVED		PALM TO BE REMOVED
	TREE TO REMAIN		PALM TO REMAIN
	TREE TO BE RELOCATED		PALM TO BE RELOCATED
	EXISTING TREE OR PALM NOT IN SCOPE		

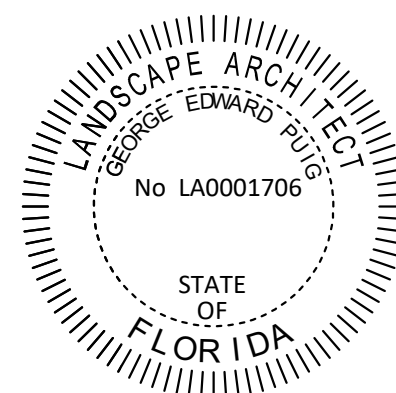

THIS ITEM HAS BEEN DIGITALLY SIGNED AND SEALED BY GEORGE EDWARD PUIG, P.L.A. LA0001706 ON DATE ADJACENT TO SEAL.
PRINTED COPIES OF THIS DOCUMENT ARE NOT CONSIDERED SIGNED AND SEALED AND THE SIGNATURE MUST BE VERIFIED ON ANY ELECTRONIC COPIES.
THE SEAL APPEARING ON THIS DOCUMENT WAS AUTHORIZED BY GEORGE EDWARD PUIG LA0001706 ON THE DATE ADJACENT TO THE SEAL.



EoA
ARCHITECTURE | INTERIORS | BRANDING | MASTER PLANNING | LANDSCAPE

Gensler
Kimley»Horn

ROYAL PALM HOTEL, MIAMI BEACH
1545 COLLINS AVE., MIAMI BEACH, FL 33139
HPB SET

AUGUST / 04 / 2024: FINAL SUBMITTAL

E o A , I n c | 1929 Ponce de Leon Blvd., Coral Gables, Florida 33146 | 3 0 5 . 4 4 4 . 0 9 9 0 | State of Florida Architect of Record Malcolm Berg, AIA License No. AR94424

OVERALL TREE
DISPOSITION PLAN







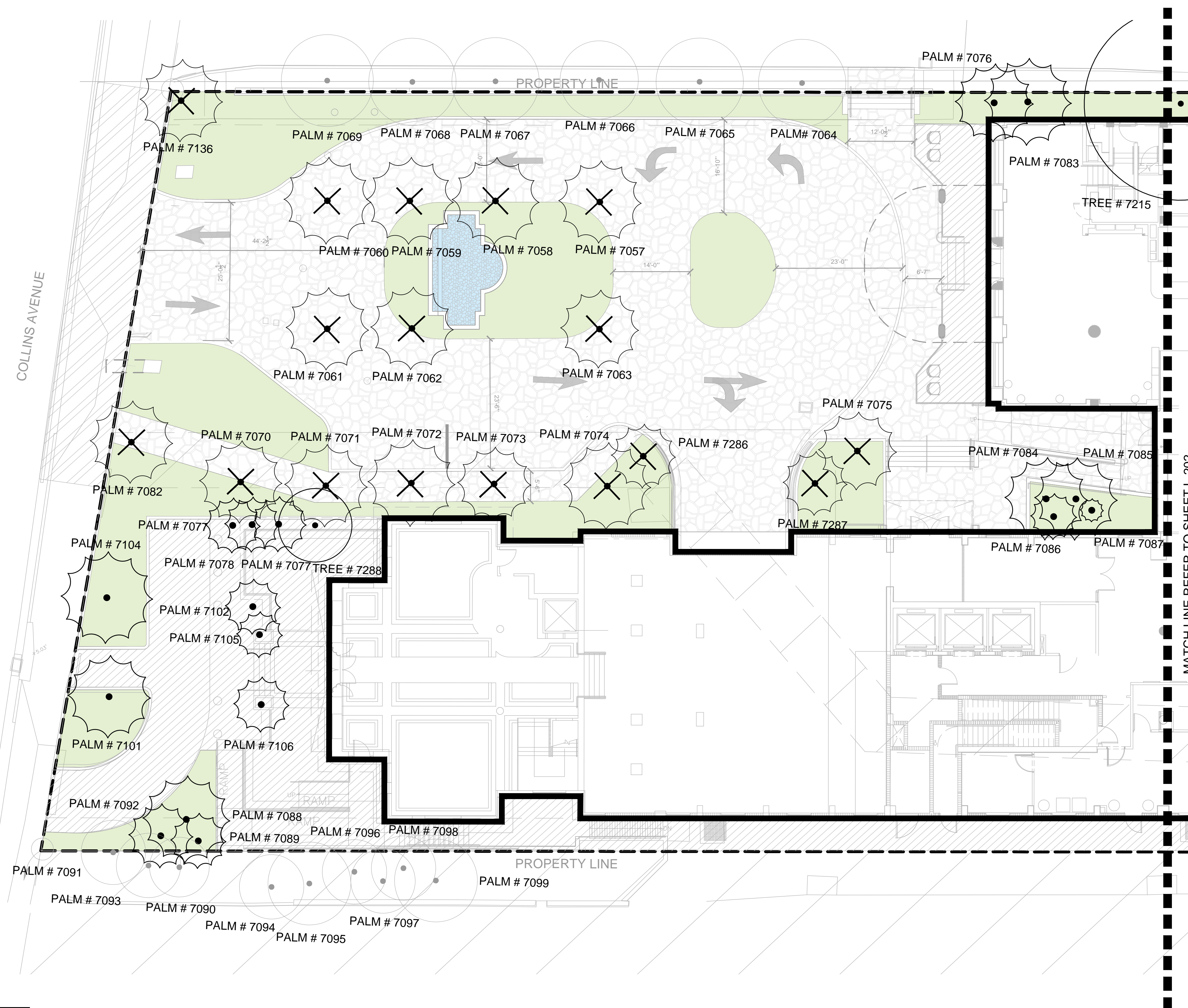

sheet no.
L-200

SCALE: AS NOTED

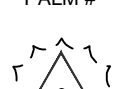

TREE DISPOSITION GRAPHIC LEGEND

<u>SYMBOL</u>	<u>DESCRIPTION</u>	<u>SYMBOL</u>	<u>DESCRIPTION</u>
	TREE TO BE REMOVED		PALM TO BE REMOVED
	TREE TO REMAIN		PALM TO REMAIN
	TREE TO BE RELOCATED		PALM TO BE RELOCATED
	EXISTING TREE OR PALM NOT IN SCOPE		

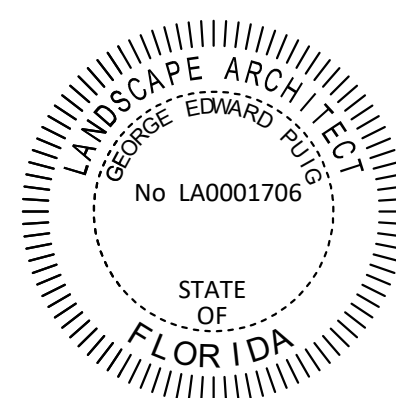
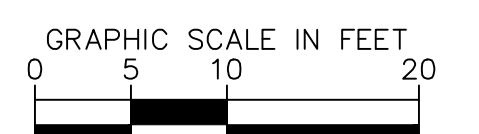

THIS ITEM HAS BEEN DIGITALLY SIGNED AND
SEALED BY GEORGE EDWARD PUIG, P.L.A.
LA0001706 ON DATE ADJACENT TO SEAL.

PRINTED COPIES OF THIS DOCUMENT ARE
NOT CONSIDERED SIGNED AND SEALED AND
THE SIGNATURE MUST BE VERIFIED ON ANY
ELECTRONIC COPIES.

THE SEAL APPEARING ON THIS DOCUMENT
WAS AUTHORIZED BY GEORGE EDWARD PUIG
LA0001706 ON THE DATE ADJACENT TO THE
SEAL.

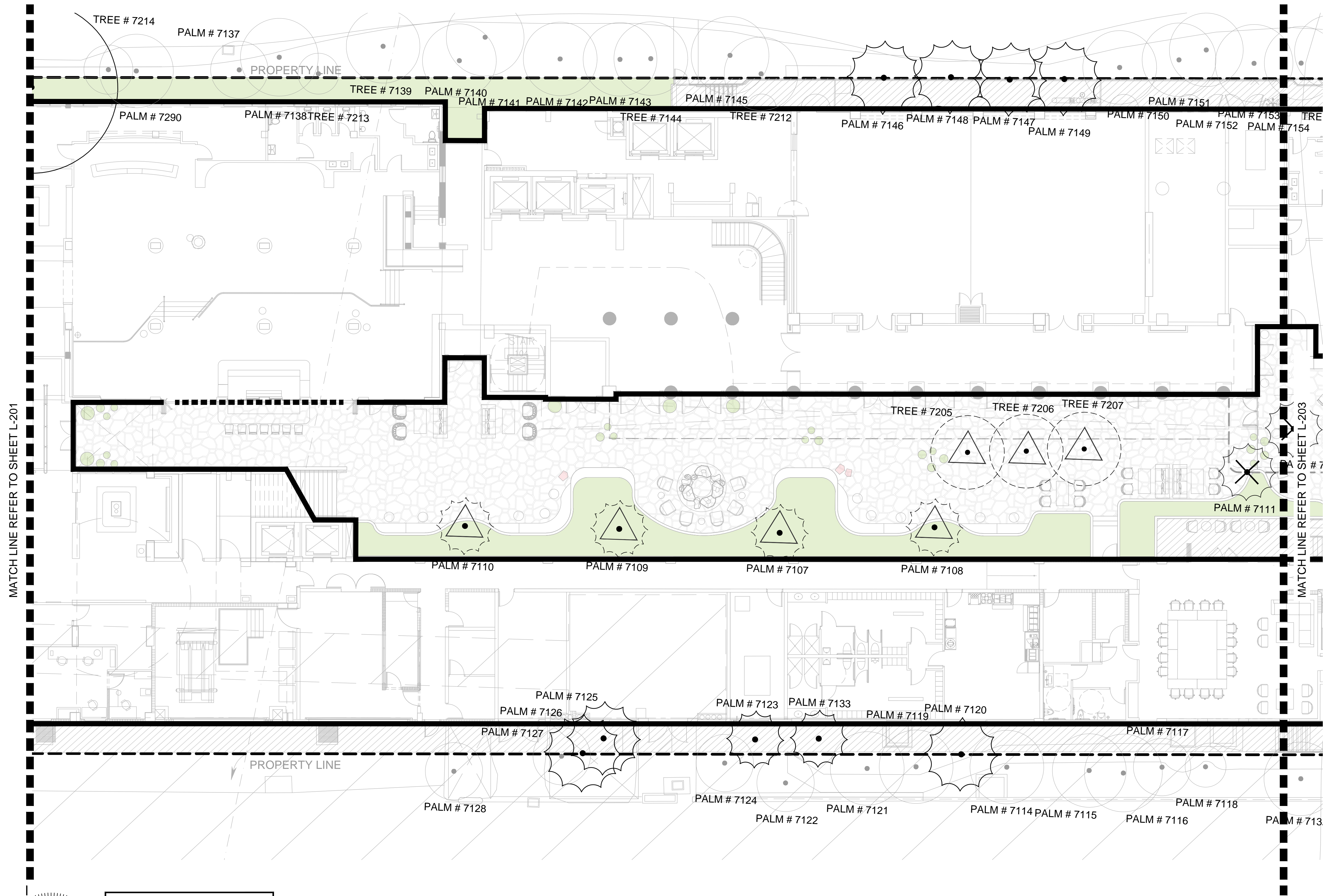

TREE DISPOSITION GRAPHIC LEGEND

SYMBOL	DESCRIPTION	SYMBOL	DESCRIPTION
	TREE # TREE TO BE REMOVED		PALM # PALM TO BE REMOVED
	TREE # TREE TO REMAIN		PALM # PALM TO REMAIN
	TREE # TREE TO BE RELOCATED		PALM # PALM TO BE RELOCATED

LANDSCAPE ARCHITECT
GEORGE EDWARD PUIG, P.L.A.
No LA0001706
STATE OF FLORIDA

THIS ITEM HAS BEEN DIGITALLY SIGNED AND SEALED BY GEORGE EDWARD PUIG, P.L.A. LA0001706 ON DATE ADJACENT TO SEAL.
PRINTED COPIES OF THIS DOCUMENT ARE NOT CONSIDERED SIGNED AND SEALED AND THE SIGNATURE MUST BE VERIFIED ON ANY ELECTRONIC COPIES.
THE SEAL APPEARING ON THIS DOCUMENT WAS AUTHORIZED BY GEORGE EDWARD PUIG LA0001706 ON THE DATE ADJACENT TO THE SEAL.

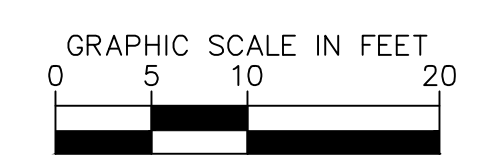

ROYAL PALM HOTEL, MIAMI BEACH
1545 COLLINS AVE., MIAMI BEACH, FL 33139
HPB SET

PARTIAL TREE
DISPOSITION PLAN

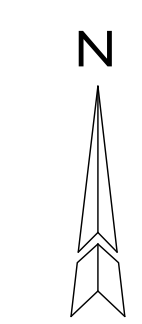

sheet no.
L-202

SCALE: AS NOTED



MATCH LINE REFER TO SHEET L-202

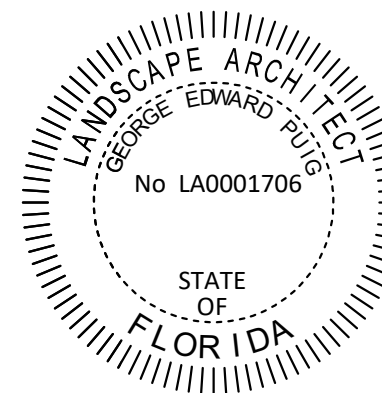

THIS ITEM HAS BEEN DIGITALLY SIGNED AND SEALED BY GEORGE EDWARD PUIG, P.L.A., LA0001706 ON DATE ADJACENT TO SEAL.
PRINTED COPIES OF THIS DOCUMENT ARE NOT CONSIDERED SIGNED AND SEALED AND THE SIGNATURE MUST BE VERIFIED ON ANY ELECTRONIC COPIES.
THE SEAL APPEARING ON THIS DOCUMENT WAS AUTHORIZED BY GEORGE EDWARD PUIG LA0001706 ON THE DATE ADJACENT TO THE SEAL.

TREE DISPOSITION GRAPHIC LEGEND

SYMBOL	DESCRIPTION	SYMBOL	DESCRIPTION
	TREE # TREE TO BE REMOVED		PALM # PALM TO BE REMOVED
	TREE # TREE TO REMAIN		PALM # PALM TO REMAIN

TREE DISPOSITION GRAPHIC LEGEND

SYMBOL	DESCRIPTION	SYMBOL	DESCRIPTION
	TREE # TREE TO BE RELOCATED		PALM # PALM TO BE RELOCATED
	TREE # EXISTING TREE OR PALM NOT IN SCOPE		

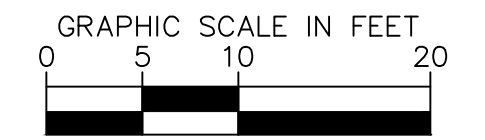

ROYAL PALM HOTEL, MIAMI BEACH 1545 COLLINS AVE., MIAMI BEACH, FL 33139 HPB SET

AUGUST / 04 / 2024: FINAL SUBMITTAL

PARTIAL TREE DISPOSITION PLAN



sheet no.

L-203

SCALE: AS NOTED

TREE DISPOSITION LIST

TREE	COMMON NAME	SCIENTIFIC NAME	DBH (in.)	HEIGHT (FT.)	CANOPY DIAMETER (FT.)	CONDITION	NOTES	DISPOSITION	MITIGATION REQUIRED
1396	Coconut Palm	Cocos nucifera	14	17	0	Good	Dead, no foliage observed	REMAIN	N/A
1398	Coconut Palm	Cocos nucifera	14	22	14	Good		REMAIN	N/A
1399	Coconut Palm	Cocos nucifera	14	22	14	Good		REMAIN	N/A
1400	Coconut Palm	Cocos nucifera	14	20	14	Good		REMAIN	N/A
1401	Coconut Palm	Cocos nucifera	14	21	13	Good		REMAIN	N/A
1402	Coconut Palm	Cocos nucifera	14	22	14	Good		REMAIN	N/A
1405	Coconut Palm	Cocos nucifera	13	20	15	Good		REMAIN	N/A
1406	Coconut Palm	Cocos nucifera	14	18	14	Good		REMAIN	N/A
1407	Coconut Palm	Cocos nucifera	12	17	13	Good		REMAIN	N/A
1425	Coconut Palm	Cocos nucifera	13	16	12	Good		REMAIN	N/A
1427	Coconut Palm	Cocos nucifera	12	18	14	Good		REMAIN	N/A
1428	Coconut Palm	Cocos nucifera	12	15	12	Good		REMAIN	N/A
1430	Coconut Palm	Cocos nucifera	12	15	12	Good		REMAIN	N/A
1434	Coconut Palm	Cocos nucifera	13	20	16	Good		REMAIN	N/A
1459	Coconut Palm	Cocos nucifera	14	17	15	Good		REMAIN	N/A
1557	Coconut Palm	Cocos nucifera	12	17	13	Good		REMAIN	N/A
1568	Coconut Palm	Cocos nucifera	13	22	16	Good		REMAIN	N/A
1568	Coconut Palm	Cocos nucifera	12	14	12	Good		REMAIN	N/A
7057	Royal Palm	Roystonea regia	14	26	15	Good		REMOVE	NO
7058	Royal Palm	Roystonea regia	14	26	16	Good		REMOVE	NO
7059	Royal Palm	Roystonea regia	14	26	16	Good		REMOVE	NO
7060	Royal Palm	Roystonea regia	14	26	16	Good		REMOVE	NO
7061	Royal Palm	Roystonea regia	14	26	15	Good		REMOVE	NO
7062	Royal Palm	Roystonea regia	14	26	15	Good		REMOVE	NO
7063	Royal Palm	Roystonea regia	13	26	13	Good		REMOVE	NO
7064	Royal Palm	Roystonea regia	14	29	16	Good		REMOVE	NO
7065	Royal Palm	Roystonea regia	14	29	16	Good		REMAIN	N/A
7066	Royal Palm	Roystonea regia	15	28	14	Fair	Foliage exhibits stress	REMAIN	N/A
7067	Royal Palm	Roystonea regia	15	29	16	Good		REMAIN	N/A
7068	Royal Palm	Roystonea regia	15	29	16	Good		REMAIN	N/A
7069	Royal Palm	Roystonea regia	15	29	17	Good		REMAIN	N/A
7070	Royal Palm	Roystonea regia	14	28	15	Good		REMOVE	NO
7071	Royal Palm	Roystonea regia	14	27	15	Good		REMOVE	NO
7072	Royal Palm	Roystonea regia	14	27	16	Good		REMOVE	NO
7073	Royal Palm	Roystonea regia	13	27	13	Good		REMOVE	NO
7074	Royal Palm	Roystonea regia	14	27	16	Good		REMOVE	YES
7075	Royal Palm	Roystonea regia	12	27	14	Good		REMOVE	YES
7076	Coconut Palm	Cocos nucifera	12	15	14	Good		REMAIN	NO
7077	Alexandra Palm	Archontophoenix alexandrae	10	11	10	Good		REMAIN	NO
7078	Alexandra Palm	Archontophoenix alexandrae	11	10	10	Good		REMAIN	NO
7079	Alexandra Palm	Archontophoenix alexandrae	11	10	10	Good		REMAIN	NO
7082	Royal Palm	Roystonea regia	14	29	15	Good		REMOVE	NO
7083	Coconut Palm	Cocos nucifera	12	22	16	Good		REMAIN	NO
7084	Solitaire Palm	Ptychosperma elegans	12	25	15	Good		REMAIN	NO
7085	Solitaire Palm	Ptychosperma elegans	12	25	15	Good		REMAIN	NO
7086	Solitaire Palm	Ptychosperma elegans	9	10	8	Good		REMAIN	NO
7087	Solitaire Palm	Ptychosperma elegans	8	10	2	Good		REMAIN	NO
7088	Coconut Palm	Cocos nucifera	12	28	16	Good		REMAIN	NO
7089	Thatch Palm	Thrinax radiata	9	17	10	Good		REMAIN	NO
7090	Coconut Palm	Cocos nucifera	11	27	16	Good		REMAIN	N/A
7091	Thatch Palm	Thrinax radiata	10	26	12	Good		REMAIN	N/A
7092	Thatch Palm	Thrinax radiata	10	25	12	Good		REMAIN	NO
7093	Thatch Palm	Thrinax radiata	10	20	12	Good		REMAIN	N/A
7094	Thatch Palm	Thrinax radiata	9	25	12	Good		REMAIN	N/A
7095	Coconut Palm	Cocos nucifera	11	25	15	Good		REMAIN	N/A
7096	Thatch Palm	Thrinax radiata	9	20	12	Good		REMAIN	N/A
7097	Thatch Palm	Thrinax radiata	9	15	12	Good		REMAIN	N/A
7098	Thatch Palm	Thrinax radiata	9	15	12	Good		REMAIN	N/A
7099	Coconut Palm	Cocos nucifera	12	22	17	Good		REMAIN	N/A
7101	Coconut Palm	Cocos nucifera	12	30	17	Good		REMAIN	NO
7102	Foxtail Palm	Wodyetia bifurcata	10	15	10	Good		REMAIN	NO
7104	Coconut Palm	Cocos nucifera	12	30	17	Good		REMAIN	NO
7105	Arecas Palm	Chrysalidocarpus lutescens	10	8	8	Good		REMAIN	NO
7106	Foxtail Palm	Wodyetia bifurcata	10	15	10	Good		REMAIN	NO
7107	Coconut Palm	Cocos nucifera	10	20	12	Good		RELOCATE	NO
7108	Coconut Palm	Cocos nucifera	10	20	12	Good		RELOCATE	NO
7109	Coconut Palm	Cocos nucifera	10	20	12	Good		RELOCATE	NO
7110	Coconut Palm	Cocos nucifera	10	20	12	Good		RELOCATE	NO
7111	Coconut Palm	Cocos nucifera	10	18	12	Good	In raised planter	REMOVE	YES
7112	Coconut Palm	Cocos nucifera	10	18	12	Good	In raised planter	REMOVE	YES
7114	Coconut Palm	Cocos nucifera	11	19	15	Good		REMAIN	N/A
7115	Sabal Palm	Sabal palmetto	12	19	15	Good		REMAIN	N/A
7116	Coconut Palm	Cocos nucifera	11	19	16	Good		REMAIN	N/A
7117	Sabal Palm	Sabal palmetto	12	18	12	Good		REMAIN	N/A
7118	Coconut Palm	Cocos nucifera	10	6	8	Good		REMAIN	N/A
7119	Coconut Palm	Cocos nucifera	10	18	15	Good			N/A
7120	Coconut Palm	Cocos nucifera	11	14	15	Good		REMAIN	NO
7121	Coconut Palm	Cocos nucifera	10	18	15	Good		REMAIN	N/A
7122	Coconut Palm	Cocos nucifera	12	12	12	Good		REMAIN	N/A
7123	Sabal Palm	Sabal palmetto	12	20	12	Good		REMAIN	NO
7124	Sabal Palm	Sabal palmetto	12	16	12	Good		REMAIN	N/A
7125	Coconut Palm	Cocos nucifera	12	18	15	Good		REMAIN	NO
7126	Coconut Palm	Cocos nucifera	12	18	16	Good		REMAIN	NO
7127	Sabal Palm	Sabal palmetto	12	15	12	Good		REMAIN	N/A
7128	Sabal Palm	Sabal palmetto	12	22	12	Good		REMAIN	N/A
7130	Coconut Palm	Cocos nucifera	12	22	17	Good		REMAIN	N/A
7131	Sabal Palm	Sabal palmetto	12	15	12	Good		REMAIN	N/A
7132	Coconut Palm	Cocos nucifera	11	18	15	Good		REMAIN	N/A
7133	Sabal Palm	Sabal palmetto	12	20	12	Good		REMAIN	NO
7134	Coconut Palm	Cocos nucifera	12	27	17	Good		REMAIN	N/A
7135	Coconut Palm	Cocos nucifera	12	26	17	Good		REMAIN	N/A
7136	Royal Palm	Roystonea regia	15	28	15	Good		REMOVE	NO
7137	Solitaire Palm	Ptychosperma elegans	7	27	12	Good		REMAIN	N/A
7138	Coconut Palm	Cocos nucifera	12	20	16	Good		REMAIN	N/A
7139	Coconut Palm	Cocos nucifera	12	19	15	Good		REMAIN	N/A
7140	Coconut Palm	Cocos nucifera	10	20	15	Good		REMAIN	N/A

TREE DISPOSITION LIST

TREE	COMMON NAME	SCIENTIFIC NAME	DBH (in.)	HIGHT (FT.)	CANOPY DIAMETER (FT.)	CONDITION	NOTES	DISPOSITION	MITIGATION REQUIRED
7141	Coconut Palm	Cocos nucifera	11	18	16	Good		REMAIN	N/A
7142	Coconut Palm	Cocos nucifera	11	20	15	Good		REMAIN	N/A
7143	Coconut Palm	Cocos nucifera	9	20	15	Good		REMAIN	N/A
7144	Beauty Leaf	Calophyllum antillarum	8	N/A	15	Good		REMAIN	N/A
7145	Coconut Palm	Cocos nucifera	10	21	16	Good		REMAIN	N/A
7146	Coconut Palm	Cocos nucifera	10	18	15	Good		REMAIN	NO
7147	Coconut Palm	Cocos nucifera	10	18	15	Good		REMAIN	NO
7148	Coconut Palm	Cocos nucifera	10	20	15	Good		REMAIN	NO
7149	Coconut Palm	Cocos nucifera	10	18	15	Good		REMAIN	NO
7150	Coconut Palm	Cocos nucifera	10	20	15	Good		REMAIN	N/A
7151	Coconut Palm	Cocos nucifera	10	20	15	Good		REMAIN	N/A
7152	Coconut Palm	Cocos nucifera	10	18	15	Good		REMAIN	N/A
7153	Coconut Palm	Cocos nucifera	10	20	16	Good		REMAIN	N/A
7154	Coconut Palm	Cocos nucifera	10	19	15	Good		REMAIN	N/A
7155	Beauty Leaf	Calophyllum antillarum	11	N/A	25	Good		REMAIN	N/A
7156	Coconut Palm	Cocos nucifera	10	19	15	Good		REMAIN	NO
7157	Coconut Palm	Cocos nucifera	11	21	16	Good		REMAIN	NO
7158	Coconut Palm	Cocos nucifera	11	22	16	Good		REMOVE	YES
7159	Coconut Palm	Cocos nucifera	11	22	16	Good		REMOVE	YES
7160	Coconut Palm	Cocos nucifera	11	22	16	Good		REMOVE	YES
7161	Coconut Palm	Cocos nucifera	11	22	16	Good		REMOVE	YES
7162	Coconut Palm	Cocos nucifera	12	22	17	Good		REMAIN	NO
7163	Coconut Palm	Cocos nucifera	11	26	16	Good		RELOCATE	NO
7164	Coconut Palm	Cocos nucifera	10	26	16	Good		REMAIN	NO
7165	Coconut Palm	Cocos nucifera	11	26	16	Good		REMAIN	NO
7166	Coconut Palm	Cocos nucifera	11	26	16	Good		REMAIN	NO
7167	Coconut Palm	Cocos nucifera	11	26	16	Good		REMAIN	NO
7168	Coconut Palm	Cocos nucifera	12	26	16	Good		REMAIN	NO
7169	Coconut Palm	Cocos nucifera	11	25	16	Good		RELOCATE	NO
7170	Coconut Palm	Cocos nucifera	11	26	16	Good		RELOCATE	NO
7171	Coconut Palm	Cocos nucifera	11	26	16	Good		REMAIN	NO
7172	Coconut Palm	Cocos nucifera	11	26	16	Good		REMAIN	NO
7173	Coconut Palm	Cocos nucifera	12	26	16	Good		REMAIN	NO
7174	Coconut Palm	Cocos nucifera	11	25	16	Good		REMAIN	NO
7175	Coconut Palm	Cocos nucifera	11	26	16	Good		REMAIN	NO
7176	Coconut Palm	Cocos nucifera	11	26	16	Good		REMAIN	NO
7177	Coconut Palm	Cocos nucifera	12	26	16	Good		REMAIN	NO
7178	Coconut Palm	Cocos nucifera	12	24	16	Good		REMAIN	NO
7179	Coconut Palm	Cocos nucifera	12	28	16	Good		REMAIN	NO
7180	Coconut Palm	Cocos nucifera	12	20	16	Good		REMAIN	N/A
7181	Coconut Palm	Cocos nucifera	12	21	16	Good		REMAIN	N/A
7182	Coconut Palm	Cocos nucifera	12	20	16	Good		REMAIN	N/A
7183	Coconut Palm	Cocos nucifera	12	24	16	Good		REMAIN	NO
7184	Coconut Palm	Cocos nucifera	12	24	16	Good		REMAIN	N/A
7185	Coconut Palm	Cocos nucifera	12	21	16	Good		REMAIN	N/A
7186	Coconut Palm	Cocos nucifera	12	19	16	Good		REMAIN	N/A
7187	Coconut Palm	Cocos nucifera	12	19	16	Good		REMAIN	N/A
7188	Coconut Palm	Cocos nucifera	12	19	16	Good		REMAIN	N/A
7189	Coconut Palm	Cocos nucifera	12	19	16	Good		REMAIN	N/A
7190	Coconut Palm	Cocos nucifera	12	20	16	Good		REMAIN	N/A
7191	Coconut Palm	Cocos nucifera	12	22	16	Good		REMAIN	N/A
7192	Sabal Palm	Sabal palmetto	12	18	14	Good		REMAIN	N/A
7193	Sabal Palm	Sabal palmetto	12	18	14	Good		REMAIN	N/A
7196	Coconut Palm	Cocos nucifera	14	20	16	Good		REMAIN	N/A
7203	Sabal Palm	Sabal palmetto	12	14	14	Good		REMAIN	N/A
7205	Silver Buttonwood	Conocarpus sericeus	10	N/A	15	Fair	Multi-leader, in raised planter	RELOCATE	NO
7206	Silver Buttonwood	Conocarpus sericeus	10	N/A	15	Fair	Multi-leader, in raised planter	RELOCATE	NO
7207	Silver Buttonwood	Conocarpus sericeus	10	N/A	15	Fair	Multi-leader, in raised planter	RELOCATE	NO
7208	Beauty Leaf	Calophyllum antillarum	10	N/A	20	Good		REMAIN	N/A
7209	Beauty Leaf	Calophyllum antillarum	9	N/A	15	Good		REMAIN	N/A
7210	Pitch Apple	Clusia rosea	9	N/A	15	Poor	Spars foliage, branch damage	REMAIN	N/A
7211	Green buttonwood	Conocarpus erectus	13	N/A	20	Fair	Canopy reduction, minor branch damage, poor structure	REMAIN	NO
7212	Beauty Leaf	Calophyllum antillarum	9	N/A	15	Good		REMAIN	N/A
7213	Green buttonwood	Conocarpus erectus	6	N/A	8	Fair	Asymmetric canopy, poor structure	REMAIN	N/A
7214	Green buttonwood	Conocarpus erectus	7	N/A	10	Fair	Asymmetric canopy, poor structure	REMAIN	N/A
7215	Green buttonwood	Conocarpus erectus	13	N/A	35	Fair	Limb damage	REMAIN	NO
7286	Solitaire Palm	Ptychosperma elegans	8	27	12	Good	Triplet	REMOVE	YES
7287	Solitaire Palm	Ptychosperma elegans	8	27	12	Good	Triplet	REMOVE	YES
7289	Fiddle-Leaf Fig	Ficus lyrata	5	N/A	12	Fair		REMAIN	NO
7290	Solitaire Palm	Ptychosperma elegans	8	27	15	Good	Double	REMAIN	N/A
7291	Beauty Leaf	Calophyllum antillarum	9	N/A	15	Good		REMAIN	N/A
7292	Christmas P alm	Vectelia merillii	8	11	14	Good	Double	REMAIN	NO

TREE REMOVAL AND TREE TO REMAIN PRUNING SPECIFICATIONS

PART 1 - EXPLANATION OF NATURAL RESOURCE PRESERVATION PROCEDURES

The sequence of operation is critical to the protection of the trees.

A. Tree canopy pruning is to compensate for root loss and damage.

B. Fertilization is to stimulate root systems to heal quickly and grow back in root-pruned areas. It also produces faster availability of food to a root system that is less efficient due to the damage incurred.

C. Root pruning is to remove the roots with a trenching procedure that is less damaging to the roots than regular construction.

PART 2 - DEFINITIONS

- A. Natural Resource - Existing trees or palms.
- B. Critical Root Zone - The mass of roots surrounding a tree that is required by the tree to live. The critical root zone is often much larger than the canopy. The critical root zone for each tree or palm within the project limits to be determined by the Contractor's Certified Arborist.
- C. DBH - Diameter Breast High - Indicates the location on the trunk, approximately 4.5' above ground, to measure the diameter of a tree.
- D. Grade - The grade of a tree refers to the overall health and appearance of the tree. The grades range from "A" being excellent to "D" being hazardous.
- E. Preserved Trees - Trees that are to be saved/remain in place.
- F. Owner's Representative - A representative, hired and paid for by the owner, that supervises the construction of the procedures shown on the tree disposition plans.
- G. Protection Zones/Areas - Any area enclosed partially or completely by a tree protector barrier/fence.
- H. Contractor's Certified Arborist - an independent ISA Certified Arborist, hired and paid for by the contractor, that supervises the construction of the procedures shown on the tree disposition plans.

PART 3 - PRODUCTS FOR TREE TREATMENT

Every effort shall be made to utilize chemicals of an organic or biodegradable nature in order to offer the least impact to the natural environment. Contractor is responsible for mixing, applying, and disposal of all chemicals in accordance with strict adherence to manufacturer's directions, unless otherwise directed in these drawings. Refer to "Part 4B" below.

- A. Chemical Treatments.
1. Recommended Fertilizer:
- a. "XL Injecto Feed", product of Doggett Corp., Lebanon, New Jersey (908) 236-6335. Apply a 12/24/24 ratio with a dilution rate 1/3 more water than specified on bag.
2. Recommended Wetting Agent:
- a. "APSA-80", product of Amway Corp. (800) 253-7088.
3. Mycorrhizal Treatment:
- a. Plant Health Care, Inc. (800) 421-9051. Products of the same type from other sources shall not be excluded, provided they possess like physical and functional characteristics and are approved by the Project Landscape Architect.
- B. Insecticide Treatments.
1. "Astro", a product of FMC Corporation. (800) 321-1362.
- C. Tree Protector Barrier Material.
1. Six (6) foot tall orange vinyl mesh construction fence supported by eight (8) foot tall metal T-Bar Posts and Post Caps.
2. The tree protector barrier shall have a two (2) foot by two (2) foot "tree protection zone" sign affixed to the fence every twenty (20) feet placed in such a manner to be clearly visible to the construction workers. The sign must be made up of weather resistant material.
3. The eight (8) foot tall metal T-Bar Post and Post Cap shall be placed a maximum of six (6) foot intervals.

PART 4 - EXECUTION

- A. Tree Canopy/Root Pruning Operation
1. Trees to be pruned shall include only trees affected by construction or as designated on the tree disposition list. This item is to be coordinated by the Contractor's Certified Arborist with the Owner's Representative.
2. All pruning shall be done in accordance with ANSI A300 (Part 1) Pruning.
3. The Contractor's Certified Arborist must be present during all pruning operations.
4. Pruning shall consist of the following methods:
- a. Cleaning
- b. Interfering branch removal.
- c. Raising
- d. Root pruning.
- B. Fertilization Operation
1. Only trees affected by construction (canopy and/or root pruning) shall be fertilized.
2. Trees specified to receive fertilizer shall be treated during the time of year as recommended by the Contractor's Certified Arborist.
- a. Mix fertilizer with a dilution rate 1/3 more water than label instructions into a tank with agitation capability (15lbs. = 133 Gallons).
- b. Mix Wetting Agent at a rate of 5 oz. Per 100 gallons of fertilizer solution into same tank with fertilizer. Agitate mix.
- c. Inject the mixture with a hydraulic injection system set at 100 to 150 p.s.i. for sandy soils, 200 p.s.i. for silt/clay soils, into the upper 6-12 inches of soil with a soil probe. Inject at the rate of one third (1/3) gallon at each injection site.
- d. Critical Root Zone areas shall be injected, where possible, in the Critical Root Zone area plus 2' beyond Critical Root Zone, but not beyond Root Prunes.
- e. Fertilizer shall be installed prior to installation of any aeration systems (if applicable). AT THE REQUEST OF THE OWNER'S REPRESENTATIVE, EMPTY PRODUCT BAGS TO BE RETURNED TO THE OWNER'S REPRESENTATIVE FOR PROOF OF USE.
3. Injectable Fertilizer Treatment.
- a. Mix fertilizer with a dilution rate 1/3 more water than label instructions into a tank with agitation capability (15lbs. = 133 Gallons).
- b. Mix Wetting Agent at a rate of 5 oz. Per 100 gallons of fertilizer solution into same tank with fertilizer. Agitate mix.
- c. Inject the mixture with a hydraulic injection system set at 100 to 150 p.s.i. for sandy soils, 200 p.s.i. for silt/clay soils, into the upper 6-12 inches of soil with a soil probe. Inject at the rate of one third (1/3) gallon at each injection site.
- EMPTY PRODUCT BAGS TO BE STOCKPILED FOR INSPECTION BY OWNER'S REPRESENTATIVE PRIOR TO DISPOSAL.
4. Inoculant & Biostimulant.
- a. Use one 3 oz. Packet of MycorTree Tree Saver Transplant Mycorrhizal Transplant Inoculant for every one (1) foot diameter of root ball. Mix inoculant in 10" wide topsoil ring around the root ball.
- b. Mix one 4 oz. Bag of MycorTree Tree Saver Injectable Mycorrhizal Inoculant and 4 packs (to equal 1 pound) PHC BioPack per 100 gallons of water.
- c. Agitate for 10 minutes.
- d. Inject the mixture with a hydraulic injection system set at 100 to 150 p.s.i. for sandy soils, 200 p.s.i. for silt/clay soils, into the upper 6-12 inches of soil with a soil probe. Inject at the rate of one third (1/3) gallon at each injection site. See transplant details on this sheet for injection locations.
- EMPTY PRODUCT BAGS TO BE STOCKPILED FOR INSPECTION BY OWNER'S REPRESENTATIVE PRIOR TO DISPOSAL.

C. Insecticide Operation

1. Apply "Astro" as a topical solution as directed by the Contractor's Certified Arborist. Notify Owner's Representative if an infestation is noticed. Apply around base of trunk to soil line, trunk and any limb 1/3 the size of the trunk to 25'-30' high. Insure complete coverage. Reapply "Astro" 2-3 months after initial application utilizing same procedure.
2. Follow all manufacturers' recommendations concerning application when applying "Astro". Read all warning labels. Any pets, as well as, the pets food and water bowls should be removed from the area and any swimming pools should be covered (if applicable).
3. Contractor shall ensure no mixing of chemicals occurs without protective measures to prevent spillage and potential contamination of soils.

D. Root Pruning/Trenching Operation

1. Trenching locations shall be approved in the field by the Owner's Representative and the Contractor's Certified Arborist.
2. Trenching equipment that will turn at high RPM's is preferred. Trenching equipment is to be used to perform all root pruning operations. A minimum depth of three feet is required or as determined by Contractor's Certified Arborist. Clean cut roots in trench on tree side with sterile equipment, loops or chain saw after trenching is complete.
3. The trench shall be backfilled and compacted immediately, as directed by the Contractor's Certified Arborist.
4. Phased root pruning timeframes vary by species. Contractor's certified arborist shall direct pruning schedule.

E. Tree Protector Barrier

1. See details this sheet.
2. Tree Protector Barrier is to be placed by the Contractor around each tree to remain as directed by the Contractor's Certified Arborist.

F. Tree Removals

1. Contractor shall remove and discard all trees shown as "Remove" on the Tree Disposition Plan and the Tree Disposition List. All trees shown to be removed shall be felled with a chain saw and stump ground 6" below surface. Any tree shown to be removed and is in an area where compaction is critical, the tree shall be felled with a chain saw and stump removed by the Contractor. Care must be taken not to damage the existing trees marked to remain.
2. If Tree Protector Barrier is damaged, repair is to be performed immediately. Care must be taken not to damage the trees to remain.
3. Contractor shall remove and haul away from the job site all wood generated from tree removals, including stumps, the same day the removal happens.
4. Burn pits are not allowed.

PART 5 - PENALTIES

A. Repair of Damaged Trees To Remain

1. If any damage to trees to remain or other natural resources should occur by accident or negligence during the construction period, the Owner's Representative shall appraise the damage and make recommendations to the Owner for repair by the Contractor, at the Contractor's expense.
2. If any tree that is designated to remain is deemed substantially damaged or dead due to construction damage, at the sole discretion of the Owner's Representative, the following penalties will apply:
- a. Trees 1" - 12" of trunk diameter, measured at 1' from the ground will be valued at \$300.00 per diameter inch.
- b. Trees 13" and above of trunk diameter measured at 4.5' from the ground will be valued at \$400.00 per diameter inch.
- c. If any tree designated to remain is removed from the site without permission of the owner's Representative, the penalty will be \$600.00 per inch.

B. Repair of Damaged Tree Protector Barrier

1. If any damage to the Tree Protector Barrier should occur by accident or negligence, the Contractor will be responsible for immediate repairs of the initial damage. Fines will be imposed as follows:
- a. First time offense, a fine of \$200.00 will be imposed.
- b. In the event the fence is not repaired within 24 hours to the Owner's Representative's satisfaction, an additional fine of \$100.00 per day will be imposed, until the fence is satisfactorily repaired.
- c. In the event a natural resource is damaged due to a Tree Protector Barrier being down, a fine of \$200.00 plus the cost of repair or replacement of the natural resource as appraised by the Owner's Representative will be imposed.
- d. Contractor shall also bear the cost of any fines, bonded tree values, attorney fees, expenses incurred by project delays, etc., as determined by the county and local municipality for unauthorized tree removal.

PART 6 - NATURAL RESOURCE PROTECTION SEQUENCE

- A. The sequence of tree treatment and preservation measures shall be:
1. Contractor shall submit a staging/access plan provided to Contractor's Certified Arborist for written approval prior to commencement.
2. Tree Protector Barrier
3. Root Pruning and Root Barriers
4. Clearing and Grading
5. Tree Pruning
6. Fertilization
7. Insecticide
- B. Contractor's Surveyor shall stake all site improvements in order to facilitate accurate location of trenching and fencing operations.
- C. Contractor's Certified Arborist to determine the location of the Tree Protector Barrier around each tree to remain based on his/her analysis of each existing tree to remain that is adjacent to construction improvements such as utility installation, pavement addition and/or restoration, etc.
- D. Contractor shall maintain and repair the Tree Protector Barrier during site construction operations.
- E. Contractor's access to the fenced tree protection areas will be permitted only with approval of Owner's Representative and Contractor's Certified Arborist's written directive.
- F. Contractor shall perform any excavation or grading required within the fenced root zone areas by hand. This operation is to be done under the direct supervision of the Contractor's Certified Arborist and the Owner's Representative.
- G. Contractor to limit required grading within the fenced tree protection areas to a maximum of 3' cut or fill of the tree critical root zone areas. All grading to be supervised by the Contractor's Certified Arborist and the Owner's Representative.
- H. Contractor shall clear by hand trees designated to be removed within critical root zone areas of the trees to remain.
- I. Contractor shall not install conduit, sprinklers, or any utility line in any critical root zone areas without the approval of the Contractor's Certified Arborist and Owner's Representative.

PART 7 - IRRIGATION

Contractor shall water the trees that have been pruned (canopy and/or root) as shown below. Water all pruned trees immediately after pruning. Contractor shall water by hand. If a potable water source is not available on-site or if it is not in working condition, then the Contractor will be responsible for providing the water and water source at his/her own expense.

A. Hand Watering Schedule

- Use the following watering schedule:
1. Contractor shall water all newly (canopy and root) pruned trees:
- (3) three times a week for the first three months
- (2) two times a week for months four and five
- (1) one time a week for month six
2. Contractor shall consult his/her Certified Arborist for watering requirements for the trees that have been canopy and/or root pruned.
- B. Per direction of 1 and 2, Contractor shall proceed with the more stringent watering schedule.

SEQUENCE

1. INSTALL PROTECTION FENCING.
2. PERFORM ANY ROOT PRUNING.
3. BREAK OR CUT CURB A 6' SECTION OF CURB.
4. CAREFULLY ROTATE CURB SECTION AWAY FROM ROOTS.
5. COORDINATE ALL DEMOLITION OPERATIONS w/ PROJECT URBAN FORESTER.
6. INSTALL NEW BACKFILL OR SIDEWALK/CURB.

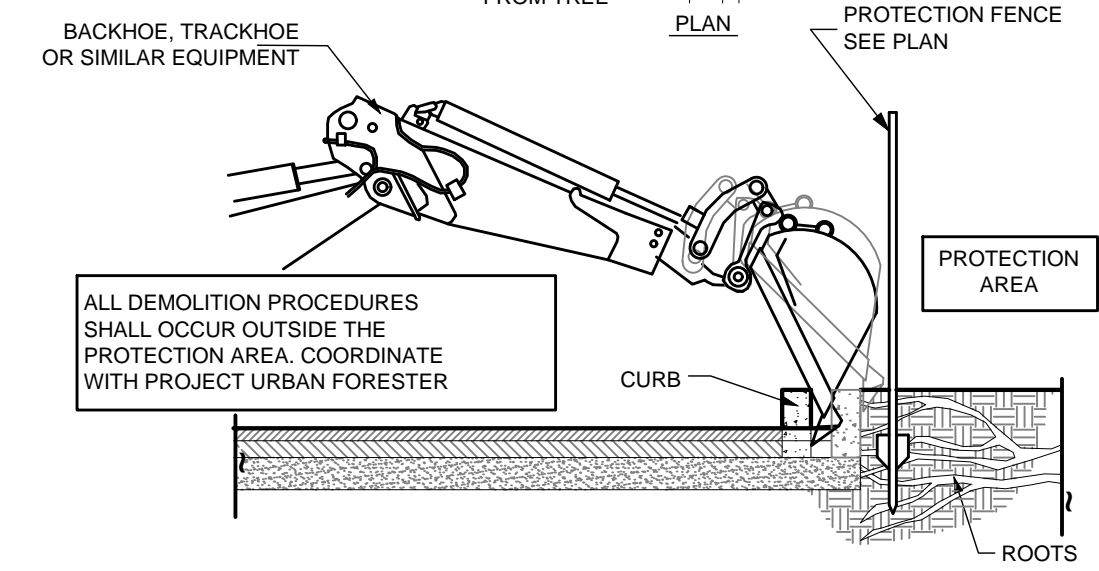

A DEMOLITION PROCEDURE - CURB

SEQUENCE

1. CONTRACTOR SHALL SUBMIT A STAGING/ACCESS PLAN PROVIDED TO CONTRACTOR'S CERTIFIED ARBORIST FOR WRITTEN APPROVAL PRIOR TO COMMENCEMENT.
2. INSTALL PROTECTION FENCING.
3. PERFORM ANY ROOT PRUNING.
4. CONTRACTOR'S LICENSED ISA CERTIFIED ARBORIST SHALL BE PRESENT DURING COMPLETE OPERATION.
5. CAREFULLY HAND EXCAVATE PAVING TO SUBGRADE.
6. INVESTIGATE TO DETERMINE LOCATION AND SIZE OF ROOT SYSTEM.
7. LOOSEN SOIL IF NO LARGE ROOTS ARE PRESENT.
7. HAND EXCAVATE WITHIN CRITICAL ROOT ZONE.

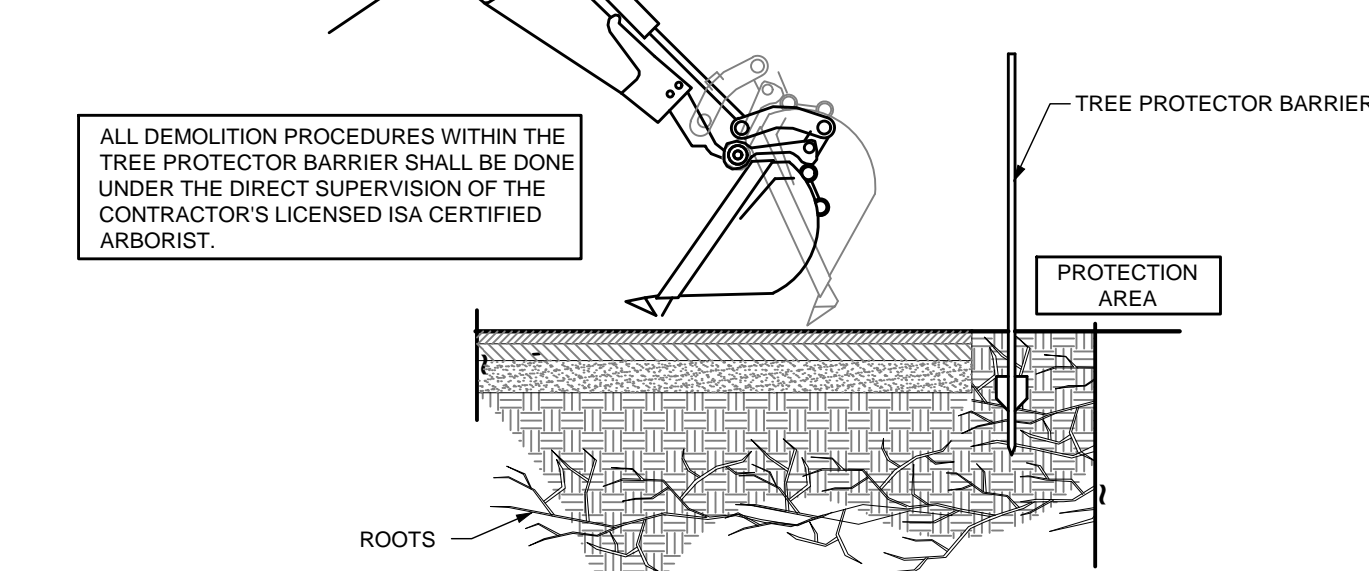

B DEMOLITION PROCEDURE - PAVEMENT

TREE/ PALM PROTECTION FENCES SHALL BE CONSTRUCTED PRIOR TO ANY CONSTRUCTION ACTIVITY INCLUDING GRUBBING FOR ALL TREES/PALMS THAT ARE TO REMAIN, BE PROTECTED OR BE RELOCATED'

NO ACTIVITY OR DISTURBANCE SHOULD OCCUR WITHIN THE FENCED AREAS, INCLUDING VEHICLE USE, STORAGE OF MATERIALS, DUMPING OF LIQUIDS OR MATERIALS, GRADE CHANGES, GRUBBING, AND MECHANICAL TRENCHING FOR IRRIGATION, ELECTRICAL, LIGHTING, ETC.

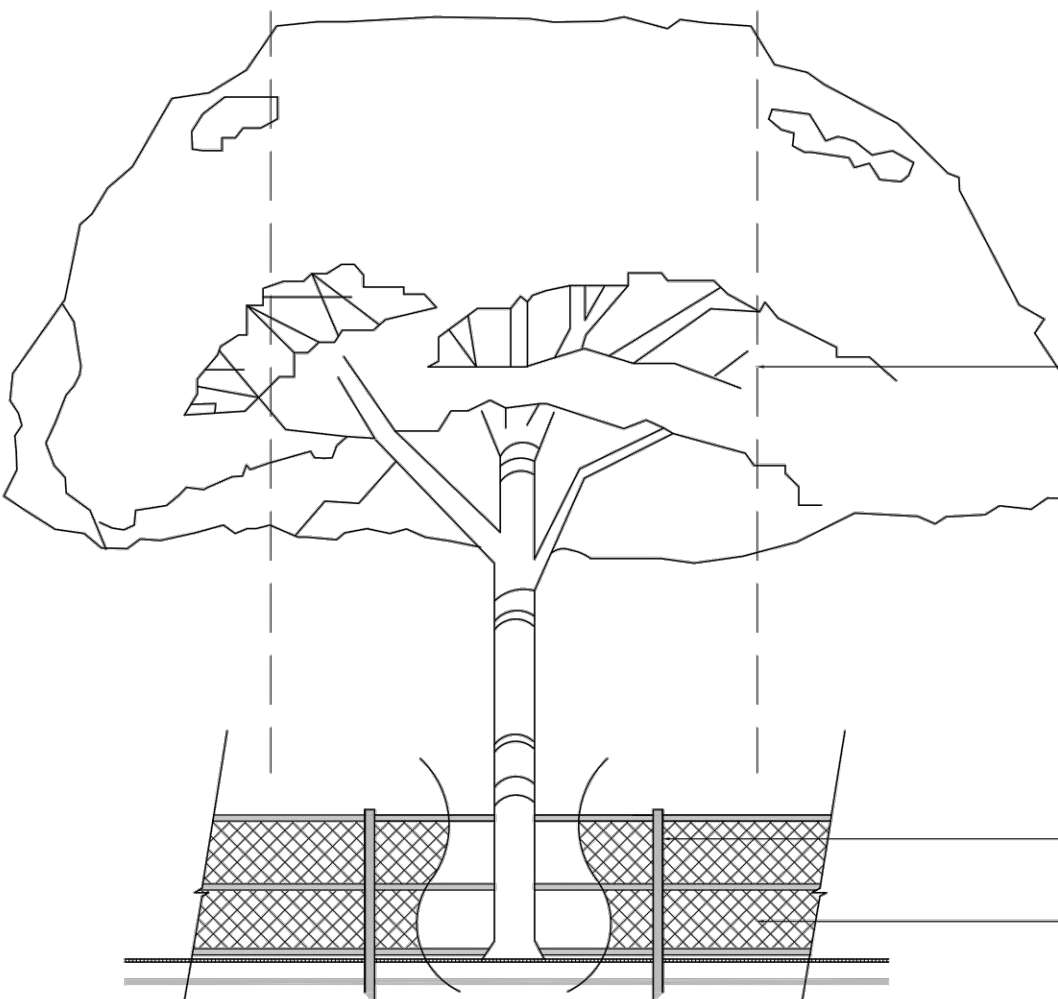

C TREE PRESERVATION BARRICADE FENCING DETAIL

PROTECTION DETAIL NOTE:
CONTRACTOR TO INSTALL 'TREE/PALM PROTECTION FENCE BARRIERS' AROUND ALL EXISTING TREES OR PALMS AT THE START OF THE PROJECT. BARRIERS TO REMAIN IN PLACE THROUGHOUT THE DURATION OF THE PROJECT AND SHOULD NOT BE REMOVED OR DROPPED FOR ANY REASON WITHOUT AUTHORIZATION FROM THE CITY OF MIAMI BEACH URBAN FORESTER + PLANNING + ZONING DEPARTMENT

D C.M.B. TREE/PALM PROTECTION DETAIL

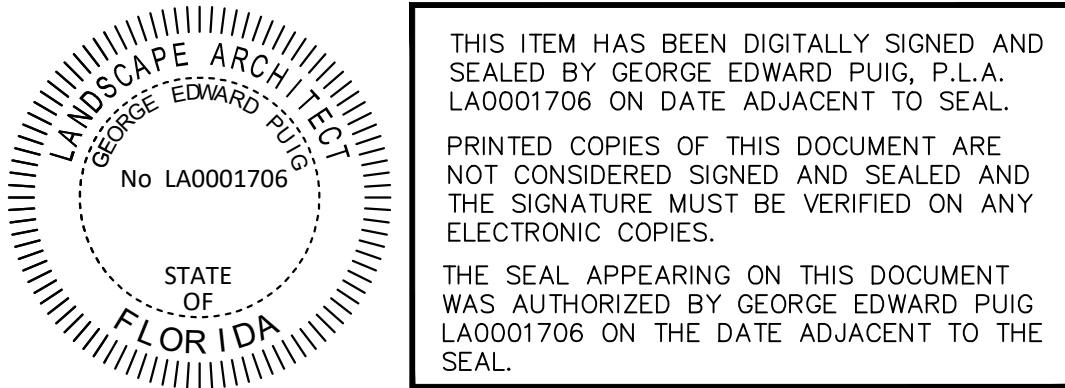

ROYAL PALM HOTEL, MIAMI BEACH
1545 COLLINS AVE., MIAMI BEACH, FL 33139
HPB SET

AUGUST / 04 / 2024: FINAL SUBMITTAL

E o A , I n c | 1929 Ponce de Leon Blvd., Coral Gables, Florida 33146 | 3 0 5 . 4 4 4 . 0 9 9 0 | State of Florida Architect of Record Malcolm Berg, AIA License No. AR94424

TREE DISPOSITION
NOTES AND DETAILS



sheet no.

L-251

SCALE: AS NOTED

L-301

L-302

L-303

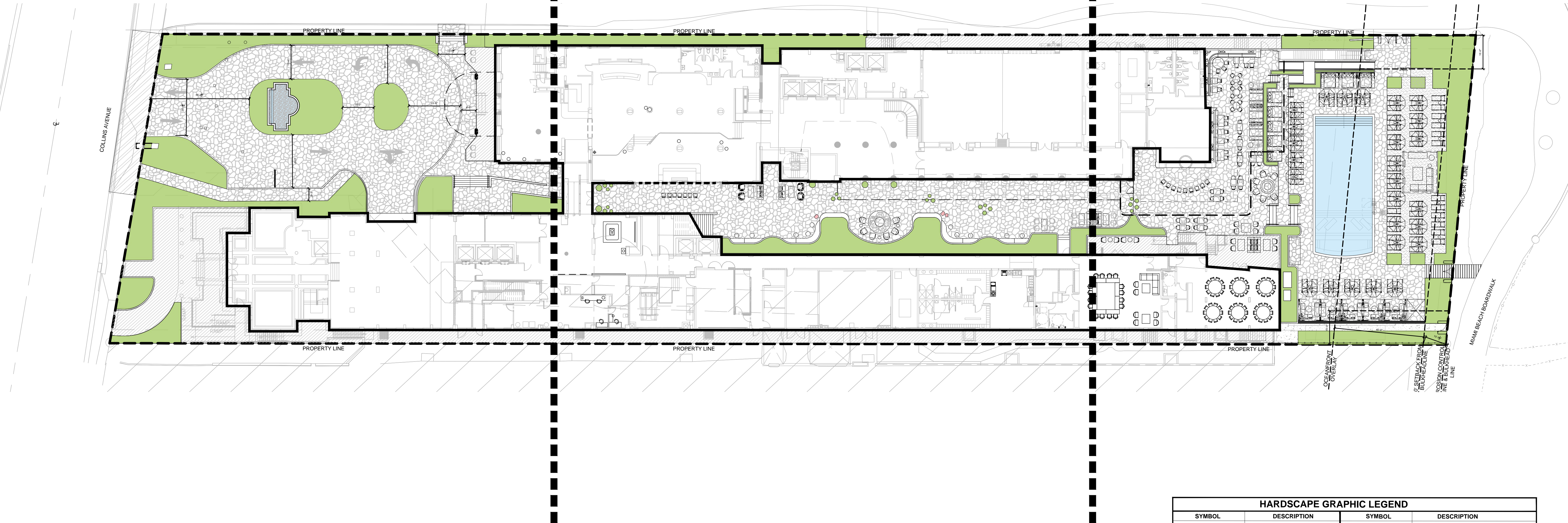

HARDSCAPE GRAPHIC LEGEND			
SYMBOL	DESCRIPTION	SYMBOL	DESCRIPTION
	PLANTING AREA		GRAVEL
	VEHICULAR RATED FLAGSTONE PAVING		

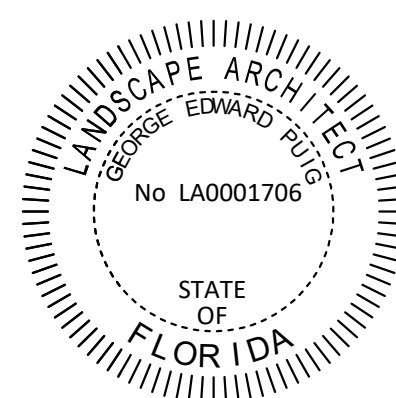

THIS ITEM HAS BEEN DIGITALLY SIGNED AND SEALED BY GEORGE EDWARD PUIG, P.L.A. LA0001706 ON DATE ADJACENT TO SEAL.
PRINTED COPIES OF THIS DOCUMENT ARE NOT CONSIDERED SIGNED AND SEALED AND THE SIGNATURE MUST BE VERIFIED ON ANY ELECTRONIC COPIES.
THE SEAL APPEARING ON THIS DOCUMENT WAS AUTHORIZED BY GEORGE EDWARD PUIG LA0001706 ON THE DATE ADJACENT TO THE SEAL.

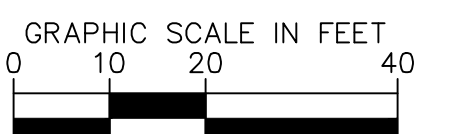

EoA
ARCHITECTURE | INTERIORS | BRANDING | MASTER PLANNING | LANDSCAPE

Gensler

Kimley»Horn

ROYAL PALM HOTEL, MIAMI BEACH
1545 COLLINS AVE., MIAMI BEACH, FL 33139
HPB SET

AUGUST / 04 / 2024: FINAL SUBMITTAL

E o A , I n c | 1929 Ponce de Leon Blvd., Coral Gables, Florida 33146 | 3 0 5 . 4 4 4 . 0 9 9 0 | State of Florida Architect of Record Malcolm Berg, AIA License No. AR94424

OVERALL
HARDSCAPE PLAN



sheet no.
L-300

SCALE: AS NOTED

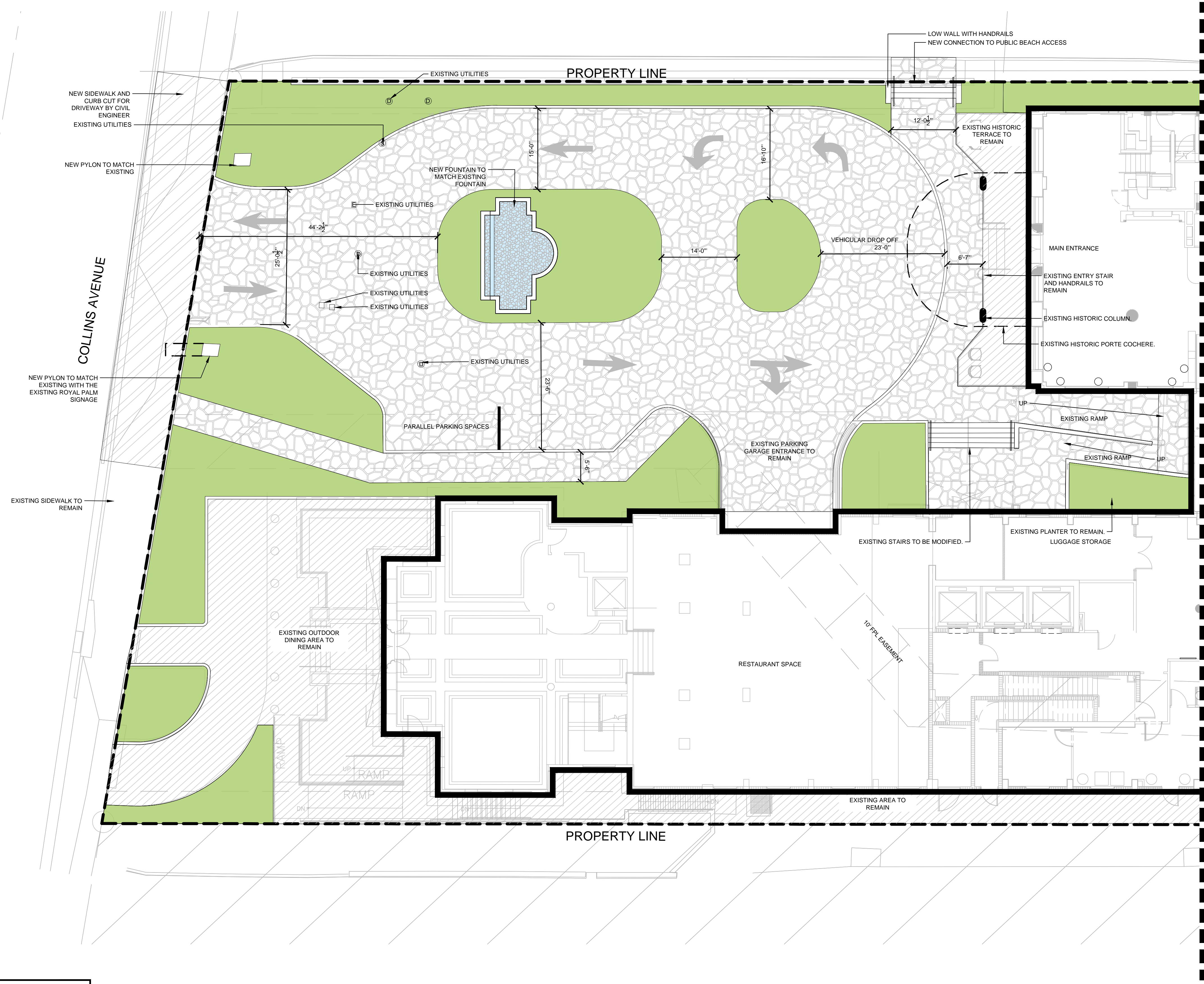

HARDSCAPE GRAPHIC LEGEND			
SYMBOL	DESCRIPTION	SYMBOL	DESCRIPTION
	PLANTING AREA		GRAVEL
	VEHICULAR RATED FLAGSTONE PAVING		

LANDSCAPE ARCHITECT

GEORGE EDWARD PUIG, P.L.A.

No LA0001706

STATE OF FLORIDA

THIS ITEM HAS BEEN DIGITALLY SIGNED AND SEALED BY GEORGE EDWARD PUIG, P.L.A. LA0001706 ON DATE ADJACENT TO SEAL.

PRINTED COPIES OF THIS DOCUMENT ARE NOT CONSIDERED SIGNED AND SEALED AND THE SIGNATURE MUST BE VERIFIED ON ANY ELECTRONIC COPIES.

THE SEAL APPEARING ON THIS DOCUMENT WAS AUTHORIZED BY GEORGE EDWARD PUIG LA0001706 ON THE DATE ADJACENT TO THE SEAL.

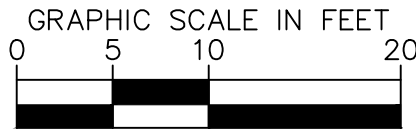

ROYAL PALM HOTEL, MIAMI BEACH

1545 COLLINS AVE., MIAMI BEACH, FL 33139

HPB SET

AUGUST / 04 / 2024: FINAL SUBMITTAL

E o A , I n c | 1929 Ponce de Leon Blvd., Coral Gables, Florida 33146 | 3 0 5 . 4 4 4 . 0 9 9 0 | State of Florida Architect of Record Malcolm Berg, AIA License No. AR94424

ENLARGED
HARDSCAPE PLAN



sheet no.

L-301

SCALE: AS NOTED

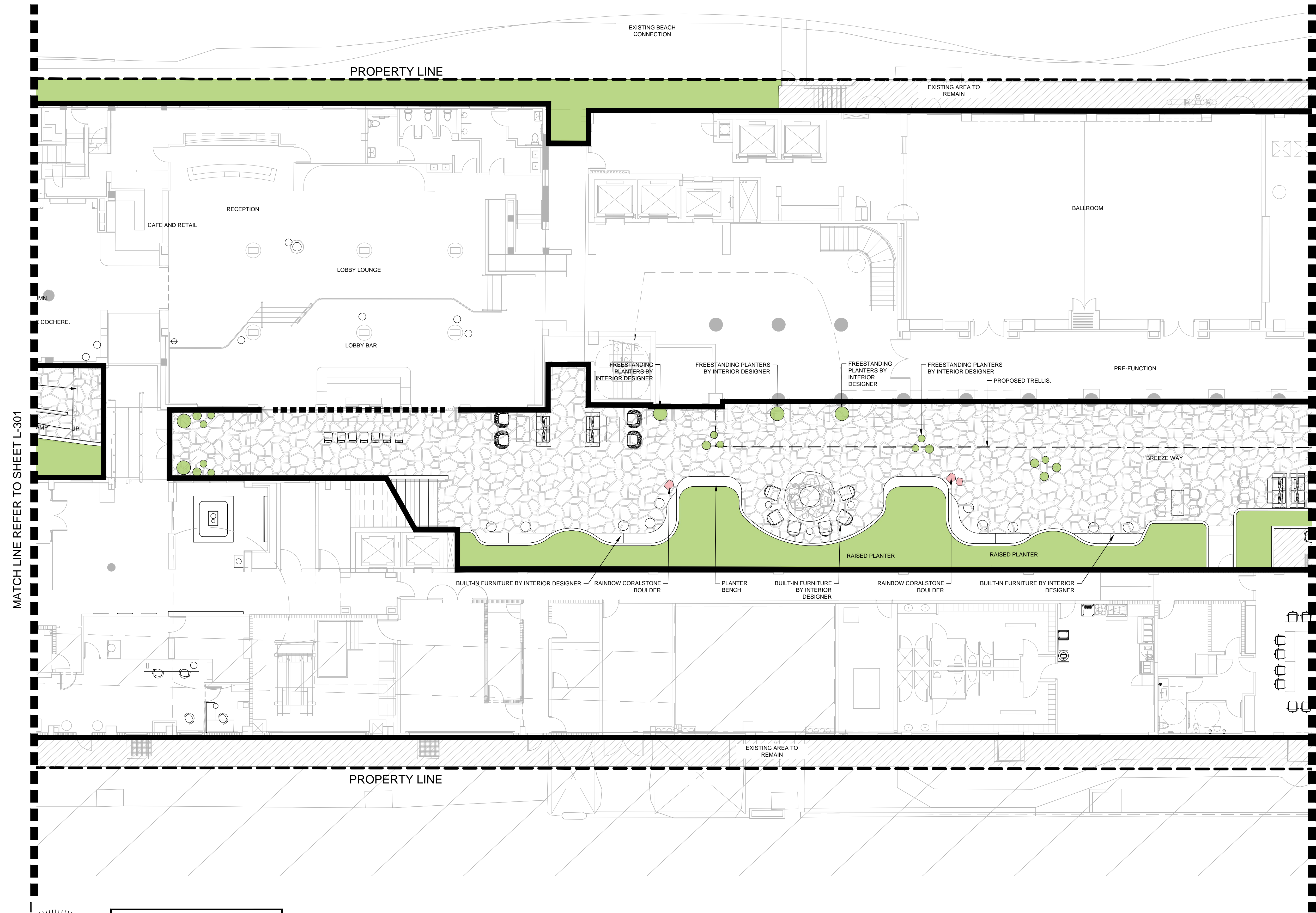

HARDSCAPE GRAPHIC LEGEND			
SYMBOL	DESCRIPTION	SYMBOL	DESCRIPTION
	PLANTING AREA		GRAVEL
	VEHICULAR RATED FLAGSTONE PAVING		

LANDSCAPE ARCHITECT

GEORGE EDWARD PUIG, P.L.A.

No LA0001706

STATE OF FLORIDA

THIS ITEM HAS BEEN DIGITALLY SIGNED AND SEALED BY GEORGE EDWARD PUIG, P.L.A. LA0001706 ON DATE ADJACENT TO SEAL.

PRINTED COPIES OF THIS DOCUMENT ARE NOT CONSIDERED SIGNED AND SEALED AND THE SIGNATURE MUST BE VERIFIED ON ANY ELECTRONIC COPIES.

THE SEAL APPEARING ON THIS DOCUMENT WAS AUTHORIZED BY GEORGE EDWARD PUIG LA0001706 ON THE DATE ADJACENT TO THE SEAL.

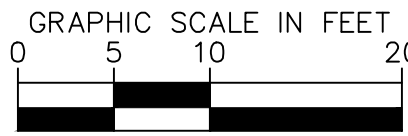

ROYAL PALM HOTEL, MIAMI BEACH

1545 COLLINS AVE., MIAMI BEACH, FL 33139

HPB SET

AUGUST / 04 / 2024: FINAL SUBMITTAL

E o A , I n c | 1929 Ponce de Leon Blvd., Coral Gables, Florida 33146 | 3 0 5 . 4 4 4 . 0 9 9 0 | State of Florida Architect of Record Malcolm Berg, AIA License No. AR94424

ENLARGED
HARDSCAPE PLAN



sheet no.

L-302

SCALE: AS NOTED

MATCH LINE REFER TO SHEET L-302

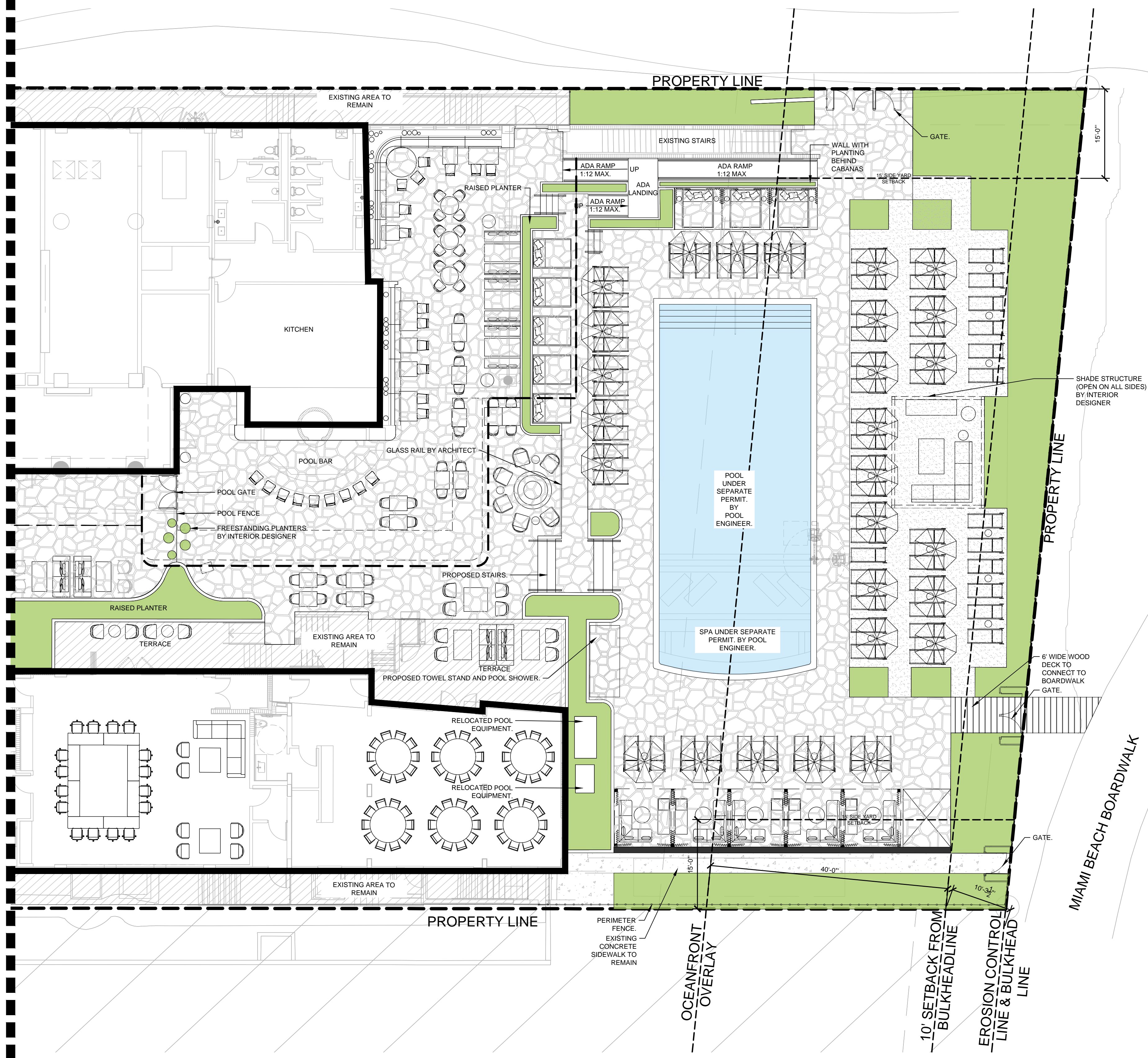

HARDSCAPE GRAPHIC LEGEND			
SYMBOL	DESCRIPTION	SYMBOL	DESCRIPTION
[Green Fill]	PLANTING AREA	[Stippled Fill]	GRAVEL
[Flagstone Pattern]	VEHICULAR RATED FLAGSTONE PAVING		

LANDSCAPE ARCHITECT

GEORGE EDWARD PUIG, P.L.A.

No. LA0001706

STATE OF FLORIDA

THIS ITEM HAS BEEN DIGITALLY SIGNED AND SEALED BY GEORGE EDWARD PUIG, P.L.A. LA0001706 ON DATE ADJACENT TO SEAL.

PRINTED COPIES OF THIS DOCUMENT ARE NOT CONSIDERED SIGNED AND SEALED AND THE SIGNATURE MUST BE VERIFIED ON ANY ELECTRONIC COPIES.

THE SEAL APPEARING ON THIS DOCUMENT WAS AUTHORIZED BY GEORGE EDWARD PUIG LA0001706 ON THE DATE ADJACENT TO THE SEAL.

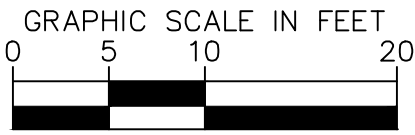

ROYAL PALM HOTEL, MIAMI BEACH
1545 COLLINS AVE., MIAMI BEACH, FL 33139
HPB SET

AUGUST / 04 / 2024: FINAL SUBMITTAL

E o A , I n c | 1929 Ponce de Leon Blvd., Coral Gables, Florida 33146 | 3 0 5 . 4 4 4 . 0 9 9 0 | State of Florida Architect of Record Malcolm Berg, AIA License No. AR94424

ENLARGED
HARDSCAPE PLAN



sheet no.

L-303

SCALE: AS NOTED

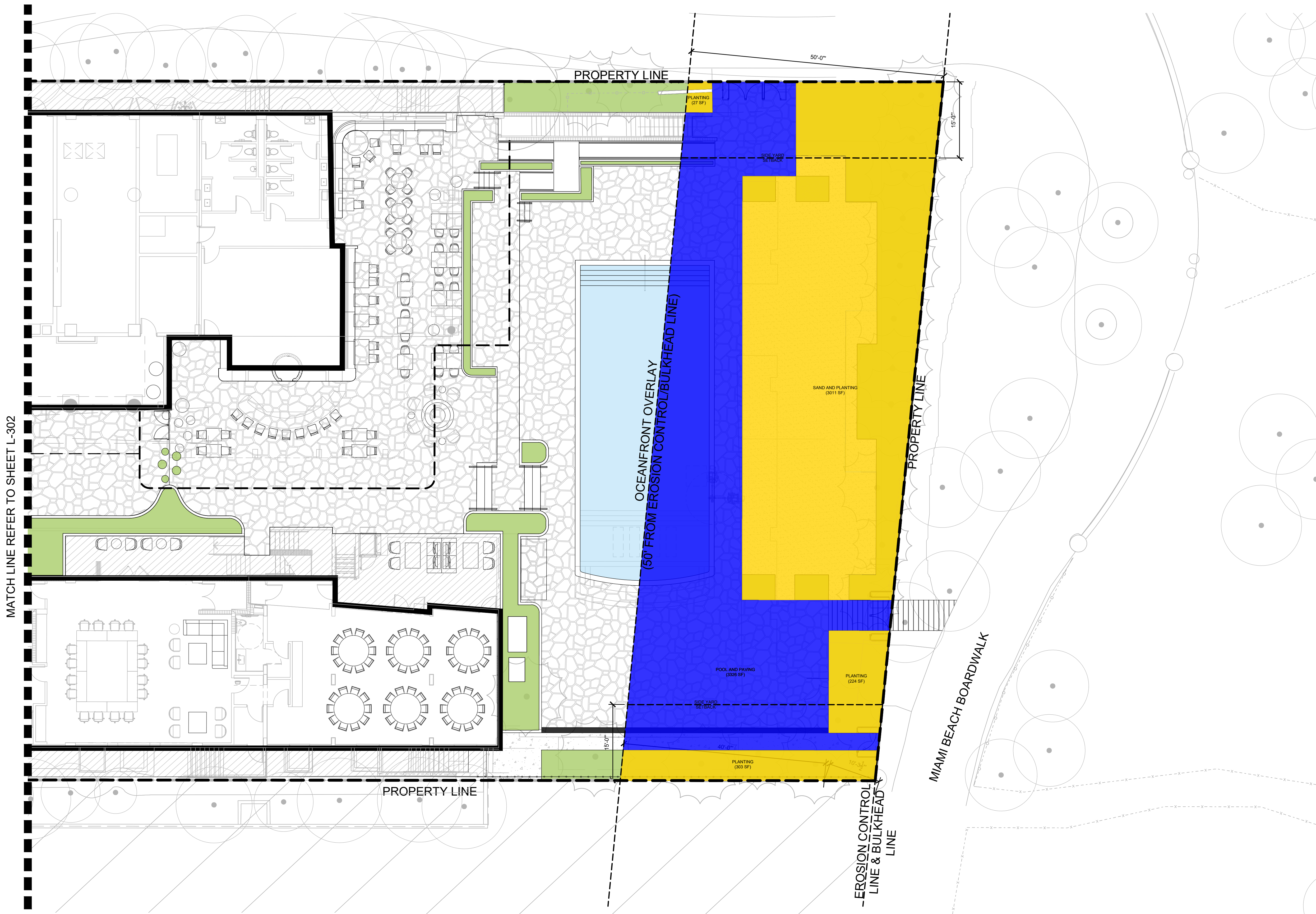

MATCH LINE REFER TO SHEET L-302

OCEANFRONT OVERLAY DIAGRAM

CODE	DESCRIPTION	QTY
1	PERVIOUS AREA	3,871 SF
2	IMPERVIOUS AREA	3,020 SF

CALCULATIONS

OCEANFRONT OVERLAY ZONE TOTAL AREA: 6,891 SF
REQUIRED MIN. PERVIOUS AREA: 3,540 SF
PROPOSED PERVIOUS AREA: 3,871 SF

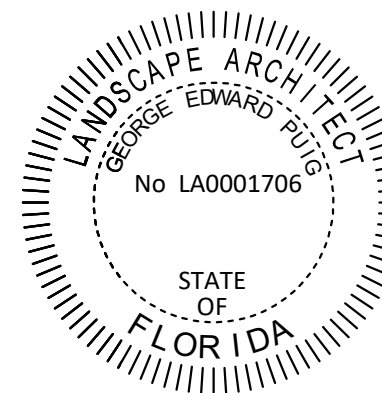

THIS ITEM HAS BEEN DIGITALLY SIGNED AND SEALED BY GEORGE EDWARD PUIG, P.L.A. LA0001706 ON DATE ADJACENT TO SEAL.
PRINTED COPIES OF THIS DOCUMENT ARE NOT CONSIDERED SIGNED AND SEALED AND THE SIGNATURE MUST BE VERIFIED ON ANY ELECTRONIC COPIES.
THE SEAL APPEARING ON THIS DOCUMENT WAS AUTHORIZED BY GEORGE EDWARD PUIG LA0001706 ON THE DATE ADJACENT TO THE SEAL.

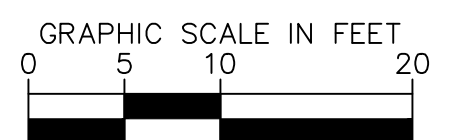

Gensler

Kimley»Horn

ROYAL PALM HOTEL, MIAMI BEACH
1545 COLLINS AVE., MIAMI BEACH, FL 33139
HPB SET

AUGUST / 04 / 2024: FINAL SUBMITTAL

E o A , I n c | 1929 Ponce de Leon Blvd., Coral Gables, Florida 33146 | 3 0 5 . 4 4 4 . 0 9 9 0 | State of Florida Architect of Record Malcolm Berg, AIA License No. AR94424

OCEANFRONT
OVERLAY DIAGRAM

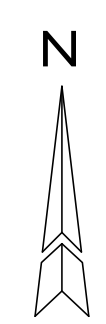

sheet no.

L-331

SCALE: AS NOTED

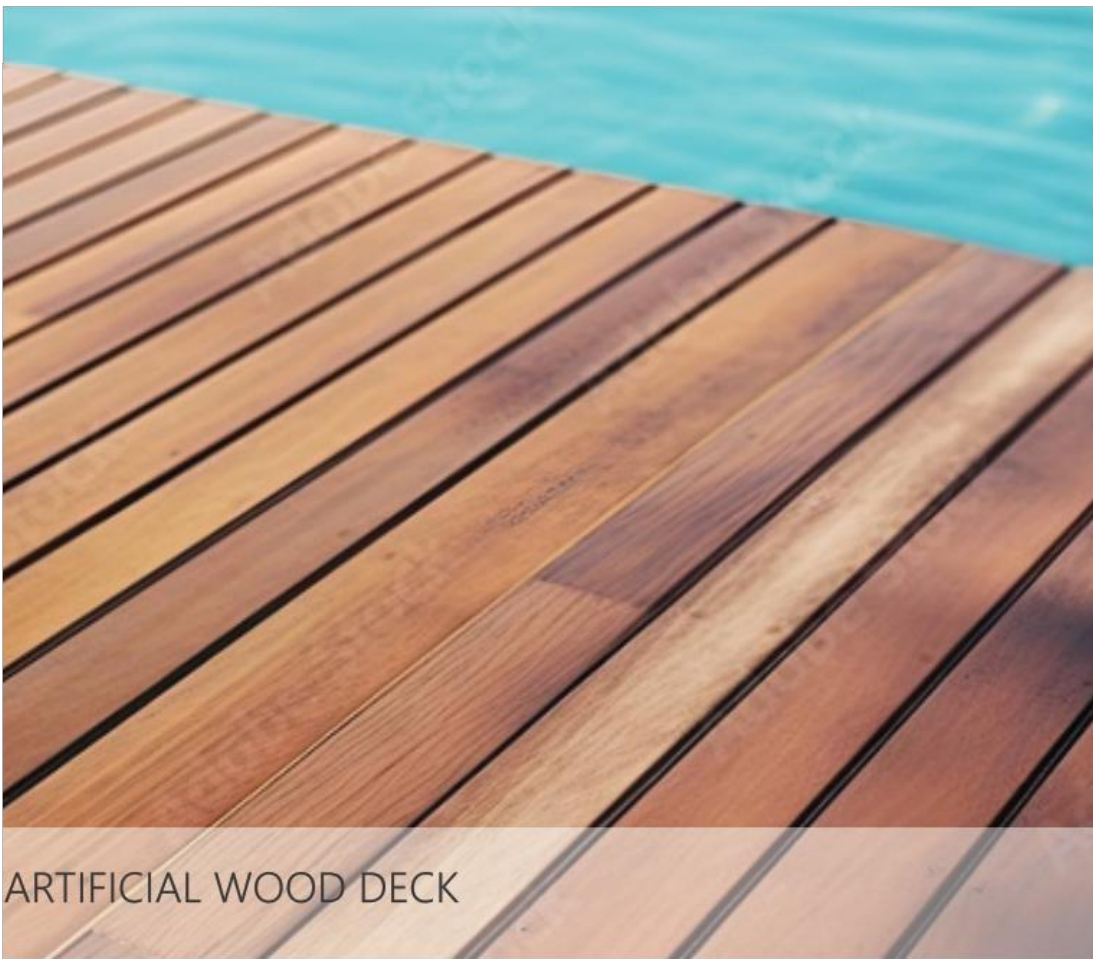

ARTIFICIAL WOOD DECK



FLAGSTONE PAVERS



ROCK SALT FINISH CONCRETE

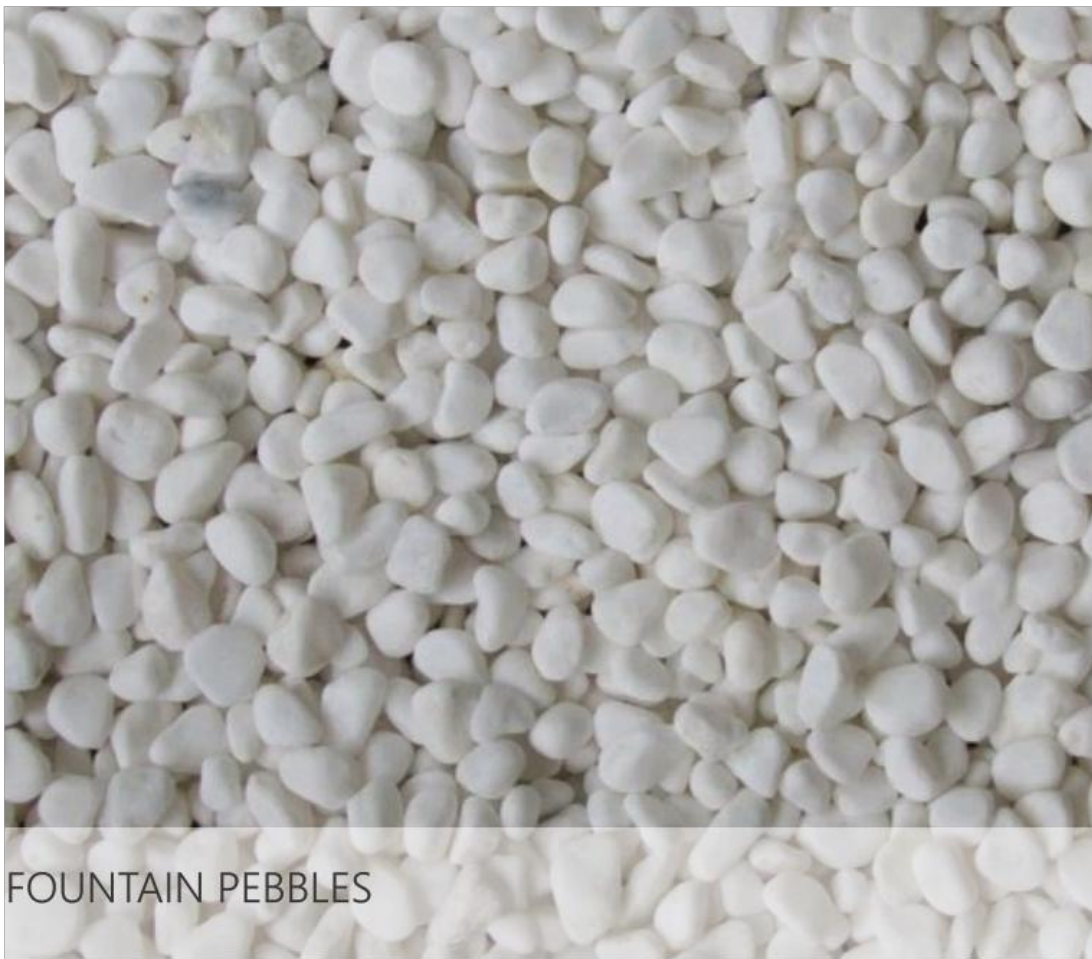

FOUNTAIN PEBBLES



PAVERS



RAINBOW CORALSTONE BOULDER

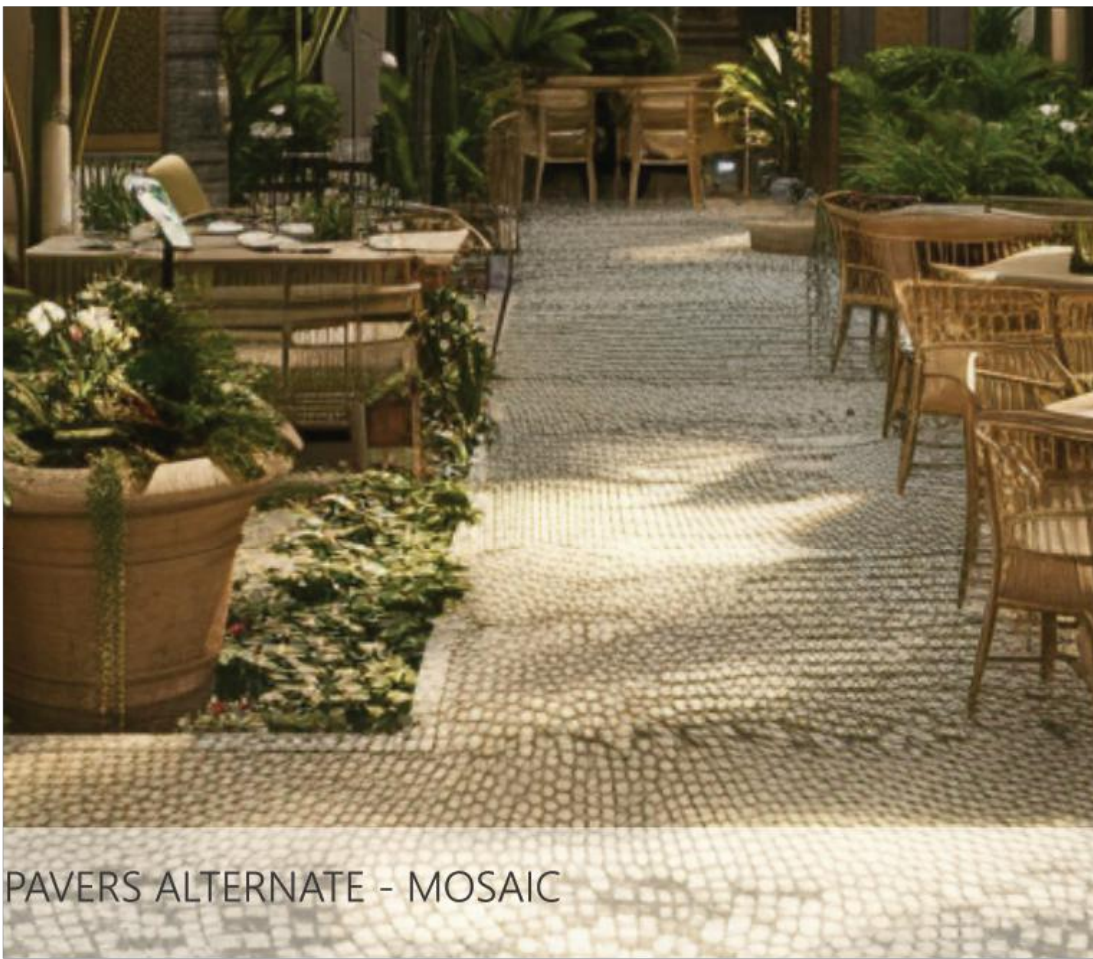

PAVERS ALTERNATE - MOSAIC

LANDSCAPE ARCHITECT

GEORGE EDWARD PUIG

No LA0001706

STATE OF FLORIDA

THIS ITEM HAS BEEN DIGITALLY SIGNED AND SEALED BY GEORGE EDWARD PUIG, P.L.A. LA0001706 ON DATE ADJACENT TO SEAL.

PRINTED COPIES OF THIS DOCUMENT ARE NOT CONSIDERED SIGNED AND SEALED AND THE SIGNATURE MUST BE VERIFIED ON ANY ELECTRONIC COPIES.

THE SEAL APPEARING ON THIS DOCUMENT WAS AUTHORIZED BY GEORGE EDWARD PUIG LA0001706 ON THE DATE ADJACENT TO THE SEAL.

*RENDERS AND IMAGES OF MATERIALS PROVIDED ON THIS SHEET ARE FOR ILLUSTRATIVE PURPOSES ONLY. THEY ARE NOT MEANT TO BE EXHAUSTIVE OR FINAL REPRESENTATIONS OF THE ACTUAL MATERIALS THAT WILL BE IMPLEMENTED AT TIME OF CONSTRUCTION. THESE IMAGES SERVE AS A REFERENCE FOR DESIGN STANDARDS AND MAY BE SUBJECT TO CHANGE BASED ON PROJECT REQUIREMENTS AND AVAILABILITY.