

EXISTING TREE DISPOSITION LIST								
KEY	BOTANICAL NAME	COMMON NAME	SIZE			DISPOSITION	NOTES	MITIGATION
			HT.(ft.)	SPD.(ft.)	DBH.(in.)			DBH.(in.)
1	Adonidia merillii	Christmas Palm	14	8	5	remove	dead	not a tree
2	Adonidia merillii	Christmas Palm	14	8	5	remove	good	not a tree
3	Adonidia merillii	Christmas Palm	14	8	5	remove	good	not a tree
4	Adonidia merillii	Christmas Palm	14	8	5	remove	good	not a tree
5	Adonidia merillii	Christmas Palm	14	8	5	remove	good	not a tree
6	Persea Americana	Avocado tree	18	12	6	remove		6
7	Veitchia montgomeriana	Montgomery Palm	16	12	6	remove		1 palm
TOTAL DBH INCHES TO BE REMOVED								6
TOTAL PALMS TO BE REMOVED								1
TOTAL DBH INCHES MITIGATION REQUIRED								(2) - 2" dbh trees to replace the avocado + (1) - 2" dbh trees to replace the palm = (3) - 2" dbh trees
TOTAL DBH INCHES MITIGATION PROVIDED								(6) - 2" dbh trees

TREE / PALM PROTECTION FENCES SHALL BE CONSTRUCTED PRIOR TO ANY CONSTRUCTION ACTIVITY INCLUDING GRUBBING FOR ALL TREES / PALMS THAT ARE 'TO REMAIN, BE PROTECTED, or BE RELOCATED'

NO ACTIVITY OR DISTURBANCE SHOULD OCCUR WITHIN THE FENCED AREAS, INCLUDING VEHICLE USE, STORAGE OF MATERIALS, DUMPING OF LIQUIDS OR MATERIALS, GRADE CHANGES, GRUBBING, AND MECHANICAL TRENCHING FOR IRRIGATION, ELECTRICAL, LIGHTING, ETC.

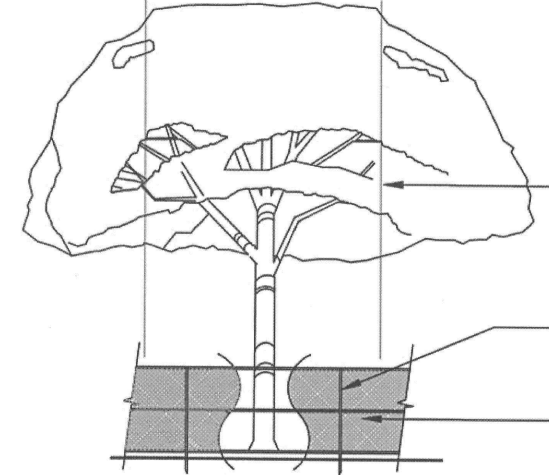

In no case shall the fence be installed less than ten feet from the trunk

Tree + Palm protection barriers to extend beyond the 'dripline' or to the 'critical root zone area' of all trees/palms to be protected. Extend where necessary to protect tree canopy roots

Barriers shall be a minimum of four feet high, and shall be constructed of continuous chain link fence with metal posts at eight-foot spacing, or of two-by-four-inch posts with three equally spaced two-by-four-inch rails. Posts may be shifted to avoid roots.

PROTECTION DETAIL NOTE
CONTRACTOR TO INSTALL 'TREE / PALM PROTECTION FENCE BARRIERS' AROUND ALL EXISTING TREES OR PALMS AT THE START OF THE PROJECT. BARRIERS TO REMAIN IN PLACE THROUGHOUT THE DURATION OF THE PROJECT AND SHOULD NOT BE REMOVED OR DROPPED FOR ANY REASON WITHOUT AUTHORIZATION FROM THE CITY OF MIAMI BEACH URBAN FORESTER + PLANNING + ZONING DEPARTMENT

C.M.B. TREE / PALM PROTEC. DETAIL

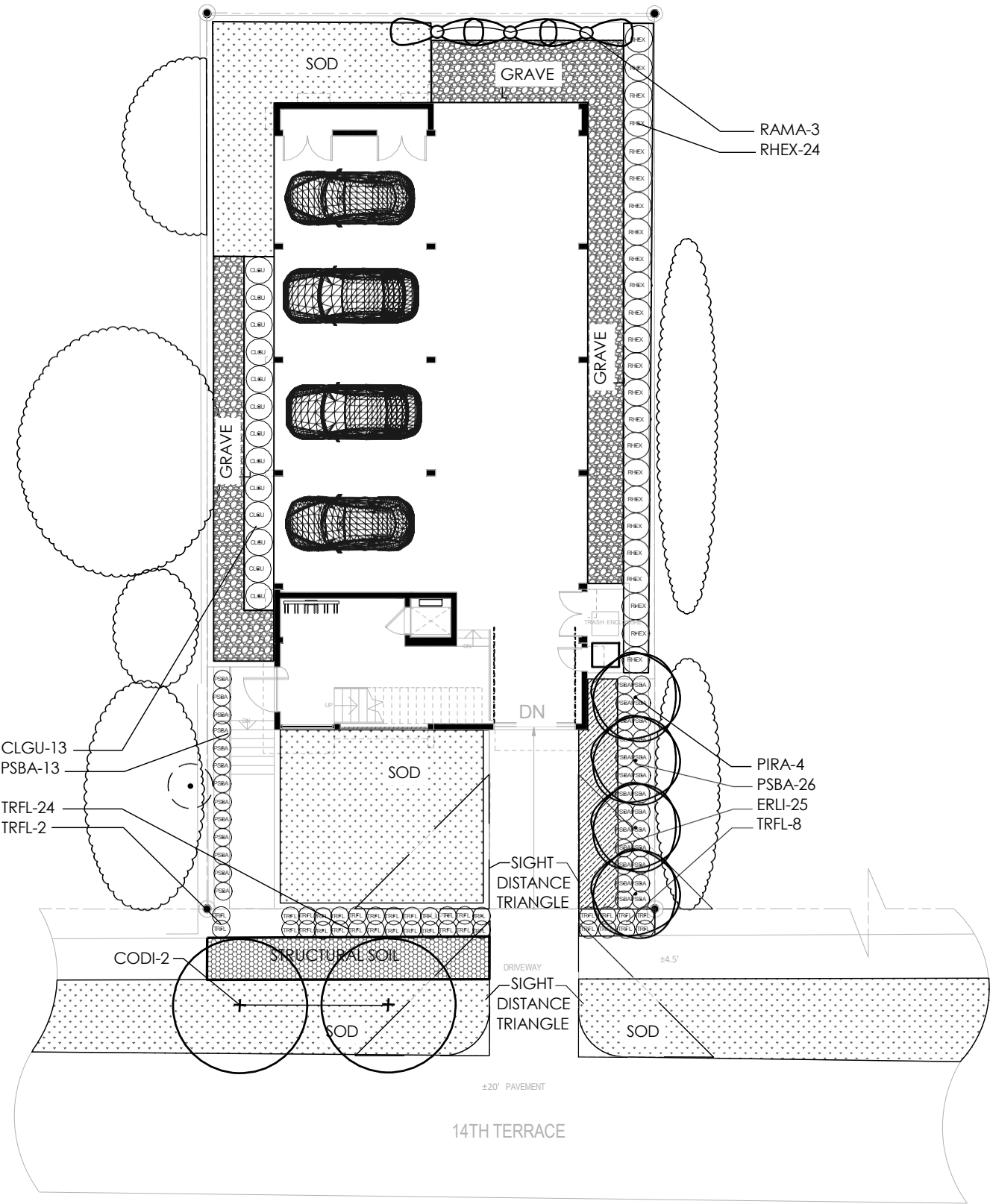

PLANT LIST - GROUND FLOOR				
TREES				
KEY	PLANT NAME	QTY.	UT.	SIZE
CODI	Coccoloba diversifolia ...Pigeon Plum	2	ea.	12' tall x 5' spread, 2" DBH
PIRA	Pimenta racemosa 'lemon' ..Bay Rum Tree	4	ea.	12' tall x 5' spread, 2" DBH
OTHER				
KEY	PLANT NAME	QTY.	UT.	SIZE
RAMA	Ravanela madagascariensis Traveler's Palm	3	ea.	8' tall overall
SHRUBS				
KEY	PLANT NAME	QTY.	UT.	SIZE
PSBA	Psychotria bahamensis ...Bahamas Wild Coffee	39	ea.	24" x 24"
TRFL	Tripsacum floridanum ...Florida Gamagrass	34	ea.	18" x 18", install 24" o.c.
RHEX	Rhapis excelsa ...Lady Palm	24	ea.	4' tall x 30" spread, multi
LARGE SHRUBS				
KEY	PLANT NAME	QTY.	UT.	SIZE
CLGU	Clusia guttifera ...Clusia	13	ea.	6' tall x 3' spread, full to ground
GROUNDCOVERS				
KEY	PLANT NAME	QTY.	UT.	SIZE
ERLI	Ernodea littoralis ...Golden Creeper	25	ea.	3 gal cans, full, install 18" o.c.
MISCELLANEOUS				
gravel	Decorative gravel to be selected	as req.	c.y.	as required
sod	"Empire" Zoysia Sod	as req.	s.f.	as required
	Planting Soil 70% Silica Sand 20% Everglades Muck 10% Shredded Pinebark	as req.	c.y.	excavate and backfill 18" depth in all planting areas.
	Roof Planter Soil Mix 25% Coarse Sand 25% Medium Sand 20% Pine Bark 20% Florida Peat 8% Rice Rock 2% Marl	as req.	c.y.	
	Shredded Melaleuca Mulch	as req.	c.y.	3" layer in all shrub beds
	CU Structural Soil	as req.	c.y.	30" deep under sidewalk

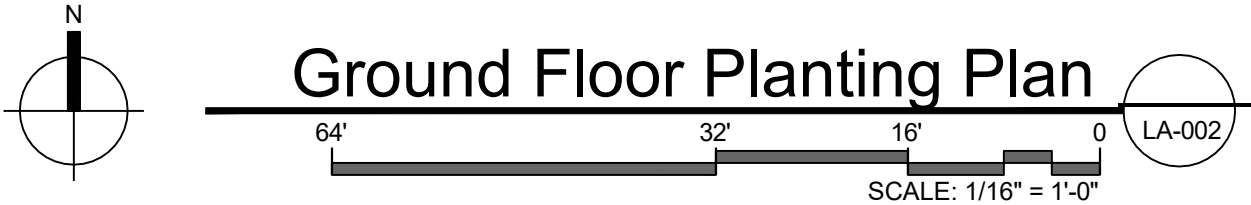

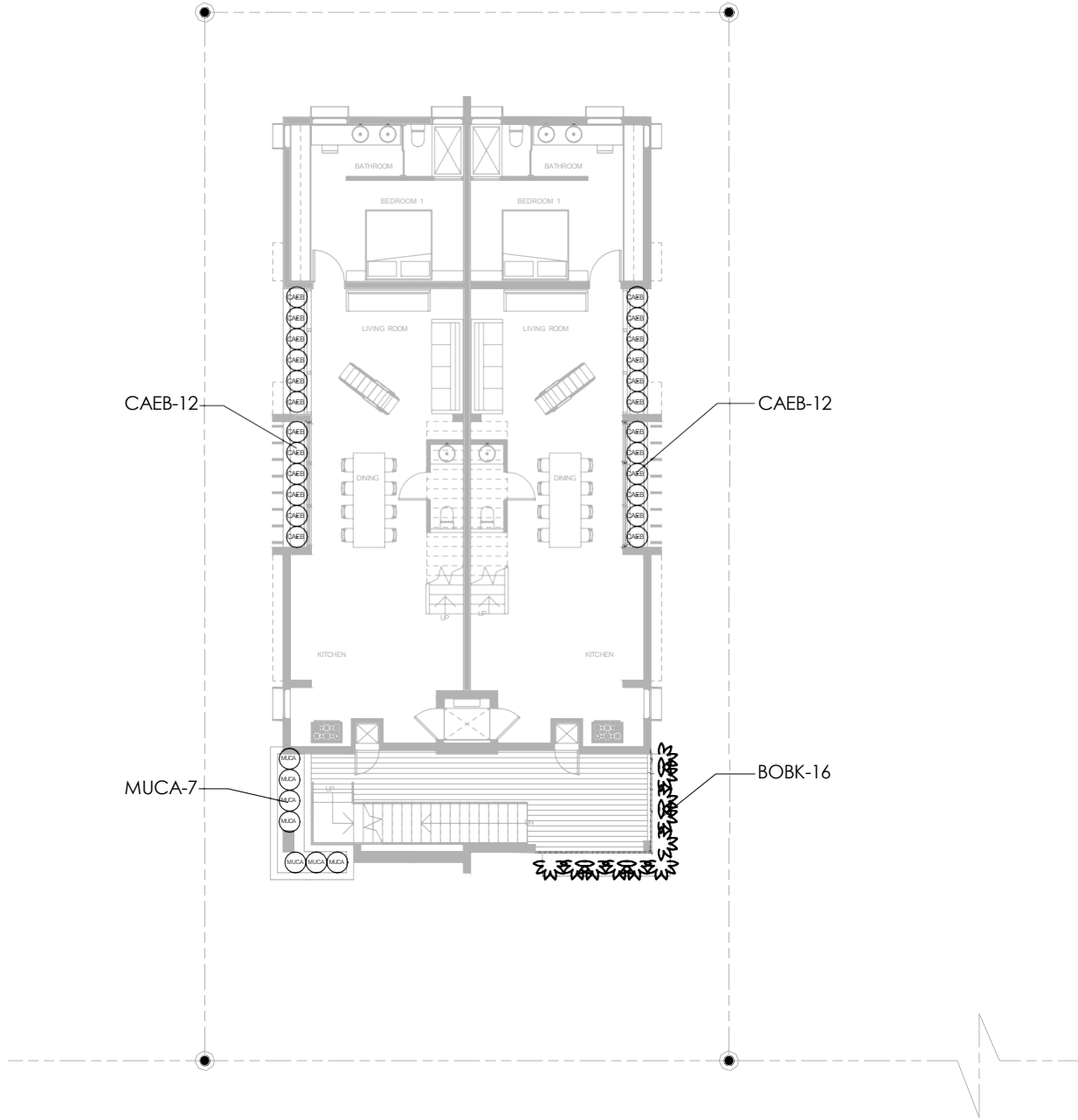

PLANT LIST - SECOND FLOOR				
SHRUBS				
KEY	PLANT NAME	QTY.	UT.	SIZE
BOBK	Bougainvillea spectabilis "Barbara Karst" ...Bougainvillea Barbara Karst	16	ea.	3 gallon cans, trellissed
CAEB	Carissa macrocarpa "Emerald Blanket" ...Natal Plum	24	ea.	3 gallon cans, 18" spread
MUCA	Muhlenbergia cappillaris ...Muhly Grass	7	ea.	3 gallon cans, full
MISCELLANEOUS				
Green Roof Soil Mixes From Atlas Soil				
	Roof Planter Soil Mix 25% Coarse Sand 25% Medium Sand 20% Pine Bark 20% Florida Peat 8% Rice Rock 2% Marl	as req.	c.y.	
	Shredded Melaleuca Mulch	as req.	c.y.	3" layer in all shrub beds

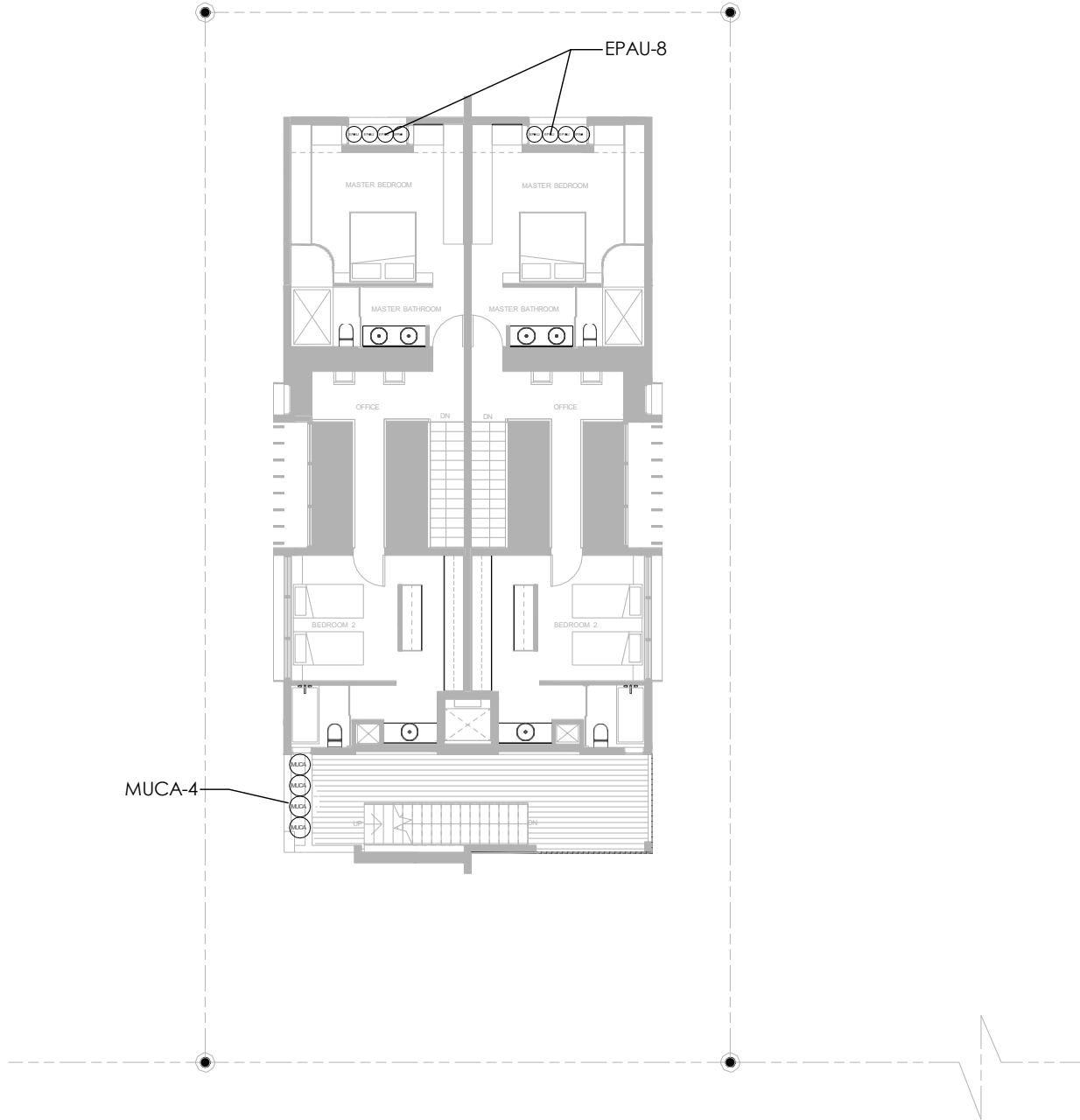

PLANT LIST - THIRD FLOOR				
SHRUBS				
KEY	PLANT NAME	QTY.	UT.	SIZE
EPAU	Epipremnum aureum ...Golden Pothos	8	ea.	1 gallon cans, 12" spread
MUCA	Muhlenberghia cappillaris ...Muhly Grass	4	ea.	3 gallon cans, full
MISCELLANEOUS				
Green Roof Soil Mixes From Atlas Soil				
	Roof Planter Soil Mix 25% Coarse Sand 25% Medium Sand 20% Pine Bark 20% Florida Peat 8% Rice Rock 2% Marl	as req.	c.y.	
	Shredded Melaleuca Mulch	as req.	c.y.	3" layer in all shrub beds

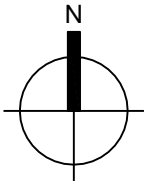

Third Floor Planting Plan

64'

32'

16'

0

LA-004

SCALE: 1/16" = 1'-0"

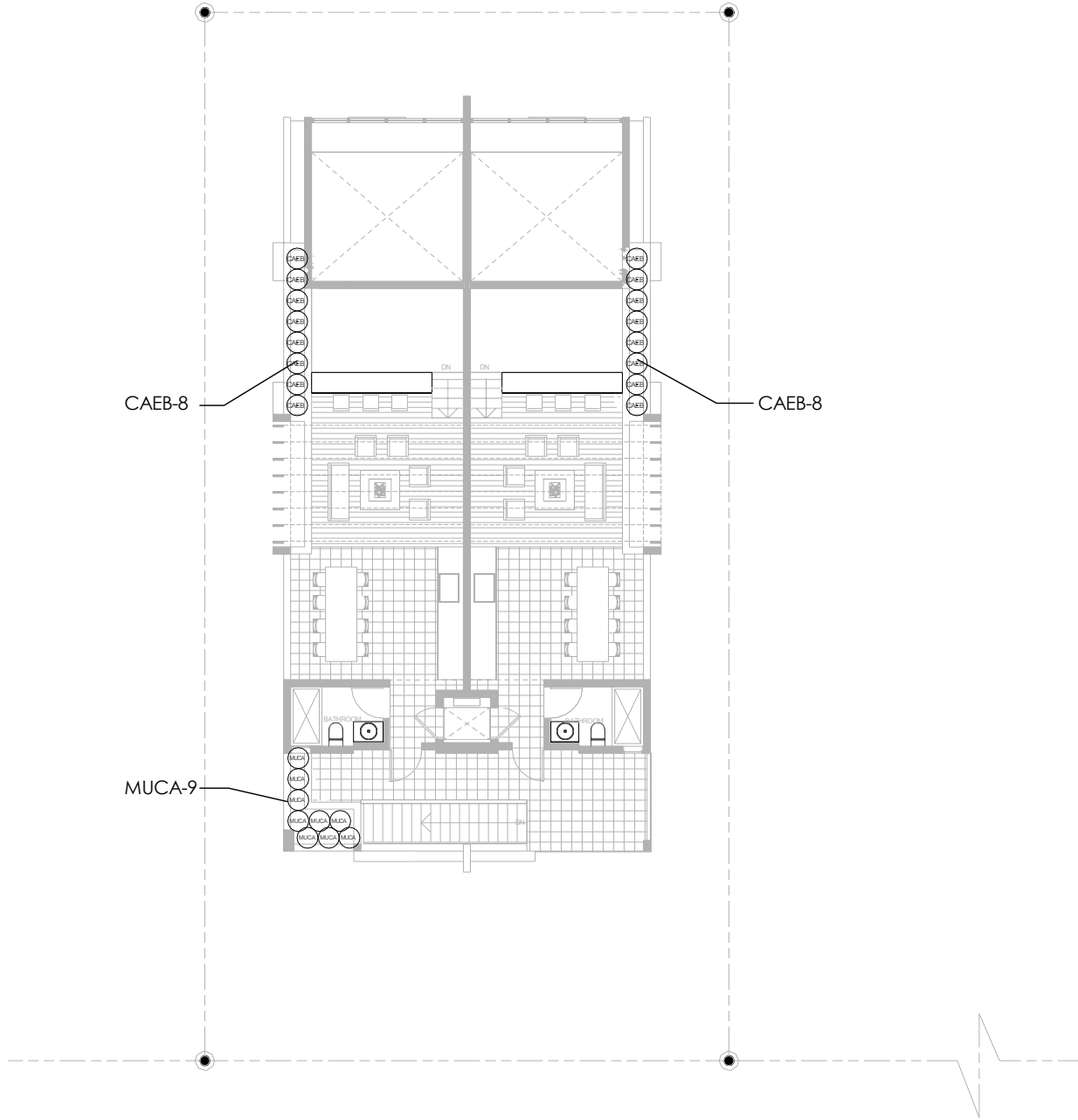

PLANT LIST - FOURTH FLOOR				
SHRUBS				
KEY	PLANT NAME	QTY.	UT.	SIZE
CAEB	Carissa macrocarpa "Emerald Blanket" ...Natal Plum	16	ea.	3 gallon cans, 18" spread
MUCA	Muhlenbergia cappillaris ...Muhly Grass	9	ea.	3 gallon cans, full
MISCELLANEOUS				
Green Roof Soil Mixes From Atlas Soil				
	Roof Planter Soil Mix 25% Coarse Sand 25% Medium Sand 20% Pine Bark 20% Florida Peat 8% Rice Rock 2% Marl	as req.	c.y.	
	Shredded Melaleuca Mulch	as req.	c.y.	3" layer in all shrub beds

N

Roof Level Planting Plan

64'32'16'0'

LA-005

SCALE: 1/16" = 1'-0"

GARDNER + SEMLER

LANDSCAPE ARCHITECTURE

WWW.GSLDESIGN.COM

DESIGN

17470 NW 78TH AVE., SUITE 214

MIAMI, FL 33155

P 305.392.1016 F 305.392.1019

CORP. 109000286

CASA LEROY

2229 14TH TERRACE MIAMI BEACH, FLORIDA 33139

MATEU ARCHITECTURE, INC.

8887 SW 131 STREET MIAMI, FLORIDA 33176

FIRST SUBMITTAL

04.29.2024

SCALE: N.T.S.

LA-006

CITY OF MIAMI BEACH			
LANDSCAPE LEGEND			
INFORMATION REQUIRED TO BE PERMANENTLY AFFIXED TO PLANS			
Zoning District: RM-1 Lot Area: 5,000 Acres: 0.11			
	OPEN SPACE	REQUIRED/ ALLOWED	PROVIDED
A.	Square feet of required Open Space as indicated on site plan: Lot Area = <u>5,000</u> s.f. x <u>30%</u> = <u>1500</u> s.f.	1,500	2,132
B.	Square feet of parking lot open space required as indicated on site		
	Number of parking spaces <u>0</u> x 10 s.f. parking space =	0	0
C.	Total square feet of landscaped open space required: A+B=	1,500	1,987
	LAWN AREA CALCULATION		
A.	Square feet of landscaped open space required	N/A	N/A
B.	Maximum lawn area (sod) permitted= <u>30%</u> x <u>5,000</u> s.f.	1,500	775
	TREES		
A.	Number of trees required per lot or net lot acre, less existing number of trees meeting minimum requirements= <u>28</u> trees x <u>0.11</u> net lot acres - number of existing trees=	4	4
B.	% Natives required: Number of trees provided x 30% =	2	4
C.	% Low maintenance / drought and salt tolerant required: Number of trees provided x 50%=	2	4
D.	Street Trees (max. average spacing of 20' o.c.) <u>40</u> (Driveway excluded) linear feet along street divided by 20' =	2	2
E.	Street tree species allowed directly beneath power lines: (max. average spacing of 20' o.c.): linear feet along street divided by	none	none
	SHRUBS		
A.	Number of shrubs required: Sum of lot and street trees req. x 12=	72	97
B.	% Native shrubs required: Number of shrubs provided x 50%=	36	73
	LARGE SHRUBS OR SMALL TREES		
A.	Number of large shrubs or small trees required: Number of required shrubs x 10%=	8	13
B.	% Native large shrubs or small trees required: Number of large shrubs or small trees provided x 50%=	4	13



CASA LEROY
1339 14TH TERRACE MIAMI BEACH, FLORIDA 33139

MATEU ARCHITECTURE, INC.
8887 SW 131 STREET MIAMI, FLORIDA 33176
TEL.: 305.233.3304
FAX.: 305.233.3326

FIRST SUBMITTAL 04.29.2024

LANDSCAPE SPECIFICATIONS
PART 1 - GENERAL

1.1 SCOPE

A. Contractor shall provide all labor, materials, equipment, supervision, and related work necessary to complete the landscape work in accordance with the intent of the landscape plans, schedules and these specifications. The extent of work is shown on the drawings which are a part of this document.

1.2 CONTRACTOR QUALIFICATIONS

A. Landscape installation work to be performed by a Contractor Certified by the Florida Nurserymen and Landscape Association (FNGLA) as a Certified Landscape Contractor. Any pruning to be supervised by an Arborist, certified by the International Society of Arboriculture (ISA) and licensed in the County where work is performed.

1.3 INVESTIGATION OF UTILITIES

A. Prior to beginning work, the Contractor shall be responsible to locate existing underground utilities. Call 811 or visit www.floridacalls11.com and Sunshine State, call (811).

1.4 SUBSTITUTIONS

A. Only materials specified will be accepted, unless approved in writing by the Landscape Architect in advance.

1.5 PLANT SIZES

A. All plant sizes shall equal or exceed the minimum sizes as specified in the plant list. If plant sizes and ordinances require larger plant material than specified on plans, then they shall supercede the sizes on the plan. When plant sizes are specified as a range of size, installed materials shall average the mean of the range specified. Plants shall be measured following pruning, with branches in normal position. All necessary pruning shall be done at the time of planting.

1.6 PLANT QUALITY

A. All plant material shall be equal to or better than Florida No. 1 as classified by "Grades for Nursery Plants" by the Division of Plant Industry, Florida Department of Agriculture. They shall have a growth habit that is normal for the species; healthy, vigorous, free from insects, disease and injury.

B. The Owner or Landscape Architect reserves the right to refuse any plant material which does not conform to the intent of the written specifications or design.

C. CIRCLING ROOTS FOUND ON CONTAINER-GROWN MATERIAL WILL NOT BE ACCEPTED UNLESS REMEDIAL ROOT PRUNING, APPROVED BY THE LANDSCAPE ARCHITECT IS DONE BEFORE PLANTING.

1.7 PLANT QUANTITY

A. The plant quantities shown on the plant list are to be used only as an aid to bidders. In the event of a discrepancy between the plant list and the plan, the quantity on the plan shall override the plant list.

1.8 UNIT PRICES

A. The materials furnished by the Contractor shall be at the prevailing market prices at the time of purchase. The Contractor shall submit a detailed unit price breakdown submitted to and accepted by the Owner.

1.9 SUBMITTALS

A. Fertilizer: The Contractor shall submit to the Owner and Landscape Architect the manufacturer's label for the fertilizer to be used for the project is of the analysis specified and placed at the rates specified in section 2.2 FERTILIZER.

2.2 FERTILIZER.

B. Planting soil: The Contractor shall submit a sample of the planting soil (approximately 1 cu. Ft.) for approval by the Landscape Architect prior to delivery to the site.

1.10 CLEAN-UP & MAINTENANCE OF TRAFFIC

A. Follow procedures in FDOT Index 600 for maintenance of traffic during construction.
B. At the end of each work day, the Contractor shall remove debris and shall barricade the un-filled holes in a manner appropriate in the path of pedestrians and motorists.
C. Upon completion of the work or any major portion of the work or as directed by the Landscape Architect, all debris and surplus material from his work shall be removed from the job site.

1.11 MAINTENANCE PRIOR TO ACCEPTANCE

A. The Contractor is responsible to maintain the plantings until they are accepted under the provisions of

1.12 "ACCEPTANCE OF INSTALLATION".

1. Plants: Begin maintenance immediately following the final plant installation operation for each plant and continue until all plant installation is complete and accepted.

Maintenance shall include watering all plants, weeding, mulching, pest and disease control, tightening and repairing of guys, repair of braces, removal of dead growth, resetting of plants to proper grade or up-right position, restoration of plant saucer, litter pick-up in plant beds and other necessary operations to assure specified minimum grade of Florida No. 1.

2. Turf Areas: Begin maintenance of turf immediately following the placement of sod and continue until sod installation is complete and accepted. Maintenance shall include but not be limited to, watering, leveling, mowing, weed and pest control, fungus and disease control and other necessary operations as determined by the Landscape Architect and good nursery practice.

3. Re-setting or straightening trees and palms:

The Contractor shall re-set and/or straighten trees and palms as required at no additional cost to the Owner unless caused by sustained winds of 75 mph or more. Then, the costs of the operations may be charged to the owner. Re-set trees within 48 hours.

1.12 ACCEPTANCE OF INSTALLATION

A. Inspection: Inspection of the work, to determine completion of contract work, exclusive of the possible replacement of plants and turf, will be made by the Landscape Architect at the conclusion of the maintenance period. Written notice requesting such an inspection and submitted by the Contractor at least ten (10) days prior to the anticipated date.

1.13 GUARANTEE

A. Guarantee all plants for a period of one year (CCD). Guarantee shall commence from the date of written acceptance. Plant material which is on the site and scheduled to be relocated is not covered by the guarantee except in the case of Contractor's negligence or work that has been done in an unworkman-like manner. The Contractor is not responsible for loss due to acts of god, (i.e.) sustained winds of 75 mph or more, floods, frost, lightning, vandalism or theft.

1.14 REPLACEMENT

A. Replacement shall be made during the guarantee period as directed by the Landscape Architect within ten (10) days from time of notification. For all replacement plant material, the guarantee period shall extend for an additional forty-five (45) days beyond the original guarantee period. The Contractor shall be responsible to provide water to the replacement plants in sufficient quantity to aid in their establishment. At the end of the guarantee period, inspection will be made by the Landscape Architect, upon written notice requesting such inspection and submitted by the Contractor at least five (5) days before the anticipated date. Replacement plants must meet the requirements of Florida No. 1 at time of inspection. Remove from the site all plants that are dead or in a state of unsatisfactory growth, as determined by the Landscape Architect. Replace the same or one of similar kind and size as the Contractor's negligence. The Contractor shall supply and plant the plants as specified under planting operations.

2. Cost of Replacements: A sum sufficient to cover the estimated cost of possible replacements, including material and labor will be retained by the Owner and paid to the Contractor after all replacements have been satisfactorily made and approved by the Landscape Architect.

PART 2 - MATERIALS

2.1 PLANTING SOIL

A. Planting soil for trees, shrubs and ground covers shall be of the composition noted on the drawings by volume.

B. Soil for Sodded Areas: shall be coarse lawn sand.

2.2 FERTILIZER

A. Fertilizer for trees, palms, shrubs, and groundcovers shall be as follows: LESCO 20-20-20 or equal, Sulfur coated with iron and other minor elements and maximum of 2% chlorine, or brand with equal analysis. The fertilizer shall be uniform in composition, dry and free flowing and shall be delivered to the site in the original unopened containers, bearing the manufacturer's guaranteed analysis. Fertilizer for sod and seeded areas shall be 8-6-8, 50% organically derived nitrogen, or equal.

2.3 WATER

A. The Contractor shall provide potable water on site, available from the start of planting. The Contractor is responsible to ascertain the location and accessibility of the water source. The Contractor shall provide the means of distribution (i.e. water truck, hoses, etc.) for distribution of water to the planting areas.

2.4 MULCH

A. Mulch shall be as specified on the Plant List.

2.5 ROOT BARRIER MATERIAL

A. Root barrier material shall be 24" deep polypropolytene panels by DeepRoot or equivalent details in the plans.

PART 3 - INSTALLATION PROCEDURES

3.1 LAYOUT

A. Verify location of all underground utilities and obstructions prior to excavation.
3.2 HERBICIDE TREATMENT
A. In all areas infected with weed and/or grass growth, a systemic herbicide shall be applied at the manufacturer's rates. When it has been established where work will be done, the systemic herbicide shall be applied in accordance with manufacturer's labeling to kill all noxious growth. Contractor shall schedule his work to allow more than one application to obtain at least 95% of the undesirable growth. At a test to establish suitability of product and applicator to be used on this project, prior to execution of the full application.

3.3 PLANT PIT EXCAVATION AND BACKFILLING

A. Trees: See the Planting and Bracing Details and notes.
B. All planting holes shall be hand dug where machine dug holes may adversely affect utilities or improvements.

C. Shrubs and Groundcover: Shrubs and groundcover shall be planted in a soil bed as described in the notes and details. Space shrubs and provide setback from curb and planters as shown in the plans.

D. Watering of field-grown plants: Thoroughly puddle in water to remove any air pockets in the plant hole.

3.4 WATERING

A. The Contractor is responsible to provide the water for all new plants and to maintain and water (by hand or water truck) during the maintenance period and extend into the guarantee until the full schedule as listed below is complete. Water for trees and other large field grown plants shall be supplemented by hand or water truck, in addition to the irrigation system, (if one is provided). Contractor can adjust watering schedule during heavy rain season upon approval of the Landscape Architect.

AMOUNT OF WATER PER APPLICATION
For trees up to 5 inch caliper - 5 gallons
From 5 to 8 inch caliper - 25 gallons
9 to 12 inch caliper - 50 gallons
13 to 18 inch caliper - 75 gallons
Daily for the first week
3 times per week for weeks 2 - 5
2 times per week for weeks 6 - 8
1 time per week for weeks 9 - 12

B. Water in plants by thoroughly soaking of the entire root ball immediately after planting. For large trees and shrubs, add water while backfilling hole to eliminate any air pockets in the soil around the root ball.

C. Water shrubs, sod and groundcover a minimum of once daily for a week or until an irrigation system is fully operational. If no irrigation system is to be installed, the Contractor shall be responsible for watering the shrub, sod, and groundcover for the time specified above, after installation of each section of the planting installed.

Landscape Specifications

SCALE: N.T.S.

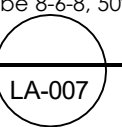

CASA LEROY
2339 34TH TERRACE MIAMI BEACH, FLORIDA 33139
MATEU ARCHITECTURE, INC.
MIAMI, FLORIDA 33176
8887 SW 133 STREET
TEL.: 305.233.3304
FAX.: 305.233.3326
FIRST SUBMITTAL
04.29.2024

3.5 FERTILIZING

A. Add fertilizer on top of the surface of shrubs beds and tree and palms root balls over (2) installation. Fertilize sod within two (2) days after installing after planting of each sod. Fertilizer shall be applied after soil has been well moistened. Fertilizer shall be washed off of plant stems immediately after application. Apply at the following rates:

1. Trees and Large Shrubs: One (1) pound per inch of trunk diameter, spread evenly over the root ball area.
2. Shrubs: One half (1/2) handful per shrub, spread evenly over the root ball area.
3. Groundcover: Twelve (12) pounds per 100 sq. ft. of bed area.
4. Sod: Twelve (12) pounds per 1,000 sq. ft. Wash fertilizer off blades immediately after spreading.

3.6 MULCHING

A. Spread mulch three (3) inches thick uniformly over the entire surface of shrubs and palm beds. Mulch depth to be measured after settling, unless otherwise specified in the plans. Provide 36" diameter bed of mulch, measured from outer edge of the trunk, for all trees and palms planted in sod areas. Keep mulch away from contact with the trunk. Create a 6" high ring of mulch at the outer edge of tree and palm holes.

3.7 GUYING AND BRACING

A. See the details bound herewith or made part of the plans.

3.8 SODDING

A. Provide a blanket of lawn sand as described in the notes in these plans. Prior to planting, remove stones, sticks, etc. from the sub-soil surface. Excavate existing non-conforming soil as required so that the finish grade of sod is flush with adjacent pavement or top of curb as well as adjacent sod in the case of sod patching.

B. Place sod on moistened soil, with edges tightly butted, in staggered rows at right angles to slopes. The sod shall be rolled with a 500 pound hand roller immediately after placing.

C. Keep edge of sod bed a minimum of 18" away from groundcover beds and 24" away from edge of shrub beds and 36" from trees, measured from the edge of plant or tree trunk.

D. Sod shall be watered immediately after installation to uniformly wet the soil to at least two inches below the bottom of sod strips.

E. Apply fertilizer to the sod as specified in Section 3.5.

F. Excavate and remove excess soil so top of sod is flush w/top of curb or adjacent pavement, or adjacent existing sod.

PLANT BED PREPARATION NOTES

1. In all areas where new sod and shrub and groundcover masses are to be planted, kill all existing weeds by treating with systemic herbicide prior to beginning soil preparation.
2. In all shrub and groundcover beds, excavate and backfill soil as described in "Plant List(s)". If no specific preparation is noted, prepare soil as described below for either condition, over the entire area to be planted:

Condition A:
If any compacted road base or asphalt or rocky soil is encountered, remove compacted material entirely to allow an 18" depth of planting soil per plant list unless otherwise stated. Backfill the entire area of the shrub and groundcover beds with 18" planting soil (as specified in Plans) to within 2 inches of the adjacent pavement or top of curb. Remove all debris and rocks and pebbles larger than 2 inches in size and level the grade before planting.

Condition B:
Where no compacted soil is encountered, thoroughly mix 6 inches of planting soil per plant list into the existing soil to a depth of 18 inches unless otherwise stated. If required, excavate and remove the existing soil to lower the grade, so that the prepared mix is finished to a minimum of 2 inches below top of curb or adjacent walkway. Remove all debris and rocks and pebbles larger than 2 inches in size and level the grade before planting.

For all sod areas, spread a 2" deep layer of lawn sand prior to sodding. Remove all debris and rocks and pebbles larger than 2 inches in size and level the grade before sodding. Remove, if required, existing soil so that top of sod is flush with and adjacent top of curb or pavement.

For Trees and shrubs larger than 7 gallon, Add Diehard" transplant innoculant supplied by Horticultural Alliance, Inc. (800-628-6373) or equal. Mix into top 8-10 inches of planting hole, making sure it is contact with the root ball. Add at a rate specified by manufacturer (typically 4oz. per 1 inches of trunk caliper or 7 gallon can).

SPACING OF PLANTS (SEE PLANT SPACING DETAIL)

1. Plants shall be planted sufficiently away from edges of pavements or curbs, to allow for growth toward the edges of the bed.

PROTECTION OF PLANTS

1. The Contractor shall be responsible to protect existing trees and shrubs in and adjacent to the area of work. Erect barriers as necessary to keep equipment and materials, any toxic material, away from the canopy drip line of trees and shrubs. DO NOT PILE SOIL OR DEBRIS AGAINST TREE TRUNKS OR DEPOSIT NOXIOUS BUILDING SUPPLIES OR CHEMICALS WITHIN THE DRIP LINE.

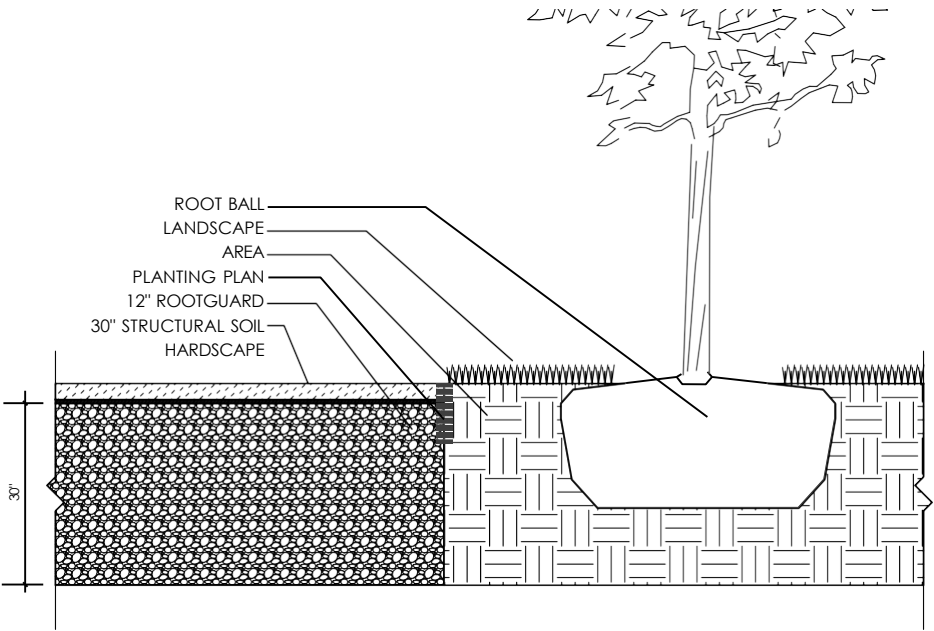

STRUCTURAL SOIL DETAIL
(TYP.)

N.T.S.

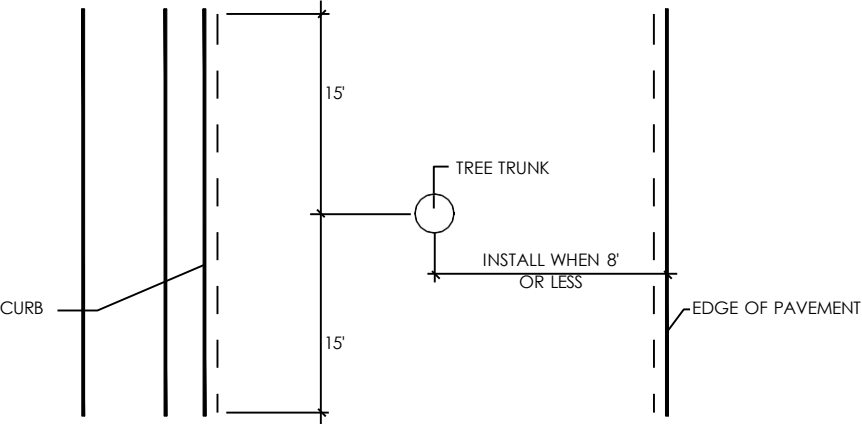

PLAN
VIEW

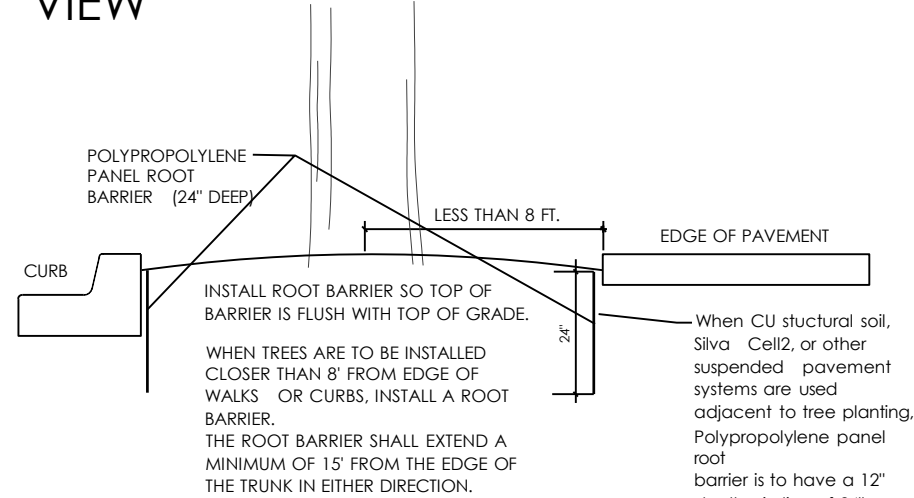

ROOT BARRIER INSTALLATION
DETAIL

N.T.S.

Landscape Specifications
& Planting Details

SCALE: N.T.S.

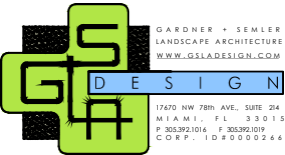
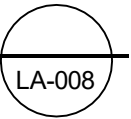

GARDNER + SEMLER
LANDSCAPE ARCHITECTURE
WWW.GSLADESIGN.COM
17470 NW 78TH AVE., SUITE 204
MIAMI, FL 33155
P 305.392.1016 F 305.392.1019
CORP. 109000286

CASA LEROY
2239 14TH TERRACE MIAMI BEACH, FLORIDA 33139
MATEU ARCHITECTURE, INC.
8887 SW 133 STREET MIAMI, FLORIDA 33176
TEL.: 305.233.3304 FAX.: 305.233.3326
FIRST SUBMITTAL 04.29.2024

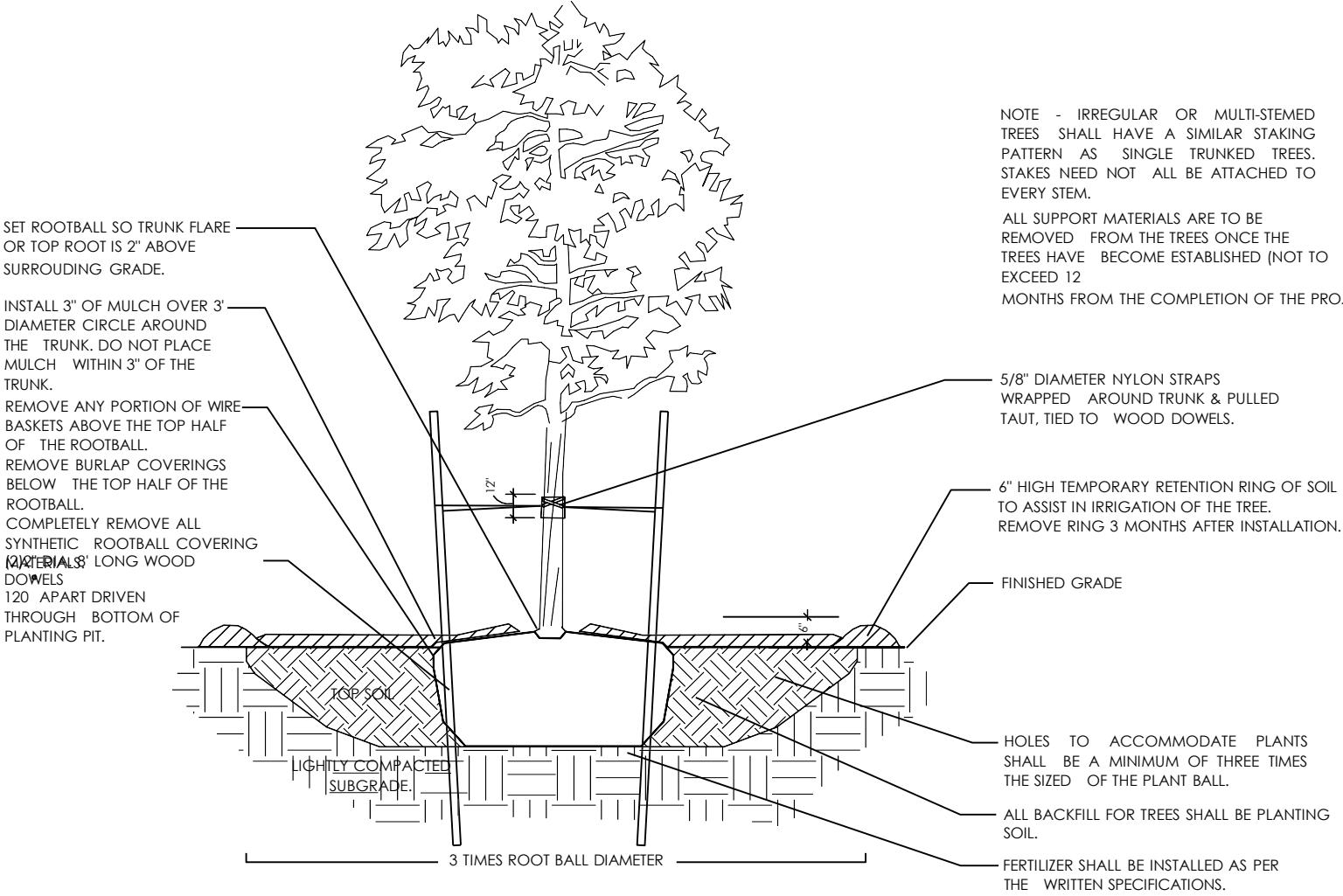

PLANTING & BRACING
DETAIL UNDER 3 1/2"
CALIPER

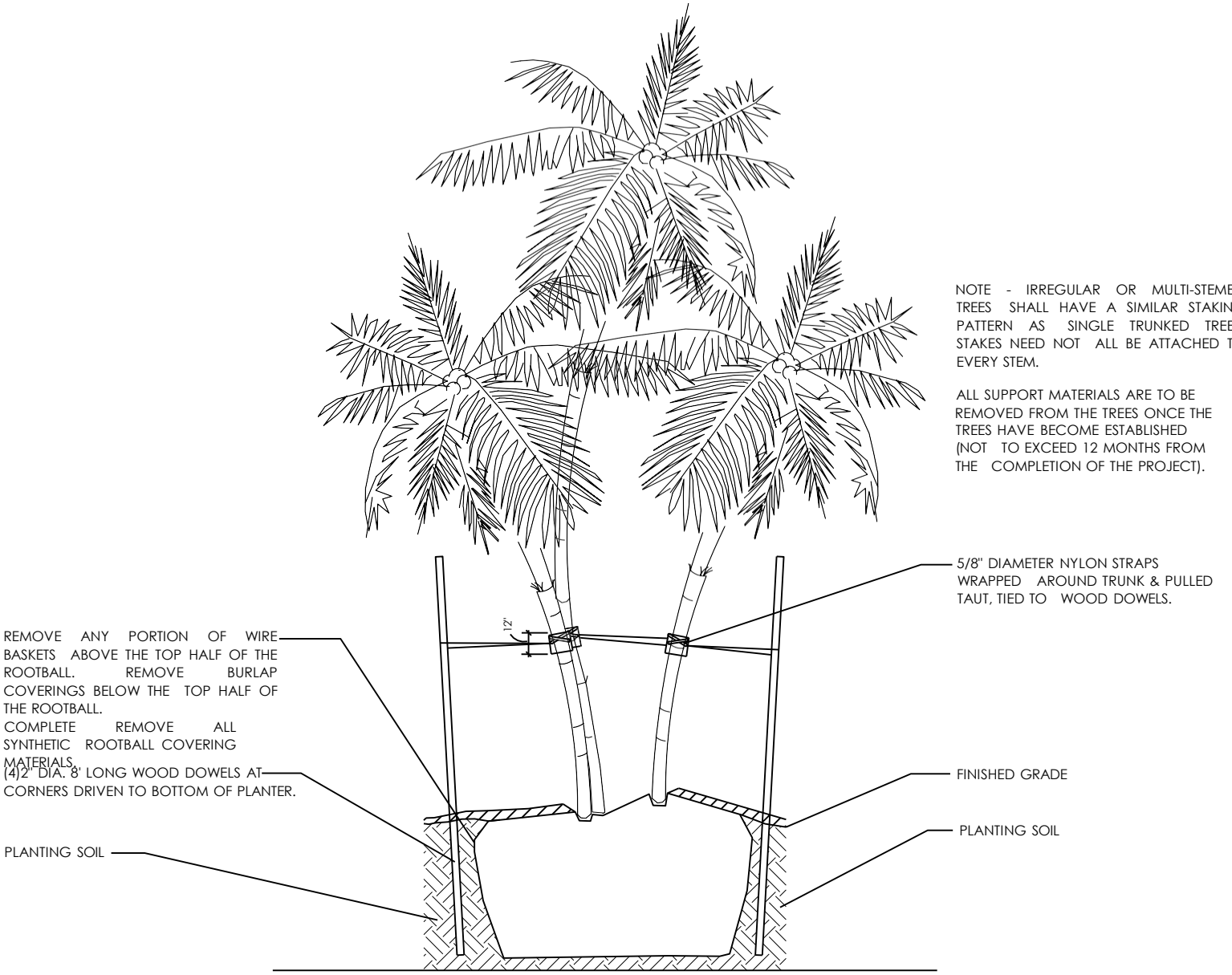

MULTI-TRUNKED TREE/PALM BRACING
DETAIL

A
N.S.

WOOD STAKES TOP OF STAKES
BELOW OR FLUSH WITH
GRADE.

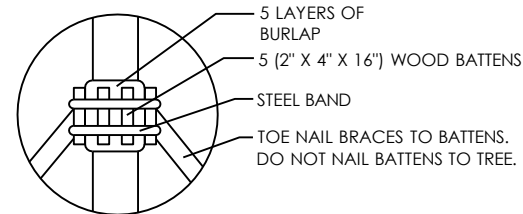
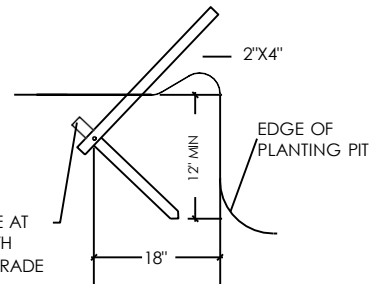

B.S.

— FERTILIZER SHALL BE INSTALLED AS PER THE WRITTEN SPECIFICATIONS.

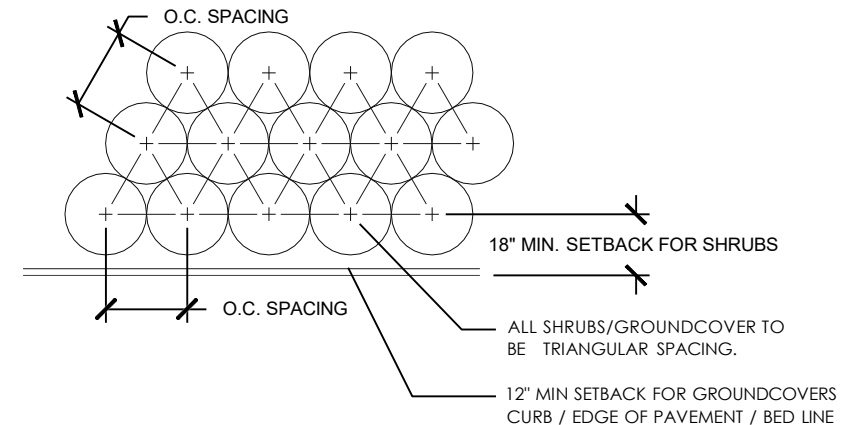

N.T.S

NOTE:
THE PERIMETER OF ALL CURVED
PLANTING BEDS SHALL BE PLANTED
WITH ROW OF SHRUBS AS SHOWN IN
THE PLANT AND AT THE SPACING
SHOWN IN THE PLANT LIST.
INTERIOR PORTIONS OF EACH BED
SHALL BE PLANTED AT APPROPRIATE
SPACING
ACCORDING TO THIS PLANT
SPACING DETAIL.

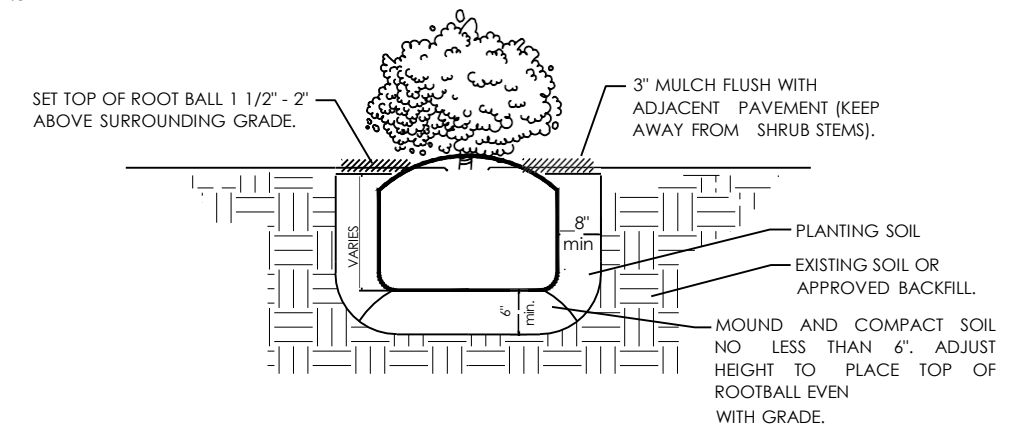

N.T

N.T.S.