

Printed on Monday, February 12, 2024, 4:25 PM by Max Kaplan
C:\Users\maxk\OneDrive\Documents\1960 NORMANDY DRIVE - 1960 NORMANDY DRIVE - SCHEMATIC UTILITY PLAN - 2400011 - THOMAS

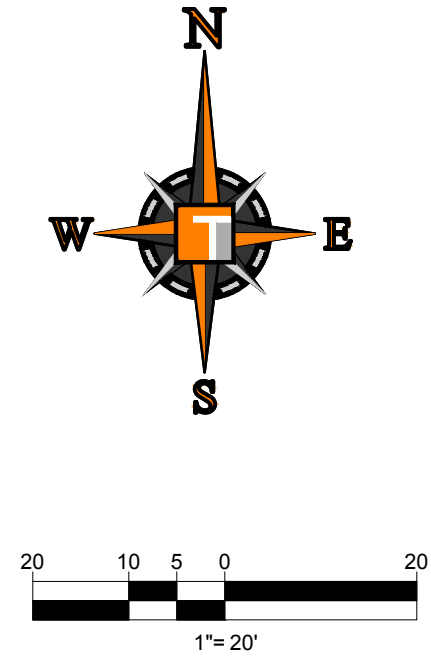
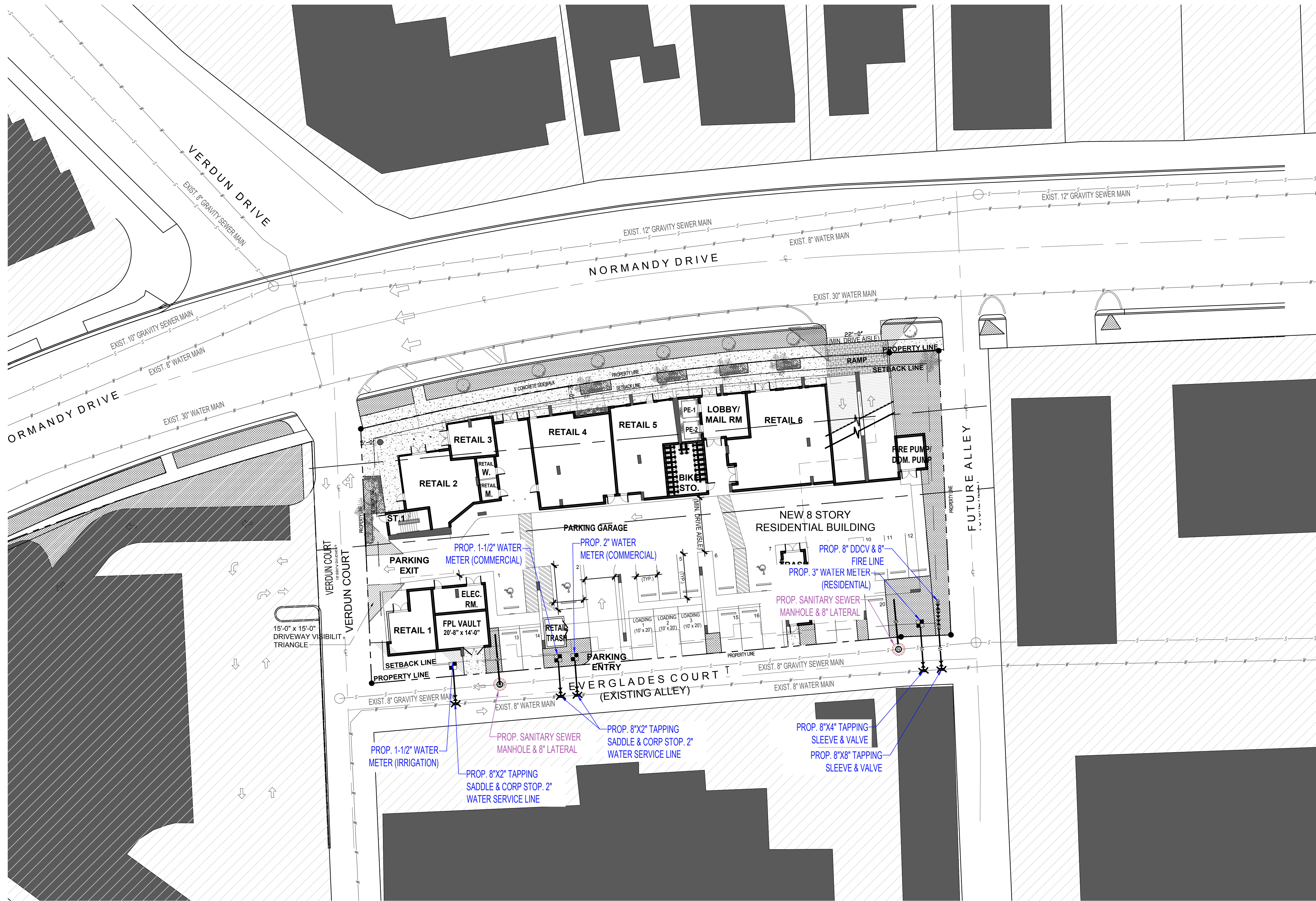

THOMAS
ENGINEERING GROUP
CIVIL ENGINEERS - PROJECT MANAGERS - LAND PLANNING - LANDSCAPE ARCHITECTS
1502 W. FLETCHER AVE.
MIAMI BEACH, FL 33139
P: (305) 379-4100
F: (305) 379-4101
WWW.THOMASENGINEERINGGROUP.COM

REVISIONS			
REV.	DATE	COMMENT	BY

Sunshine
Call 811 or visit sunshine811.com two full business days before digging to have buried facilities located and marked.
Check positive response codes before you dig!

PROJECT No.: F240011
DRAWN BY: JFV
CHECKED BY: MTK
DATE: 02/08/2024
CAD I.D.: F240011 SCHEMATIC UTILITY

PROJECT:
1960 NORMANDY DRIVE
FOR
ALAN WASERSTEIN
MIAMI BEACH FL

THOMAS
ENGINEERING GROUP
6300 NW 31ST AVENUE
FORT LAUDERDALE, FL 33309
PH: (954) 202-7000
FX: (954) 202-7070
www.ThomasEngineeringGroup.com

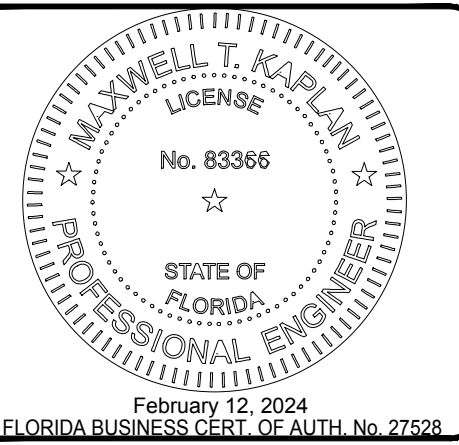

SHEET TITLE:
SCHEMATIC UTILITY PLAN
SHEET NUMBER:
C-01

THIS ITEM HAS BEEN DIGITALLY SIGNED AND SEALED BY MAXWELL T. KAPLAN ON THE DATE ADJACENT TO THE SEAL.
PRINTED COPIES OF THIS DOCUMENT ARE NOT CONSIDERED SIGNED AND SEALED AND THE SIGNATURE MUST BE VERIFIED ON ANY ELECTRONIC COPIES.