

LIQUOR SURVEY

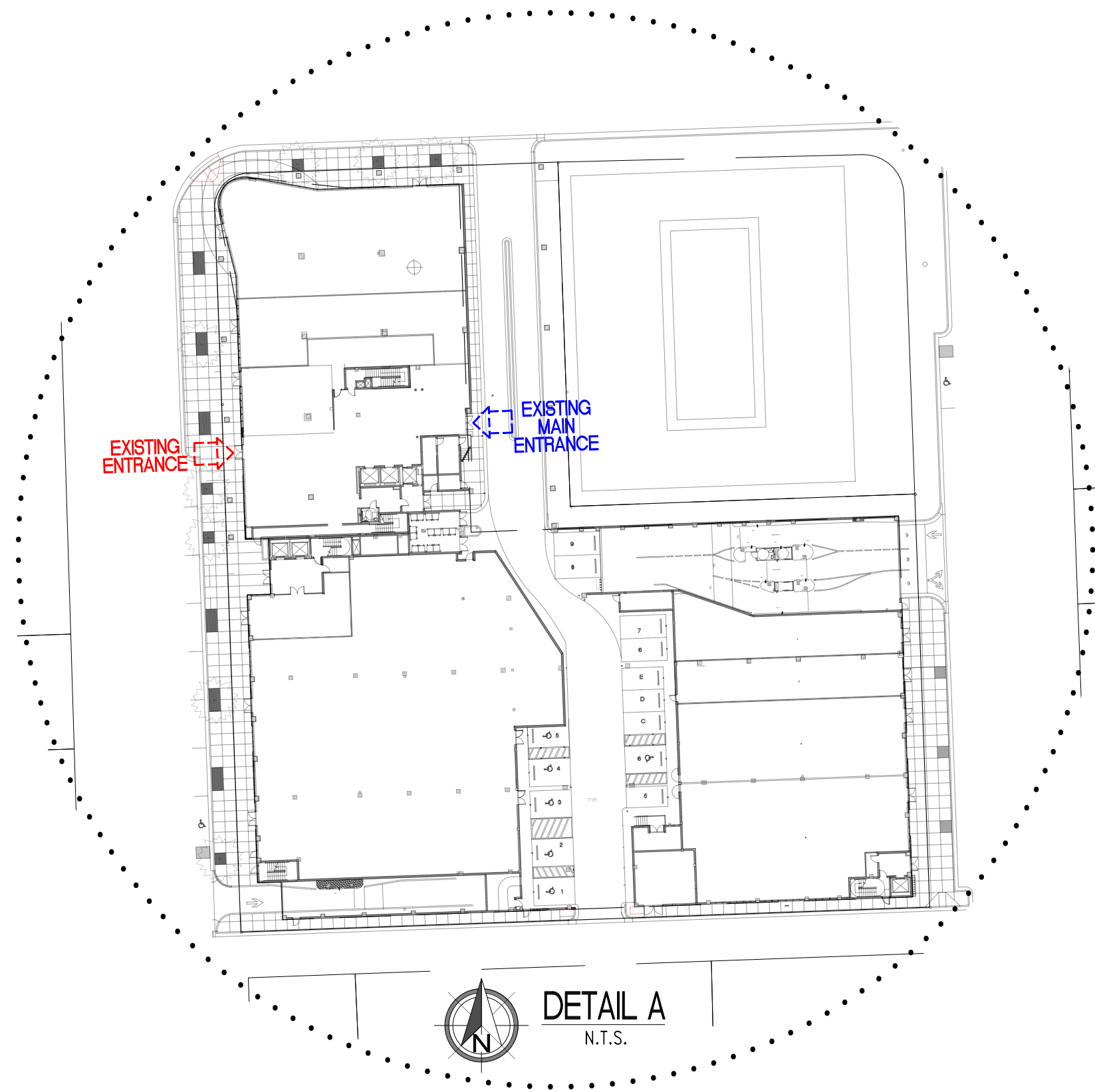
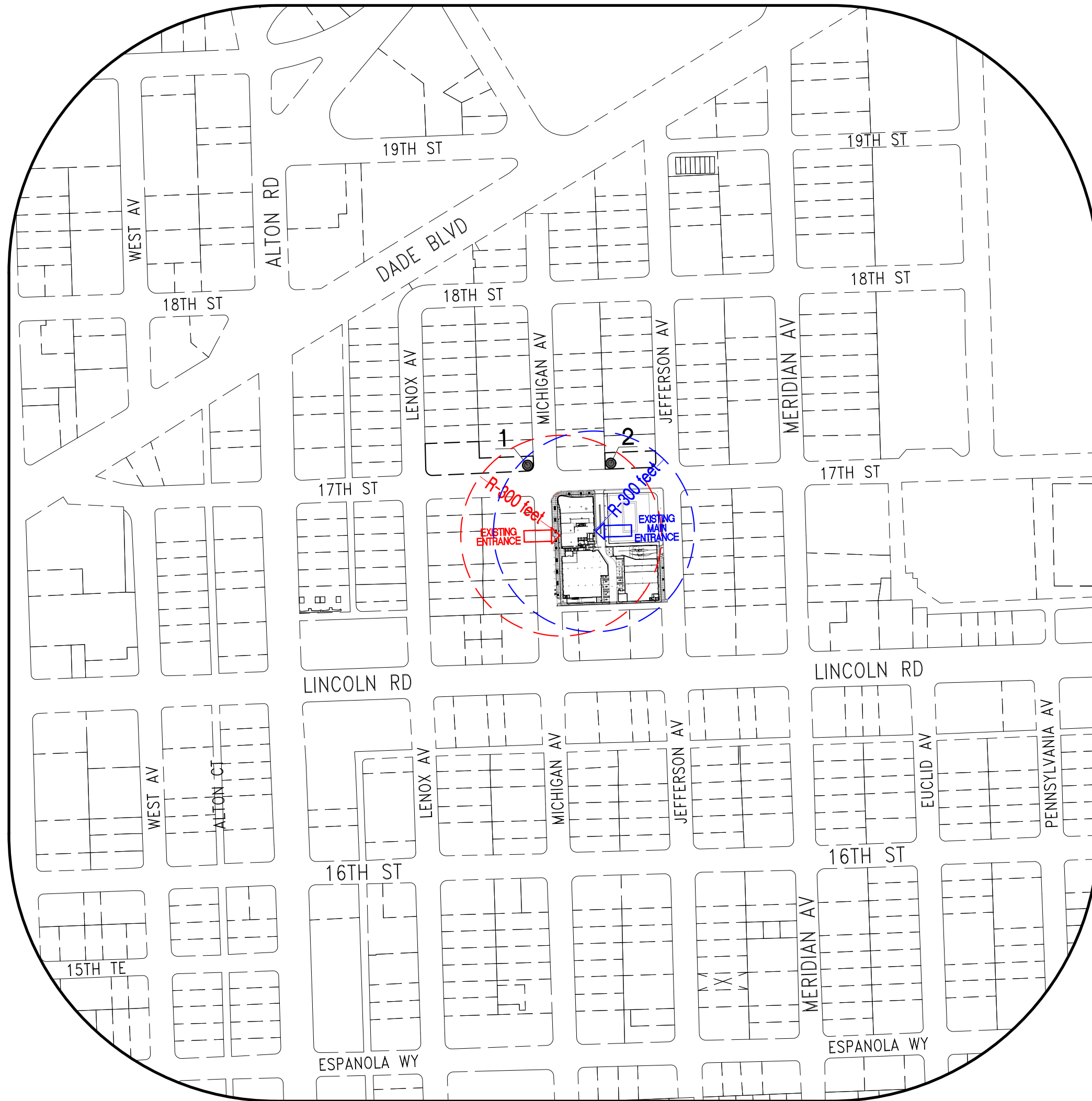
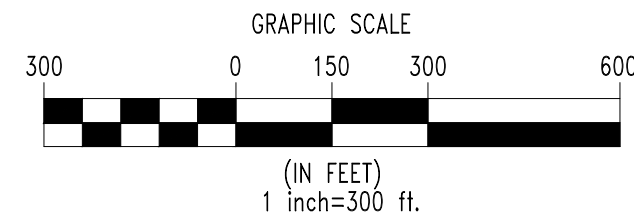
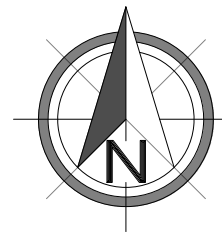

SURVEYOR REPORT and NOTES

- THIS IS NOT A BOUNDARY SURVEY, THIS IS LIQUOR SURVEY FOR PROPOSED LIQUOR LICENSE.
- DATE OF SURVEY: 03-06-2024.
- ACCORDING TO MEASUREMENTS TAKEN AT THE SITE THERE IS ONE (1) PUBLIC OR PRIVATE ELEMENTARY SCHOOL, MIDDLE SCHOOL, OR SECONDARY SCHOOL WITHIN 300 FEET ALONG THE STRAIGHT LINE, MEASURED AND COMPUTED, FROM THE MAIN FRONT ENTRANCE OF THE PROPOSED PLACE OF BUSINESS TO THE NEAREST POINT ON A PARCEL OF LAND OCCUPIED BY A PARCEL OF LAND SET ASIDE FOR, AND USED, OR PROPOSED TO BE USED, FOR PUBLIC OR PRIVATE ELEMENTARY SCHOOL, MIDDLE SCHOOL, OR SECONDARY SCHOOL PURPOSES.
- ACCORDING TO MEASUREMENTS TAKEN AT THE SITE THERE IS ONE (1) HOUSE OF WORSHIP WITHIN 300 FEET ALONG THE STRAIGHT LINE, MEASURED AND COMPUTED, FROM THE MAIN FRONT ENTRANCE OF THE PROPOSED PLACE OF BUSINESS TO THE NEAREST POINT ON A PARCEL OF LAND OCCUPIED BY A HOUSE OF WORSHIP.
- LIQUOR LICENSING TYPES SHOWN HERE (IF APPLICABLE), ACCORDING TO FLORIDA DEPARTMENT OF BUSINESS PROFESSIONAL REGULATION, IN CASE OF A DISCREPANCY, HAS BEEN PROVIDED AND VERIFIED BY THE CLIENT OR LAWYER COMPANY.
- THIS SURVEY HAS BEEN PREPARED FOR THE EXCLUSIVE USE OF THE ENTITIES NAMED HEREON.
- THE EXISTING ENTRIES SHOWN HERE ON, ARE LOCATED EXACTLY ACCORDING TO EXISTING GROUND FLOOR PLAN FOR 1691 MICHIGAN AVENUE, MIAMI BEACH, FL 33139, SENT BY THE CLIENT.

SURVEYOR'S CERTIFICATION

I HEREBY CERTIFY, THAT THE ATTACHED "LIQUOR SURVEY" OF THE ABOVE DESCRIBED PROPERTY IS TRUE AND CORRECT TO THE BEST OF MY KNOWLEDGE AND BELIEF AS RECENTLY SURVEYED UNDER MY DIRECTION, AND WAS PREPARED IN ACCORDANCE WITH CURRENT STANDARDS OF PRACTICE SET FORTH BY THE FLORIDA STATE BOARD OF PROFESSIONAL SURVEYORS AND MAPPERS, PURSUANT TO RULE 5J-17 OF THE FLORIDA ADMINISTRATIVE CODE AND ITS IMPLEMENTING LAW, CHAPTER 472.027 OF THE FLORIDA STATUTES.

Seal:

Date: 06.25.2024

The seal appearing on this document was authorized by Francisco L Nunez, Jr, PSM, on the date adjacent to seal

- THIS SURVEY IS CONSIDERED VALID ONLY:
- 1) IN HARD COPY, WITH ORIGINAL SIGN AND RAISED SEAL.
 - 2) IN ELECTRONIC FILE, DIGITALLY SIGNED AND SEALED UNDER RULE 5J-17.062, F.A.C.

Francisco L. Nunez Jr.
PROFESSIONAL SURVEYOR AND MAPPER No.6382
STATE OF FLORIDA

ITEM No.	ADDRESS	NAME	LICENSE TYPE	STATUS	DISTANCE (Along the linear feet distance) ENTRANCE (Michigan)	DISTANCE (Along the linear feet distance) MAIN ENTRANCE
1	1700 MICHIGAN AVENUE, MIAMI BEACH, FL 33139	CUBAN HEBREW CONGREGATION OF MIAMI TEMPLE BETH SHMUEL		ACTIVE	216 FEET	263 FEET
2	1700 JEFFERSON AVENUE, MIAMI BEACH, FL 33139	LINCOLN-MARTI SCHOOL DAYCARE		ACTIVE	238 FEET	189 FEET

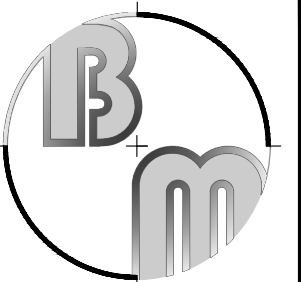

designGroup
SURVEYORS
MAPPERS | LAND PLANNERS

p: (305) 551-8511
c: (786) 877-7176
a: 15045 SW 26th Terrace,
Miami, FL 33185-5617
e: bm@bmsurveyors.com

License Business No: 8369

RECORD OF REVISION

No.	DATE	DESCRIPTION

Project Name:

Type of Project:

LIQUOR SURVEY
ADD INFORMATION

Project Address(es):

1691 MICHIGAN AVENUE,
MIAMI BEACH, FL 33139

Folio No(s):

02-3234-004-0690

Prepared for:

BLACK LION
INVESTMENT GROUP

Scale: As shown

Drawn By: BM

Checked By: FLN

Field Date: March 06/2024

Drawn Date: June 25/2024

F.B./PG.: FILE/RMB

Project No.:

24-0103

Sheet: 1 of 1