

EXISTING TREE LIST

Tree #	Botanical Name	Common Name	DBH in inches	OAH in feet	Spread in feet	Notes/Condition (All are fair to good unless otherwise noted)
1	Bursera simaruba	Gumbo limbo	9.5	12-14	18-22	To remain
2	Quercus virginiana	Live oak	25	35-40	25-30	To remain
3	Schefflera actinophylla	Umbrella tree	15	25-30	20-25	Invasive species to be removed
4	Quercus virginiana	Live oak	12	30-35	15-20	To remain
5	Quercus virginiana	Live oak	11.5	35-40	20-25	To remain
6	Washingtonia robusta	Washingtonia palm	13	50-60	12-14	Exempt from permit requirements
7	Washingtonia robusta	Washingtonia palm	13	50-60	12-14	Exempt from permit requirements
8	Washingtonia robusta	Washingtonia palm	13	35-40	12-14	Exempt from permit requirements
9	Quercus virginiana	Live oak	14	35-40	30-35	To remain
10	Quercus virginiana	Live oak	16	35-40	30-35	To remain
11	Washingtonia robusta	Washingtonia palm	14	60-65	12-14	Exempt from permit requirements
12	Cocos nucifera	Coconut palm	9	40-45	20-25	To be removed
13	Cocos nucifera	Coconut palm	9	30-35	20-25	To be removed
14	Cocos nucifera	Coconut palm	9	35-40	20-25	To be removed
15	Washingtonia robusta	Washingtonia palm	14	60-65	12-14	Exempt from permit requirements
16	Sabal palmetto	Sabal palm	8	30-35	10-12	To be relocated
17	Sabal palmetto	Sabal palm	8	30-35	10-12	To be relocated
18	Quercus virginiana	Live oak	3	10-11	6-8	To remain
19	Quercus virginiana	Live oak	3	10-11	6-8	To remain
20	Quercus virginiana	Live oak	3	10-11	6-8	To remain
21	Quercus virginiana	Live oak	3	10-11	6-8	To remain
22	Quercus virginiana	Live oak	3	10-11	6-8	To remain
23	Tabebuia heterophylla	Pink trumpet tree	12	35-40	20-25	To be relocated on site
24	Quercus virginiana	Live oak	16	20-25	20-25	To remain
25	Sabal palmetto	Sabal palm	8	30-35	10-12	To be relocated on site
26	Sabal palmetto	Sabal palm	8	30-35	10-12	To be relocated on site
27	Sabal palmetto	Sabal palm	8	30-35	10-12	To be relocated on site
28	Sabal palmetto	Sabal palm	8	30-35	10-12	To be relocated on site
29	Sabal palmetto	Sabal palm	8	30-35	10-12	To be relocated on site
30	Sabal palmetto	Sabal palm	8	30-35	10-12	To be relocated on site
31	Sabal palmetto	Sabal palm	8	20-25	10-12	To be relocated on site
32	Sabal palmetto	Sabal palm	8	25-30	10-12	To be relocated on site
33	Sabal palmetto	Sabal palm	7	30-35	10-12	To be relocated on site
34	Sabal palmetto	Sabal palm	7	25-30	10-12	To be relocated on site
35	Sabal palmetto	Sabal palm	10	30-35	10-12	To be relocated on site
36	Sabal palmetto	Sabal palm	6	30-35	10-12	To be relocated on site
37	Sabal palmetto	Sabal palm	7	30-35	10-12	To be relocated on site
38	Phoenix sylvestris	Date palm	12	25-30	15-20	To be relocated on site
38A	Schefflera actinophylla	Umbrella tree	24	40-45	30-35	Invasive species to be removed
39	Sabal palmetto	Sabal palm	8	20-25	10-12	To be relocated on site
40	Sabal palmetto	Sabal palm	8	30-35	10-12	To be relocated on site
41	Sabal palmetto	Sabal palm	8	30-35	10-12	To be relocated on site
42	Phoenix reclinata	Senegal Date palm	40	25-30	30-35	To be removed. Category 1, no mitigation requi
43	Sabal palmetto	Sabal palm	8	30-35	10-12	To be relocated on site
44	Sabal palmetto	Sabal palm	8	30-35	10-12	To be relocated on site
45	Sabal palmetto	Sabal palm	8	40-45	10-12	To be relocated on site
46	Bucida buceras	Black Olive	28	40-45	30-35	To remain. Recommended pruning off roadway
47	Bucida buceras	Black Olive	24	40-45	60-65	To remain
48	Ravenala madagascariensis	Travelers Palm	16	15-20	15-20	To be removed
49	Bursera simaruba	Gumbo limbo	7	12-14	15-20	To remain
50	Washingtonia robusta	Washingtonia palm	13.5	50-60	12-14	Exempt from permit requirements
51	Quercus virginiana	Live oak	21	30-35	45-50	To remain
52	Washingtonia robusta	Washingtonia palm	13	50-60	12-14	Exempt from permit requirements
53	Washingtonia robusta	Washingtonia palm	N/A	8-10	6-7	Exempt from permit requirements
54	Washingtonia robusta	Washingtonia palm	12	40-45	12-14	Exempt from permit requirements
54A	Washingtonia robusta	Washingtonia palm	N/A	6-7	5-6	Exempt from permit requirements
55	Quercus virginiana	Live oak	20	30-35	40-45	To remain
56	Washingtonia robusta	Washingtonia palm	13	40-45	12-14	Exempt from permit requirements
57	Quercus virginiana	Live oak	20	30-35	40-45	To remain
58	Washingtonia robusta	Washingtonia palm	13	40-45	12-14	Exempt from permit requirements
59	Washingtonia robusta	Washingtonia palm	13	40-45	12-14	Exempt from permit requirements
60	Washingtonia robusta	Washingtonia palm	13	20-25	12-14	Exempt from permit requirements
61	Quercus virginiana	Live oak	12.5	20-25	20-25	Poor condition-remove
62	Washingtonia robusta	Washingtonia palm	13	35-40	12-14	Exempt from permit requirements
63	Ptychosterma elegans	Alexander palm	4	30-35	8-10	Poor condition-remove
64	Sabal palmetto	Sabal palm	8	30-35	10-12	Relocate
65	Sabal palmetto	Sabal palm	8	20-25	10-12	Relocate
66	Thrinax sp.	Thatch palm	4	15-20	6-8	Relocate
67	Thrinax sp.	Thatch palm	4	15-20	6-8	Relocate
68	Thrinax sp.	Thatch palm	4	15-20	6-8	Relocate

NOTES:

ALL EXISTING TREES TO REMAIN
PRESERVE+PROTECT DURING
CONSTRUCTION EXCEPT FOR PROHIBITED

EXISTING TREE SYMBOLS ARE GRAPHIC AND
LOCATION MAY VARY

EX. TREE SYMBOLS

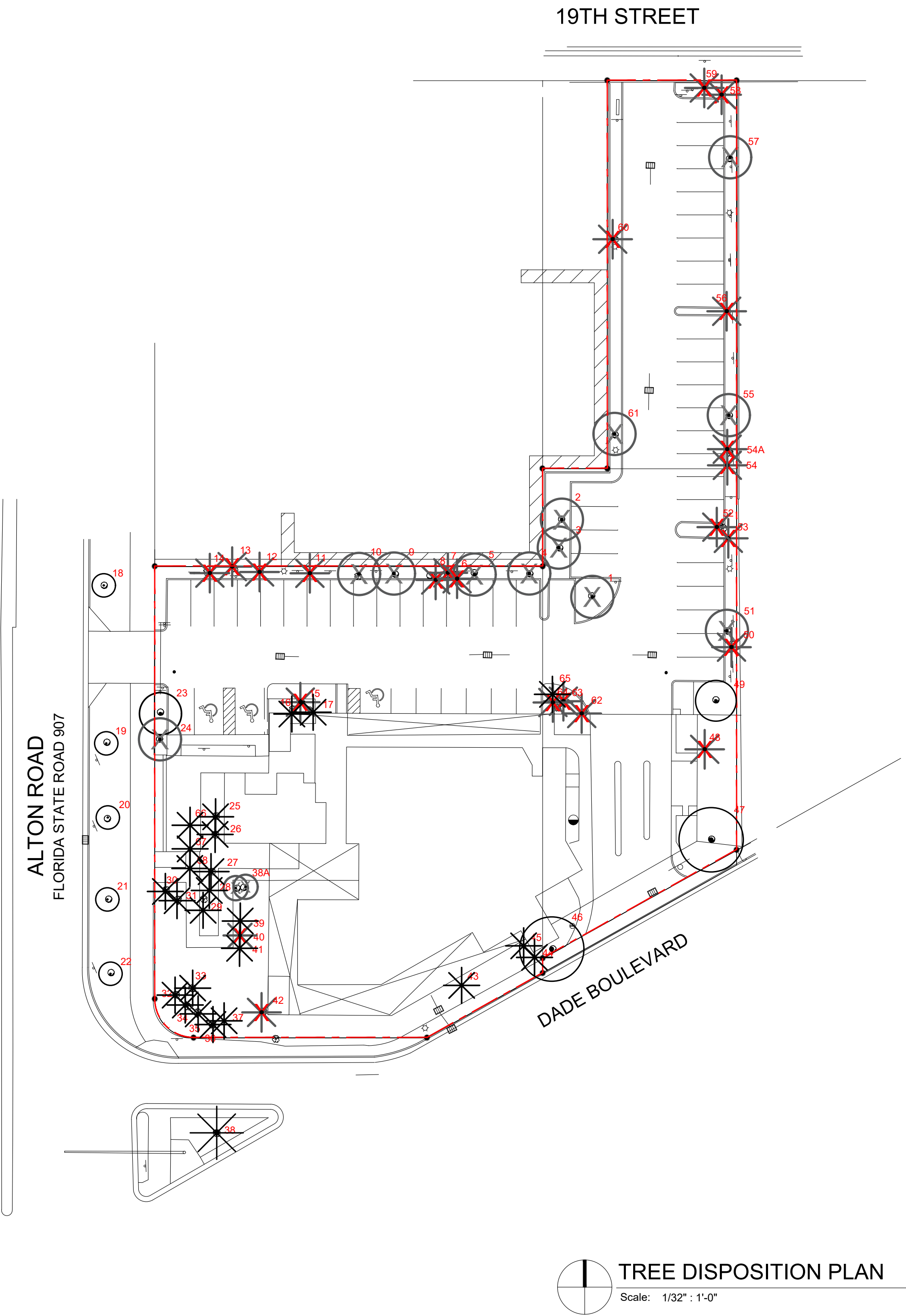
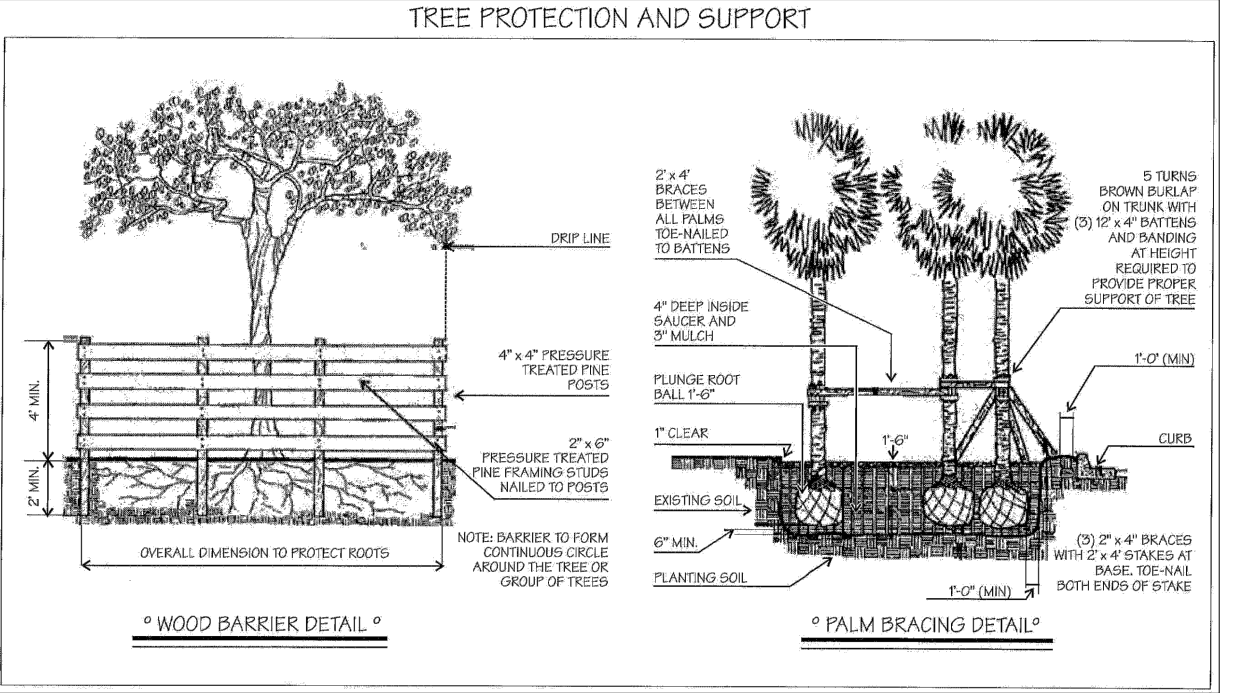
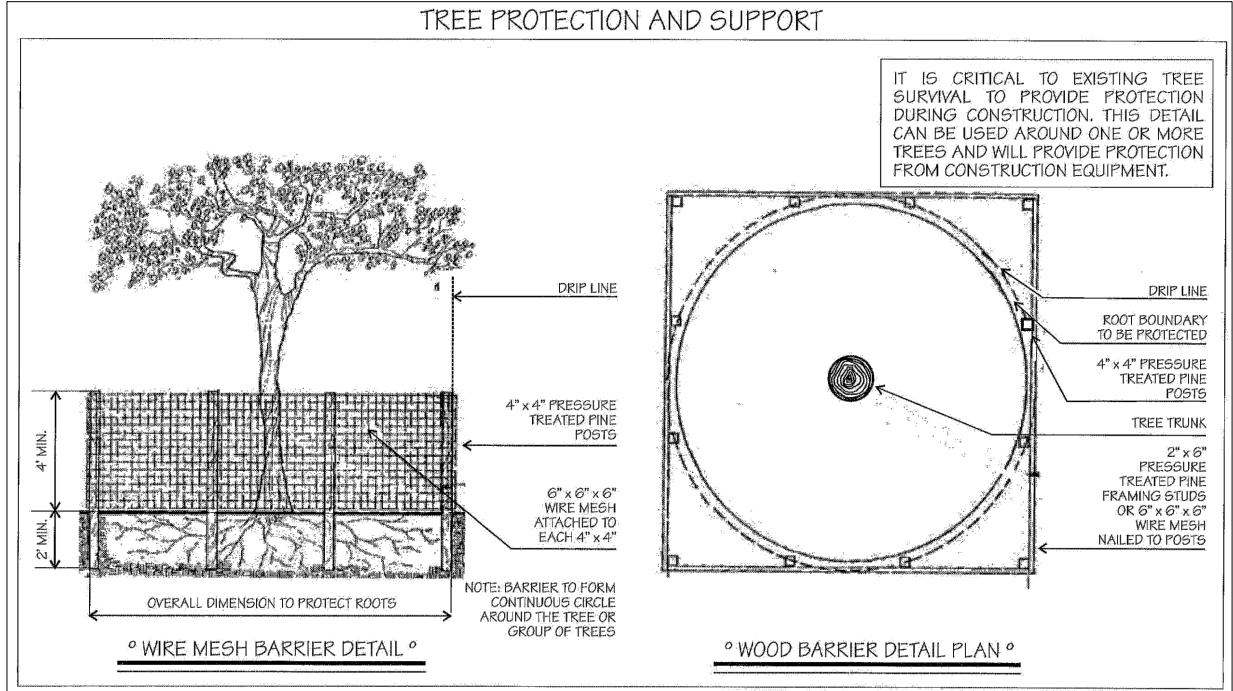
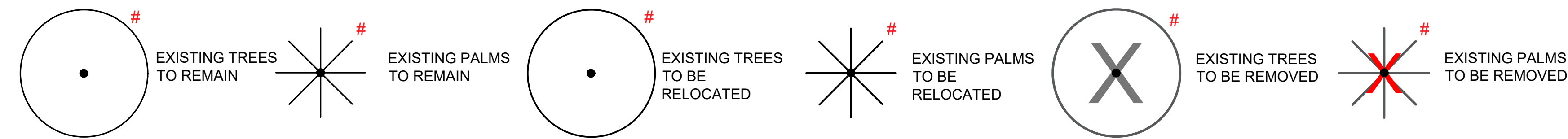

LANDSCAPE ARCHITECT
FL RLA LIC. #6667191
9822 NE 2ND AVE, SUITE #10
MIAMI SHORES, FL 33138
P. 786.346.8909
www.VincentFiligenzi.com

PROFESSIONAL SEAL:

SEAL:

Vincent Filigenzi
Digitally signed by Vincent Filigenzi
Date: 2024.04.05 13:01:11 -0400
VINCENT A. FILIGENZI
LA #6667191

NOTE:
These architectural drawings and plans are the property of Vincent Filigenzi, architect, VFD INC. These drawings and plans shall not be reproduced for use by any individual or entity or any other project without express written permission.

2ND LEVEL COMMERCIAL
TENANT IMPROVEMENT
1801 ALTON ROAD
MIAMI BEACH, FLORIDA 33139

SHEET ISSUE:		
REV #	DATE	DESCRIPTION

DRAWN BY: SJ
CHECKED BY: VF
DATE: 03.12.2024

DISCIPLINE / SHEET TITLE:

TREE
DISPOSITION
PLAN

SHEET NUMBER:

LD-1.0

PLANT LIST

SYM	BOTANICAL NAME	COMMON NAME	SPEC	NATIVE	DROUGHT	QTY
TREES + PALMS						
Rre	<i>Roystonea regia</i>	Florida Royal Palm	45' OA 18" GW 20" CAL	*	*	1
Bsi	<i>Bursera simaruba</i>	Gumbo Limbo	20' HT 8"-10" DBH	*	*	2
Tba	<i>Tabebuia bahamensis</i>	Bahama Tabebuia Tree	14'-16" HT OA 4"-6" DBH	*	*	1
Cer1	<i>Conocarpus erectus var. sericeus</i>	Silver Buttonwood Tree	8'-10' OA STD. 2"-3" DBH	*	*	16
Cer2	<i>Conocarpus erectus</i>	Green Buttonwood Tree	18' OA 4"-6" DBH Multi w/ Character	*	*	3
SHRUBS + ACENTS						
PL	<i>Psychotria ligustrifolia</i>	Bahama Coffee	15G		*	21
SR	<i>Serenoa Repens</i>	Silver Saw Palmetto	25G @ 4' HT	*	*	4
TF	<i>Tripsacum floridiana</i>	Gamma Grass	7 GAL	*	*	18
ZP	<i>Zamia pumila</i>	Coontie	3 GAL. @ 24" OC	*	*	33
AO	<i>Silver odorata bromeliad</i>	Alcantarea Odorata	30" X 30"		*	9
HP	<i>Hamelia patens</i>	Firebush	15G		*	56
CC	<i>Capparis cynophallophora</i>	Jamaican Caper	25G	*	*	25
CW	<i>Carapa guianensis</i>	Crabwood	25G	*	*	27
CG	<i>Clusia guttifera Hedge</i>	Small Leaf Clusia	25G		*	88
DS	<i>Dioon spinulosum</i>	Giant Dioon	4' HT		*	1
FK	<i>Pennisetum fakahatchee</i>	Fakahatchee Grass	7G	*	*	2
ZF	<i>Zamia Floridana</i>	Coontie Palm	15G	*	*	4
GROUNDCOVERS						
EL	<i>Emodea littoralis</i>	Golden Creeper	1 GAL @ 18" OC	*	*	35
TF	<i>Tripsacum floridiana</i>	Gamma Grass	3 GAL @ 36" OC	*	*	452
AG	<i>Perenninal Peanut</i>	Wild Peanut	1 GAL @ 18" OC		*	1430
CM	<i>Carissa</i>	Emerald Blanket	3 GAL. @ 24" OC	*	*	165
BM	<i>Philodendron</i>	Burle Marx	3 GAL. @ 24" OC		*	116
SOD	Empire Zoysia		2,161 SF			

LANDSCAPE LEGEND

Transect Zone CD-1	Lot Area: 46,845.00	Acres: 1.080	REQUIRED/ ALLOWED	PROVIDED
--------------------	---------------------	--------------	----------------------	----------

TREES

A. Number of trees required per net lot acre, less existing number of trees
meeting minimum requirements =

22 trees x 1.080 net lot acres – number of existing trees (6) = **18** **22**

B. % Natives required: Number of trees provided x 30% =		
$22 \times .30 = 7$ Native Trees required	7	21

C. % Drought tolerant and low maintenance:		
Number of trees provided x 50% =		
22 x .5 = 11 <i>Drought & Low Maintenance Trees required</i>	11	22

D. Street Trees (maximum average spacing of 20' o.c.):
 237 linear feet along street / 20 =
 237 / 20 = 12 *Street Trees required.* **12** **12**

E. Street trees located directly beneath power lines: (maximum average spacing of 20' o.c.): _____ linear feet along street / 20 = **N/A** **N/A**

SHRUBS

A. Number of shrubs required: Number of trees required x 12 =		
<i>18X 12 = 216 Shrubs required</i>	216	303

B. % Native shrubs required: Number of shrubs provided x 30% =		
<i>288 X .30 = Native shrubs required</i>	87	113

GENERAL PLANTING NOTES

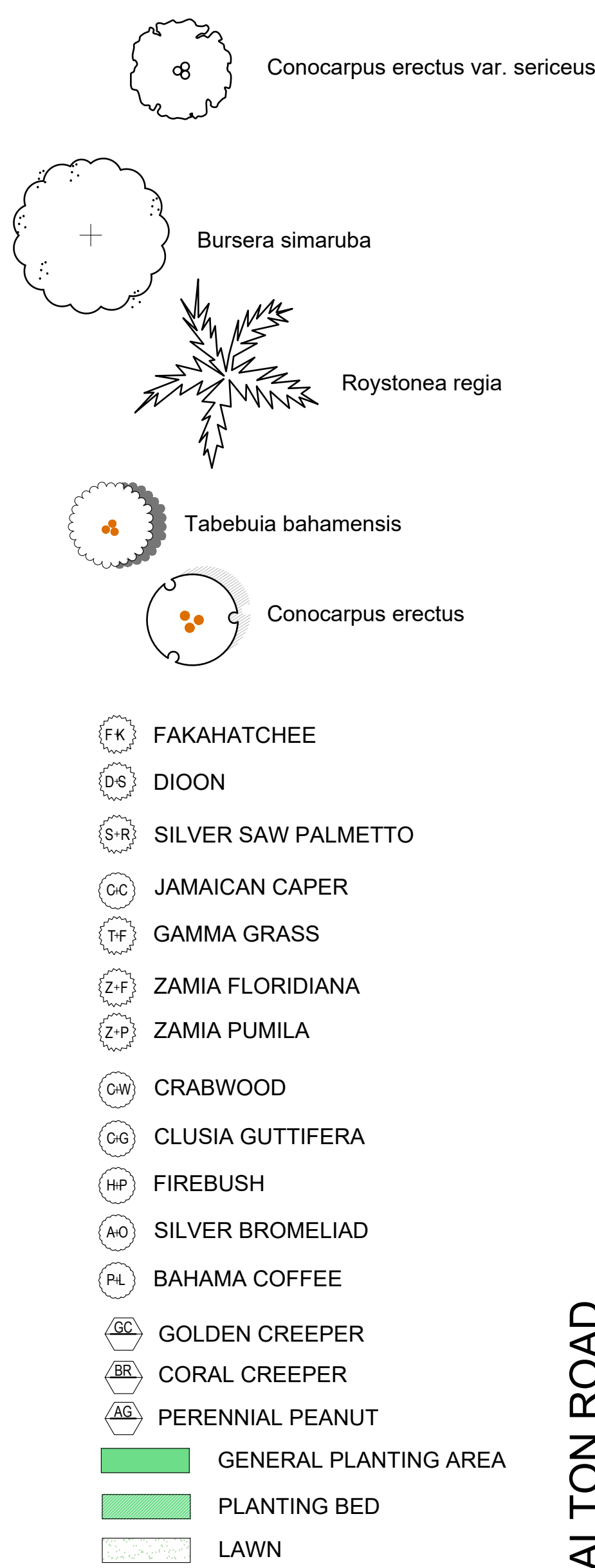
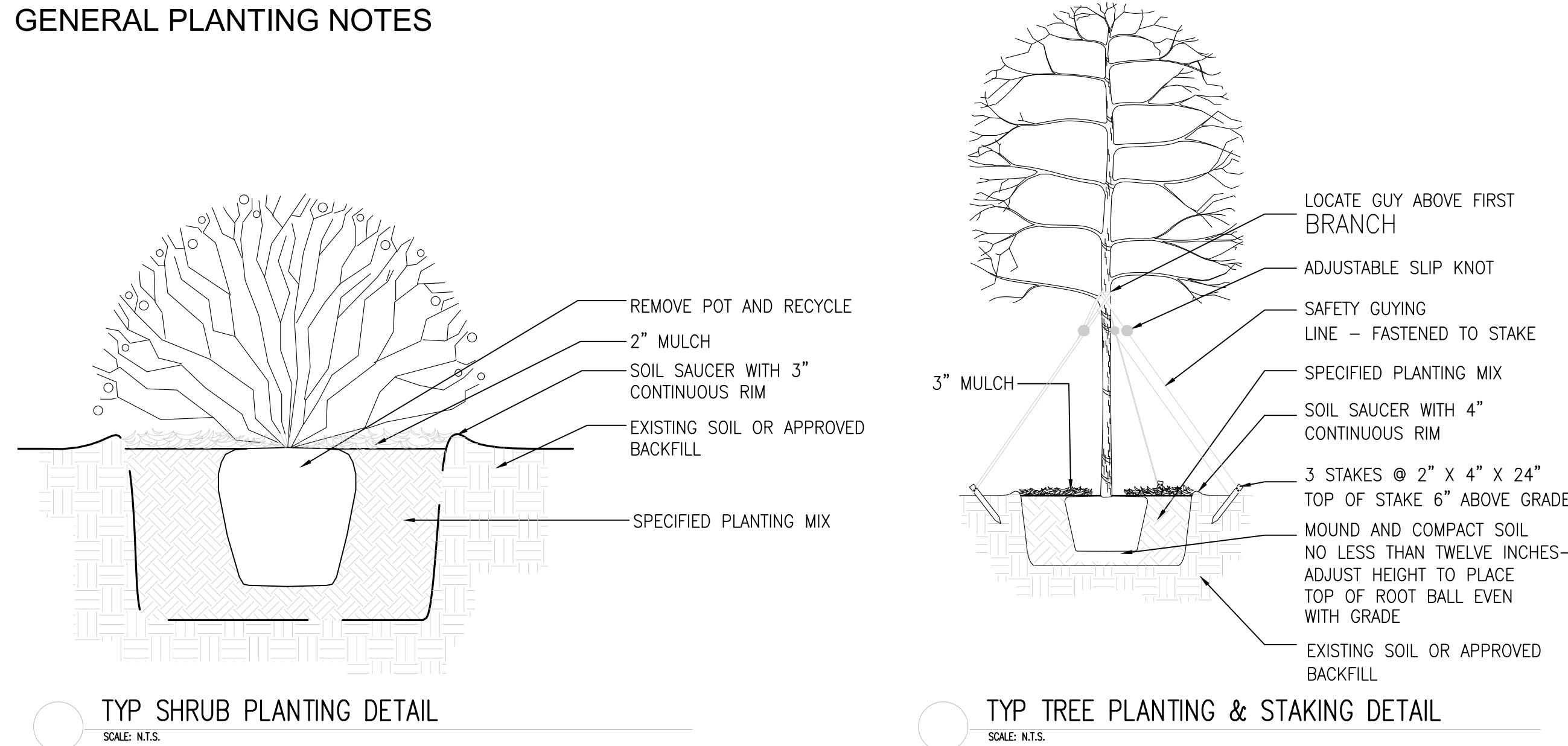

<u>PROPOSED F.A.R. CALCULATIONS</u>		
<u>LOCATION</u>	<u>USE</u>	<u>AREA</u>
LEVEL 1:	OFFICE/RETAIL	4,938.69 SF
4,938.69 SF / 300 SF / SPACE=		16.46 SP
TOTAL PARKING REQ'D:		16.46 SP
LEVEL 1 PARKING PROV'D		67 SP
TOTAL PARKING PROV'D:		67 SP

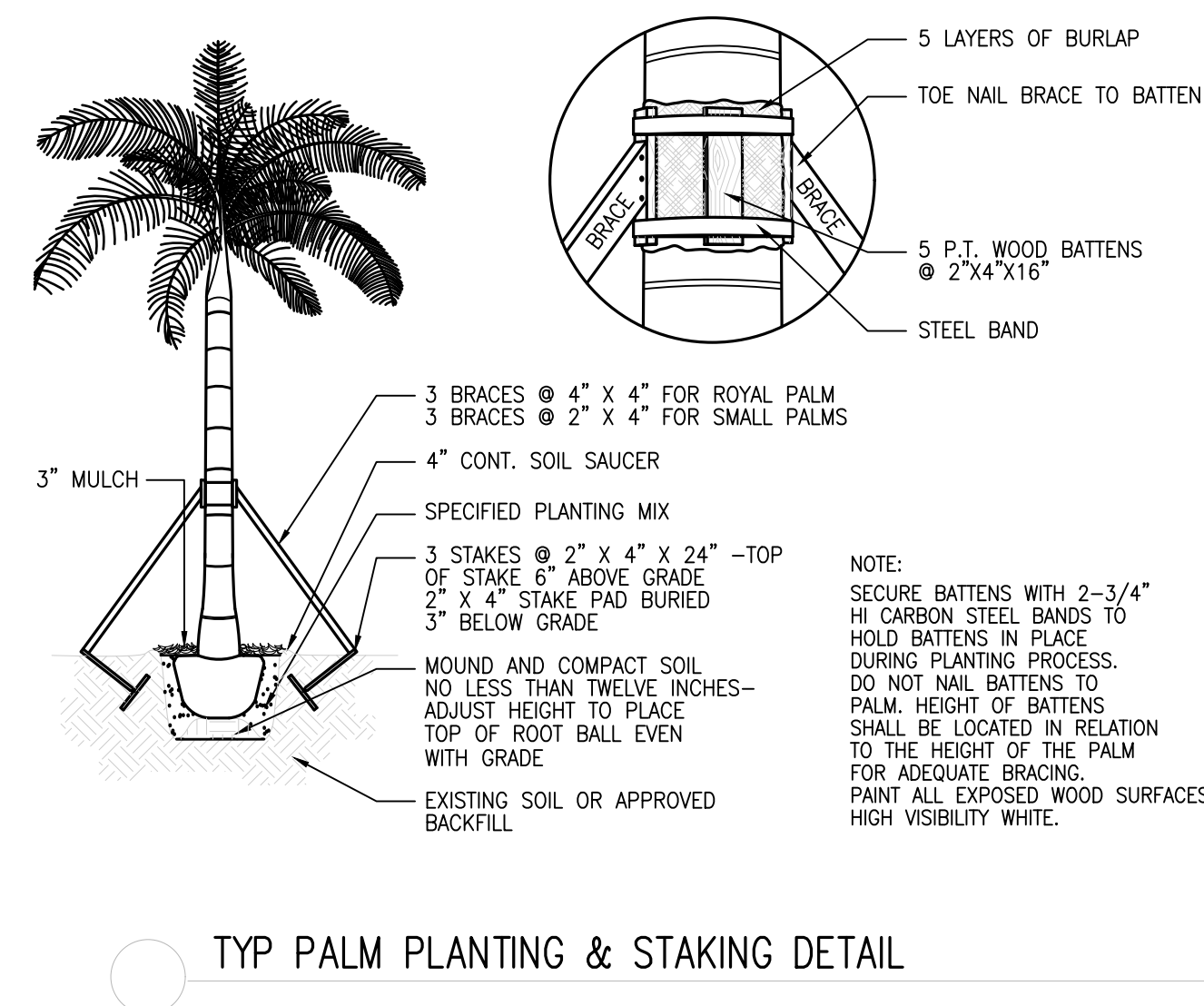
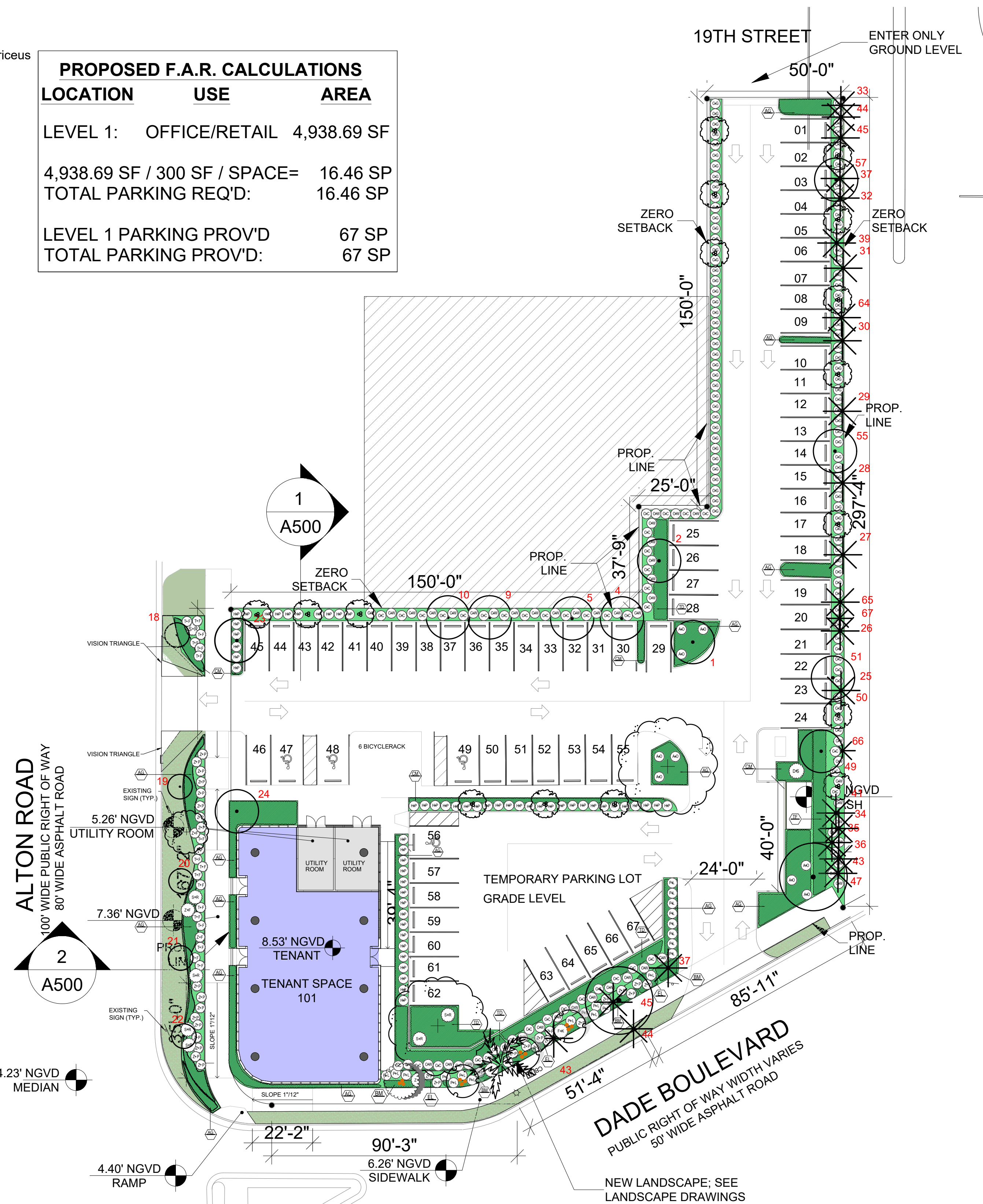

PLANT LIST

PROPOSED PLANT LIST						
SYM	BOTANICAL NAME	COMMON NAME	SPEC	NATIVE	DROUGHT	QTY
GROUNDCOVERS						
EL	<i>Erodia littoralis</i>	Golden Creeper	1 GAL @ 18" OC	*	*	1310
MULCH						
	Mulch	Pine Straw	2095 SQ FEET			

PLANT SYMBOL

- EL

GOLDEN CREEPER
- GENERAL PLANTING AREA
- PLANTING BED

GREEN ROOF COVERAGE

ROOF AREA	SQ. FEET
GREEN AREA	2339.5
ROOF	2339.5
TOTAL ROOF AREA	4679.46

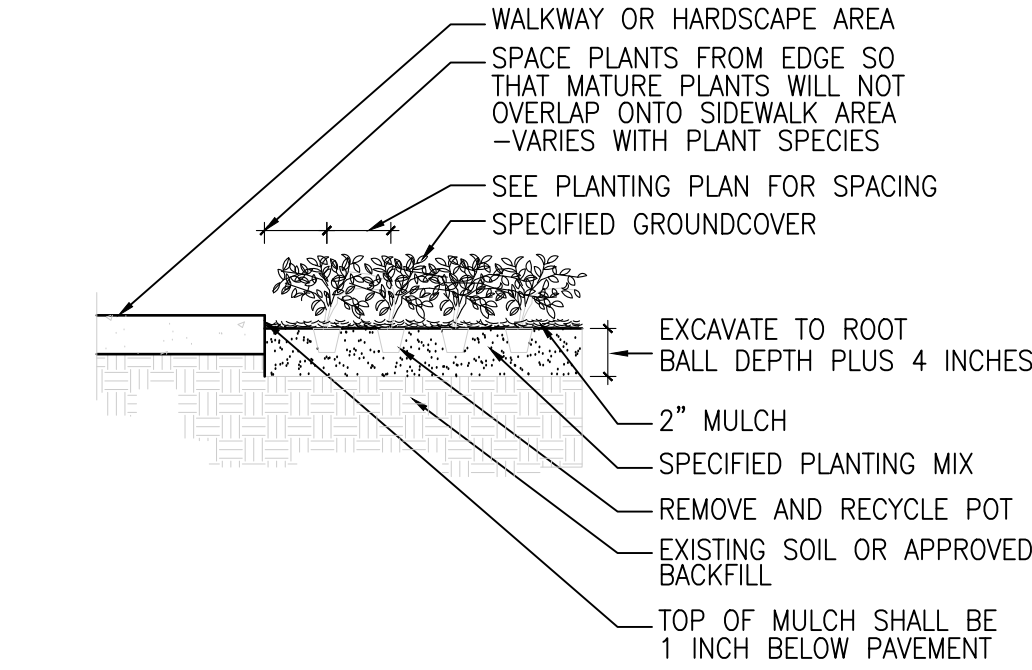

GROUNDCOVER EDGE PLANTING CONDITION
SCALE: N.T.S.

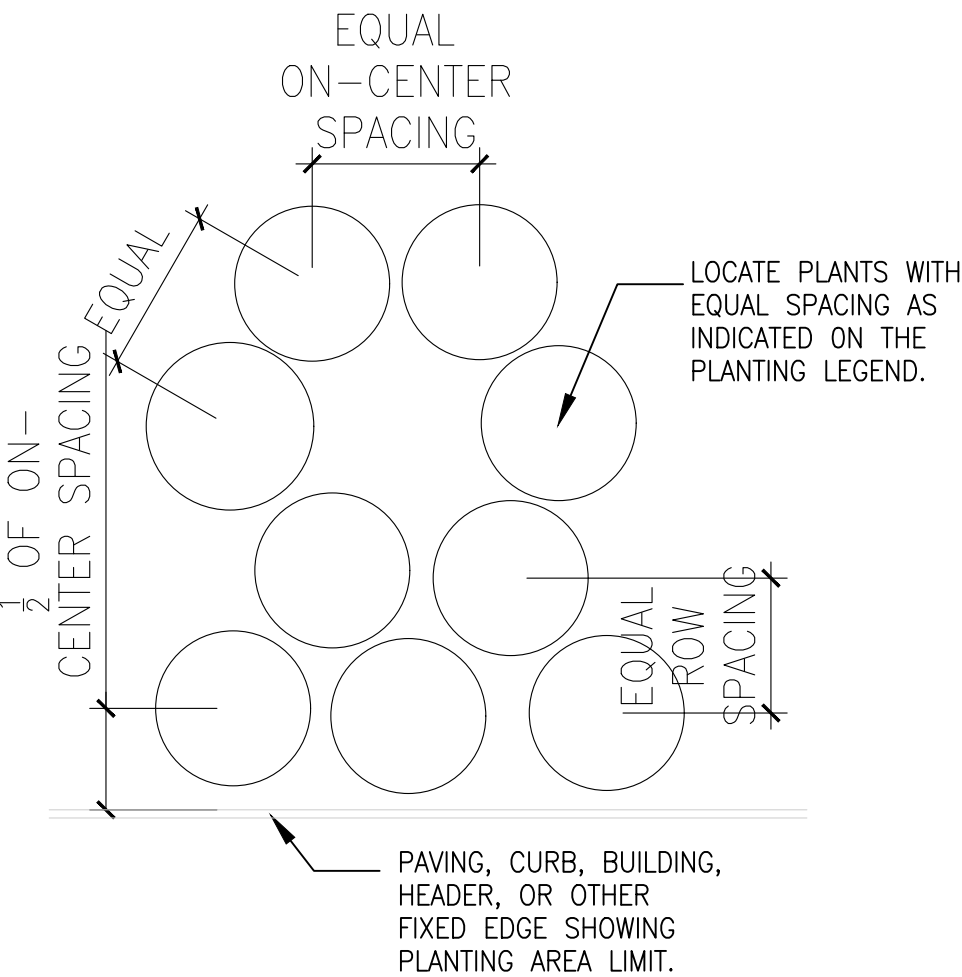

TYP SHRUB SPACING DETAIL

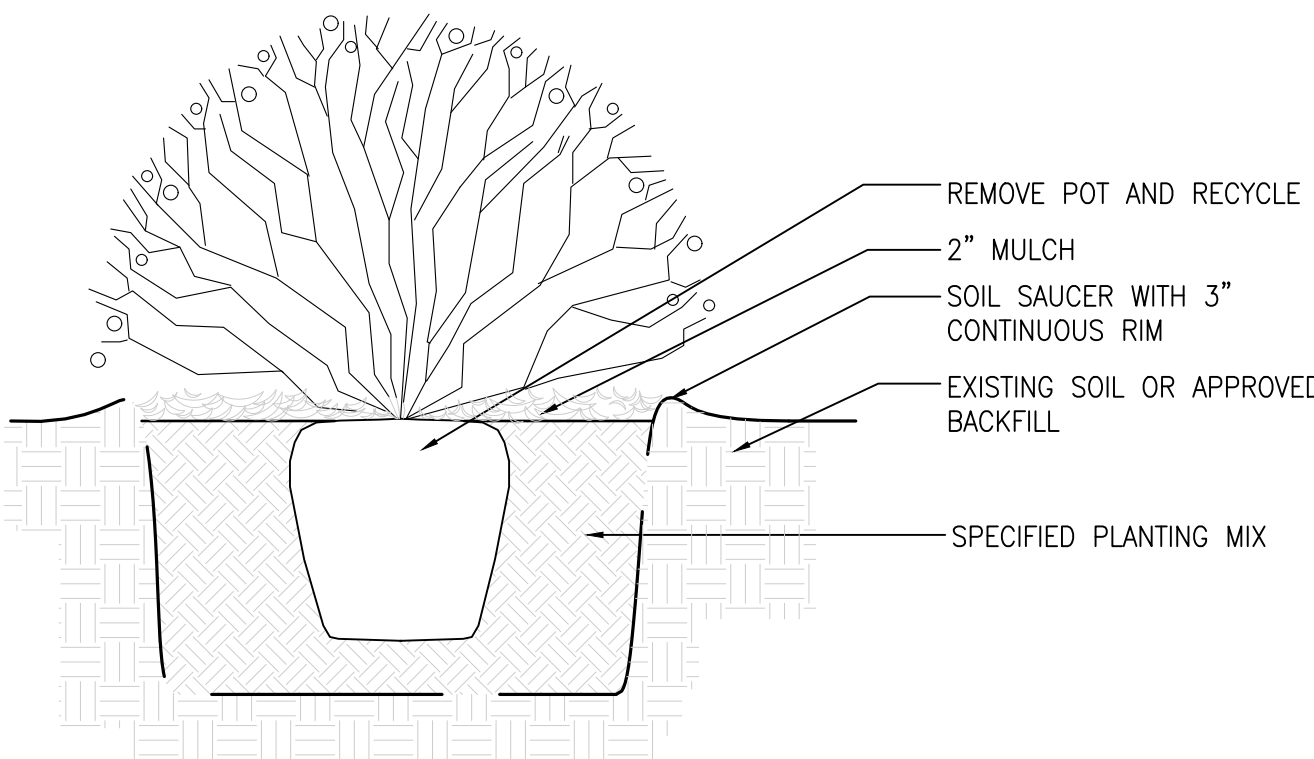

TYP SHRUB PLANTING DETAIL
SCALE: N.T.S.

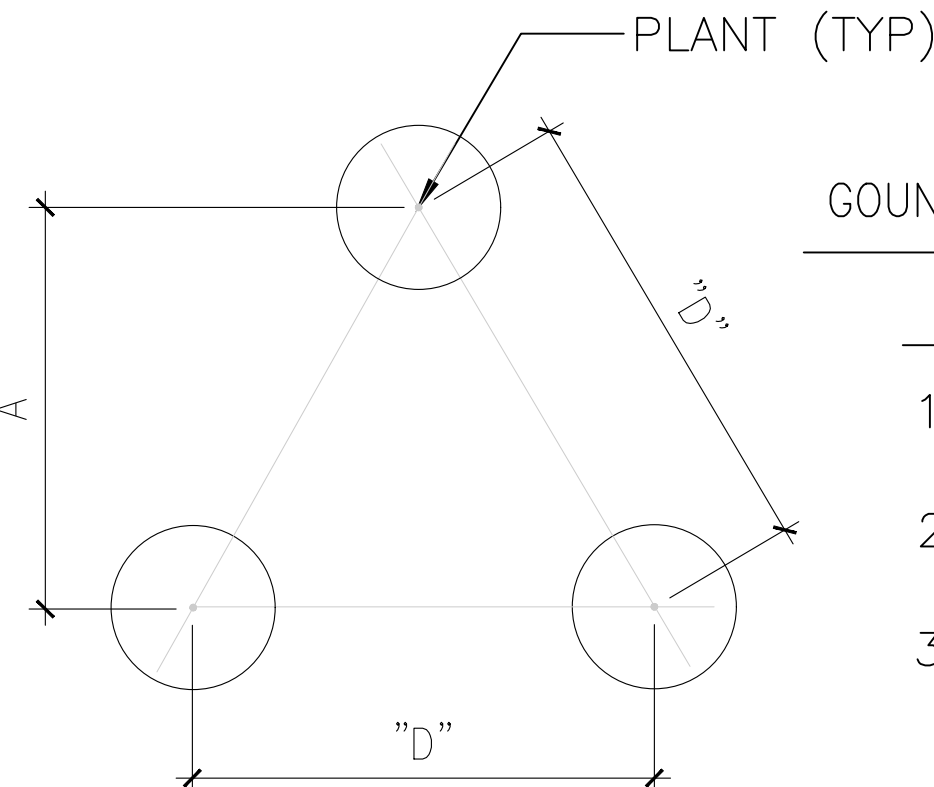

TYP TRIANGULAR PLANT SPACING CHART FOR GROUNDCOVERS
SCALE: N.T.S.

GROUNDCOVER & PERENNIAL SPACING	
"D"	"A"
18" O.C.	15" O.C.
24" O.C.	21" O.C.
36" O.C.	31" O.C.

ALTON ROAD
FLORIDA STATE ROAD 907

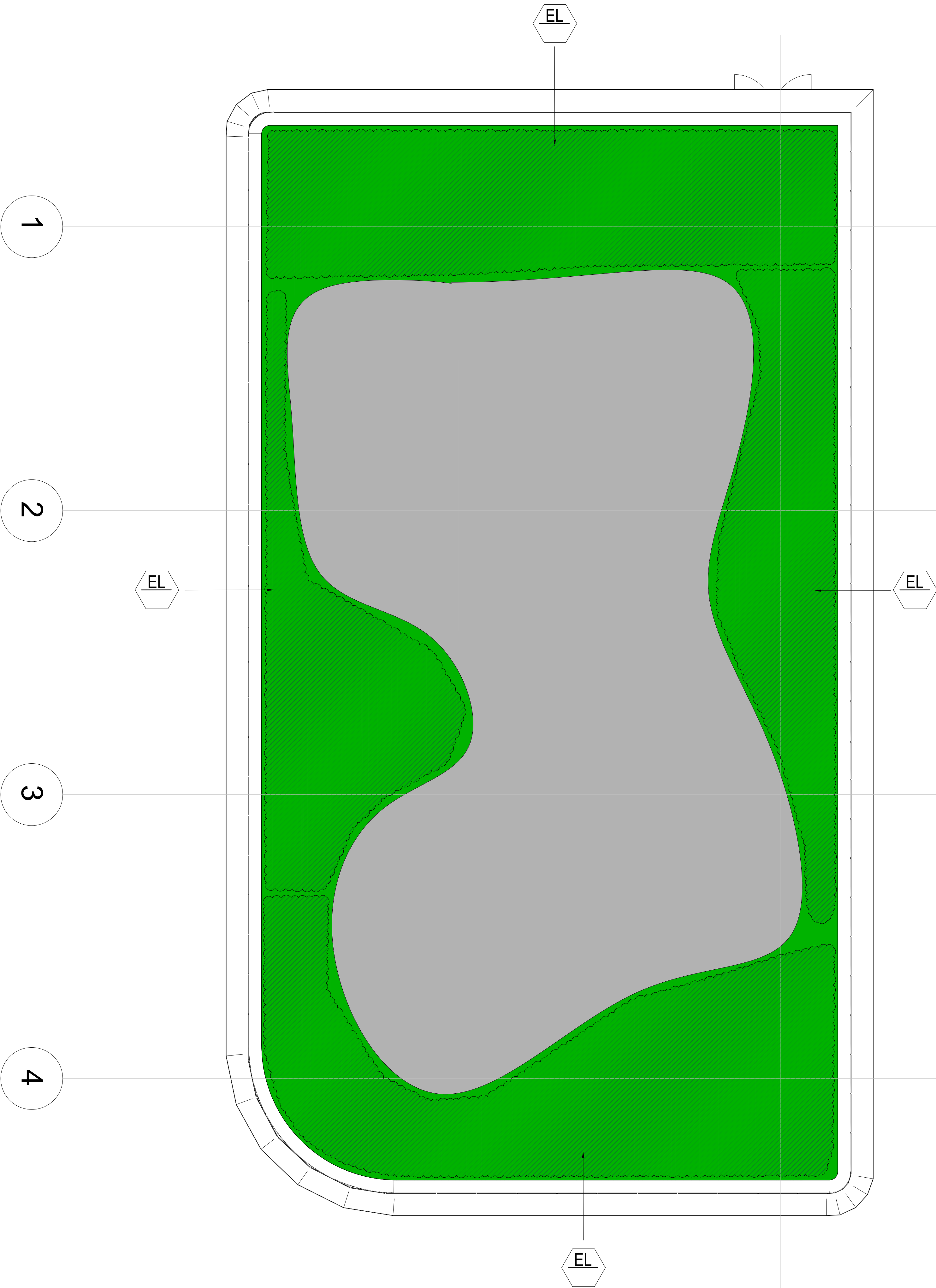

OVERALL ROOFTOP PLAN
Scale: 3/32" = 1'-0"

VFD
VINCENT FILIGENZI DESIGN
LANDSCAPE ARCHITECTURE, PLANNING, APPLICATIONS

LANDSCAPE ARCHITECT
FL RLA LIC. #6667191
9822 NE 2ND AVE SUITE #10
MIAMI SHORES, FL 33138
P. 786.346.8909
www.VincentFiligenzi.com

PROFESSIONAL SEAL:

SEAL:

Vincent Filigenzi

Digitally signed by Vincent Filigenzi
Date: 2024.04.05 13:03:44 -04'00'

VINCENT A. FILIGENZI
LA #6667191

NOTE:
These architectural drawings and plans are the property of Vincent Filigenzi, VFD INC. These drawings and plans shall not be reproduced for use by any individual or entity or any other project without the express written permission.

2ND LEVEL COMMERCIAL
TENANT IMPROVEMENT
1801 ALTON ROAD
MIAMI BEACH, FLORIDA 33139

SHEET ISSUE:
REV # DATE DESCRIPTION

DRAWN BY:
CHECKED BY: VF
DATE: 03.05.2024

DISCIPLINE / SHEET TITLE:
ROOFTOP PLAN

SHEET NUMBER:
LP-1.2