

SHEET INDEX

ISSUE DATES		08.04.2024			
HPB INTERIOR CD SET		CD SET			
Sheet Number	Sheet Title				
ID-0.00	COVER SHEET	●			
ID-0.01	INDEX	●			
ID-1.00	RPH HISTORY	●			
ID-1.01	RPH HISTORY	●			
ID-1.02	RPH HISTORY	●			
ID-2.00	SITE PHOTOS	●			
ID-2.01	SITE PHOTOS	●			
ID-2.02	SITE PHOTOS	●			
ID-2.03	SITE PHOTOS	●			
ID-2.04	SITE PHOTOS	●			
ID-2.05	SITE PHOTOS	●			
ID-2.06	SITE PHOTOS	●			
ID-2.07	SITE PHOTOS	●			
ID-2.08	SITE PHOTOS	●			
ID-2.09	SITE PHOTOS	●			
ID-2.10	SITE PHOTOS	●			
ID-2.11	SITE PHOTOS	●			
ID-2.12	SITE PHOTOS	●			
ID-2.13	SITE PHOTOS	●			
ID-2.14	SITE PHOTOS	●			
ID-2.15	SITE PHOTOS	●			
ID-2.16	SITE PHOTOS	●			
ID-2.17	SITE PHOTOS	●			
ID-2.18	SITE PHOTOS	●			
ID-2.19	SITE PHOTOS	●			
ID-2.20	SITE PHOTOS	●			
ID-2.21	SITE PHOTOS	●			
ID-2.22	SITE PHOTOS	●			
ID-2.23	SITE PHOTOS	●			
ID-2.24	SITE PHOTOS	●			
ID-2.25	SITE PHOTOS	●			
ID-2.26	SITE PHOTOS	●			
ID-2.27	SITE PHOTOS	●			
ID-3.00	HISTORY LAYOUT	●			
ID-4.00	ZONING	●			
ID-4.01	EXISTING FAR DIAGRAMS	●			
ID-4.02	EXISTING FAR DIAGRAMS	●			
ID-4.03	EXISTING FAR DIAGRAMS	●			
ID-4.04	EXISTING FAR DIAGRAMS	●			
ID-4.05	EXISTING FAR DIAGRAMS	●			
ID-4.06	PROPOSED FAR DIAGRAMS	●			
ID-4.07	PROPOSED FAR DIAGRAMS	●			
ID-4.08	PROPOSED FAR DIAGRAMS	●			
ID-4.09	PROPOSED FAR DIAGRAMS	●			
ID-4.10	PROPOSED FAR DIAGRAMS	●			
ID-4.11	PARKING & OCCUPANCY CALCULATIONS	●			
ID-4.12	PARKING & OCCUPANCY DIAGRAMS	●			
ID-6.00	SURVEY	●			
ID-6.01	SURVEY	●			
ID-6.02	SURVEY	●			
ID-6.03	SURVEY	●			
ID-6.04	SURVEY	●			
ID-6.05	SURVEY	●			
ID-7.00	EXISTING PLAN 01	●			
ID-7.01	DEMO PLAN 01	●			
ID-7.02	PROPOSED PLAN 01	●			
ID-7.03	DEMO PLAN 02	●			
ID-7.04	PROPOSED PLAN 02	●			
ID-7.05	ENLARGED DEMOLITION PLAN 01 - ENTRANCE	●			
ID-7.06	ENLARGED PROPOSED PLAN 01 - ENTRANCE	●			
ID-7.07	ENLARGED DEMOLITION PLAN 01 - LOBBY	●			
ID-7.08	ENLARGED PROPOSED PLAN 01 - LOBBY	●			
ID-7.09	ENLARGED DEMOLITION PLAN 01 - BREEZEWAY	●			

REVISIONS NARRATIVE		
REV. #	DATE	NARRATIVE
-	08.04.2024	PERMIT/CD SET

ISSUE KEY				
DRAWING NAME	PREVIOUS ISSUE DATE	CURRENT ISSUE DATE	ISSUED DATES	
FIRST FLOOR PLAN A	●			CURRENTLY ISSUED
FIRST FLOOR PLAN B				NOT ISSUED
FIRST FLOOR PLAN C	○			PREVIOUSLY ISSUED
FIRST FLOOR PLAN D	✕			REMOVED

SHEET INDEX

ISSUE DATES		08.04.2024			
HPB INTERIOR CD SET		CD SET			
Sheet Number	Sheet Title				
ID-7.10	ENLARGED PROPOSED PLAN 01 - BREEZEWAY	●			
ID-7.11	ENLARGED DEMOLITION PLAN 01 - POOL DECK	●			
ID-7.12	ENLARGED PROPOSED PLAN 01 - POOL DECK	●			
ID-7.13	ENLARGED DEMOLITION PLAN 02 - MEETING ROOMS	●			
ID-7.14	ENLARGED PROPOSED PLAN 02 - MEETING ROOMS	●			
ID-7.15	ENLARGED DEMOLITION PLAN 02 - RESTAURANT	●			
ID-7.16	ENLARGED PROPOSED PLAN 02 - RESTAURANT	●			
ID-7.17	ENLARGED DEMOLITION PLAN 02 - FLEX TERRACE	●			
ID-7.18	ENLARGED PROPOSED PLAN 02 - FLEX TERRACE	●			
ID-8.00	ELEVATIONS	●			
ID-8.01	ELEVATIONS	●			
ID-8.02	EXTERIOR ELEVATIONS	●			
ID-8.03	EXTERIOR ELEVATIONS	●			
ID-8.04	EXTERIOR ELEVATIONS	●			
ID-8.05	EXTERIOR ELEVATIONS	●			
ID-8.06	EXTERIOR ELEVATIONS	●			
ID-8.07	EXTERIOR ELEVATIONS	●			
ID-8.08	CANOPY DETAILS	●			
ID-8.09	CABANA DETAILS	●			
ID-8.10	CABANA DETAILS	●			
ID-9.00	RENDERINGS	●			
ID-9.01	RENDERINGS	●			
ID-9.02	RENDERINGS	●			
ID-9.03	RENDERINGS	●			
ID-9.04	RENDERINGS	●			
ID-9.05	RENDERINGS	●			
ID-9.06	RENDERINGS	●			
ID-9.07	RENDERINGS	●			
ID-9.08	RENDERINGS	●			
LANDSCAPE					
L-000	COVER SHEET	●			
L-001	SHEET INDEX	●			
L-200	OVERALL TREE DISPOSITION PLAN	●			
L-201	PARTIAL TREE DISPOSITION PLAN	●			
L-202	PARTIAL TREE DISPOSITION PLAN	●			
L-203	PARTIAL TREE DISPOSITION PLAN	●			
L-250	TREE DISPOSITION LIST AND CHARTS	●			
L-251	TREE DISPOSITION NOTES AND DETAILS	●			
L-300	OVERALL HARDSCAPE PLAN	●			
L-301	ENLARGED HARDSCAPE PLAN	●			
L-302	ENLARGED HARDSCAPE PLAN	●			
L-303	ENLARGED HARDSCAPE PLAN	●			
L-330	DUNE OVERLAY DIAGRAM	●			
L-331	OCEANFRONT OVERLAY DIAGRAM	●			
L-350	DUNE OVERLAY DIAGRAM	●			
L-400	OVERALL LANDSCAPE PLAN	●			
L-401	ENLARGED LANDSCAPE PLAN	●			
L-402	ENLARGED LANDSCAPE PLAN	●			
L-403	ENLARGED LANDSCAPE PLAN	●			
L-410	LANDSCAPE SCHEDULE AND LANDSCAPE LEDGEND	●			
L-450	LANDSCAPE MATERIALS	●			

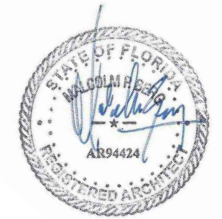

ESTABLISHED 1939

On *historic* Collins
Avenue, a *steadfast*
landmark in the
heart of South
Beach.



EoA
ARCHITECTURE | INTERIORS | BRANDING | MASTER PLANNING | LANDSCAPE

Gensler
Kimley»Horn

ROYAL PALM HOTEL, MIAMI BEACH
1545 COLLINS AVE., MIAMI BEACH, FL 33139
HPB SET

AUGUST / 04 / 2024: FINAL SUBMITTAL

E o A , I n c | 1929 Ponce de Leon Blvd., Coral Gables, Florida 33146 | 3 0 5 . 4 4 4 . 0 9 9 0 | State of Florida Architect of Record Malcolm Berg, AIA License No. AR94424



sheet no.

ID-1.00

SCALE: AS NOTED

TIMELINE

Royal Palm *History*

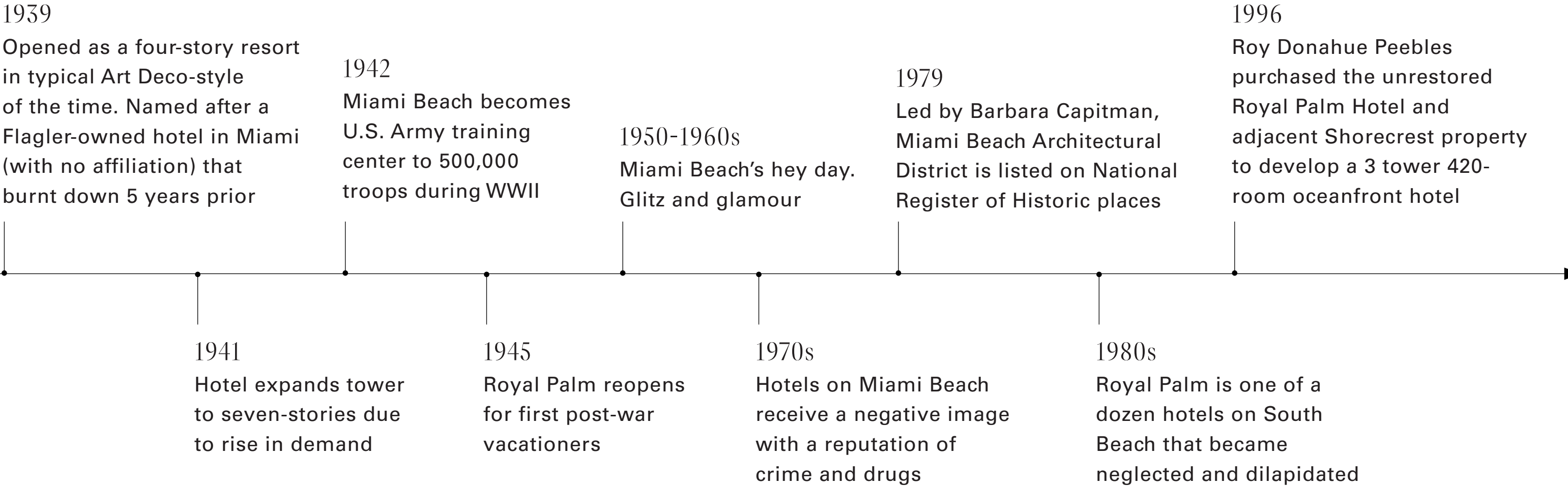

TIMELINE

Royal Palm *History*

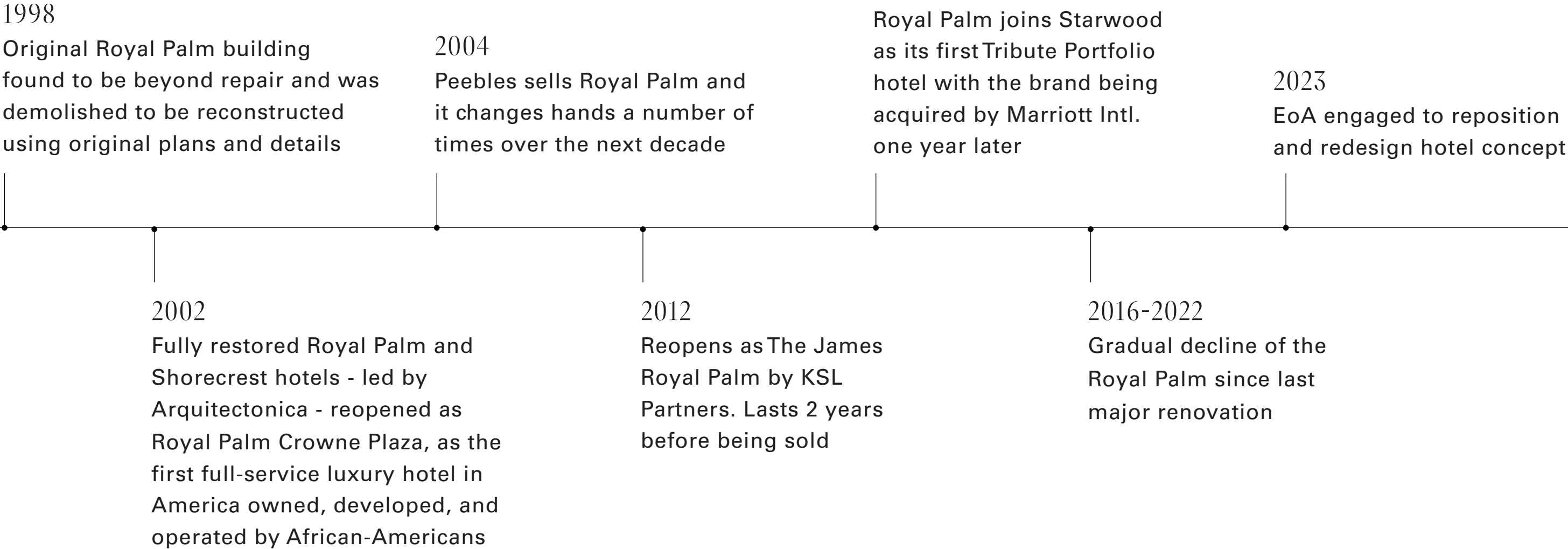

ROYAL PALM HOTEL, MIAMI BEACH
1545 COLLINS AVE., MIAMI BEACH, FL 33139
HPB SET

AUGUST / 04 / 2024: FINAL SUBMITTAL

E o A , I n c | 1929 Ponce de Leon Blvd., Coral Gables, Florida 33146 | 3 0 5 . 4 4 4 . 0 9 9 0 | State of Florida Architect of Record Malcolm Berg, AIA License No. AR94424

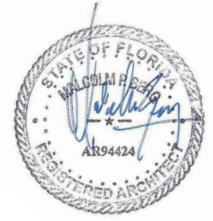

sheet no.
ID-1.02
SCALE: AS NOTED



**NICHOLS
BROSCH
WURST
WOLFE**
& ASSOCIATES, INC.
Architecture & Planning

151 Almeria Avenue
Coral Gables,
Florida 33134
Tel: (305) 443-5206
E-MAIL:
jwurst@nbww.com
AAC 00680

JAMES P. WURST
ARCHITECT
FLA. REG. #AR011080

ROTTET STUDIO

Project Designer
180 VARICK STREET,
SUITE 404
NEW YORK, NY 10014
PH: 212.537.9245
E-MAIL:
lauren@rottetstudio.com

Landscape Architect
ECOPLAN

1515 S.E. 4TH AVENUE
FT. LAUDERDALE, FLORIDA
33316
PH: 954.524.3722
E-MAIL:
john@ecoplan-inc.com

TO THE BEST OF THE
ARCHITECT'S KNOWLEDGE,
THE PLANS AND
SPECIFICATIONS COMPLY
WITH THE APPLICABLE
MINIMUM BUILDING CODES
AND THE APPLICABLE
FSC SAFETY STANDARDS
AS DETERMINED BY THE
LOCAL AUTHORITIES IN
ACCORDANCE WITH SECTION
105.2, 105.3 & 4
OF THE 2007 FSC AND
633 FLORIDA STATUTES.

Project Reference
Elevation

THE JAMES ROYAL PALM
ADDITIONS AND ALTERATIONS
1545 COLLINS AVENUE
MIAMI BEACH, FLORIDA

10012

01

EoA

ARCHITECTURE | INTERIORS | BRANDING | MASTER PLANNING | LANDSCAPE

Gensler
Kimley»Horn

ROYAL PALM HOTEL, MIAMI BEACH
1545 COLLINS AVE., MIAMI BEACH, FL 33139
HPB SET

AUGUST / 04 / 2024: FINAL SUBMITTAL

E o A , I n c | 1929 Ponce de Leon Blvd., Coral Gables, Florida 33146 | 3 0 5 . 4 4 4 . 0 9 9 0 | State of Florida Architect of Record Malcolm Berg, AIA License No. AR94424



sheet no.

ID-2.00

SCALE: AS NOTED

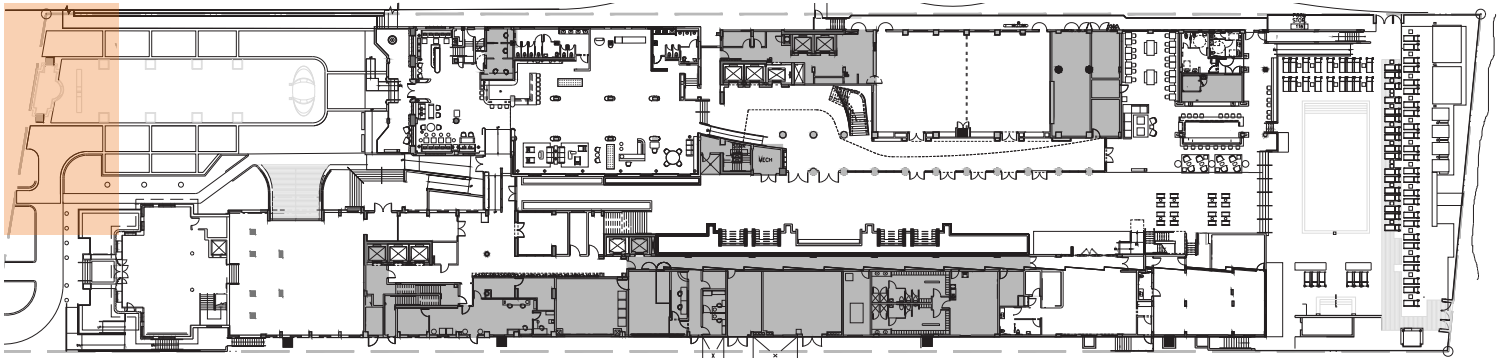

MAIN ENTRY
1/30/2024 SITE IMAGES

EoA
ARCHITECTURE | INTERIORS | BRANDING | MASTER PLANNING | LANDSCAPE

Gensler
Kimley»Horn

ROYAL PALM HOTEL, MIAMI BEACH
1545 COLLINS AVE., MIAMI BEACH, FL 33139
HPB SET

AUGUST / 04 / 2024: FINAL SUBMITTAL

E o A , I n c | 1929 Ponce de Leon Blvd., Coral Gables, Florida 33146 | 3 0 5 . 4 4 4 . 0 9 9 0 | State of Florida Architect of Record Malcolm Berg, AIA License No. AR94424

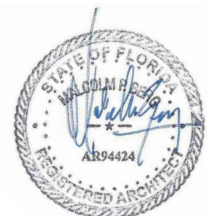

sheet no.

ID-2.01

SCALE: AS NOTED



MAIN ENTRY - WATER FOUNTAIN AND ARBOR
1/30/2024 SITE IMAGES

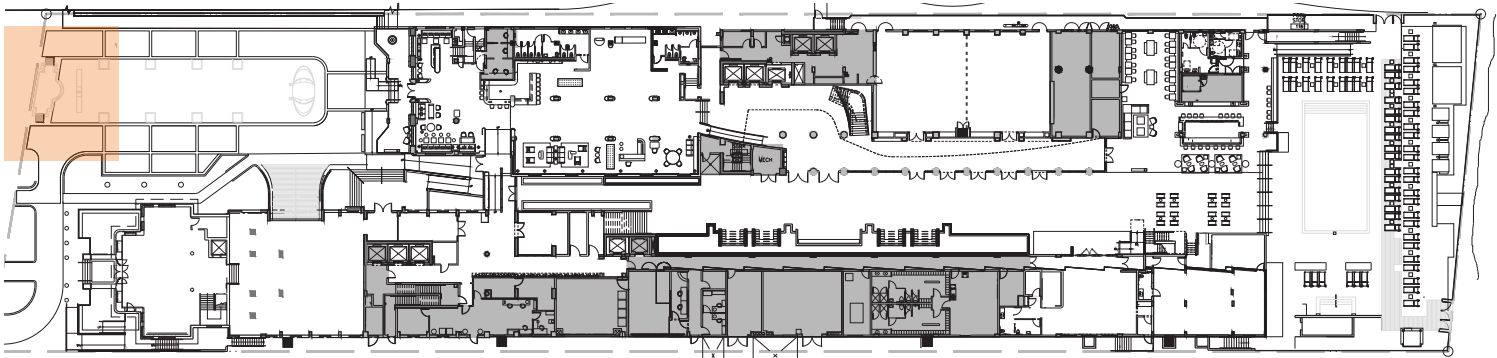

ROYAL PALM HOTEL, MIAMI BEACH
1545 COLLINS AVE., MIAMI BEACH, FL 33139
HPB SET

AUGUST / 04 / 2024: FINAL SUBMITTAL

E o A , I n c | 1929 Ponce de Leon Blvd., Coral Gables, Florida 33146 | 3 0 5 . 4 4 4 . 0 9 9 0 | State of Florida Architect of Record Malcolm Berg, AIA License No. AR94424

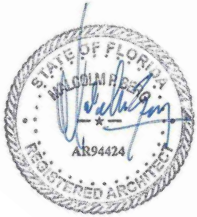

sheet no.

ID-2.02

SCALE: AS NOTED

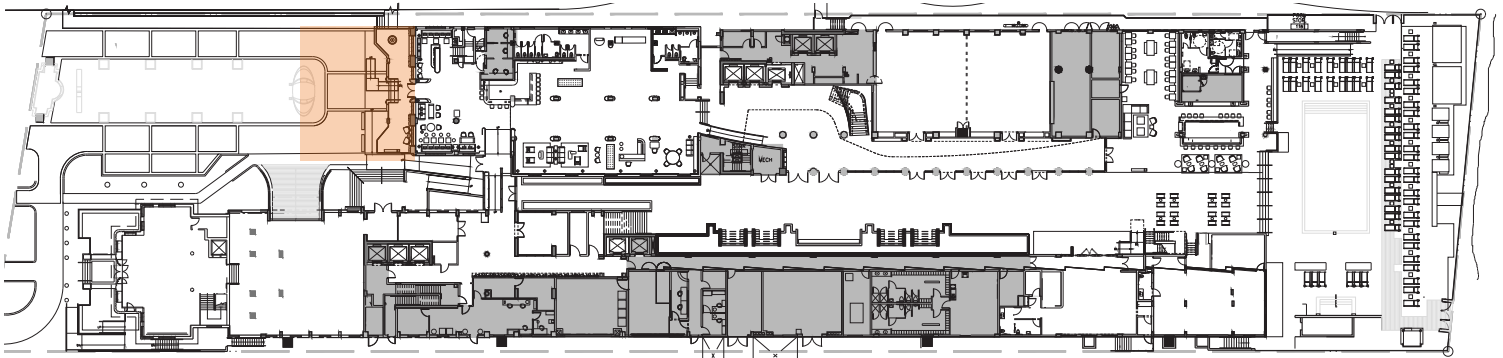

MAIN ENTRY - PORTE COCHERE AND VALET
1/30/2024 SITE IMAGES