

CITY OF MIAMI BEACH

MAYOR: STEVEN MEINER

COMMISSIONERS: KRISTEN ROSEN GONZALEZ  
LAURA DOMINGUEZ  
ALEX J. FERNANDEZ  
TANYA K. BHATT  
DAVID SUAREZ  
JOSEPH MAGAZINE

CITY MANAGER: ALINA T. HUDAK

CITY ATTORNEY: RAFAEL A. PAZ

PUBLIC WORKS DIRECTOR: JOE GOMEZ, P.E., F.FES

CITY ENGINEER: CRISTINA ORTEGA

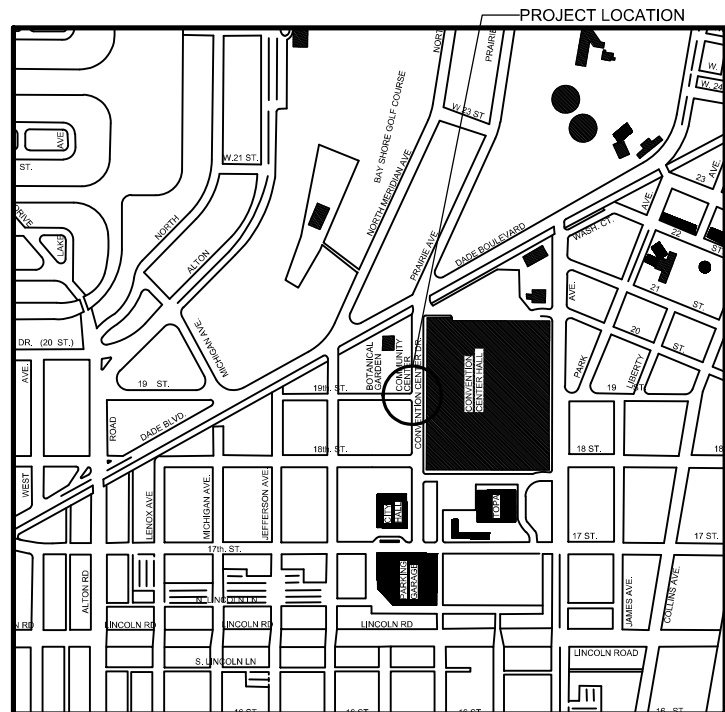

## INDEX OF PLANS

NUMBER	DISCIPLINE	SHEET NO.	DESCRIPTION	NOTES
1	GENERAL	G-01	COVER SHEET	
2	GENERAL	G-03	INDEX OF SHEETS	
3	GENERAL	G-04	ADA NOTES, SCOPE OF WORK & KIOSK SPECIFICATIONS	
4	CIVIL	C1-01	CIVIL SITE PLAN	
5	CIVIL	C1-02	KIOSK MIB-003 ENGINEERING PLAN	
6	ELECTRICAL	E1-01	KIOSK MIB-003 ELECTRICAL PLAN	
7	SURVEY		KIOSK MIB-003 SITE SURVEY	

**SCOPE OF WORK:** THE PROJECT CONSISTS OF THE INSTALLATION OF ONE (1) DIGITAL INTERACTIVE KIOSK AND APPLICABLE INFRASTRUCTURE; STRUCTURAL FOUNDATION AND ELECTRICAL SERVICE AT THE LOCATION INDICATED ON THESE DESIGN PLANS.

ENGINEER OF RECORD: VANESSA A. MELA, P.E. NO. 77676

Work Order \_\_\_\_\_ Sheet 1 of 7 Drawing **G0-01**

# INDEX OF PLANS

NUMBER	DISCIPLINE	SHEET NO.	DESCRIPTION	NOTES
1	GENERAL	G0-01	COVER SHEET	
2	GENERAL	G0-03	INDEX OF SHEETS	
3	GENERAL	G0-04	ADA NOTES, SCOPE OF WORK & KIOSK SPECIFICATIONS	
4	CIVIL	C1-01	CIVIL SITE PLAN	
5	CIVIL	C1-02	KIOSK MIB-003 ENGINEERING PLAN	
6	ELECTRICAL	E1-01	KIOSK MIB-003 ELECTRICAL PLAN	
7	SURVEY		KIOSK MIB-003 SITE SURVEY	

## PROJECT LOCATION

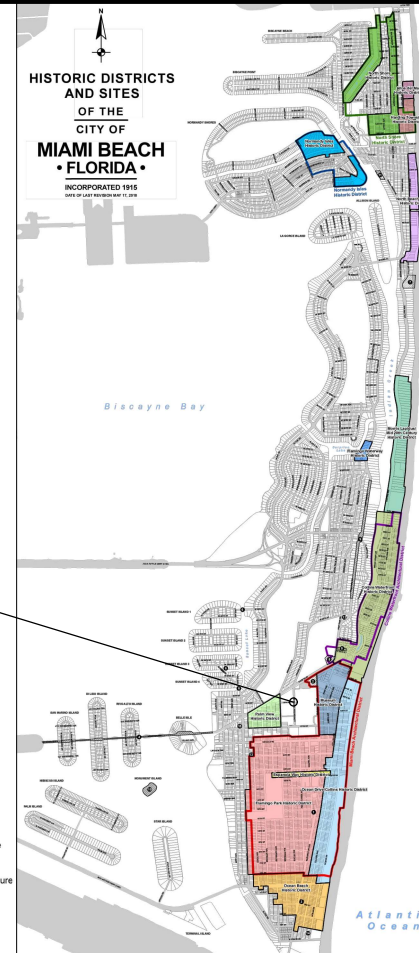

## LEGEND AND ABBREVIATIONS

	= PALM TREE
	= TREE
	= ORNAMENTAL TREE
O.R.B.	= OFFICIAL RECORDS BOOK
PG.	= PAGE
ELEV.	= ELEVATION
TYP.	= TYPICAL
CATV	= CABLE TELEVISION
OHE	= OVERHEAD ELECTRIC LINE
X 0.00	= SPOT ELEVATION
CONC.	= CONCRETE
C.B.S.	= CONCRETE BLOCK STUCCO
C.L.F.	= CHAIN LINK FENCE
W.F.	= WOOD FENCE
M.F.	= METAL FENCE
RCP	= REINFORCED CONCRETE PIPE
FF	= FINISH FLOOR
(R)	= RECORD
(C)	= CALCULATED
(M)	= MEASURE
LB	= LICENSE BUSINESS
L	= LENGTH
Δ	= CENTRAL ANGLE
R	= RADIUS
T	= TANGENT
PT	= POINT OF TANGENCY
PC	= POINT OF CURVATURE
STA.	= STATION
P	= POINT OF INTERSECTION
ID	= IDENTIFICATION
MLP	= METAL LIGHT POLE
CLP	= CONCRETE LIGHT POLE
R/W	= RIGHT-OF-WAY
P.B.	= PLAT BOOK
Δ	= SECTION LINE
C	= CENTERLINE
B	= BASELINE
M	= MONUMENT LINE
TSB	= TRAFFIC SIGNAL BOX
TSC	= TRAFFIC SIGNAL CABINET
BOLLARD	= BOLLARD
PEDESTRIAN SIGNAL	= PEDESTRIAN SIGNAL
TSMA	= TRAFFIC SIGNAL MAST ARM
SIGN	= SIGN
CABLE TELEVISION BOX	= CABLE TELEVISION BOX
LIGHT POLE	= LIGHT POLE
ELECTRIC BOX	= ELECTRIC BOX
UTILITY POLE	= UTILITY POLE
ELECTRIC TRANSFORMER	= ELECTRIC TRANSFORMER
GUY ANCHOR	= GUY ANCHOR
ELECTRIC MANHOLE	= ELECTRIC MANHOLE
ELECTRIC METER	= ELECTRIC METER
GAS VALVE	= GAS VALVE
GAS UTILITY BOX	= GAS UTILITY BOX
GAS MANHOLE	= GAS MANHOLE
GAS TANK	= GAS TANK
GAS METER	= GAS METER
COMMUNICATION BOX	= COMMUNICATION BOX
COMMUNICATION MANHOLE	= COMMUNICATION MANHOLE
GARBAGE RECEPTACLE	= GARBAGE RECEPTACLE
HANDICAP PARKING SPACE	= HANDICAP PARKING SPACE
WATER METER	= WATER METER
IRRIGATION VALVE	= IRRIGATION VALVE
WATER VALVE	= WATER VALVE
FIRE HYDRANT	= FIRE HYDRANT
WATER BOX	= WATER BOX
WATER CONNECTION	= WATER CONNECTION
WATER MANHOLE	= WATER MANHOLE
WATER TANK	= WATER TANK
WATER WELL	= WATER WELL
WATER MARKING FLAG	= WATER MARKING FLAG
WATER MARKING SIGN	= WATER MARKING SIGN
STORM MANHOLE	= STORM MANHOLE
STORM METER	= STORM METER
CATCH BASIN	= CATCH BASIN
TELEPHONE MANHOLE	= TELEPHONE MANHOLE
TELEPHONE BOX	= TELEPHONE BOX
NEWSPAPER DISPENSER	= NEWSPAPER DISPENSER
MAILBOX	= MAILBOX
SANITARY MANHOLE	= SANITARY MANHOLE
SANITARY BOX	= SANITARY BOX
SANITARY TANK	= SANITARY TANK
SANITARY LIFT STATION	= SANITARY LIFT STATION
GREASE TRAP MANHOLE	= GREASE TRAP MANHOLE
CLEANOUT	= CLEANOUT
PARKING METER	= PARKING METER
FIBER OPTIC BOX	= FIBER OPTIC BOX
FIBER OPTIC MARKER SIGN	= FIBER OPTIC MARKER SIGN
MONITORING WELL	= MONITORING WELL
FUEL TANK	= FUEL TANK
UNKNOWN UTILITY BOX	= UNKNOWN UTILITY BOX
UNKNOWN UTILITY METER	= UNKNOWN UTILITY METER
UNKNOWN UTILITY MANHOLE	= UNKNOWN UTILITY MANHOLE
UNKNOWN UTILITY VALVE	= UNKNOWN UTILITY VALVE
UNKNOWN UTILITY MARKER	= UNKNOWN UTILITY MARKER
FLAG	= FLAG
SANITARY VALVE	= SANITARY VALVE
RAILROAD SIGN	= RAILROAD SIGN
FLAGPOLE	= FLAGPOLE
PROPERTY LINE	= PROPERTY LINE
ELECTRICAL OUTLET	= ELECTRICAL OUTLET

## NOTES:

## KEY PLAN (NOT TO SCALE):

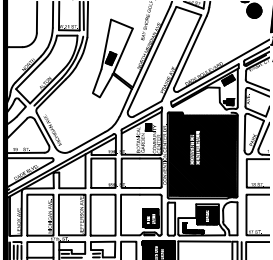

## P.E. SEAL:

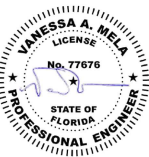

## PROJECT DIRECTORY:

**PROJECT NAME:**  
INTERACTIVE DIGITAL INFORMATION  
KIOSKS DEPLOYMENT PROJECT

**JURISDICTION:**  
CITY OF MIAMI  
DEPARTMENT OF RESILIENCE AND  
PUBLIC WORKS  
MIAMI RIVERSIDE CENTER  
444 S.W. 2nd AVENUE, 8th FLOOR  
MIAMI, FLORIDA 33130  
TEL: 305-416-1200

**OWNER:**  
IKE SMART CITY  
250 N HARTFORD AVE  
COLUMBUS, OH 43222  
(614) 589-0087

**ENGINEER OF RECORD:**  
MAINSTREET ENGINEERING  
7035 SW 47 STREET, SUITE A  
MIAMI, FL 33155  
(305) 456-3505  
PROJ. MGR: VANESSA MELA, P.E.  
VMELA@MAINSTREETENG.COM

**KIOSK MANUFACTURER:**  
DISPLAY DEVICE INC.  
21075 WESTGATE RD.  
GOLDEN, CO 80403  
CONTACT: ERIC PERKINS  
PHONE: (303) 929-4071

## UTILITIES:

ELECTRICAL POWER: FLORIDA  
POWER & LIGHT COMPANY (FPL)  
WATER & SEWER: MIAMI-DADE  
WATER & SEWAGE DEPARTMENT

TELEPHONE: AT&T

CABLE: COMCAST, XFINITY,  
ATT-VERSE

GAS: FLORIDA GAS

## SIDEWALK & STREET SYMBOLS

	ASPHALT		BRICK
	PAVER		CONCRETE
	UNIMPROVED		TILE
	GRAVEL		STAMPED CONCRETE

**MIAMI BEACH**

PUBLIC WORKS DEPARTMENT  
1700 CONVENTION CENTER DRIVE, MIAMI BEACH, FL 33139

CITY MANAGER: ALINA T. HUDAK  
DIRECTOR: JOE GOMEZ, P.E.  
CITY ENGINEER: CRISTINA ORTEGA  
CASTINEIRAS, P.E.

5			
4			
3			
2			
1			
NO.	DATE	REVISION	APPROD. BY



ENGINEER OF RECORD:  
DESIGN ENGINEER: VM  
DRAWN BY: KM  
CHECKER: WP  
SCALE:

VANESSA A. MELA  
P.E. NO. 77676

NEIGHBORHOOD:

MIB-003: CONVENTION CENTER DR & 19TH ST

TITLE:

INDEX OF SHEETS

File Name: MIB-003-GENERAL AND FOUNDATION.dwg

Survey Reference:

Field Book: N/A Page: N/A Work Order: N/A

Date: 02/09/2024 Sheet: 2 of 7 Drawing: G0-03

## ADA NOTES

- ALL CONSTRUCTION ACTIVITIES SHALL BE COMPLETED IN FULL COMPLIANCE WITH THE AMERICANS WITH DISABILITIES ACT (ADA). CLEAR SPACES IN FRONT OF KIOSK SHALL HAVE THE FOLLOWING CHARACTERISTICS:
- SURFACES SHALL BE FIRM, STABLE, AND SLIP RESISTANT AND OTHERWISE COMPLY WITH PROWAG SECTION R302.7 AND SHALL HAVE A RUNNING SLOPE CONSISTENT WITH GRADE OF THE ADJACENT PEDESTRIAN ACCESS ROUTE AND CROSS SLOPE OF 1.50% +/-0.50%)
- SIZE: CLEAR SPACES SHALL BE 48" MINIMUM BY 48" MINIMUM.
- POSITION: UNLESS OTHERWISE SPECIFIED, CLEAR SPACES SHALL BE POSITIONED FOR EITHER FORWARD OR PARALLEL APPROACH TO THE KIOSK.
- APPROACH: ONE FULL UNOBSTRUCTED SIDE OF A CLEAR SPACE SHALL ADJOIN A PEDESTRIAN ACCESS ROUTE OR ADJOIN ANOTHER CLEAR SPACE.
- MANEUVERING SPACE: WHERE A CLEAR SPACE IS CONFINED ON ALL OR PART OF THREE SIDES, ADDITIONAL MANEUVERING SPACE SHALL BE PROVIDED AS FOLLOWS:
  - FORWARD APPROACH: THE CLEAR SPACE AND ADDITIONAL MANEUVERING SPACE SHALL BE 36" WIDE MINIMUM WHERE THE DEPTH OF THE CONFINING ELEMENT EXCEEDS 24".
  - PARALLEL APPROACH: THE CLEAR SPACE AND ADDITIONAL MANEUVERING SPACE SHALL BE 60" WIDE MINIMUM WHERE THE DEPTH OF THE CONFINING ELEMENT EXCEEDS 15".
- THE MINIMUM WHEELCHAIR PASSAGE WIDTH OR CLEAR SPACE WIDTH FOR A SINGLE WHEELCHAIR PASSAGE SHALL BE 48" PER PROWAG SECTION R302.3.
- INITIAL OPERATION FOR THE KIOSK WILL HAVE 4G LTE CONNECTION SECTION R404. TO THE INTERNET.
- THE KIOSKS HAVE BEEN DESIGN TO COMPLY WITH ALL ADA GUIDELINES INCLUDING VIEWING, OPERATION, AND ACCESSIBILITY.
- THE MOBILE IKE EXPERIENCE WILL FOLLOW WEB CONTENT ACCESSIBILITY GUIDELINES (WCAG) TO WORK IN TANDEM WITH THE NATIVE ACCESSIBILITY FEATURES ON THE USER'S MOBILE DEVICE, INCLUDING TALKBACK AND VOICEOVER TOOLS.

## SCOPE OF WORK

THE PROJECT CONSIST OF THE INSTALLATION OF ONE (1) DIGITAL INTERACTIVE KIOSKS AT THE LOCATION(S) INDICATED ON THIS PLANS SET. INSTALLER SHALL PROVIDE AND INCLUDE ALL WORKMANSHIP AND MATERIALS NECESSARY TO COMPLETE THE INSTALLATION INCLUDING BUT NOT LIMITED TO:

- INSTALLATION OF THE KIOSKS TO THE FOUNDATION AS INDICATED ON PLANS TO NEW RECTANGULAR CONCRETE FOUNDATION.
- ELECTRICAL SERVICE POINTS ARE EXISTING. CONNECT THE EXISTING ELECTRIC SERVICE TO THE NEW KIOSK AS INDICATED ON PLANS.
- TESTING OF THE ELECTRICAL SERVICE INFRASTRUCTURE SHALL BE PERFORMED IN CONJUNCTION WITH A REPRESENTATIVE OF THE ENGINEER OF RECORD.
- THE CONTRACTOR SHALL INSTALL THE KIOSK IN SUCH A WAY THAT THE KIOSK IS WITHIN THE PUBLIC R.O.W. AND IN COMPLIANCE WITH ALL APPLICABLE A.D.A. REQUIREMENTS
- THE LOCATION OF KIOSKS HAS BEEN COORDINATE TO ENSURE THERE IS NO OBSTRUCTION OF THE SIGHT OF VEHICULAR SIGNS.
- STAND-ALONE PEDESTRIAN KIOSKS SHOULD NOT BE INSTALLED WITHIN PEDESTRIAN CIRCULATION PATHS IN A MANNER THAT PERSONS AT THE KIOSK LOCK THE EFFECTIVE WIDTH OF THE PEDESTRIAN TRAVEL WAY.

## MONUMENT SIGN SPECIFICATIONS AND FUNCTIONS

THE UNIT CONSISTS OF A UL/NRTL LISTED WEATHER AND VANDAL RESISTANT FREE STANDING ENCLOSURE DESIGNED TO COMPLY WITH THE FLORIDA BUILDING CODE AND OTHER APPLICABLE CODES INCLUDING THE NATIONAL ELECTRICAL CODE. THE UNIT HAS BEEN DESIGNED TO WITHSTAND WINDS OF 165 MPH. THE UNIT'S MAIN COMPONENTS ARE:

- TWO (2) INTERACTIVE 65" VIDEO TOUCH SCREENS.
- TWO (2) CAMERAS
- ONE (1) CPU
- ONE (1) WI-FI TRANSMITTER

MANUFACTURER: DYNASCAN MODEL NUMBER: CIO651DR5  
NATIVE RESOLUTION: 1920 X 1080  
ELECTRICAL POWER REQUIREMENT:

- ONE-2-POLE, 20 AMP, 240 VOLTS CIRCUIT.
- TOTAL LOAD: 1400/2200 WATTS (OPERATIONAL/PEAK)
- VOLTAGE: 100-240 VOLTS AC, 50-60 HZ

WEIGHT: 832 LBS  
CERTIFICATION CE / FCC / RoHS

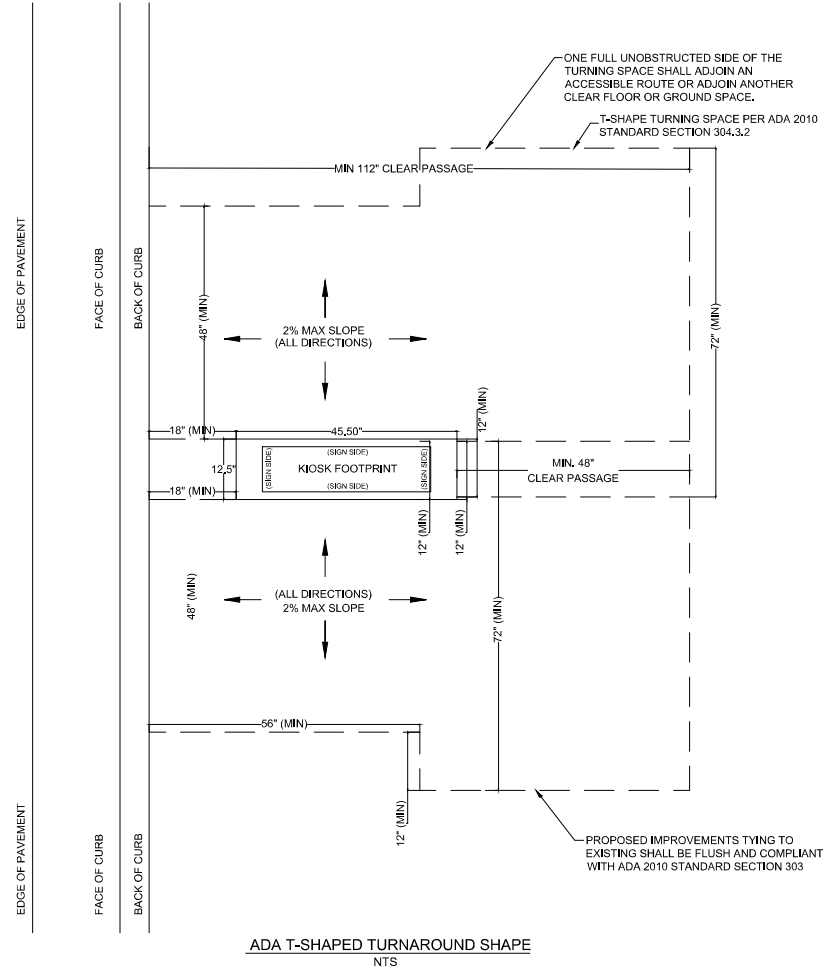

NOTES:

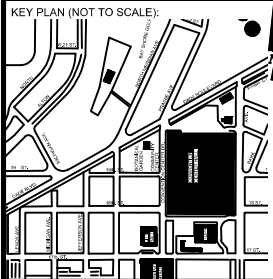

P.E. SEAL:

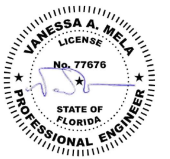

**MIAMI BEACH**  
PUBLIC WORKS DEPARTMENT  
1700 CONVENTION CENTER DRIVE, MIAMI BEACH, FL 33139

CITY MANAGER: ALINA T. HUDAK  
DIRECTOR: JOE GOMEZ, P.E.  
CITY ENGINEER: CRISTINA ORTEGA CASTINEIRAS, P.E.

NO.	DATE	REVISION	APPROD. BY
1			
2			
3			
4			
5			



ENGINEER OF RECORD:  
VANESSA A. MELA  
P.E. NO. 77676

DESIGN ENGINEER: VM  
DRAWN BY: KM  
CHECKER: WP  
SCALE:

NEIGHBORHOOD:  
**MIB-003: CONVENTION CENTER DR & 19TH ST**  
TITLE: **ADA NOTES, SCOPE OF WORK & KIOSK SPECIFICATIONS**

File Name: MIB-003-GENERAL AND FOUNDATION.dwg  
Survey Reference:  
Field Book: N/A Page: N/A Work Order: N/A  
Date: 02/09/2024 Sheet: 3 of 7 Drawing: G0-04





**Sunshine811**  
Call 811 or visit [sunshine811.com](http://sunshine811.com) two full business days before digging to have buried facilities located and marked.  
*Check positive response codes before you dig!*

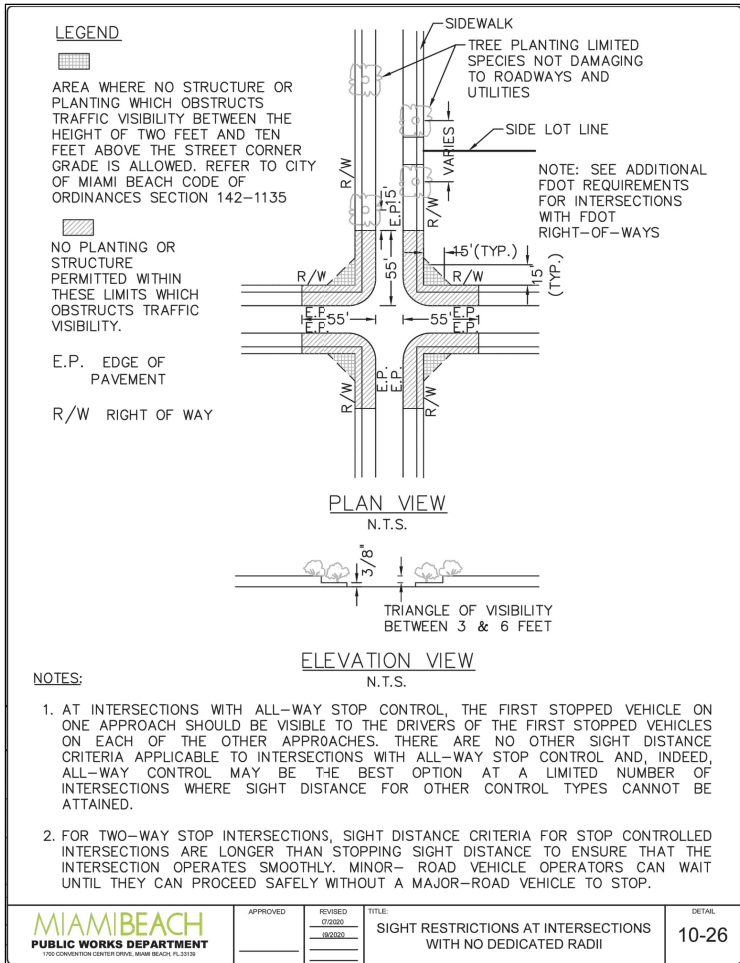

**NOTES:**

**KEY PLAN (NOT TO SCALE):**

**P.E. SEAL:**

ENGINEER OF RECORD: VANESSA A. MELIA P.E. NO. 77676	ENGINEER OF RECORD: VM DESIGN ENGINEER: VM DRAWN BY: KM CHECKER: YP SCALE:	NEIGHBORHOOD: <b>MIB-003: CONVENTION CENTER DR &amp; 19TH ST</b> TITLE: <b>CIVIL SITE PLAN</b>	File Name: MIB-003-CIVIL PLANS.dwg Survey Reference: Field Book: N/A Date: 02/09/2024 Page: N/A Sheet: 4 of 7 Work Order: N/A Drawing: C1-01
---	--	---	---



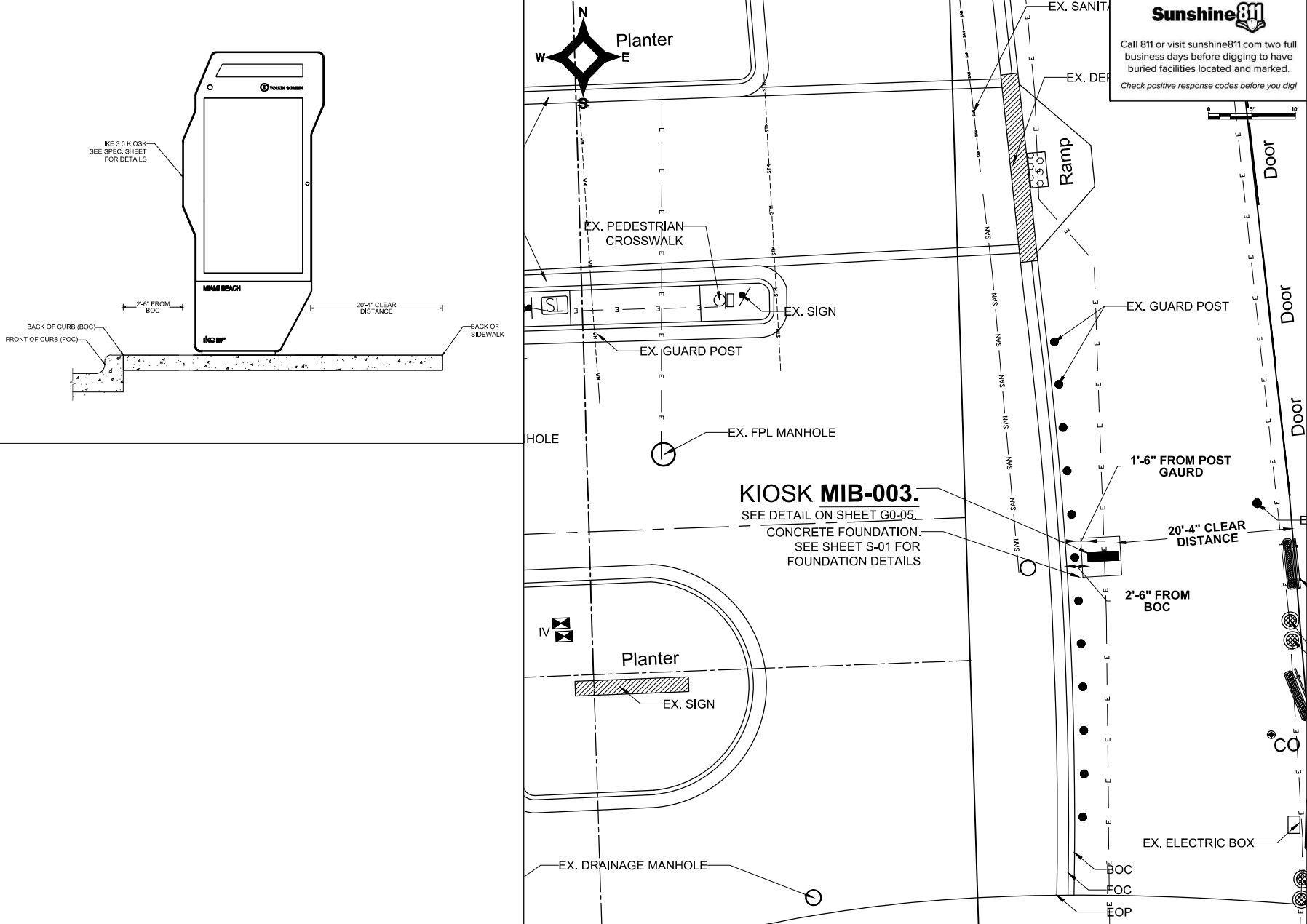

**Sunshine 811**  
Call 811 or visit sunshine811.com two full business days before digging to have buried facilities located and marked.  
Check positive response codes before you dig!

NOTES:

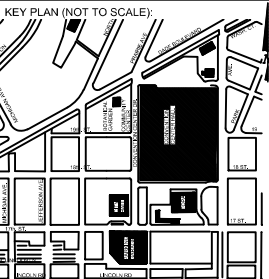

P.E. SEAL:  
**VANESSA A. MELA**  
LICENSE  
No. 77676  
STATE OF  
FLORIDA  
PROFESSIONAL ENGINEER

**MIAMI BEACH**  
PUBLIC WORKS DEPARTMENT  
1700 CONVENTION CENTER DRIVE, MIAMI BEACH, FL 33139

CITY MANAGER: ALINA T. HUDAK  
DIRECTOR: JOE GOMEZ, P.E.  
CITY ENGINEER: CRISTINA ORTEGA  
CASTINEIRAS, P.E.

NO.	DATE	REVISION	APP'D. BY
1			
2			
3			
4			
5			



ENGINEER OF RECORD:  
DESIGN ENGINEER: VM  
DRAWN BY: KM  
CHECKER: WP  
SCALE: 1"=5'  
VANESSA A. MELA  
P.E. NO. 77676

NEIGHBORHOOD:  
**MIB-003: CONVENTION CENTER DR & 19TH ST**  
TITLE:  
**KIOSK MIB-003 ENGINEERING PLAN**

File Name: MIB-003-CIVIL PLANS.dwg  
Survey Reference:  
Field Book: N/A  
Page: N/A  
Work Order: N/A  
Date: 02/09/2024  
Sheet: 5 of 7  
Drawing: C1-02

# ELECTRICAL PLAN

SCALE: 1"=20'



NOTES:

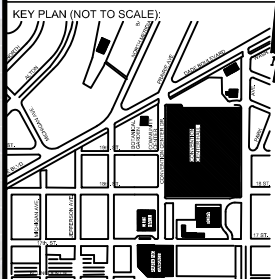
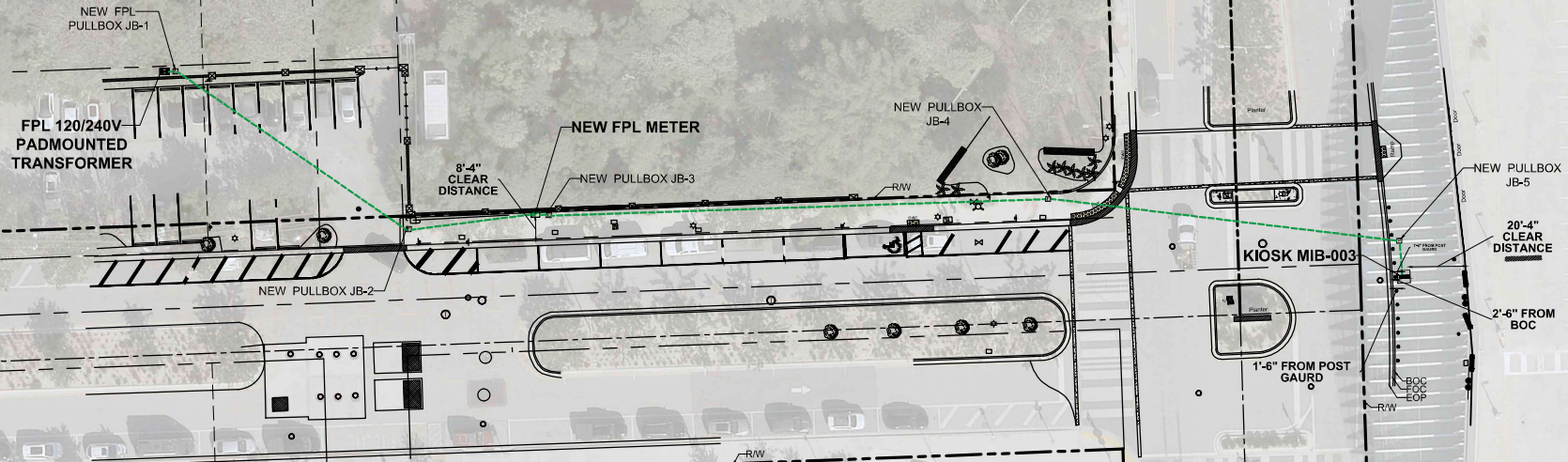

P.E. SEAL:

**Sunshine811**

Call 811 or visit sunshine811.com two full business days before digging to have buried facilities located and marked.  
Check positive response codes before you dig!

**MIAMI BEACH**

CITY MANAGER: ALINA T. HUDAK  
DIRECTOR: JOE GOMEZ, P.E.  
CITY ENGINEER: CRISTINA ORTEGA CASTINEIRAS, P.E.

5			
4			
3			
2			
1			
NO.	DATE	REVISION	APP'D. BY



ENGINEER OF RECORD: WILLIAM E. PINO, P.E. NO. 32088  
ENGINEER OF RECORD: WP  
DESIGN ENGINEER: WP  
DRAWN BY: KM  
CHECKER: WP  
SCALE: 1"=20'

NEIGHBORHOOD: MIB-003: CONVENTION CENTER DR & 19TH ST  
TITLE: KIOSK MIB-003 ELECTRICAL PLAN

File Name: MIB-003-ELECTRICAL & TTC PLANS.dwg  
Survey Reference: N/A  
Field Book: N/A  
Page: N/A  
Work Order: N/A  
Date: 02/09/2024  
Sheet: 6 of 7  
Drawing: E1-01



# SPECIFIC PURPOSE SURVEY

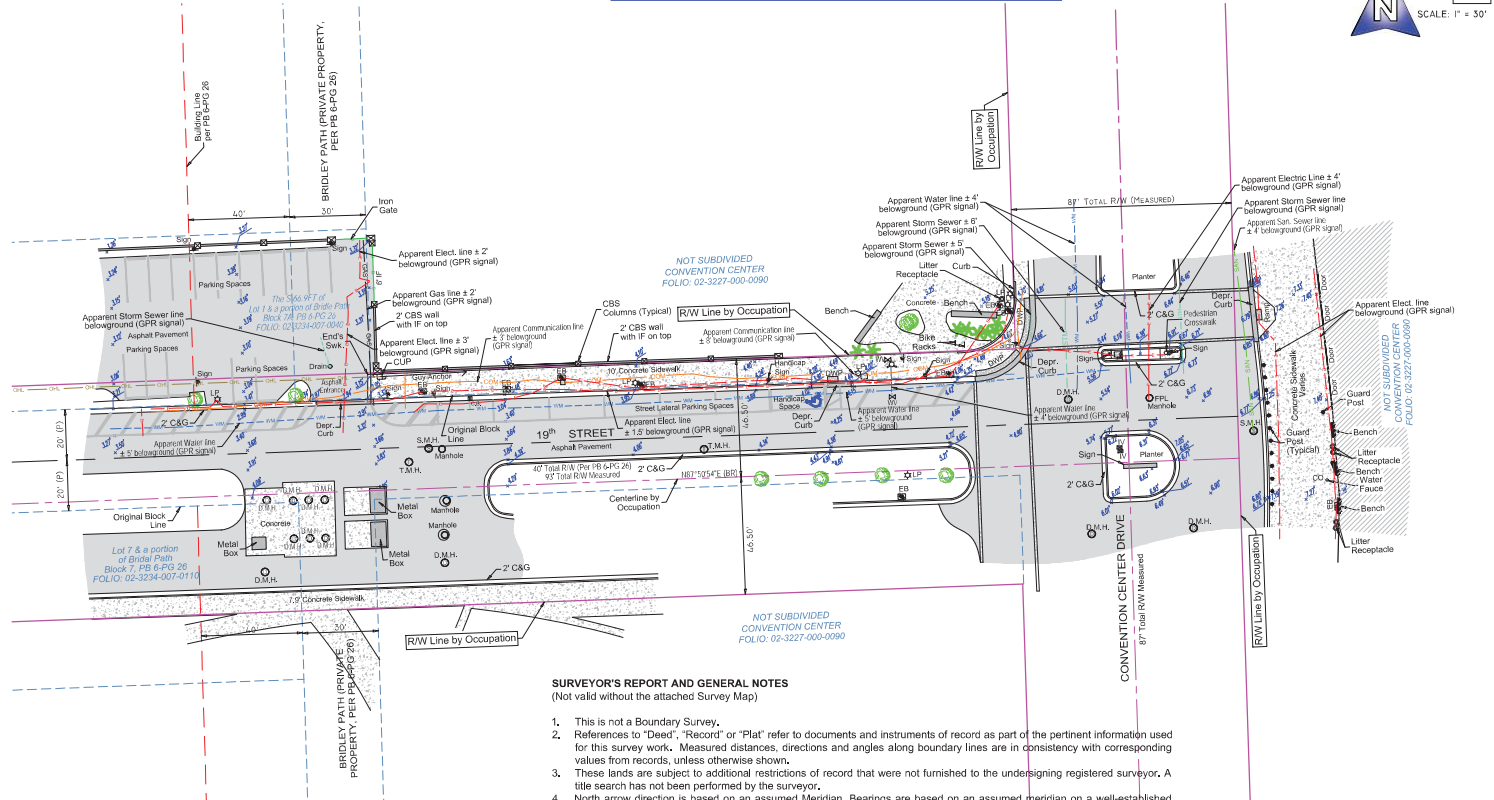

LEGEND & ABBREVIATIONS	
	CONCRETE (CONC.)
	CONCRETE BLOCK WALL
	WOOD DECK
	COVERED AREA
	ASPHALT
	TILE
	PAVERS
	STONE
	CHAIN LINK FENCE (CLF)
	WOOD FENCE (WF)
	IRON METAL BARS FENCE (IF)
	OVERHEAD WIRES
	WATER VALVE (WV)
	POWER POLE (PP)
	GUY ANCHOR
	WATER METER (WM)
	CONC. LIGHT POLE (LP)
	ELECTRIC BOX (EB)
	STREET SIGN
	SANITARY MANHOLE
	DRAINAGE MANHOLE
	MANHOLE
	TELEPHONE MANHOLE
	CABLE BOX (CAB)
	CATCH BASIN OR INLET
	EXISTING ELEVATION
	CONCRETE COLUMNS
	TREE (NO IDENTIFIED)
	PALM (NO IDENTIFIED)
PT	POINT OF TANGENCY
PC	POINT OF CURVATURE
PCC	POINT OF COMPOUND CURVE
PRC	POINT OF REVERSE CURVE
BH	BENCH MARK
BR	BEARING REFERENCE
DWP	DETECTABLE WARNING PAD
DEPR.	DEPRECEASED
E	PROPERTY LINE
C	CENTER LINE
B	BASE LINE
PSH	PROFESSIONAL SURVEYOR AND MAPPER
C&G	CURB & GUTTER
GA	GUY ANCHOR
ENCR	ENCROACHMENT
VE	VALLEY CUTTER
DOCK-X	DOCKS PLAT BOOK XX - PAGE XX
ORB	OFFICIAL RECORD BOOK
CS	CONCRETE BLOCK STRUCTURE
R/W	RIGHT OF WAY
ELECT	ELECTRIC
SEC	SECTION
T	TOWNSHIP
R	RANGE
WM	WATER MEASURED
(C)	CALCULATED
(R)	RECORD
(P)	PER PLAT

## SURVEYOR'S REPORT AND GENERAL NOTES

(Not valid without the attached Survey Map)

- This is not a Boundary Survey.
- References to "Deed", "Record" or "Plat" refer to documents and instruments of record as part of the pertinent information used for this survey work. Measured distances, directions and angles along boundary lines are in consistency with corresponding values from records, unless otherwise shown.
- These lands are subject to additional restrictions of record that were not furnished to the undersigned registered surveyor. A title search has not been performed by the surveyor.
- North arrow direction is based on an assumed Meridian. Bearings are based on an assumed meridian on a well-established line, said line is being noted as BR on the Survey Map.
- Only above ground improvements are shown herein. Foundations, underground features and utilities have not been located.
- Survey markers found in the field have no identification unless otherwise shown. Any survey marker set by our company is labeled LB 7262 or PSM 6168.
- This Survey Map is intended to be displayed at the scale shown hereon. Data is expressed in U.S. Survey Foot.
- This Survey Map is being prepared for the use of the party/parties that it is certified to and does not extend to any unnamed individual, entity or assignee.
- FLOODPLAIN INFORMATION:** As scaled from Federal Insurance Rate Map (FIRM) of Community No. 120651 (City of Miami Beach), Panel 0319, Suffix L, revised on Sept 11th, 2009, this real property falls in Zone "X" and "AE" with Base Flood Elevation 8 feet (NGVD 1929).
- HORIZONTAL ACCURACY:** Accuracy obtained thru measurements and calculations meets and exceeds the minimum horizontal feature accuracy for a Suburban area being equal to 1 foot in 7,500 feet.
- VERTICAL CONTROL AND ACCURACY:** The elevations as shown are referred to the National American Vertical Datum of 1988 (NAVD 1988). The closure in feet, as computed, meets the standard of plus or minus 0.05 feet times the squared root of the loop distance in miles. Elevation are based on a level loop from and to the following official Bench Marks:  
Bench Mark #1: City Miami Beach Bench Mark CMB MA 12, Elevation = 7.56 feet (NAVD'88)  
Description: PK Nail & washer in traffic separator @ south side of Dade Boulevard & Meridian Avenue.  
Bench Mark #2: City Miami Beach Bench Mark CMB 17 CH, Elevation = 2.46 feet (NAVD'88)  
Description: Nail & washer @ Southeast quadrant of intersection Meridian Avenue & 17th Street.

### SUE NOTES:

- Data collected for this Survey had been determined using GNSS (RTK/GPS) conventional TS and differential leveling. Dimensions obtained are subject to equipment limitations.
- Subsurface Utility investigation was performed as part of this survey using GPR (Ground Penetrating Radar) and RD (Radiodetection Technology) for design and location of underground facilities. This Survey depicts apparent location of underground piping found during this investigation. This method accuracy is plus or minus 1.5 feet approximately. There might be additional underground facilities not discovered at the time of this survey.

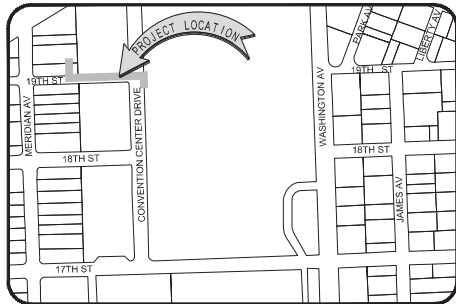

**LOCATION MAP**  
Not to Scale

## I HEREBY CERTIFY TO:

Main Street Engineering  
That this Survey conforms to the Standards of Practice as set forth by the Florida Board of Professional Surveyors and Mappers in applicable provisions of Chapter 5J-17, Florida Administrative Code pursuant to Section 472.027 Florida Statutes. This Survey is accurate and correct to the best of my knowledge and belief.

Odalys C. Bello  
CALS, ex-Bello and Bello Land  
Surveying Corp.  
dnQualifier-A011020000188  
4E3867E800000A0A, cs=Odalys  
C Bello  
2023.08.02 09:08:54 -c410f

Odalys C. Bello-Iznaga  
Professional Surveyor and Mapper LS#169 • State of Florida  
Field Work Date: 08/01/2023

Additional and deletions to this Survey Map are prohibited. This Survey Map and Report are not valid without the signature and original raised seal or without the authenticated electronic signature and seal of the undersigned Florida Licensed Surveyor and Mapper.

Property Address:  
1901 Convention Center Drive, Miami Beach, Florida 33125  
Project No. 23181 D.B., EO Page 1 of 1

**BELLO & BELLO LAND SURVEYING**  
1220 SW 131 AVENUE • SUITE 201 • MIAMI FL 33186  
Phone: 305.251.9606 • Fax: 305.251.6057 • LB#7262  
e-mail: info@belloland.com • www.bellolandsurveying.com







● TEAL CIRCLES: PHOTOGRAPHER'S APPROXIMATE POSITION  
 ● RED CIRCLE: APPROXIMATE KIOSK POSITION



1. VIEW OF SITE FROM NORTH



2. VIEW OF SITE FROM NORTHWEST





TEAL CIRCLES: PHOTOGRAPHER'S APPROXIMATE POSITION  
 RED CIRCLE: APPROXIMATE KIOSK POSITION

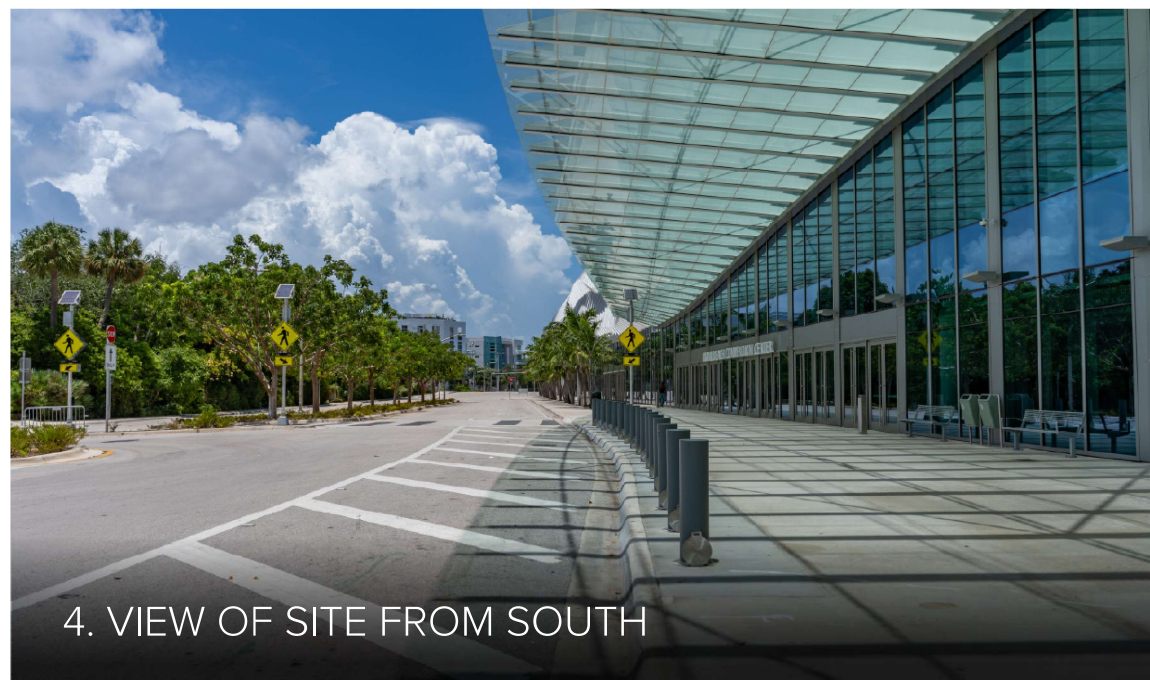

# MIAMI BEACH

## PUBLIC WORKS DEPARTMENT LINCOLN ROAD & ALTON ROAD (SR-907) INTERACTIVE DIGITAL KIOSK DEPLOYMENT PROJECT FEBRUARY 2024 IKE SMART CITY MIB-017

### CITY OF MIAMI BEACH

MAYOR: STEVEN MEINER

COMMISSIONERS: KRISTEN ROSEN GONZALEZ  
LAURA DOMINGUEZ  
ALEX J. FERNANDEZ  
TANYA K. BHATT  
DAVID SUAREZ  
JOSEPH MAGAZINE

CITY MANAGER: ALINA T. HUDAK

CITY ATTORNEY: RAFAEL A. PAZ

PUBLIC WORKS DIRECTOR: JOE GOMEZ, P.E., F.FES

CITY ENGINEER: CRISTINA ORTEGA

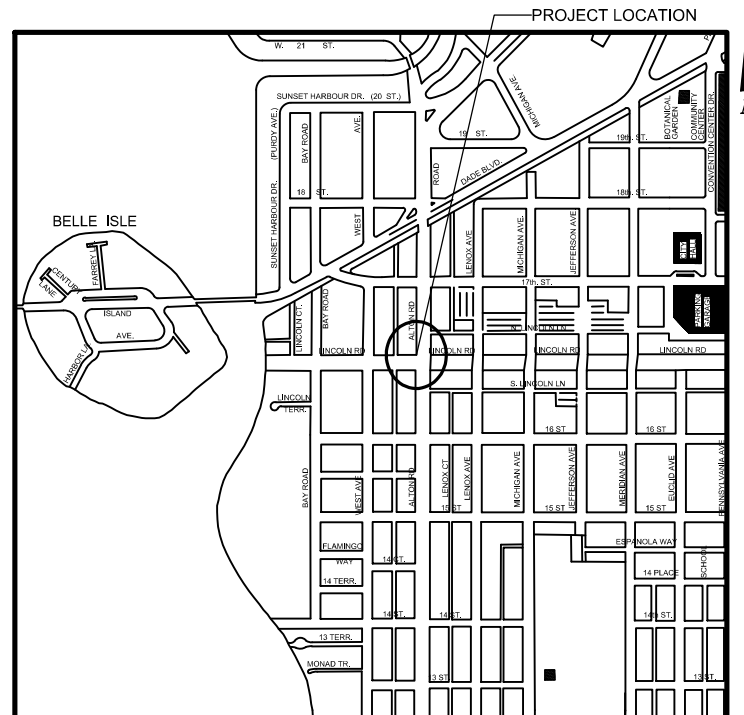

LOCATION MAP



### INDEX OF PLANS

NUMBER	DISCIPLINE	SHEET NO.	DESCRIPTION	NOTES
1	GENERAL	G0-01	COVER SHEET	

**SCOPE OF WORK:** THE PROJECT CONSISTS OF THE INSTALLATION OF ONE (1) DIGITAL INTERACTIVE KIOSK AND APPLICABLE INFRASTRUCTURE; STRUCTURAL FOUNDATION AND ELECTRICAL SERVICE AT THE LOCATION INDICATED ON THESE DESIGN PLANS.

ENGINEER OF RECORD: VANESSA A. MELA, P.E. NO. 77676

Work Order \_\_\_\_\_ Sheet 1 of 1 Drawing **G0-01**



## 6. Lincoln Rd & Alton Rd - Plans

Due to the ongoing construction at this intersection as a result of the CitizenM Hotel development, the sidewalk is currently obstructed by construction fencing. Therefore, this location could not be surveyed due to the inaccessibility of the site. However, once the location is accessible, the plan sets shall reflect what the intersection will look like post-construction.