

Richard A. Barocas
ISA Certified Arborist
7565 SW 135 St.
Pinecrest, FL 33156
305.518.8350 * barocasr@bellsouth.net

Arborist Tree Resource Survey/Level-2, Limited visual assessment
In advance of possible property improvement

Prepared for: The City of Miami Beach

To: 5300 Flamingo Drive LLC
C/O Todd Michael Glaser Properties
Via: jakeryantmg@gmail.com

Property location: 3500 Flamingo Dr.

Folio: 02-3226-002-0400

Date of site visit: February 25, 2025

23-Pages total



- **This assessment was done for the purpose of documenting all trees on property, in advance of possible construction. No construction plans have been reviewed, therefore, no TPB Spec's can be provided, however, CRZ and TPZ Spec's are included for use in subsequent plans.**

Tree sizes are listed in diameter at breast height (**dbh**) measurement, taken at or as close to 54" above grade, rounded to the nearest inch, measured with a forestry tape. Height is expressed in an estimated number of feet per visual observation and recorded in 2' to 5' increments dependent upon overall tree height. Canopy area/spread is most often measured in two perpendicular directions (north/south & east west if available) with a ground wheel device and recorded in the two dimensions. Or, expressed as an estimated average diameter of spread. Where important or applicable, canopy spread will also be expressed in square feet. Multi-trunk trees include the sum of all trunks greater than 2" diameter. Multi-trunk, clustering palms are expressed by an estimate of total dominant trunks, including an average range of diameter X an average overall height and spread.

Tree conditions consider tree vigor, form, structure, volume and appearance of foliage and species impact if a known invasive, controlled or prohibited species:

Excellent: A tree or palm offering excellence in all aspects of its health and structure.

Good: No obvious signs of current health or structural defects with all indications of long-term viability.

Fair: Some evidence of health and/or structural defects are present which are or may compromise the long-term viability but are able to be improved and/or corrected, reducing or eliminating their effects.

Poor: Some evidence of health and/or structural defects are present and are not correctable through commonly acceptable arboriculture practices, therefore the decline of its condition is likely, presenting an increase in risk of failure and/or premature death is likely. Or, a Prohibited/Invasive species. **Trees rated Poor should be considered for removal!**

***Hazardous:** Evidence of an imminent or impending threat of failure resulting in potential harm or damage to people, property or surrounding healthy trees, which cannot be mitigated by commonly accepted arboricultural practices. **Trees rated Hazardous are recommended for immediate removal!**

** Hazardous trees “may” qualify for a Tree Risk Assessment and potential removal without a permit or government intervention per the Private Property Rights Act of 2019, FS163.045.*

Specimen trees & palms: Trees and palms are designated by the City of Miami Beach when they mature to a trunk size worthy of special consideration. A Specimen does not necessarily refer to the health or condition of a tree or palm. The Specimen designation can be important when making decisions related to a tree’s removal and/or relocation. Miami Beach Code, Chapter 46-56 defines trees and palms with an individual trunk **or** multiple trunks with a total cumulative trunk diameter of 12” or greater, measured at 54” above grade (diameter at breast height; “dbh”) as “Specimen”. Palms with an overall height of 10’ or greater, with multiple trunks in which the sum of those trunks equal 12” or greater is also a Specimen. Specimen trees may also require different mitigation/replacement obligations than non-Specimen trees. Consult the City Codes for exceptions that may apply to the above.

Tree Protection Zones (TPZ) and Tree Protection Barriers (TPB)

City Of Miami Beach: Section 46-62; Tree preservation and protection requirements, root cutting, tree relocations, tree pruning, and tree maintenance.

1. Tree protection requirements, in general and during construction.

(a) General. All reasonable steps shall be taken to prevent the destruction or damaging of trees for which no tree work permit has been issued during site development and construction on private or public property. Any owner, tenant, contractor or agent thereof who fails to provide tree protection, as set forth herein, shall be subject to enforcement as provided in [section 46-67](#). Trees destroyed or

City Of Miami Beach: Section 46-62; Tree preservation and protection requirements, root cutting, tree relocations, tree pruning, and tree maintenance, Cont'd.

incurring major damage must be replaced by trees of equal environmental value, as specified by the environment and sustainability department, prior to the issuance of the certificate of occupancy or certificate of use, unless removal of the trees has been authorized pursuant to a tree work permit. Tree protection zones must be established for all trees that remain in place on-site and for any trees relocated within or to the site. When proposed development activities may damage the root systems or canopies of trees to be retained or relocated on-site, alternatives to the proposed activities or effective protective measures, shall be identified and used.

(b) Permit/construction drawings. All permit and construction drawings of the site shall show the tree protection zones, as prescribed by the environment and sustainability department, as shaded areas that are accurately drawn to scale and labeled as such on the drawings. The tree protection zones shall be shown on all drawings that include any underground utility installations, including, but not limited to, irrigation, plumbing, electrical, telecommunication or streetlight lines. The tree protection zones shall be shown on all drawings that include structural installations that will require excavation(s), and for above-ground installations that may include, but is not limited to, such as walkways, street lights, overhead wires or other types of infrastructure.

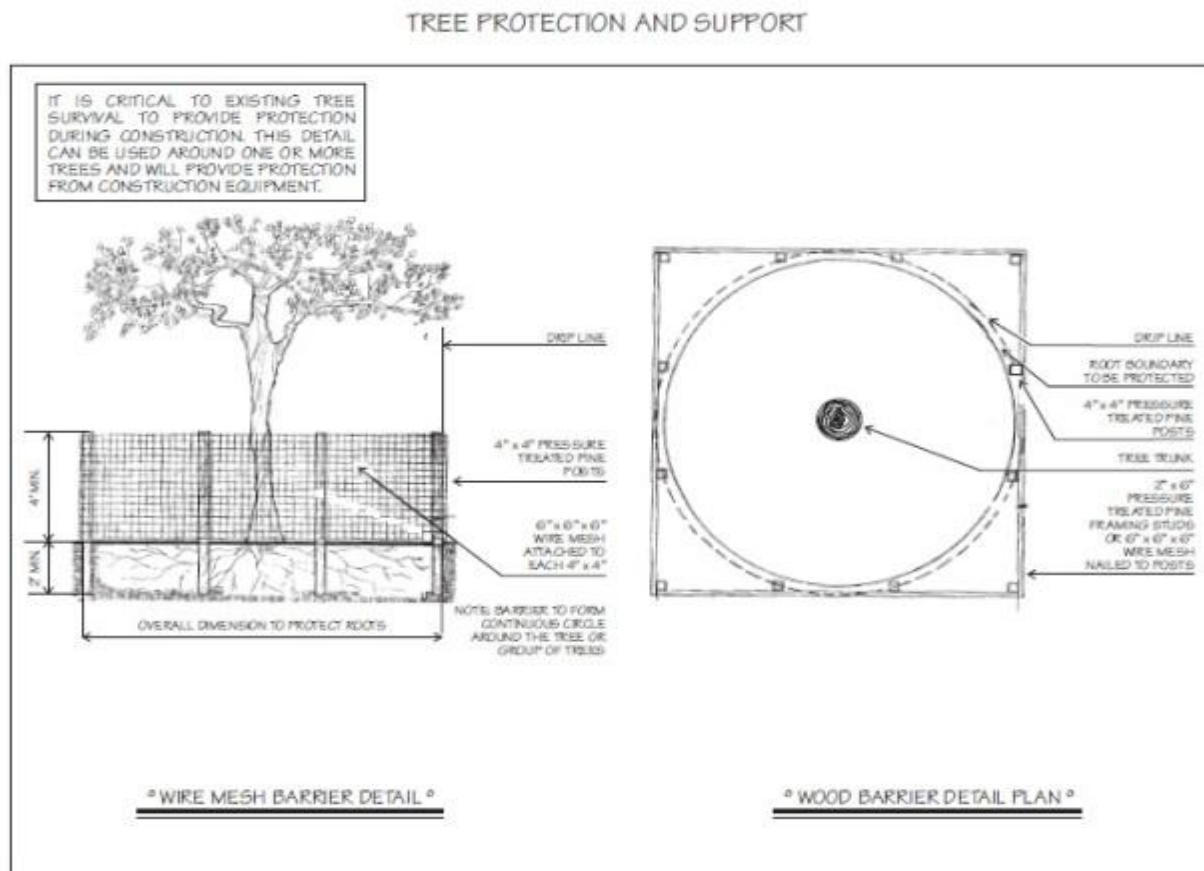

2. Tree protection specifications. The following tree protection specifications must be adhered to, in general, and as a condition of approval of the site plan for any project. The environment and sustainability department may require supplemental protection measures to ensure the protection of trees. The environment and sustainability director and his/her designee shall have the authority to enter the subject property to ensure compliance with required tree protection measures.

(a) Protective barriers.

(i) Placement. Protective barriers shall be placed at the drip line of each tree, cluster of trees, or preservation area, and in no case less than ten feet from the trunk of any protected tree, tree cluster or preservation area. In situations where trees have been transplanted to the project site, the protective fencing shall be placed no closer to the tree than a point one to two feet outside the root ball, or at the drip line, whichever is greater. The fenced tree protection zones shall be extended where necessary to protect tree canopies roots. If trees are to be preserved in place and root pruning is required to accommodate new construction, the root pruning locations shall be identified and approved by the environment and sustainability department, and fencing shall be installed one to two feet beyond the edge of the root ball. The installation of the fencing shall be coordinated with any phased root pruning that must occur. Tree maintenance measures must defined in the general notes of the approved construction plans or a report from an ISA Certified Arborist and or ASCA Registered Consulting Arborist prior to any root pruning or transplanting.

(ii) Timing and duration. All protective barriers shall be installed prior to the start of any construction or site development, including tree removal, demolition or land-clearing activities, and shall remain in place throughout all phases of construction. Protective barriers shall be maintained in place until development is completed, and shall not be removed until the environment and sustainability department inspects the site and authorizes their removal.

(iii) Barrier specifications. Sturdy temporary barriers shall be installed around all tree protection zones. Barriers shall be a minimum of four feet high, and shall be constructed of continuous chain link fence with metal posts at eight-foot spacing, or of two-by-four-inch posts with three equally spaced two-by-four-inch rails. Posts may be shifted to avoid roots.(b)

(b) Activities within tree protection zones enclosed by protective barriers.

(i) Understory plants within areas surrounded by protective barriers shall be protected.

(ii) No oil, fill, equipment, building materials, building debris, or any other material shall be placed within the areas surrounded by protective barriers.

(iii) No disposal of any waste material such as paints, oils, solvents, asphalt, concrete, mortar, or any other material shall occur within the areas surrounded by protective barriers.

(iv) Natural grade shall be maintained on areas surrounded by protective barriers. In the event that the natural grade of the site is changed as a result of site development such that the safety of the tree may be endangered, tree wells or retaining walls are required.

(v) Only hand digging and grading activities will be permitted within the tree protection zone. All surrounding areas must be graded to a point that meets the outside of the tree protection zone.

(vi) Underground utility lines, including, but not limited to, irrigation, plumbing, electrical, or telecommunication lines, shall be placed outside the areas enclosed by protective barriers. If such placement is not possible, disturbance and root damage shall be minimized by using techniques such as tunneling, hand digging, excavation with an air spade, or the use of overhead utility lines.

(vii) No vehicles or equipment shall be permitted within areas surrounded by protective barriers.

(c) Construction of fences, walkways and walls. Fences, walkways and walls shall be constructed to avoid disturbance to any tree to remain in place onsite in the vicinity of construction activities. Post holes and trenches located close to trees shall be dug by hand and adjusted as necessary, using techniques to avoid damage to major roots system.

(d) Attachments prohibited. No attachments, signs, chains, ropes, or wires other than those of a protective or non-damaging nature shall be attached to any trees on publicly owned or controlled property, in general, or during any proposed site development or construction.

Tree I.D., size, condition and comments

Note: 11 Right-Of-Way trees, 4 on-property trees and 7 on-property palms were not included in the Boundary survey, however, are included in this report for accuracy. All are designated in [blue](#). Some are unregulated size, however, are being included for accountability since they appear in pictures.

Flamingo Drive Right-Of-Way

ROW1. Coconut/*Cocos nucifera*: 8" dbh X 40'H X 17' N/S X 17' E/W. Good condition.

ROW2. Specimen Coconut/*Cocos nucifera*: 14" dbh X 40'H X 20' N/S X 20' E/W. Good condition.

ROW3. Specimen Banyan/*Ficus benghalensis*: 71" dbh X 60'H X 58' N/S X 70' E/W. Fair condition; primarily due to structure (multiple branch clusters with poor aspect ratio).

ROW4. Specimen Weeping fig/*Ficus benjamina*: 14" dbh X 40'H X 20' N/S X 20' E/W. **Poor Condition;** primarily due to growing as an understory tree to the Banyan next to it (#ROW3) who's canopy has interrupted enough sunlight to aid in the decline of this tree, along with evidence of Whitefly damage, a 30° trunk lean to the south and terrible branching architecture.

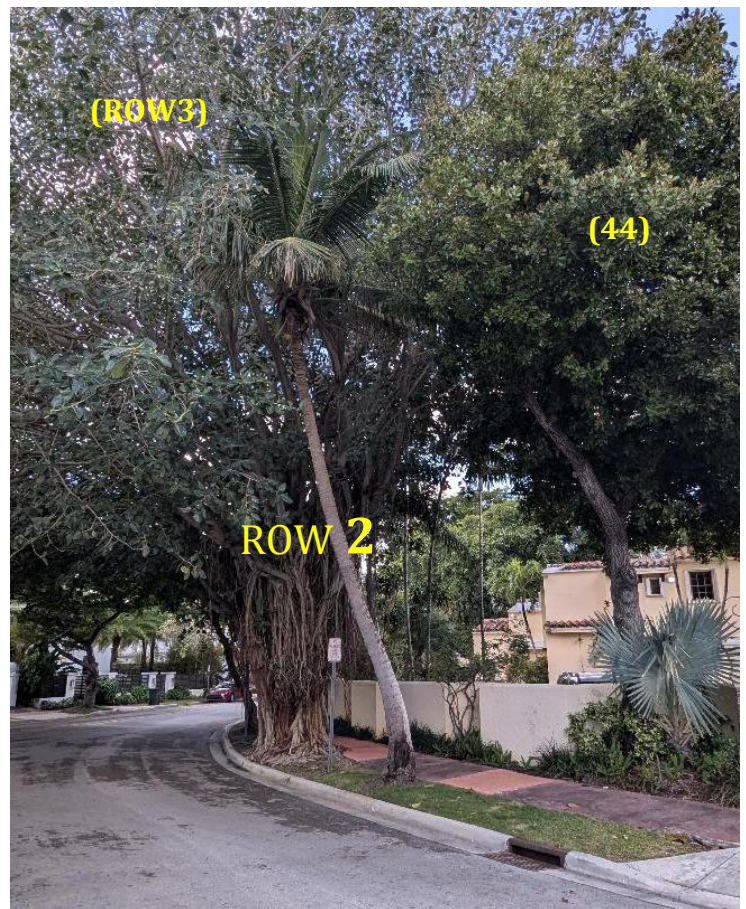

Flamingo Drive Right-Of-Way, Cont'd.



W 35th Street Right-Of-Way

ROW5. Verawood/*Bulnesia arborea*: 2" dbh X 12' X 10' N/S X 9' E/W. Good condition.

ROW6. Verawood/*Bulnesia arborea*: 2" dbh X 15' X 8' N/S X 8' E/W. Good condition.

ROW7. Verawood/*Bulnesia arborea*: 3" dbh X 17' X 11' N/S X 10' E/W. Good condition.

ROW8. Verawood/*Bulnesia arborea*: 4" dbh (2x; 3+1) X 24' X 18' N/S X 10' E/W. Good condition.

ROW9. Verawood/*Bulnesia arborea*: 3" dbh (2x; 2+1) X 15' X 9' N/S X 8' E/W. Good condition.

ROW10. Verawood/*Bulnesia arborea*: 2" dbh X 12' X 5' N/S X 4' E/W. Good condition.

ROW11. Verawood/*Bulnesia arborea*: 3" dbh X 14' X 14' N/S X 12' E/W. Good condition.



Pinetree Drive Right-Of-Way

ROW43. Specimen Strangler fig/*Ficus aurea*: 44" dbh X 55'H X 65' N/S X 40' E/W. Good condition.



Tree I.D., size, condition and comments

Trees within boundary lines

1. Specimen Christmas/*Adonidia merrillii*: 13" dbh (2x; 7"+6") X 32'H X 14' N/S X 14' E/W. Good condition.

2. Specimen Christmas/*Adonidia merrillii*: 12" dbh (2x; 6"+6") X 32'H X 15' N/S X 15' E/W. Good condition.

2A. Christmas/*Adonidia merrillii*: 10" dbh (2x; 5"+5") X 30'H X 15' N/S X 15' E/W. Good condition

2B. Christmas/*Adonidia merrillii*: 9" dbh (2x; 5"+4") X 28'H X 15' N/S X 15' E/W. Good condition.

2C. Christmas/*Adonidia merrillii*: 8" dbh (2x; 4"+4") X 26'H X 13' N/S X 13' E/W. Good condition.

2D. *Unregulated Bismarckia nobilis*: No developed trunk @ 4.5' above grade. 12'OA X 9' N/S X 9' E/W.



3. Solitaire palm/*Ptychosperma elegans*: 8" dbh (2x; 4"+4") X 40'H X 12' N/S X 12' E/W. Good condition.
4. Queen palm/*Syagrus romanzoffianum*: 9" dbh X 36'H X 12' N/S X 18' E/W. Fair condition.
5. Queen palm/*Syagrus romanzoffianum*: 9" dbh X 44'H X 10' N/S X 10' E/W. Fair condition.
6. *Unregulated* Solitaire palm/*Ptychosperma elegans*: 4" dbh X 40'H X 12' N/S X 12' E/W. Good condition.
7. *Unregulated* Solitaire palm/*Ptychosperma elegans*: 4" dbh X 40'H X 12' N/S X 12' E/W. Good condition.
8. *Unregulated* Solitaire palm/*Ptychosperma elegans*: 4" dbh X 40'H X 8' N/S X 10' E/W. Good condition.
9. *Unregulated* Christmas/*Adonidia merrillii*: 5" dbh X 25'H X 8' N/S X 8' E/W. Good condition.
10. Christmas/*Adonidia merrillii*: 6" dbh X 30'H X 10' N/S X 10' E/W. Fair condition due to a cavity in the NW trunk face, 4' above grade.
- 10A. *Unregulated* Solitaire palm/*Ptychosperma elegans*: 3" dbh X 40'H X 10' N/S X 10' E/W. Good condition.



Trees within boundary lines. Cont'd.

11. *Unregulated Montgomery/Veitchia montgomeriana*:
3" dbh X 16'H X 16' N/S X 16' E/W. Good condition.

12. *Unregulated Montgomery/Veitchia montgomeriana*:
4" dbh X 24'H X 10' N/S X 10' E/W. Good condition.

13. *Unregulated Montgomery/Veitchia montgomeriana*:
5" dbh X 24'H X 10' N/S X 10' E/W. Good condition.

14. Royal palm/*Roystonea regia*: 10" dbh X 50'H X 18'
N/S X 18' E/W. Good condition.



Trees within boundary lines. Cont'd.

15. Specimen *Bismarckia nobilis*: 21" dbh X 60'H X 20' N/S X 20' E/W. Good condition.

16. Specimen *Bismarckia nobilis*: 16" dbh X 22'H X 16' N/S X 16' E/W. Good condition.

17. Unregulated Christmas/*Adonidia merrillii*: 5" dbh X 26'H X 11' N/S X 11' E/W. Good condition.

18. Unregulated Christmas/*Adonidia merrillii*: 5" dbh X 28'H X 10' N/S X 10' E/W. Good condition.

19. Unregulated Christmas/*Adonidia merrillii*: 5" dbh X 28'H X 6' N/S X 6' E/W. Good condition.

20. Specimen Avocado/*Persea americana*: 48" dbh (4; 14"+13"+12"+9") X 55'H X 37' N/S X 32' E/W. Fair condition due to the 4x union located only 36" above grade with poor aspect ratio and a Fishtail palm growing out of the union.

*Note: #18 &
#19 are
hidden
behind #16*



Trees within boundary lines. Cont'd.

21. Cabbage/*sabal palmetto*: 9" dbh X 22'H X 10' N/S X 10' E/W. Good condition.

21A. Signature/*Clusia rosea*: 13" dbh X 40'H X 27' N/S X 34' E/W. Fair condition due to the trunk growing out of a tight cluster of a comingled areca and fishtail palm. Additionally, the north side of the canopy has been "side-cut" back to the property line (evidently it had been overhanging the north neighbor's side).

22. Specimen *Bismarckia nobilis*: 15" dbh X 40'H X 19' N/S X 19' E/W. Good condition.

23. Specimen *Bismarckia nobilis*: 17" dbh X 48'H X 20' N/S X 20' E/W. Good condition.

24. Specimen *Bismarckia nobilis*: 17" dbh X 50'H X 20' N/S X 20' E/W. Good condition.

25. Specimen *Bismarckia nobilis*: 14" dbh X 48'H X 16' N/S X 16' E/W. Good condition.

26. Specimen *Bismarckia nobilis*: 15" dbh X 32'H X 18' N/S X 18' E/W. Good condition.

26A. Royal/*Roystonea regia*: 6" dbh X 18'H X 12' N/S X 12' E/W. Fair condition due to location.

27. Specimen *Bismarckia nobilis*: 13" dbh X 32'H X 18' N/S X 18' E/W. Good condition.





Trees within boundary lines. Cont'd.

28. Christmas/*Adonidia merrillii*: 6" dbh X 24'H X 10' N/S X 10' E/W. Good condition.

29. Unregulated Solitaire palm/*Ptychosperma elegans*: 5" dbh X 24'H X 18' N/S X 18' E/W. Good Cond.

29A. Unregulated Royal/*Roystonea regia*: 3" dbh X 12'H X 4' N/S X 5' E/W. Good condition.

30. Unregulated Solitaire palm/*Ptychosperma elegans*: 4" dbh X 36'H X 16' N/S X 16' E/W. Good Cond.

31. Unregulated Solitaire palm/*Ptychosperma elegans*: 4" dbh X 32'H X 16' N/S X 16' E/W. Good Cond.

32. Unregulated Solitaire palm/*Ptychosperma elegans*: 4" dbh X 32'H X 16' N/S X 16' E/W. Good Cond.

33. Unregulated Solitaire palm/*Ptychosperma elegans*: 4" dbh X 32'H X 12' N/S X 16' E/W. Good Cond.

33A. Black olive/*Terminalia buceras*: 3" dbh X 36'H X 8' N/S X 12' E/W. Good Condition.

34. Black olive/*Terminalia buceras*: 10" dbh X 45'H X 36' N/S X 27' E/W. Good Condition.

34A. Black olive/*Terminalia buceras*: 4" dbh X 30'H X 19' N/S X 12' E/W. Fair Condition due to high degree of suppressed growth to the south from #33.





35. Specimen Black olive/*Terminalia buceras*: 10" dbh X 45'H X 36' N/S X 27' E/W. Good Condition.

- This tree is note worthy of being in extremely good condition. It is truly a specimen by virtue of a very straight trunk with excellent taper to approximately 25', at which point there is a branch cluster with less than desirable aspect ratio of the stems (otherwise this tree would be rated as in Excellent Condition). Additionally, this tree offers very good canopy branch architecture, very good branch spacing and a well-balanced canopy, exhibiting excellent health.
- **If any construction and/or ground disturbing activities may take place within the TPZ, a 12' radius, protection is critical!**

36. Unregulated Coconut palm/*Cocos nucifera*: 4" dbh X 40'H X 10' N/S X 10' E/W. Good condition.

Trees within boundary lines. Cont'd.

37. Specimen Cabbage/*Sabal palmetto*: 15" dbh X 34'H X 13' N/S X 13' E/W. Good condition.

38. Specimen Star fruit/*Carambola averrhoa*: 15" dbh X 18'H X 18' N/S X 24' E/W. Fair condition due to structure. The center leader failed at approximately 8' above grade and there is a cavity opening on the east trunk face from 5' to 8' above grade. Despite the condition of the trunk, reaction growth has provided 3 significant vertical stems from just below the cavity, which are responsible for the current canopy.

39. Unregulated Solitaire palm/*Ptychosperma elegans*: 3" dbh X 38'H X 10' N/S X 10' E/W. Good Condition

40. Unregulated Solitaire palm/*Ptychosperma elegans*: 4" dbh X 45'H X 6' N/S X 6' E/W. Fair Condition

41. Unregulated Solitaire palm/*Ptychosperma elegans*: 4" dbh X 45'H X 6' N/S X 6' E/W. Fair Condition

- #40 & #41 are both Fair due to sparse canopies with damaged fronds (possible wind damage although not reflected on other nearby palms. Possible insect/pest issue).



Close-up of #38's
damaged trunk with
cavity and reaction
growth stems
providing a
worthwhile canopy



42. Specimen Banyan/*Ficus benghalensis*: 66" dbh X 50'H X 76' N/S X 64' E/W. Good condition.



Pinetree Drive Right-Of-Way

43. See Page-8.

Trees within boundary lines. Cont'd.

44. Specimen Beauty-leaf/*Calophyllum brasiliense*: 18" dbh X 40'H X 32' N/S X 49' E/W. Good condition.



Neighboring tree

N1. Specimen Banyan/*Ficus benghalensis*: Neighboring property has an estimated 60"+ dbh X 60'H with 16' of canopy overhang. Any ground disturbing activities in close proximity to this tree shall be cognizant of the need for root protection on the 3500 side.



Tree Table

"Specimen" trees & palms: A tree with an individual trunk that has a dbh of 12 inches or greater, or any multiple-trunk tree in which the sum of the diameters of all the trunks at dbh equals 12 inches or greater. Includes palm trees with an overall height of 10 feet or greater with multiple-trunks in which the sum of those trunks is 12 inches or greater.

ID #	Name: Common/botanical	dbh" X H' X N/S X E/W	Cond	CRZ Dia. Ft.	TPZ Rad. Ft.
ROW 1	Coconut palm/ <i>Cocos nucifera</i>	8 X 40 X 17 X 17	Good	3	2
ROW 2	Specimen Coconut palm/ <i>Cocos nucifera</i>	14 X 40 X 20 X 20	Good	4	2
ROW 3	Specimen Banyan/ <i>Ficus benghalensis</i>	71 X 60 X 58 X 70	Fair	71	36
ROW 4	Specimen Weeping fig/ <i>Ficus benjamina</i>	14 X 20 X 40 X 33	Poor	14	7
ROW 5	Verawood/ <i>Bulnesia arborea</i>	2 X 12 X 10 X 9	Good	2	1
ROW 6	Verawood/ <i>Bulnesia arborea</i>	2 X 15 X 8 X 8	Good	2	1
ROW 7	Verawood/ <i>Bulnesia arborea</i>	3 X 17 X 11 X 10	Good	2	1
ROW 8	Verawood/ <i>Bulnesia arborea</i>	2 X 12 X 10 X 9	Good	2	1
ROW 9	Verawood/ <i>Bulnesia arborea</i>	3 X 15 X 9 X 8	Good	3	2
ROW10	Verawood/ <i>Bulnesia arborea</i>	2 X 12 X 5 X 4	Good	2	1
ROW 11	Verawood/ <i>Bulnesia arborea</i>	3 X 14 X 14 X 12	Good	3	2
1	Specimen Christmas/ <i>Adonidia merrillii</i>	13 X 32 X 14 X 14	Good	3	2
2	Specimen Christmas/ <i>Adonidia merrillii</i>	12 X 32 X 15 X 15	Good	3	2
2A	Christmas/ <i>Adonidia merrillii</i>	10 X 30 X 15 X 15	Good	3	2
2B	Christmas/ <i>Adonidia merrillii</i>	9 X 28 X 15 X 15	Good	3	2
2C	Christmas/ <i>Adonidia merrillii</i>	8 X 26 X 13 X 13	Good	3	2
2D	Unregulated Bismarck/ <i>Bismarckia nobilis</i>	No developed trunk @ 4.5'	Good	4	2
3	Solitaire palm/ <i>Ptychosperma elegans</i>	8 X 40 X 12 X 12	Good	4	2
4	Queen palm/ <i>Syagrus romanzoffianum</i>	9 X 36 X 12 X 18	Fair	3	2
5	Queen palm/ <i>Syagrus romanzoffianum</i>	9 X 44 X 10 X 10	Fair	3	2
6	Unregulated Solitaire palm/ <i>Ptychosperma elegans</i>	4 X 40 X 12 X 12	Good	2	1
7	Unregulated Solitaire palm/ <i>Ptychosperma elegans</i>	4 X 40 X 12 X 12	Good	2	1
8	Unregulated Solitaire palm/ <i>Ptychosperma elegans</i>	4 X 40 X 8 X 10	Good	2	1
9	Unregulated Christmas/ <i>Adonidia merrillii</i>	5 X 25 X 8 X 8	Good	2	1
10	Christmas/ <i>Adonidia merrillii</i>	6 X 30 X 10 X 10	Fair	2	1
10A	Unregulated Solitaire palm/ <i>Ptychosperma elegans</i>	3 X 40 X 10 X 10	Good	2	1
11	Unregulated Montgomery/ <i>Veitchia montgomeriana</i>	3 X 16 X 16 X 16	Good	1	1
12	Unregulated Montgomery/ <i>Veitchia montgomeriana</i>	4 X 24 X 10 X 10	Good	2	1
13	Unregulated Montgomery/ <i>Veitchia montgomeriana</i>	5 X 24 X 10 X 10	Good	2	1
14	Royal palm/ <i>Roystonea regia</i>	10 X 50 X 18 X 18	Good	3	2
15	Specimen Bismarck/ <i>Bismarckia nobilis</i>	21 X 60 X 20 X 20	Good	4	2
16	Specimen Bismarck/ <i>Bismarckia nobilis</i>	16 X 22 X 16 X 16	Good	5	3
17	Unregulated Christmas/ <i>Adonidia merrillii</i>	5 X 26 X 11 X 11	Good	2	1
18	Unregulated Christmas/ <i>Adonidia merrillii</i>	5 X 28 X 10 X 10	Good	2	1

ID #	Name: Common/botanical	dbh" X H' X N/S X E/W	Cond	CRZ Dia.Ft.	TPZ Rad. Ft.
19	Unregulated Christmas/ <i>Adonidia merrillii</i>	5 X 28 X 6 X 6	Fair	2	1
20	Specimen Avocado/ <i>Persea americana</i>	48 X 55 X 37 X 32	Fair	48	24
21	Cabbage/ <i>Sabal palmetto</i>	9 X 22 X 10 X 10	Good	3	2
21A	Specimen Signature/ <i>Clusia rosea</i>	13 X 40 X 27 X 34	Fair	13	7
22	Specimen Bismarck/ <i>Bismarckia nobilis</i>	15 X 40 X 19 X 19	Good	5	3
23	Specimen Bismarck/ <i>Bismarckia nobilis</i>	17 X 48 X 20 X 20	Good	5	3
24	Specimen Bismarck/ <i>Bismarckia nobilis</i>	17 X 50 X 20 X 20	Good	5	3
25	Specimen Bismarck/ <i>Bismarckia nobilis</i>	14 X 48 X 16 X 16	Good	5	3
26	Specimen Bismarck/ <i>Bismarckia nobilis</i>	15 X 32 X 18 X 18	Good	5	3
26A	Royal palm/ <i>Roystonea regia</i>	6 X 18 X 12 X 12	Good	3	2
27	Specimen Bismarck/ <i>Bismarckia nobilis</i>	13 X 32 x 18 X 18	Good	4	2
28	Christmas/ <i>Adonidia merrillii</i>	6 X 24 X 10 X 10	Good	2	1
29	Solitaire palm/ <i>Ptychosperma elegans</i>	5 X 24 X 18 X 18	Good	5	1
29A	Royal palm/ <i>Roystonea regia</i>	3 X 12 X 4 X 5	Fair	2	1
30	Unregulated Solitaire palm/ <i>Ptychosperma elegans</i>	4 X 36 X 16 X 16	Good	2	1
31	Unregulated Solitaire palm/ <i>Ptychosperma elegans</i>	4 X 32 X 16 X 16	Good	2	1
32	Unregulated Solitaire palm/ <i>Ptychosperma elegans</i>	4 X 32 X 16 X 16	Good	2	1
33	Unregulated Solitaire palm/ <i>Ptychosperma elegans</i>	4 X 32 X 12 X 16	Good	2	1
33A	Black olive/ <i>Terminalia buceras</i>	3 X 36 X 8 X 12	Fair	3	2
34	Black olive/ <i>Terminalia buceras</i>	10 X 45 X 36 X 27	Good	10	5
34A	Black olive/ <i>Terminalia buceras</i>	4 X 30 X 19 X 12	Fair	4	2
35	Specimen Black olive/ <i>Terminalia buceras</i>	24 X 60 X 60 X 58	Good	24	12
36	Unregulated Coconut palm/ <i>Cocos nucifera</i>	4 X 40 X 10 X 10	Good	2	1
37	Specimen Cabbage/ <i>Sabal palmetto</i>	15 X 34 X 13 X 13	Good	5	3
38	Specimen Star fruit/ <i>Carambola averrhoa</i>	15 X 18 X 18 X 24	Fair	15	8
39	Unregulated Solitaire palm/ <i>Ptychosperma elegans</i>	3 X 38 X 10 X 10	Good	2	1
40	Unregulated Solitaire palm/ <i>Ptychosperma elegans</i>	4 X 45 X 6 X 6	Fair	2	1
41	Unregulated Solitaire palm/ <i>Ptychosperma elegans</i>	4 X 45 X 6 X 6	Fair	2	1
42	Specimen Banyan/ <i>Ficus benghalensis</i>	66 X 50 X 76 X 64	Good	66	33
ROW43	Specimen Strangler fig/ <i>Ficus aurea</i>	44 X 55 X 65 X 40	Good	44	22
44	Specimen Beauty leaf/ <i>Calophyllum brasiliense</i>	18 X 40 X 32 X 49	Good	18	9
N1	Neighbor's Specimen Banyan				

CRZ & TPZ Calculations

Trees: CRZ diameter: 1' (12") per inch of dbh or the canopy drip line were conflict may occur outside of the CRZ.

Trees: TPZ radius: .5' (6") per inch of dbh or the canopy drip line. Larger radius exceptions for known sensitive species.

Palms: CRZ (expressed in diameter) & TPZ (expressed in radius) generally reflect the same area of concern by virtue of being Monocot's. : 3" to 4" per inch of dbh for single and multi-stem palms of 6x or less, with total trunk dbh of 24" or less. Larger palms are calculated on a case-by-case basis.

Note: Any or all of the above calculations may be adjusted per species tolerance, tree age, condition, location and/or conflicts or surrounding considerations (i.e., hardscape protection, fences, walls, landscaping, Etc.).



Richard A. Barocas, ISA
FL6342A/TRAQ/PPQ