



## RESTORATION OF THE HISTORIC PROPERTY LANDSCAPE



Deco Preservation with Spanish Roots

Layers of time and history. A palimpsest of different time layered over and over again. The landscape will respect and respond to the forms and shapes of streamline moderne but painted with the rich texture and patterns of the Spanish Roots of Florida

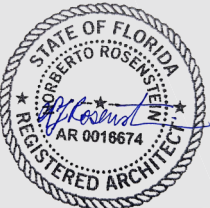

NR  
architect

NORBERTO ROSENSTEIN  
ARCHITECT, INC.

ARCHITECTURE - INTERIOR DESIGN - PLANNING  
126 S. FEDERAL HIGHWAY SUITE #202  
DANIA BEACH, FLORIDA 33004  
P: (954) 922-6551  
NROSENSTEIN@ROSENSTEINARCHITECT.COM  
WWW.ROSENSTEINARCHITECT.COM

STATE REG. NO. ARO016674  
NATL. REG. NO. 69178  
COPYRIGHT © 2024  
NORBERTO ROSENSTEIN  
ARCHITECT, INC.  
ALL RIGHTS RESERVED. THIS  
DOCUMENT OR PARTS THEREOF,  
MAY NOT BE REPRODUCED IN ANY  
FORM WITHOUT PERMISSION.

|          |       |         |
|----------|-------|---------|
| DESIGNED | DRAWN | CHECKED |
|          |       |         |

I HEREBY CERTIFY THAT THESE  
PLANS WERE PREPARED BY ME  
OR UNDER  
MY SUPERVISION, AND TO THE  
BEST OF MY KNOWLEDGE,  
COMPLY WITH ALL APPLICABLE  
CODES.

|  |  |  |
|--|--|--|
|  |  |  |
|  |  |  |
|  |  |  |
|  |  |  |
|  |  |  |

| REVISIONS |      |
|-----------|------|
| COMM.     | DATE |
|           |      |

TREEHOUSE HOTEL,  
MIAMI BEACH

1500 COLLINS +  
1509-1515 WASHINGTON  
AVE, MIAMI BEACH, FL,  
33139

LANDSCAPE  
CONCEPTS

LC0-01



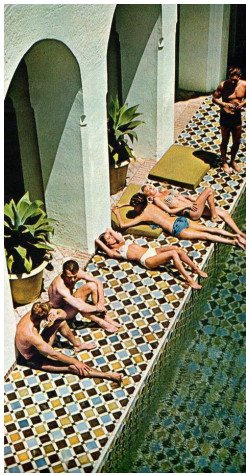

The Spanish Foundation

Rich and layered like the world the Spanish found, this interior courtyard will be full of natural curves with nooks and crannies for guests to get lost within. Native plants drape the garden and building with nature and merge with fragments and layers of Spanish tile and terrazzo.

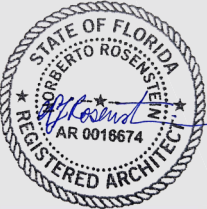

NR  
architect

NORBERTO ROSENSTEIN  
ARCHITECT, INC.  
ARCHITECTURE - INTERIOR DESIGN - PLANNING  
126 S. FEDERAL HIGHWAY SUITE #202  
DANIA BEACH, FLORIDA 33004  
P: (954) 922-6551  
NROSENSTEIN@ROSENSTEINARCHITECT.COM  
WWW.ROSENSTEINARCHITECT.COM

STATE REG. NO. ARO016674  
NATL. REG. NO. 69178  
COPYRIGHT © 2024  
NORBERTO ROSENSTEIN  
ARCHITECT, INC.  
ALL RIGHTS RESERVED. THIS  
DOCUMENT OR PARTS THEREOF,  
MAY NOT BE REPRODUCED IN ANY  
FORM WITHOUT PERMISSION.

| DESIGNED | DRAWN | CHECKED |
|----------|-------|---------|
|          |       |         |

I HEREBY CERTIFY THAT THESE  
PLANS WERE PREPARED BY ME  
OR UNDER  
MY SUPERVISION, AND TO THE  
BEST OF MY KNOWLEDGE,  
COMPLY WITH ALL APPLICABLE  
CODES.

|  |  |  |
|--|--|--|
|  |  |  |
|  |  |  |
|  |  |  |
|  |  |  |
|  |  |  |

| REVISIONS |      |
|-----------|------|
| COMM.     | DATE |
|           |      |

TREEHOUSE HOTEL,  
MIAMI BEACH

1500 COLLINS +  
1509-1515 WASHINGTON  
AVE, MIAMI BEACH, FL,  
33139

LANDSCAPE  
CONCEPTS

LC0-02





Building’s Interaction with Nature

Like the Bayan trees that have inspired many myths and legends across many cultures, this conceptual Banyan tree bridges the 3 distinct buildings. The canopy unifies each building into a singular property and brings the landscape up into the sky to provide shade and activation for activities on multiple levels.

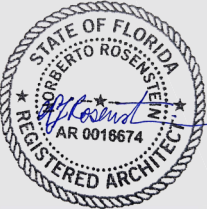

**NR**  
architect

NORBERTO ROSENSTEIN  
ARCHITECT, INC.  
ARCHITECTURE - INTERIOR DESIGN - PLANNING  
126 S. FEDERAL HIGHWAY SUITE #202  
DANIA BEACH, FLORIDA 33004  
P: (954) 922-6551  
NROSENSTEIN@ROSENSTEINARCHITECT.COM  
WWW.ROSENSTEINARCHITECT.COM

STATE REG. NO. ARO016674  
NATL. REG. NO. 69178  
COPYRIGHT © 2024  
NORBERTO ROSENSTEIN  
ARCHITECT, INC.  
ALL RIGHTS RESERVED. THIS  
DOCUMENT OR PARTS THEREOF,  
MAY NOT BE REPRODUCED IN ANY  
FORM WITHOUT PERMISSION.

| DESIGNED | DRAWN | CHECKED |
|----------|-------|---------|
|          |       |         |

I HEREBY CERTIFY THAT THESE  
PLANS WERE PREPARED BY ME  
OR UNDER  
MY SUPERVISION, AND TO THE  
BEST OF MY KNOWLEDGE,  
COMPLY WITH ALL APPLICABLE  
CODES.

|  |  |  |
|--|--|--|
|  |  |  |
|  |  |  |
|  |  |  |
|  |  |  |
|  |  |  |

| R E V I S I O N S |      |
|-------------------|------|
| COMM.             | DATE |
|                   |      |

TREEHOUSE HOTEL,  
MIAMI BEACH

1500 COLLINS +  
1509-1515 WASHINGTON  
AVE, MIAMI BEACH, FL,  
33139

LANDSCAPE  
CONCEPTS

LC0-03



WASHINGTON AVENUE

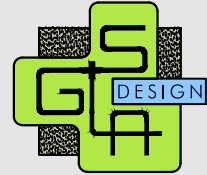
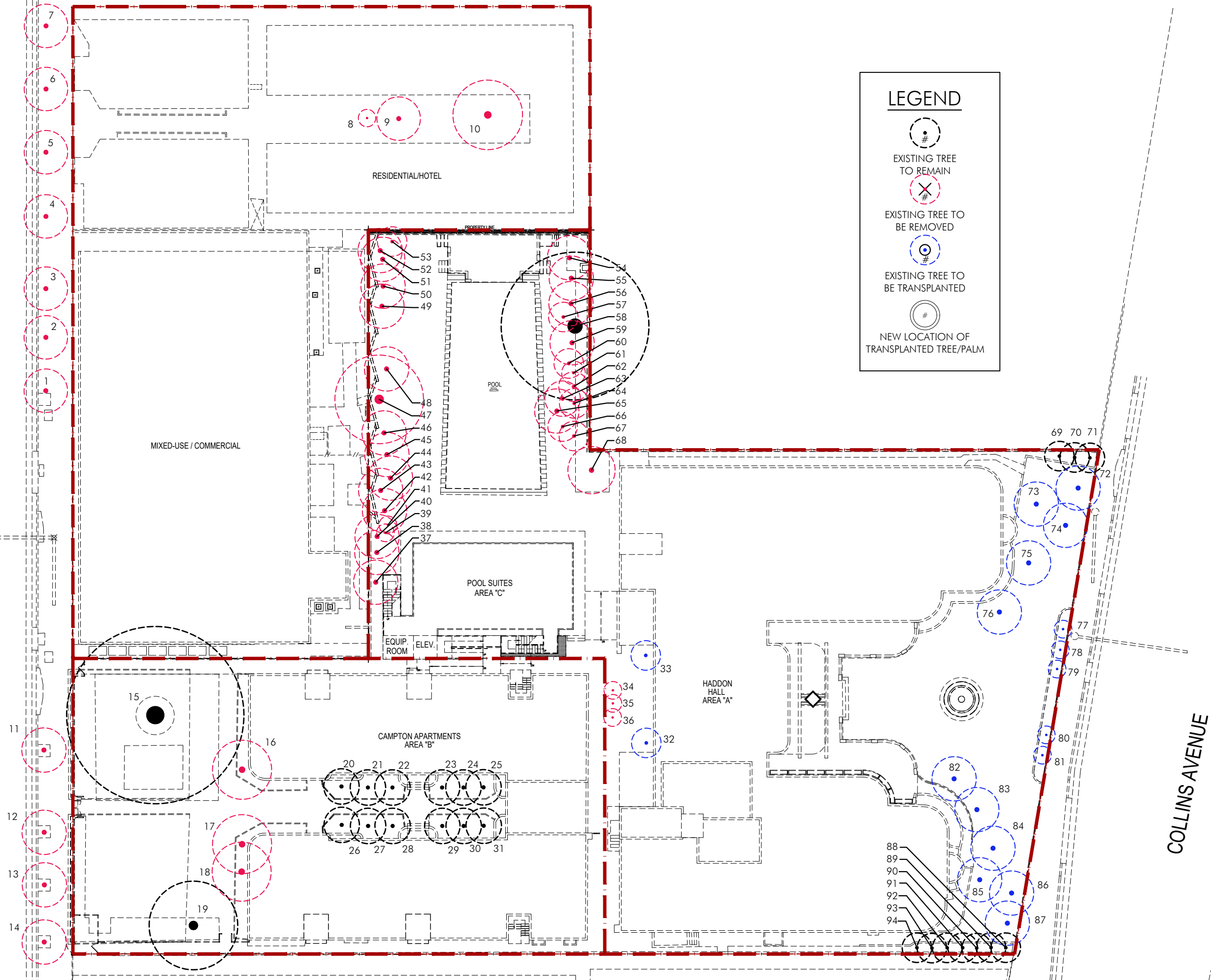

GARDNER + SEMLER  
LANDSCAPE ARCHITECTURE  
WWW.GSLADDESIGN.COM  
17670 NW 78th AVE., SUITE 214  
MIAMI, FL 33155  
P 305.392.1016 F 305.392.1019  
CORP. ID # 0000266

**NR**  
architect

NORBERTO ROSENSTEIN  
ARCHITECT, INC.

ARCHITECTURE - INTERIOR DESIGN - PLANNING  
126 S. FEDERAL HIGHWAY SUITE #202  
DANIA BEACH, FLORIDA 33004  
P: (954) 922-6551  
NROSENSTEIN@ROSENSTEINARCHITECT.COM  
WWW.ROSENSTEINARCHITECT.COM

STATE REG. NO. ARO016674  
NATL. REG. NO. 69178  
COPYRIGHT © 2024  
NORBERTO ROSENSTEIN  
ARCHITECT, INC.  
ALL RIGHTS RESERVED. THIS  
DOCUMENT OR PARTS THEREOF,  
MAY NOT BE REPRODUCED IN ANY  
FORM WITHOUT PERMISSION.

| DESIGNED | DRAWN | CHECKED |
|----------|-------|---------|
| GSLA     | GSLA  | GSLA    |

I HEREBY CERTIFY THAT THESE  
PLANS WERE PREPARED BY ME  
OR UNDER  
MY SUPERVISION, AND TO THE  
BEST OF MY KNOWLEDGE,  
COMPLY WITH ALL APPLICABLE  
CODES.

|  |  |  |
|--|--|--|
|  |  |  |
|  |  |  |
|  |  |  |
|  |  |  |
|  |  |  |

| REVISIONS |          |
|-----------|----------|
| COMM.     | DATE     |
| 2024-30   | 09.27.24 |

**TREEHOUSE HOTEL,  
MIAMI BEACH**

1500 COLLINS +  
1509-1515  
WASHINGTON AVE,  
MIAMI BEACH,  
FL 33139

Existing Tree Disposition  
Plan

L0-01



| EXISTING TREE DISPOSITION LIST |                           |                     |          |           |           |             |           |            |
|--------------------------------|---------------------------|---------------------|----------|-----------|-----------|-------------|-----------|------------|
| KEY                            | BOTANICAL NAME            | COMMON NAME         | SIZE     |           |           | DISPOSITION | CONDITION | MITIGATION |
|                                |                           |                     | HT.(ft.) | SPD.(ft.) | DBH.(in.) |             |           | DBH.(in.)  |
| 1                              | Cocos nucifera            | Coconut Palm        | 30       | 12        | 7         | remove      | fair      | palm       |
| 2                              | Cocos nucifera            | Coconut Palm        | 30       | 12        | 7         | remove      | fair      | palm       |
| 3                              | Cocos nucifera            | Coconut Palm        | 30       | 12        | 7         | remove      | fair      | palm       |
| 4                              | Cocos nucifera            | Coconut Palm        | 30       | 12        | 7         | remove      | fair      | palm       |
| 5                              | Cocos nucifera            | Coconut Palm        | 30       | 12        | 7         | remove      | fair      | palm       |
| 6                              | Cocos nucifera            | Coconut Palm        | 30       | 12        | 7         | remove      | fair      | palm       |
| 7                              | Cocos nucifera            | Coconut Palm        | 30       | 12        | 7         | remove      | fair      | palm       |
| 8                              | Mangifera indica          | Mango               | 13       | 6         | 1         | remove      | poor      |            |
| 9                              | Mangifera indica          | Mango               | 18       | 15        | 3         | remove      | fair      |            |
| 10                             | Aracaria heterophylla     | Norfolk Island Pine | 45       | 25        | 9,9,10    | remove      | fair      | 28         |
| 11                             | Cocos nucifera            | Coconut Palm        | 25       | 12        | 8         | remove      | fair      | palm       |
| 12                             | Cocos nucifera            | Coconut Palm        | 25       | 12        | 8         | remove      | fair      | palm       |
| 13                             | Cocos nucifera            | Coconut Palm        | 25       | 12        | 8         | remove      | fair      | palm       |
| 14                             | Cocos nucifera            | Coconut Palm        | 25       | 12        | 8         | remove      | fair      | palm       |
| 15                             | Ficus aurea               | Strangler Fig       | 45       | 60        | 120       | keep        | good      |            |
| 16                             | Coccoloba uvifera         | Seagrape            | 20       | 20        | 16        | remove      | poor      | 16         |
| 17                             | Coccoloba uvifera         | Seagrape            | 20       | 20        | 24        | remove      | poor      | 24         |
| 18                             | Coccoloba uvifera         | Seagrape            | 20       | 20        | 24        | remove      | poor      | 24         |
| 19                             | Ficus citrifolia          | Shorleaf Fig        | 30       | 40        | 36        | keep        | good      |            |
| 20                             | Dypsis cabadae            | Cabada Palm         | 25       | 15        | multi     | keep        | good      |            |
| 21                             | Dypsis cabadae            | Cabada Palm         | 25       | 15        | multi     | keep        | good      |            |
| 22                             | Dypsis cabadae            | Cabada Palm         | 25       | 15        | multi     | keep        | good      |            |
| 23                             | Dypsis cabadae            | Cabada Palm         | 25       | 15        | multi     | keep        | good      |            |
| 24                             | Dypsis cabadae            | Cabada Palm         | 25       | 15        | multi     | keep        | good      |            |
| 25                             | Dypsis cabadae            | Cabada Palm         | 25       | 15        | multi     | keep        | good      |            |
| 26                             | Dypsis cabadae            | Cabada Palm         | 25       | 15        | multi     | keep        | good      |            |
| 27                             | Dypsis cabadae            | Cabada Palm         | 25       | 15        | multi     | keep        | good      |            |
| 28                             | Dypsis cabadae            | Cabada Palm         | 25       | 15        | multi     | keep        | good      |            |
| 29                             | Dypsis cabadae            | Cabada Palm         | 25       | 15        | multi     | keep        | good      |            |
| 30                             | Dypsis cabadae            | Cabada Palm         | 25       | 15        | multi     | keep        | good      |            |
| 31                             | Dypsis cabadae            | Cabada Palm         | 25       | 15        | multi     | keep        | good      |            |
| 32                             | Thrinax radiata           | Green Thatch Palm   | 16       | 10        | 6         | transplant  | good      |            |
| 33                             | Thrinax radiata           | Green Thatch Palm   | 10       | 10        | 6         | transplant  | good      |            |
| 34                             | Veitchia memilii          | Christmas Palm      | 22       | 6         | 7         | remove      | poor      | palm       |
| 35                             | Veitchia memilii          | Christmas Palm      | 22       | 6         | 7         | remove      | poor      | palm       |
| 36                             | Veitchia memilii          | Christmas Palm      | 22       | 6         | 7         | remove      | poor      | palm       |
| 37                             | Ravenala madagascariensis | Traveller's Palm    | 22       | 15        | multi     | remove      | good      | palm       |
| 38                             | Ravenala madagascariensis | Traveller's Palm    | 22       | 15        | multi     | remove      | good      | palm       |
| 39                             | Ravenala madagascariensis | Traveller's Palm    | 22       | 15        | multi     | remove      | good      | palm       |
| 40                             | Veitchia memilii          | Christmas Palm      | 20       | 6         | 7         | remove      | fair      | palm       |
| 41                             | Veitchia memilii          | Christmas Palm      | 20       | 6         | 7         | remove      | fair      | palm       |
| 42                             | Ravenala madagascariensis | Traveller's Palm    | 22       | 15        | multi     | remove      | good      | palm       |
| 43                             | Ravenala madagascariensis | Traveller's Palm    | 22       | 15        | multi     | remove      | good      | palm       |
| 44                             | Ravenala madagascariensis | Traveller's Palm    | 22       | 15        | multi     | remove      | good      | palm       |
| 45                             | Dypsis lutescens          | Areca Palm          | 18       | 12        | multi     | remove      | fair      | palm       |
| 46                             | Ravenala madagascariensis | Traveller's Palm    | 22       | 15        | multi     | remove      | good      | palm       |
| 47                             | Thespesia palpunea        | Portia Tree         | 20       | 30        | 36        | remove      | poor      | 36         |
| 48                             | Dypsis lutescens          | Areca Palm          | 18       | 12        | multi     | remove      | fair      | palm       |
| 49                             | Dypsis lutescens          | Areca Palm          | 18       | 12        | multi     | remove      | fair      | palm       |
| 50                             | Caryota mitis             | Fishtail Palm       | 22       | 15        | multi     | remove      | good      | palm       |
| 51                             | Caryota mitis             | Fishtail Palm       | 22       | 15        | multi     | remove      | good      | palm       |
| 52                             | Ravenala madagascariensis | Traveller's Palm    | 22       | 15        | multi     | remove      | good      | palm       |
| 53                             | Sabal palmetto            | Sabal Palm          | 18       | 10        | 10        | remove      | good      | palm       |
| 54                             | Caryota mitis             | Fishtail Palm       | 22       | 15        | multi     | remove      | good      | palm       |
| 55                             | Caryota mitis             | Fishtail Palm       | 22       | 15        | multi     | remove      | good      | palm       |
| 56                             | Caryota mitis             | Fishtail Palm       | 22       | 15        | multi     | remove      | good      | palm       |
| 57                             | Sabal palmetto            | Sabal Palm          | 12       | 10        | 10        | remove      | good      | not a tree |
| 58                             | Ficus aurea               | Strangler Fig       | 50       | 50        | 72        | keep        | fair      |            |
| 59                             | Caryota mitis             | Fishtail Palm       | 22       | 15        | multi     | remove      | good      | palm       |
| 60                             | Sabal palmetto            | Sabal Palm          | 16       | 10        | 10        | remove      | good      | palm       |
| 61                             | Accoeloraphe wrightii     | Paurotis Palm       | 16       | 8         | multi     | remove      | poor      | palm       |
| 62                             | Sabal palmetto            | Sabal Palm          | 18       | 10        | 10        | remove      | good      | palm       |
| 63                             | Veitchia memilii          | Christmas Palm      | 20       | 15        | multi     | remove      | good      | palm       |
| 64                             | Caryota mitis             | Fishtail Palm       | 16       | 8         | multi     | remove      | good      | palm       |
| 65                             | Veitchia memilii          | Christmas Palm      | 20       | 12        | multi     | remove      | good      | palm       |
| 66                             | Sabal palmetto            | Sabal Palm          | 18       | 10        | 10        | remove      | good      | palm       |
| 67                             | Sabal palmetto            | Sabal Palm          | 18       | 10        | 10        | remove      | good      | palm       |
| 68                             | Accoeloraphe wrightii     | Paurotis Palm       | 16       | 16        | multi     | remove      | poor      | palm       |
| 69                             | Sabal palmetto            | Sabal Palm          | 20       | 10        | 10        | keep        | good      |            |
| 70                             | Sabal palmetto            | Sabal Palm          | 20       | 10        | 10        | keep        | good      |            |
| 71                             | Sabal palmetto            | Sabal Palm          | 20       | 10        | 10        | keep        | good      |            |
| 72                             | Cocos nucifera            | Coconut Palm        | 26       | 15        | 8         | transplant  | good      |            |
| 73                             | Cocos nucifera            | Coconut Palm        | 26       | 15        | 8         | transplant  | good      |            |
| 74                             | Cocos nucifera            | Coconut Palm        | 26       | 15        | 8         | transplant  | good      |            |
| 75                             | Cocos nucifera            | Coconut Palm        | 26       | 15        | 8         | transplant  | good      |            |

| KEY  | BOTANICAL NAME  | COMMON NAME       | SIZE     |           |           | DISPOSITION | CONDITION | MITIGATION  |
|--|-----------------|-------------------|----------|-----------|-----------|-------------|-----------|---|
|  |                 |                   | HT.(ft.) | SPD.(ft.) | DBH.(in.) |             |           | DBH.(in.)   |
| 76   | Cocos nucifera  | Coconut Palm      | 26       | 15        | 8         | transplant  | good      |   |
| 77   | Thrinax radiata | Green Thatch Palm | 10       | 6         | 4         | transplant  | good      |   |
| 78   | Thrinax radiata | Green Thatch Palm | 10       | 6         | 4         | transplant  | good      |   |
| 79   | Thrinax radiata | Green Thatch Palm | 10       | 6         | 4         | transplant  | good      |   |
| 80   | Thrinax radiata | Green Thatch Palm | 10       | 6         | 4         | transplant  | good      |   |
| 81   | Thrinax radiata | Green Thatch Palm | 10       | 6         | 4         | transplant  | good      |   |
| 82   | Cocos nucifera  | Coconut Palm      | 26       | 15        | 8         | transplant  | good      |   |
| 83   | Cocos nucifera  | Coconut Palm      | 26       | 15        | 8         | transplant  | good      |   |
| 84   | Cocos nucifera  | Coconut Palm      | 26       | 15        | 8         | transplant  | good      |   |
| 85   | Cocos nucifera  | Coconut Palm      | 26       | 15        | 8         | transplant  | good      |   |
| 86   | Cocos nucifera  | Coconut Palm      | 26       | 15        | 8         | transplant  | good      |   |
| 87   | Cocos nucifera  | Coconut Palm      | 26       | 15        | 8         | transplant  | good      |   |
| 88   | Sabal palmetto  | Sabal Palm        | 20       | 10        | 10        | keep        | good      |   |
| 89   | Sabal palmetto  | Sabal Palm        | 20       | 10        | 10        | keep        | good      |   |
| 90   | Sabal palmetto  | Sabal Palm        | 20       | 10        | 10        | keep        | good      |   |
| 91   | Sabal palmetto  | Sabal Palm        | 20       | 10        | 10        | keep        | good      |   |
| 92   | Sabal palmetto  | Sabal Palm        | 20       | 10        | 10        | keep        | good      |   |
| 93   | Sabal palmetto  | Sabal Palm        | 20       | 10        | 10        | keep        | good      |   |
| 94   | Sabal palmetto  | Sabal Palm        | 20       | 10        | 10        | keep        | good      |   |
| TOTAL DBH INCHES TO BE REMOVED             |                 |                   |          |           |           |             |           | 128   |
| TOTAL PALMS TO BE REMOVED                  |                 |                   |          |           |           |             |           | 43  |
| TOTAL TREES MITIGATION REQUIRED            |                 |                   |          |           |           |             |           | 44 trees (from hardwood removal)<br>+ 43 trees (from palm removals)<br>= 87 trees |
| TOTAL TREES MITIGATION PROVIDED            |                 |                   |          |           |           |             |           | xx trees  |
| Mitigation is provided in the form of XXXX |                 |                   |          |           |           |             |           |   |

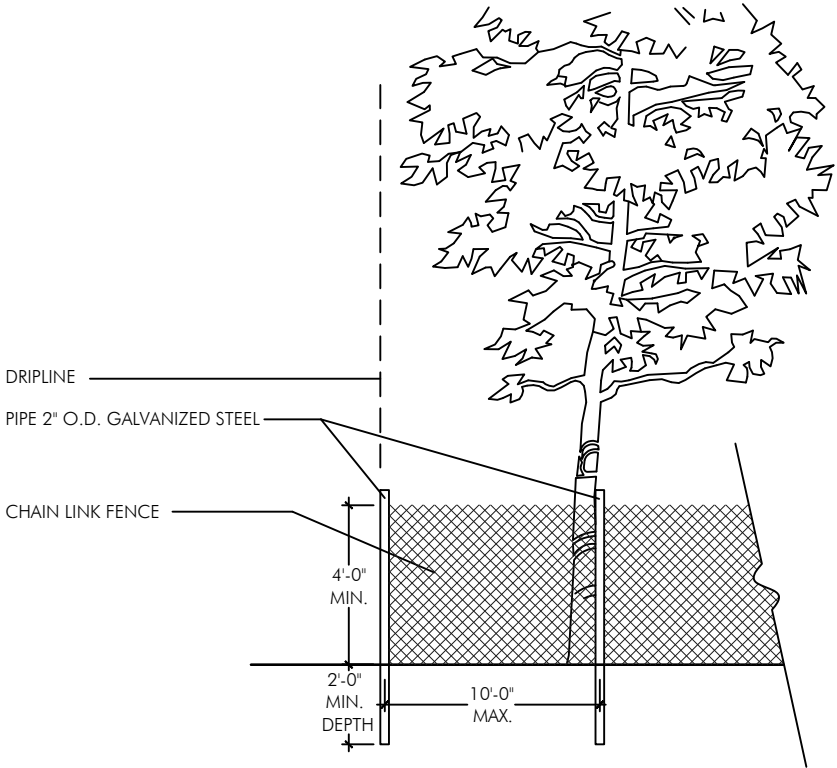

NOTES:  
-BARRIER SHALL BE PLACED AT THE EDGE OF THE DRIPLINE OF THE THE TREE CANOPY OR AS FAR FROM THE TREE AS POSSIBLE WHERE THE CANOPY OVERHANGS PAVEMENT THAT IS TO REMAIN. BARRIER SHALL BE MAINTAINED IN AN UPRIGHT POSITION AT ALL TIMES.  
-TREE PROTECTION FENCE (TPF) SHALL BE INSTALLED PRIOR TO ANY SITE WORK, CLEARING, OR DEMOLITION. AND MAINTAINED THROUGHOUT CONSTRUCTION.  
-REMOVE TPF ONLY WITH APPROVAL FROM URBAN FORESTER AFTER ALL SITE WORK HAS BEEN COMPLETED.

\*NOTE: Should any existing trees or palms be damaged they shall be evaluated by the City Urban Forester to determine corrective actions that may include removal, corrective pruning and or replacement. Any corrective actions required shall be performed in accordance with the City of Miami Beach Code, the most current ANSI A-300 Pruning Standards and or an issued City Tree or Environmental Permit. Any corrective pruning required shall be performed by an ISA Certified Arborist and the City Urban Forester shall be consulted.

## TREE PROTECTION DETAIL

N.T.S.



GARDNER + SEMLER  
LANDSCAPE ARCHITECTURE  
WWW.GS&ADESIGN.COM  
17670 NW 78th AVE., SUITE 214  
MIAMI, FL 33015  
P 305.392.1016 F 305.392.1019  
CORP. 10#0000266

NR  
architect

NORBERTO ROSENSTEIN  
ARCHITECT, INC.

ARCHITECTURE - INTERIOR DESIGN - PLANNING  
126 S. FEDERAL HIGHWAY SUITE #202  
DANIA BEACH, FLORIDA 33004  
P: (954) 922-6551  
NROSENSTEIN@ROSENSTEINARCHITECT.COM  
WWW.ROSENSTEINARCHITECT.COM

STATE REG. NO. ARO016674  
NATL. REG. NO. 69178  
COPYRIGHT © 2024  
NORBERTO ROSENSTEIN  
ARCHITECT, INC.  
ALL RIGHTS RESERVED. THIS  
DOCUMENT OR PARTS THEREOF,  
MAY NOT BE REPRODUCED IN ANY  
FORM WITHOUT PERMISSION.

|          |       |         |
|----------|-------|---------|
| DESIGNED | DRAWN | CHECKED |
| GS&A     | GS&A  | GS&A    |

I HEREBY CERTIFY THAT THESE  
PLANS WERE PREPARED BY ME  
OR UNDER  
MY SUPERVISION, AND TO THE  
BEST OF MY KNOWLEDGE,  
COMPLY WITH ALL APPLICABLE  
CODES.

|  |  |  |
|--|--|--|
|  |  |  |
|  |  |  |
|  |  |  |
|  |  |  |
|  |  |  |

### REVISIONS

|         |          |
|---------|----------|
| COMM.   | DATE     |
| 2024-30 | 09.27.24 |

TREEHOUSE HOTEL,  
MIAMI BEACH

1509 COLLINS +  
1509-1515  
WASHINGTON AVE,  
MIAMI BEACH,  
FL 33139

Existing Tree Disposition  
List

L0-02



WASHINGTON AVENUE

ADDAPAVE  
OPENINGS  
MIAMI BEACH  
RED CONCRETE  
SIDEWALK

ADDAPAVE  
OPENINGS  
MIAMI BEACH  
RED CONCRETE  
SIDEWALK

KEYSTONE  
PAVERS  
WOOD DECK  
KEYSTONE  
PAVERS  
WOOD DECK  
ADDAPAVE  
OPENINGS  
MIAMI BEACH  
RED CONCRETE  
SIDEWALK  
KEYSTONE  
PAVERS

KEYSTONE  
PAVERS  
PORYPHERY  
PAVERS

KEYSTONE  
PAVERS  
WATER FEATURE  
PORYPHERY  
PAVERS

KEYSTONE  
PAVERS  
PORYPHERY  
PAVERS

KEYSTONE  
PAVERS  
MIAMI BEACH  
RED CONCRETE  
SIDEWALK  
MIAMI BEACH  
RED CONCRETE  
SIDEWALK

COLLINS AVENUE



GARDNER + SEMLER  
LANDSCAPE ARCHITECTURE  
WWW.GSLADDESIGN.COM  
17670 NW 78th AVE., SUITE 214  
MIAMI, FL 33015  
P 305.392.1016 F 305.392.1019  
CORP. ID # 0000266

NR  
architect

NORBERTO ROSENSTEIN  
ARCHITECT, INC.

ARCHITECTURE - INTERIOR DESIGN - PLANNING  
126 S. FEDERAL HIGHWAY SUITE #202  
DANIA BEACH, FLORIDA 33004  
P: (954) 922-6551  
NROSENSTEIN@ROSENSTEINARCHITECT.COM  
WWW.ROSENSTEINARCHITECT.COM

STATE REG. NO. ARO016674  
NATL. REG. NO. 69178  
COPYRIGHT © 2024  
NORBERTO ROSENSTEIN  
ARCHITECT, INC.  
ALL RIGHTS RESERVED. THIS  
DOCUMENT OR PARTS THEREOF,  
MAY NOT BE REPRODUCED IN ANY  
FORM WITHOUT PERMISSION.

| DESIGNED | DRAWN | CHECKED |
|----------|-------|---------|
| GSLA     | GSLA  | GSLA    |

I HEREBY CERTIFY THAT THESE  
PLANS WERE PREPARED BY ME  
OR UNDER  
MY SUPERVISION, AND TO THE  
BEST OF MY KNOWLEDGE,  
COMPLY WITH ALL APPLICABLE  
CODES.

|  |  |  |
|--|--|--|
|  |  |  |
|  |  |  |
|  |  |  |
|  |  |  |
|  |  |  |

REVISIONS

| COMM.   | DATE     |
|---------|----------|
| 2024-30 | 09.27.24 |

TREEHOUSE HOTEL,  
MIAMI BEACH

1509 COLLINS +  
1509-1515  
WASHINGTON AVE,  
MIAMI BEACH,  
FL 33139

Hardscape Layout Plan -  
Level 01





NORBERTO ROSENSTEIN  
ARCHITECT, INC.

ARCHITECTURE - INTERIOR DESIGN - PLANNING

126 S. FEDERAL HIGHWAY SUITE #202

DANIA BEACH, FLORIDA 33004  
P: (954) 922-6551

NROSENSTEIN®ROSENSTEINARCHITECT  
WWW.ROSENSTEINARCHITECT.COM

---

STATE REG. NO. AROO16674

NATL. REG. NO. 69178  
COPYRIGHT © 2024

NORBERTO ROSENSTEIN

ARCHITECT, INC.  
ALL RIGHTS RESERVED. THIS

ALL RIGHTS RESERVED. THIS  
DOCUMENT OR PARTS THEREOF

MAY NOT BE REPRODUCED IN ANY FORM WITHOUT PERMISSION

FORM WITHOUT PERMISSION.

|          |       |         |
|----------|-------|---------|
| DESIGNED | DRAWN | CHECKED |
|----------|-------|---------|

|  |  |  |
|--|--|--|
|  |  |  |
|  |  |  |

| GSLA | GSLA | GSLA |
|------|------|------|
|------|------|------|

I HEREBY CERTIFY THAT THESE PLANS WERE PREPARED BY ME OR UNDER MY SUPERVISION, AND TO THE BEST OF MY KNOWLEDGE, COMPLY WITH ALL APPLICABLE CODES.

|  |  |  |
|--|--|--|
|  |  |  |
|  |  |  |
|  |  |  |
|  |  |  |
|  |  |  |
|  |  |  |

## REVISIONS

|         |          |
|---------|----------|
| COMM.   | DATE     |
| 2024-30 | 09.27.24 |

**TREEHOUSE HOTEL,  
MIAMI BEACH**

1500 COLLINS +  
1509-1515  
WASHINGTON AVE,  
MIAMI BEACH,  
FL 33139

## Hardscape Layout Plan Level 02

L1-02

THERE WILL BE HARDCAPE  
ON THIS SHEET





THERE WILL BE HARDSCAPE  
ON THIS SHEET



NORBERTO ROSENSTEIN  
ARCHITECT, INC.

ARCHITECTURE - INTERIOR DESIGN - PLANNING  
126 S. FEDERAL HIGHWAY SUITE #202  
DANIA BEACH, FLORIDA 33004  
P: (954) 922-6551  
NROSENSTEIN@ROSENSTEINARCHITECT.COM  
WWW.ROSENSTEINARCHITECT.COM

STATE REG. NO. AROO16674  
NATL. REG. NO. 69178  
COPYRIGHT © 2024  
NORBERTO ROSENSTEIN  
ARCHITECT, INC.  
ALL RIGHTS RESERVED. THIS  
DOCUMENT OR PARTS THEREOF,  
MAY NOT BE REPRODUCED IN ANY  
FORM WITHOUT PERMISSION.

| DESIGNED | DRAWN | CHECKED |
|----------|-------|---------|
| GS LA    | GS LA | GS LA   |

I HEREBY CERTIFY THAT THESE  
PLANS WERE PREPARED BY ME  
OR UNDER  
MY SUPERVISION, AND TO THE  
BEST OF MY KNOWLEDGE,  
COMPLY WITH ALL APPLICABLE  
CODES.

|  |  |  |
|--|--|--|
|  |  |  |
|  |  |  |
|  |  |  |
|  |  |  |
|  |  |  |

| REVISIONS |          |
|-----------|----------|
| COMM.     | DATE     |
| 2024-30   | 09.27.24 |

TREEHOUSE HOTEL,  
MIAMI BEACH

1500 COLLINS +  
1509-1515  
WASHINGTON AVE,  
MIAMI BEACH,  
FL 33139

Hardscape Layout Plan -  
Level 03





THERE WILL BE HARDSCAPE  
ON THIS SHEET

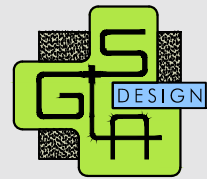

GARDNER + SEMLER  
LANDSCAPE ARCHITECTURE  
WWW.GSLADESIGN.COM  
17670 NW 78th AVE., SUITE 214  
MIAMI, FL 33015  
P: 305.392.1016 F: 305.392.1019  
CORP. ID # 0000266



NORBERTO ROSENSTEIN  
ARCHITECT, INC.

ARCHITECTURE - INTERIOR DESIGN - PLANNING

126 S. FEDERAL HIGHWAY SUITE #202

DANIA BEACH, FLORIDA 33004

P: (954) 922-8551

NROSENSTEIN@ROSENSTEINARCHITECT.COM

WWW.ROSENSTEINARCHITECT.COM

STATE REG. NO. AROO16674

NATL. REG. NO. 69178

COPYRIGHT © 2024

NORBERTO ROSENSTEIN

ARCHITECT, INC.

ALL RIGHTS RESERVED. THIS

DOCUMENT OR PARTS THEREOF,

MAY NOT BE REPRODUCED IN ANY

FORM WITHOUT PERMISSION.

| DESIGNED | DRAWN | CHECKED |
|----------|-------|---------|
| GSLA     | GSLA  | GSLA    |

I HEREBY CERTIFY THAT THESE  
PLANS WERE PREPARED BY ME  
OR UNDER  
MY SUPERVISION, AND TO THE  
BEST OF MY KNOWLEDGE,  
COMPLY WITH ALL APPLICABLE  
CODES.

|  |  |  |
|--|--|--|
|  |  |  |
|  |  |  |
|  |  |  |
|  |  |  |
|  |  |  |

REVISIONS

| COMM.   | DATE     |
|---------|----------|
| 2024-30 | 09.27.24 |

TREEHOUSE HOTEL,  
MIAMI BEACH

1500 COLLINS +  
1509-1515  
WASHINGTON AVE,  
MIAMI BEACH,  
FL 33139

Hardscape Layout Plan -  
Level 04

L1-04





GARDNER + SEMLER  
LANDSCAPE ARCHITECTURE  
WWW.GSLADESIGN.COM  
17670 NW 78th AVE., SUITE 214  
MIAMI, FL 33015  
P 305.392.1016 F 305.392.1019  
CORP. ID # 0000266



NORBERTO ROSENSTEIN  
ARCHITECT, INC.

ARCHITECTURE - INTERIOR DESIGN - PLANNING  
126 S. FEDERAL HIGHWAY SUITE #202  
DANIA BEACH, FLORIDA 33004  
P: (954) 922-6551  
NROSENSTEIN@ROSENSTEINARCHITECT.COM  
WWW.ROSENSTEINARCHITECT.COM

STATE REG. NO. ARO016674  
NATL. REG. NO. 69178  
COPYRIGHT © 2024  
NORBERTO ROSENSTEIN  
ARCHITECT, INC.  
ALL RIGHTS RESERVED. THIS  
DOCUMENT OR PARTS THEREOF,  
MAY NOT BE REPRODUCED IN ANY  
FORM WITHOUT PERMISSION.

| DESIGNED | DRAWN | CHECKED |
|----------|-------|---------|
| GSLA     | GSLA  | GSLA    |

I HEREBY CERTIFY THAT THESE  
PLANS WERE PREPARED BY ME  
OR UNDER  
MY SUPERVISION, AND TO THE  
BEST OF MY KNOWLEDGE,  
COMPLY WITH ALL APPLICABLE  
CODES.

|  |  |  |
|--|--|--|
|  |  |  |
|  |  |  |
|  |  |  |
|  |  |  |
|  |  |  |

| REVISIONS |          |
|-----------|----------|
| COMM.     | DATE     |
| 2024-30   | 09.27.24 |

TREEHOUSE HOTEL,  
MIAMI BEACH

1500 COLLINS +  
1509-1515  
WASHINGTON AVE,  
MIAMI BEACH,  
FL 33139

Hardscape Layout Plan -  
Level 05





GARDNER + SEMLER  
LANDSCAPE ARCHITECTURE  
WWW.GSLADESIGN.COM  
17670 NW 78th AVE., SUITE 214  
MIAMI, FL 33015  
P 305.392.1016 F 305.392.1019  
CORP. ID # 0000266



NORBERTO ROSENSTEIN  
ARCHITECT, INC.

ARCHITECTURE - INTERIOR DESIGN - PLANNING  
126 S. FEDERAL HIGHWAY SUITE #202  
DANIA BEACH, FLORIDA 33004  
P: (954) 922-8551  
NROSENSTEIN@ROSENSTEINARCHITECT.COM  
WWW.ROSENSTEINARCHITECT.COM

STATE REG. NO. AROO16674  
NATL. REG. NO. 69178  
COPYRIGHT © 2024  
NORBERTO ROSENSTEIN  
ARCHITECT, INC.  
ALL RIGHTS RESERVED. THIS  
DOCUMENT OR PARTS THEREOF,  
MAY NOT BE REPRODUCED IN ANY  
FORM WITHOUT PERMISSION.

|          |       |         |
|----------|-------|---------|
| DESIGNED | DRAWN | CHECKED |
| GSLA     | GSLA  | GSLA    |

I HEREBY CERTIFY THAT THESE  
PLANS WERE PREPARED BY ME  
OR UNDER  
MY SUPERVISION, AND TO THE  
BEST OF MY KNOWLEDGE,  
COMPLY WITH ALL APPLICABLE  
CODES.

|  |  |  |
|--|--|--|
|  |  |  |
|  |  |  |
|  |  |  |
|  |  |  |
|  |  |  |

| REVISIONS |          |
|-----------|----------|
| COMM.     | DATE     |
| 2024-30   | 09.27.24 |

TREEHOUSE HOTEL,  
MIAMI BEACH

1500 COLLINS +  
1509-1515  
WASHINGTON AVE,  
MIAMI BEACH,  
FL 33139

Hardscape Layout Plan -  
Level 06



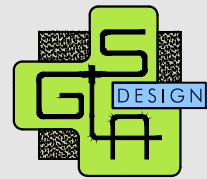
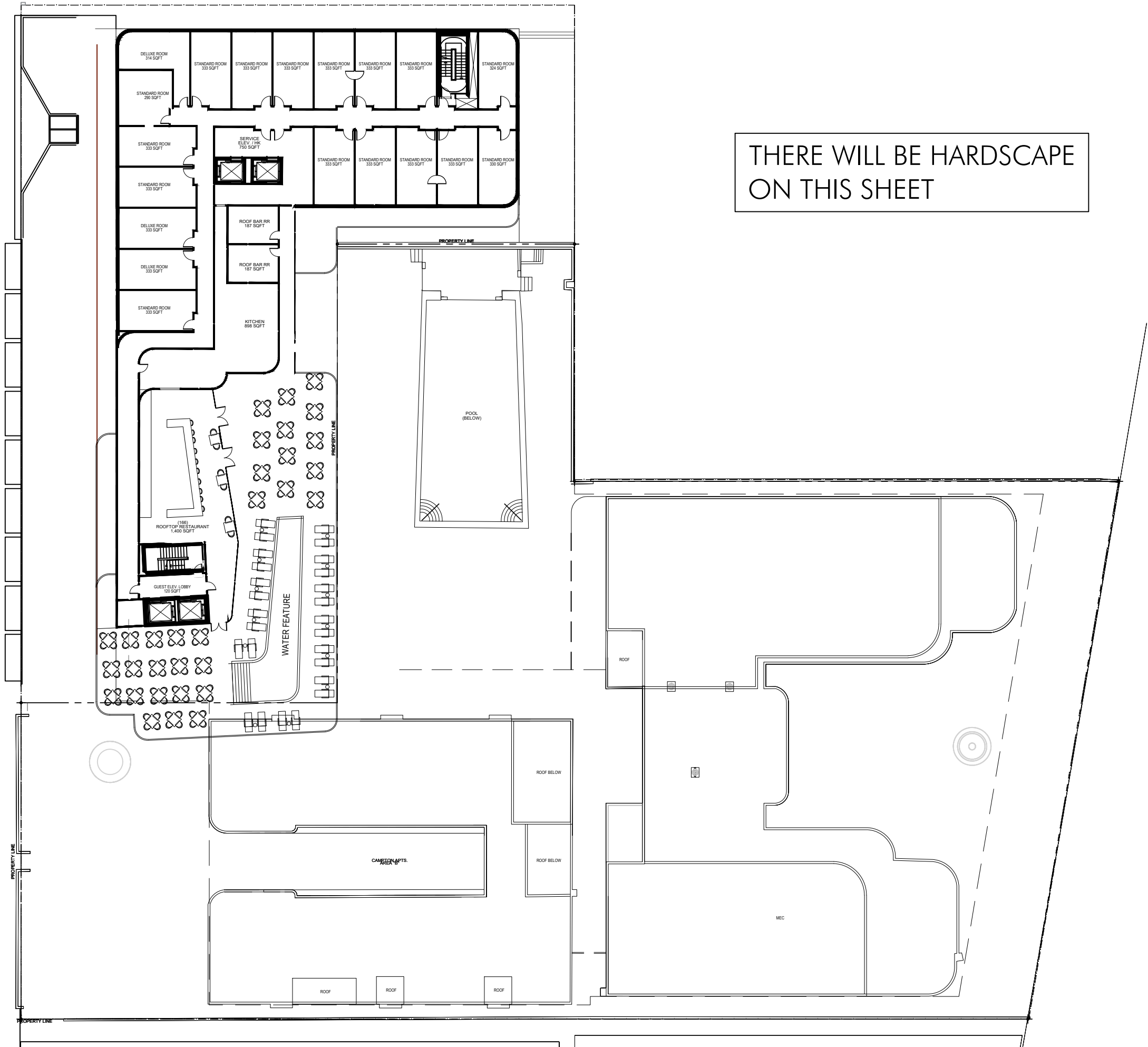

GARDNER + SEMLER  
LANDSCAPE ARCHITECTURE  
WWW.GSLADESIGN.COM  
17670 NW 78th AVE., SUITE 214  
MIAMI, FL 33015  
P: 305.392.1016 F: 305.392.1019  
CORP. ID # 0000266



NORBERTO ROSENSTEIN  
ARCHITECT, INC.

ARCHITECTURE - INTERIOR DESIGN - PLANNING

126 S. FEDERAL HIGHWAY SUITE #202

DANIA BEACH, FLORIDA 33004

P: (954) 922-8551

NROSENSTEIN@ROSENSTEINARCHITECT.COM

WWW.ROSENSTEINARCHITECT.COM

STATE REG. NO. ARO016674

NATL. REG. NO. 69178

COPYRIGHT © 2024

NORBERTO ROSENSTEIN

ARCHITECT, INC.

ALL RIGHTS RESERVED. THIS

DOCUMENT OR PARTS THEREOF,

MAY NOT BE REPRODUCED IN ANY

FORM WITHOUT PERMISSION.

| DESIGNED | DRAWN | CHECKED |
|----------|-------|---------|
| GSLA     | GSLA  | GSLA    |

I HEREBY CERTIFY THAT THESE  
PLANS WERE PREPARED BY ME  
OR UNDER  
MY SUPERVISION, AND TO THE  
BEST OF MY KNOWLEDGE,  
COMPLY WITH ALL APPLICABLE  
CODES.

|  |  |  |
|--|--|--|
|  |  |  |
|  |  |  |
|  |  |  |
|  |  |  |
|  |  |  |

REVISIONS

| COMM.   | DATE     |
|---------|----------|
| 2024-30 | 09.27.24 |

TREEHOUSE HOTEL,  
MIAMI BEACH

1500 COLLINS +  
1509-1515  
WASHINGTON AVE,  
MIAMI BEACH,  
FL 33139

Hardscape Layout Plan -  
Level 07

L1-07





KEYSTONE PAVERS



WOOD DECK



MIAMI BEACH RED SIDEWALK



ADDAPAVE



PORYPHERY PAVERS



PORYPHERY PAVERS



GARDNER + SEMLER  
LANDSCAPE ARCHITECTURE  
WWW.GSLADesign.COM  
17670 NW 78th AVE., SUITE 214  
MIAMI, FL 33015  
P 305.392.1016 F 305.392.1019  
CORP. ID # 0000266



NORBERTO ROSENSTEIN  
ARCHITECT, INC.

ARCHITECTURE - INTERIOR DESIGN - PLANNING  
126 S. FEDERAL HIGHWAY SUITE #202  
DANIA BEACH, FLORIDA 33004  
P: (954) 922-6551  
NROSENSTEIN@ROSENSTEINARCHITECT.COM  
WWW.ROSENSTEINARCHITECT.COM

STATE REG. NO. AROO16674  
NATL. REG. NO. 69178  
COPYRIGHT © 2024  
NORBERTO ROSENSTEIN  
ARCHITECT, INC.  
ALL RIGHTS RESERVED. THIS  
DOCUMENT OR PARTS THEREOF,  
MAY NOT BE REPRODUCED IN ANY  
FORM WITHOUT PERMISSION.

| DESIGNED | DRAWN | CHECKED |
|----------|-------|---------|
| GSLA     | GSLA  | GSLA    |

I HEREBY CERTIFY THAT THESE  
PLANS WERE PREPARED BY ME  
OR UNDER  
MY SUPERVISION, AND TO THE  
BEST OF MY KNOWLEDGE,  
COMPLY WITH ALL APPLICABLE  
CODES.

|  |  |  |
|--|--|--|
|  |  |  |
|  |  |  |
|  |  |  |
|  |  |  |
|  |  |  |

| REVISIONS |          |
|-----------|----------|
| COMM.     | DATE     |
| 2024-30   | 09.27.24 |

TREEHOUSE HOTEL,  
MIAMI BEACH

1500 COLLINS +  
1509-1515  
WASHINGTON AVE,  
MIAMI BEACH,  
FL 33139

Proposed Hardscape  
Materials



WASHINGTON AVENUE

COLLINS AVENUE

SHADE TREES IN  
ADDAPAVE  
OPENINGS

SHADE TREES IN  
ADDAPAVE  
OPENINGS

EXISTING FICUS  
TO REMAIN  
SHRUBS  
SHADE TREES IN  
ADDAPAVE  
OPENINGS

NARROW TREES  
SHRUBS  
SHADE TREES IN  
ADDAPAVE  
OPENINGS

PALMS  
SHRUBS

LEANING PALMS  
SHRUBS  
LEANING PALMS

EXISTING PALMS  
SHRUBS  
EXIST. FICUS TO  
REMAIN

LEANING PALMS  
SHRUBS  
EXIST. FICUS TO  
REMAIN

EXIST. PALMS  
TO REMAIN  
SMALL TREES  
MEDIUM TREES  
SHRUBS

MEDIUM TREE  
LEANING PALMS  
SHRUBS  
LEANING PALMS

SHRUBS  
MEDIUM TREE  
ACCENT PALMS

SHRUBS  
MEDIUM TREE  
SMALL TREE

SMALL TREES  
MEDIUM TREES  
SHRUBS  
EXIST. PALMS  
TO REMAIN  
SHADE TREE IN  
ADDAPAVE  
OPENINGS

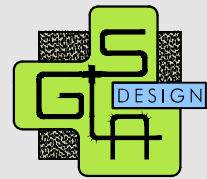

GARDNER + SEMLER  
LANDSCAPE ARCHITECTURE  
WWW.GSLADesign.COM  
17670 NW 78th AVE., SUITE 214  
MIAMI, FL 33015  
P 305.392.1016 F 305.392.1019  
CORP. ID # 0000266

NR  
architect

NORBERTO ROSENSTEIN  
ARCHITECT, INC.

ARCHITECTURE - INTERIOR DESIGN - PLANNING  
126 S. FEDERAL HIGHWAY SUITE #202  
DANIA BEACH, FLORIDA 33004  
P: (954) 922-6551  
NROSENSTEIN@ROSENSTEINARCHITECT.COM  
WWW.ROSENSTEINARCHITECT.COM

STATE REG. NO. ARO016674  
NATL. REG. NO. 69178  
COPYRIGHT © 2024  
NORBERTO ROSENSTEIN  
ARCHITECT, INC.  
ALL RIGHTS RESERVED. THIS  
DOCUMENT OR PARTS THEREOF,  
MAY NOT BE REPRODUCED IN ANY  
FORM WITHOUT PERMISSION.

| DESIGNED | DRAWN | CHECKED |
|----------|-------|---------|
| GSLA     | GSLA  | GSLA    |

I HEREBY CERTIFY THAT THESE  
PLANS WERE PREPARED BY ME  
OR UNDER  
MY SUPERVISION, AND TO THE  
BEST OF MY KNOWLEDGE,  
COMPLY WITH ALL APPLICABLE  
CODES.

|  |  |  |
|--|--|--|
|  |  |  |
|  |  |  |
|  |  |  |
|  |  |  |
|  |  |  |
|  |  |  |

| REVISIONS |          |
|-----------|----------|
| COMM.     | DATE     |
| 2024-30   | 09.27.24 |

TREEHOUSE HOTEL,  
MIAMI BEACH

1509 COLLINS +  
1509-1515  
WASHINGTON AVE,  
MIAMI BEACH,  
FL 33139

Conceptual Planting Plan -  
Level 01

L2-01



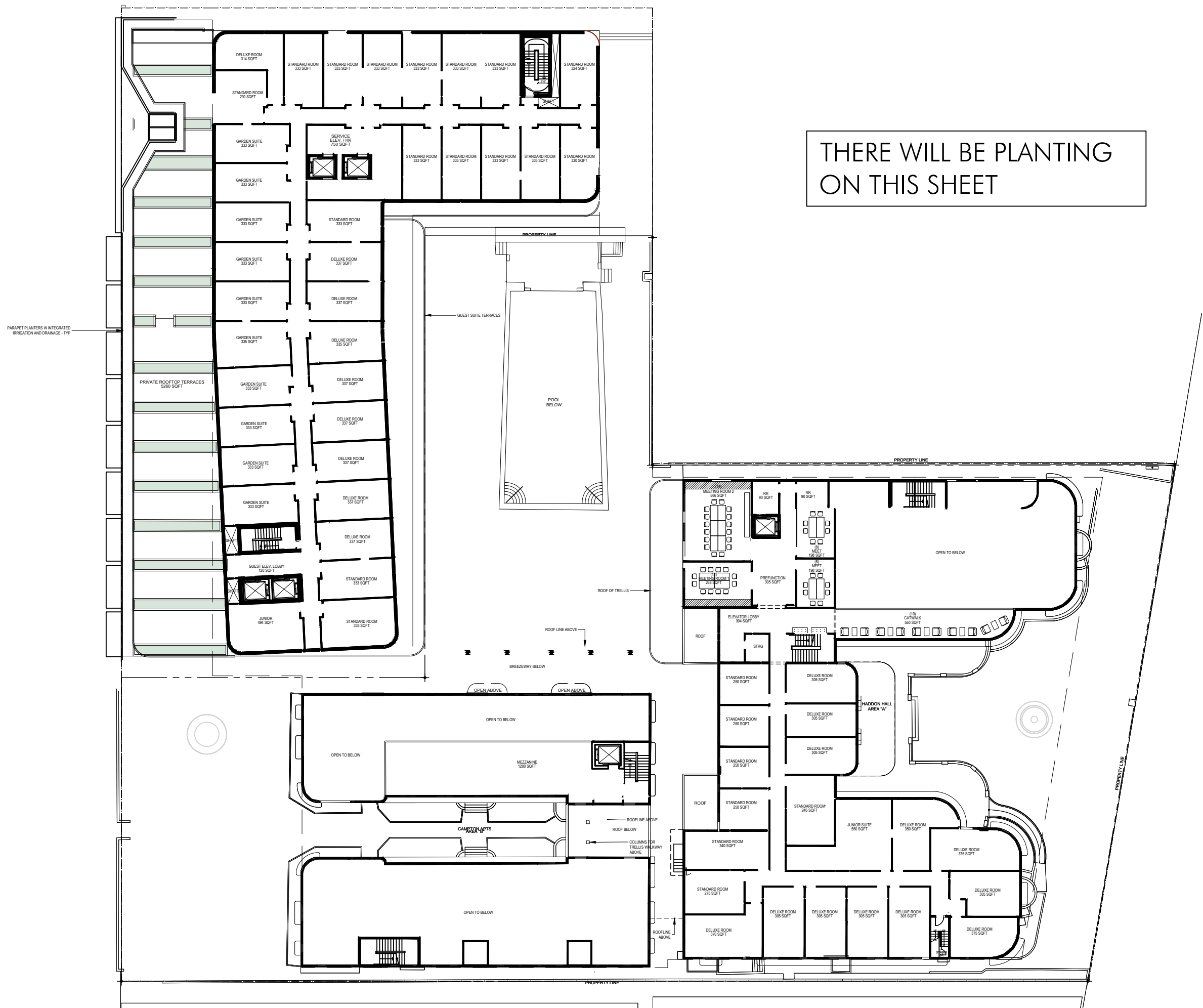

THERE WILL BE PLANTING  
ON THIS SHEET



GARDNER + SEMLER  
LANDSCAPE ARCHITECTURE  
WWW.GSDESIGN.COM  
17670 NW 78th AVE., SUITE 214  
MIAMI, FL 33015  
P 305.392.1016 F 305.392.1019  
CORP. ID # 0000266



NORBERTO ROSENSTEIN  
ARCHITECT, INC.

ARCHITECTURE - INTERIOR DESIGN - PLANNING

126 S. FEDERAL HIGHWAY SUITE #202  
DANIA BEACH, FLORIDA 33004  
P: (954) 922-6551  
NROSENSTEIN@ROSENSTEINARCHITECT.COM  
WWW.ROSENSTEINARCHITECT.COM

STATE REG. NO. AR0016674  
NATL. REG. NO. 69178  
COPYRIGHT © 2024  
NORBERTO ROSENSTEIN  
ARCHITECT, INC.  
ALL RIGHTS RESERVED. THIS  
DOCUMENT OR PARTS THEREOF,  
MAY NOT BE REPRODUCED IN ANY  
FORM WITHOUT PERMISSION.

| DESIGNED | DRAWN | CHECKED |
|----------|-------|---------|
| GSLA     | GSLA  | GSLA    |

I HEREBY CERTIFY THAT THESE  
PLANS WERE PREPARED BY ME  
OR UNDER  
MY SUPERVISION, AND TO THE  
BEST OF MY KNOWLEDGE,  
COMPLY WITH ALL APPLICABLE  
CODES.

|  |  |  |
|--|--|--|
|  |  |  |
|  |  |  |
|  |  |  |
|  |  |  |
|  |  |  |

| REVISIONS |          |
|-----------|----------|
| COMM.     | DATE     |
| 2024-30   | 09.27.24 |

TREEHOUSE HOTEL,  
MIAMI BEACH

1500 COLLINS +  
1509-1515  
WASHINGTON AVE,  
MIAMI BEACH,  
FL 33139

Conceptual Planting Plan -  
Level 02

L2-02

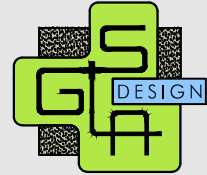

GARDNER + SEMLER  
LANDSCAPE ARCHITECTURE  
WWW.GSLADESIGN.COM  
17670 NW 78th AVE., SUITE 214  
MIAMI, FL 33015  
P 305.392.1016 F 305.392.1019  
CORP. ID # 0000266



NORBERTO ROSENSTEIN  
ARCHITECT, INC.

ARCHITECTURE - INTERIOR DESIGN - PLANNING

126 S. FEDERAL HIGHWAY SUITE #202  
DANIA BEACH, FLORIDA 33004  
P: (954) 922-6551  
NROSENSTEIN@ROSENSTEINARCHITECT.COM  
WWW.ROSENSTEINARCHITECT.COM

STATE REG. NO. AROO16674  
NATL. REG. NO. 69178  
COPYRIGHT © 2024  
NORBERTO ROSENSTEIN  
ARCHITECT, INC.  
ALL RIGHTS RESERVED. THIS  
DOCUMENT OR PARTS THEREOF,  
MAY NOT BE REPRODUCED IN ANY  
FORM WITHOUT PERMISSION.

| DESIGNED | DRAWN | CHECKED |
|----------|-------|---------|
| GSLA     | GSLA  | GSLA    |

I HEREBY CERTIFY THAT THESE  
PLANS WERE PREPARED BY ME  
OR UNDER  
MY SUPERVISION, AND TO THE  
BEST OF MY KNOWLEDGE,  
COMPLY WITH ALL APPLICABLE  
CODES.

|  |  |  |
|--|--|--|
|  |  |  |
|  |  |  |
|  |  |  |
|  |  |  |
|  |  |  |

| REVISIONS |          |
|-----------|----------|
| COMM.     | DATE     |
| 2024-30   | 09.27.24 |

TREEHOUSE HOTEL,  
MIAMI BEACH

1500 COLLINS +  
1509-1515  
WASHINGTON AVE,  
MIAMI BEACH,  
FL 33139

Conceptual Planting Plan -  
Level 03

L1-03



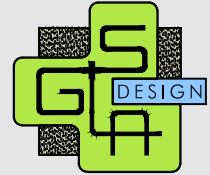

GARDNER + SEMLER  
LANDSCAPE ARCHITECTURE  
WWW.GSLADESIGN.COM  
17670 NW 78th AVE., SUITE 214  
MIAMI, FL 33015  
P 305.392.1016 F 305.392.1019  
CORP. ID # 0000266



NORBERTO ROSENSTEIN  
ARCHITECT, INC.

ARCHITECTURE - INTERIOR DESIGN - PLANNING

126 S. FEDERAL HIGHWAY SUITE #202  
DANIA BEACH, FLORIDA 33004  
P: (954) 922-6551  
NROSENSTEIN@ROSENSTEINARCHITECT.COM  
WWW.ROSENSTEINARCHITECT.COM

STATE REG. NO. ARO016674  
NATL. REG. NO. 69178  
COPYRIGHT © 2024  
NORBERTO ROSENSTEIN  
ARCHITECT, INC.  
ALL RIGHTS RESERVED. THIS  
DOCUMENT OR PARTS THEREOF,  
MAY NOT BE REPRODUCED IN ANY  
FORM WITHOUT PERMISSION.

| DESIGNED | DRAWN | CHECKED |
|----------|-------|---------|
| GSLA     | GSLA  | GSLA    |

I HEREBY CERTIFY THAT THESE  
PLANS WERE PREPARED BY ME  
OR UNDER  
MY SUPERVISION, AND TO THE  
BEST OF MY KNOWLEDGE,  
COMPLY WITH ALL APPLICABLE  
CODES.

|  |  |  |
|--|--|--|
|  |  |  |
|  |  |  |
|  |  |  |
|  |  |  |
|  |  |  |

| REVISIONS |          |
|-----------|----------|
| COMM.     | DATE     |
| 2024-30   | 09.27.24 |

TREEHOUSE HOTEL,  
MIAMI BEACH

1500 COLLINS +  
1509-1515  
WASHINGTON AVE,  
MIAMI BEACH,  
FL 33139

Conceptual Planting Plan -  
Level 04

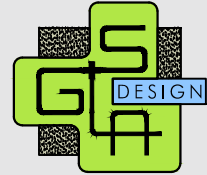

GARDNER + SEMLER  
LANDSCAPE ARCHITECTURE  
WWW.GSLADESIGN.COM  
17670 NW 78th AVE., SUITE 214  
MIAMI, FL 33015  
P 305.392.1016 F 305.392.1019  
CORP. ID # 0000266



NORBERTO ROSENSTEIN  
ARCHITECT, INC.

ARCHITECTURE - INTERIOR DESIGN - PLANNING

126 S. FEDERAL HIGHWAY SUITE #202  
DANIA BEACH, FLORIDA 33004  
P: (954) 922-6551  
NROSENSTEIN@ROSENSTEINARCHITECT.COM  
WWW.ROSENSTEINARCHITECT.COM

STATE REG. NO. ARO016674  
NATL. REG. NO. 69178  
COPYRIGHT © 2024  
NORBERTO ROSENSTEIN  
ARCHITECT, INC.  
ALL RIGHTS RESERVED. THIS  
DOCUMENT OR PARTS THEREOF,  
MAY NOT BE REPRODUCED IN ANY  
FORM WITHOUT PERMISSION.

| DESIGNED | DRAWN | CHECKED |
|----------|-------|---------|
| GSLA     | GSLA  | GSLA    |

I HEREBY CERTIFY THAT THESE  
PLANS WERE PREPARED BY ME  
OR UNDER  
MY SUPERVISION, AND TO THE  
BEST OF MY KNOWLEDGE,  
COMPLY WITH ALL APPLICABLE  
CODES.

|  |  |  |
|--|--|--|
|  |  |  |
|  |  |  |
|  |  |  |
|  |  |  |
|  |  |  |

| REVISIONS |          |
|-----------|----------|
| COMM.     | DATE     |
| 2024-30   | 09.27.24 |

TREEHOUSE HOTEL,  
MIAMI BEACH

1500 COLLINS +  
1509-1515  
WASHINGTON AVE,  
MIAMI BEACH,  
FL 33139

Conceptual Planting Plan -  
Level 05

L2-05



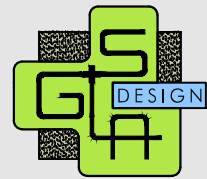

GARDNER + SEMLER  
LANDSCAPE ARCHITECTURE  
WWW.GSLADESIGN.COM  
17670 NW 78th AVE., SUITE 214  
MIAMI, FL 33015  
P 305.392.1016 F 305.392.1019  
CORP. ID # 0000266



NORBERTO ROSENSTEIN  
ARCHITECT, INC.

ARCHITECTURE - INTERIOR DESIGN - PLANNING

126 S. FEDERAL HIGHWAY SUITE #202  
DANIA BEACH, FLORIDA 33004  
P: (954) 922-8551  
NROSENSTEIN@ROSENSTEINARCHITECT.COM  
WWW.ROSENSTEINARCHITECT.COM

STATE REG. NO. AROO16674  
NATL. REG. NO. 69178  
COPYRIGHT © 2024  
NORBERTO ROSENSTEIN  
ARCHITECT, INC.  
ALL RIGHTS RESERVED. THIS  
DOCUMENT OR PARTS THEREOF,  
MAY NOT BE REPRODUCED IN ANY  
FORM WITHOUT PERMISSION.

| DESIGNED | DRAWN | CHECKED |
|----------|-------|---------|
| GSLA     | GSLA  | GSLA    |

I HEREBY CERTIFY THAT THESE  
PLANS WERE PREPARED BY ME  
OR UNDER  
MY SUPERVISION, AND TO THE  
BEST OF MY KNOWLEDGE,  
COMPLY WITH ALL APPLICABLE  
CODES.

|  |  |  |
|--|--|--|
|  |  |  |
|  |  |  |
|  |  |  |
|  |  |  |
|  |  |  |

| REVISIONS |          |
|-----------|----------|
| COMM.     | DATE     |
| 2024-30   | 09.27.24 |

TREEHOUSE HOTEL,  
MIAMI BEACH

1500 COLLINS +  
1509-1515  
WASHINGTON AVE,  
MIAMI BEACH,  
FL 33139

Conceptual Planting Plan -  
Level 06

L2-06

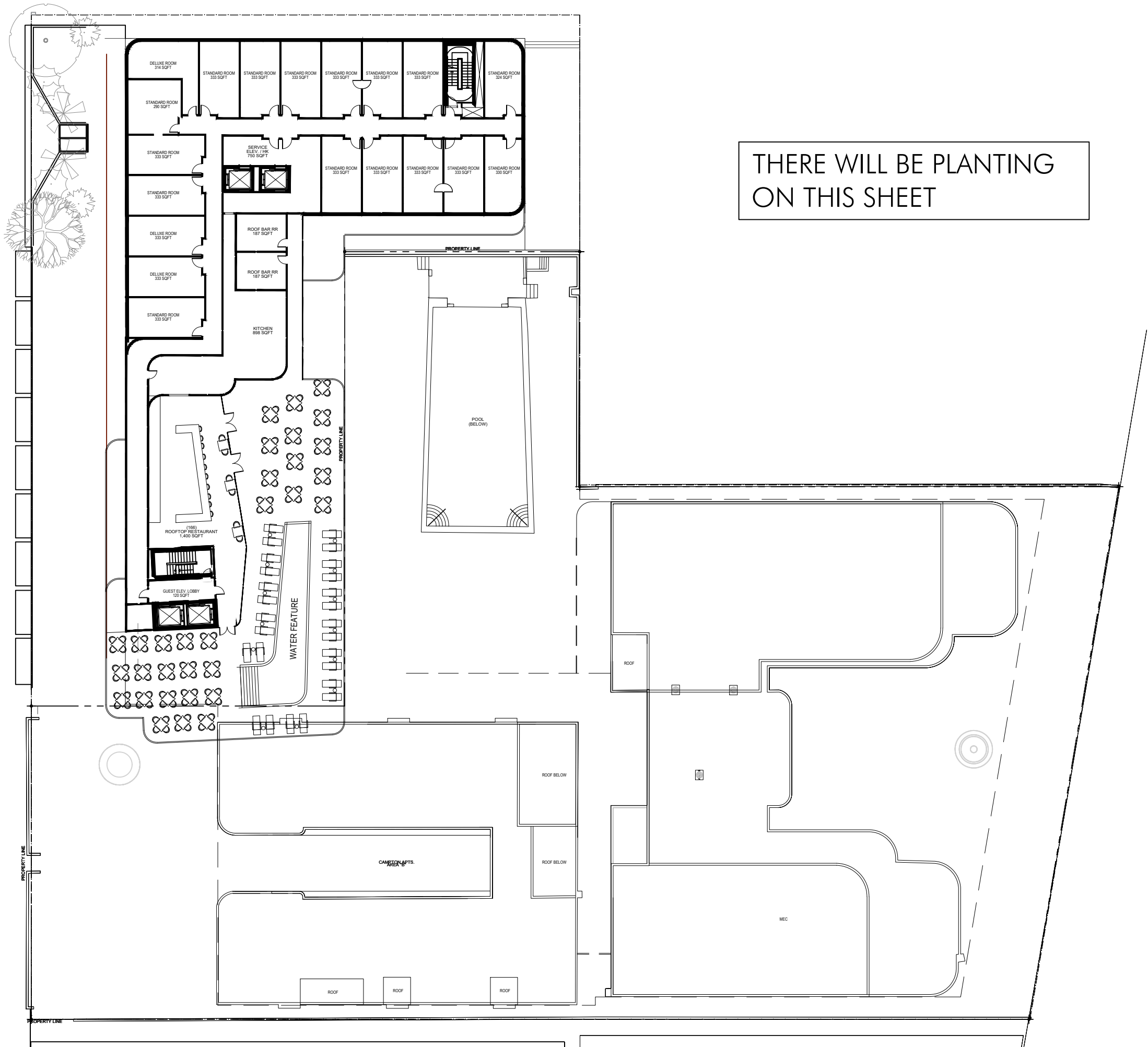

GARDNER + SEMLER  
LANDSCAPE ARCHITECTURE  
WWW.GSLADDESIGN.COM  
17670 NW 78th AVE., SUITE 214  
MIAMI, FL 33015  
P 305.392.1016 F 305.392.1019  
CORP. ID # 0000266



NORBERTO ROSENSTEIN  
ARCHITECT, INC.

ARCHITECTURE - INTERIOR DESIGN - PLANNING

126 S. FEDERAL HIGHWAY SUITE #202

DANIA BEACH, FLORIDA 33004

P: (954) 922-8551

NROSENSTEIN@ROSENSTEINARCHITECT.COM

WWW.ROSENSTEINARCHITECT.COM

STATE REG. NO. ARO016674

NATL. REG. NO. 69178

COPYRIGHT © 2024

NORBERTO ROSENSTEIN

ARCHITECT, INC.

ALL RIGHTS RESERVED. THIS

DOCUMENT OR PARTS THEREOF,

MAY NOT BE REPRODUCED IN ANY

FORM WITHOUT PERMISSION.

| DESIGNED | DRAWN | CHECKED |
|----------|-------|---------|
| GSLA     | GSLA  | GSLA    |

I HEREBY CERTIFY THAT THESE  
PLANS WERE PREPARED BY ME  
OR UNDER  
MY SUPERVISION, AND TO THE  
BEST OF MY KNOWLEDGE,  
COMPLY WITH ALL APPLICABLE  
CODES.

|  |  |  |
|--|--|--|
|  |  |  |
|  |  |  |
|  |  |  |
|  |  |  |
|  |  |  |

REVISIONS

| COMM.   | DATE     |
|---------|----------|
| 2024-30 | 09.27.24 |

TREEHOUSE HOTEL,  
MIAMI BEACH

1500 COLLINS +  
1509-1515  
WASHINGTON AVE,  
MIAMI BEACH,  
FL 33139

Conceptual Planting Plan -  
Level 07

L2-07





ACACIA FARNESIANA



BURSERA SIMAROUBA



CHORISIA SPECIOSA



COCOLOBA DIVERSIFOLIA



CHORIOPHYLLA  
OLIVIFORME



CONOCARPUS ERECTUS



CONOCARPUS ERECTUS "SERICEUS"



LAGERSTROEMIA INDICA



PIMENTA RACEMOSA



QUERCUS VIRGINIANA



TABEBUIA CARAIBEA

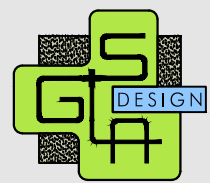

GARDNER + SEMLER  
LANDSCAPE ARCHITECTURE  
WWW.GSLADESIGN.COM  
17670 NW 78th AVE., SUITE 214  
MIAMI, FL 33015  
P 305.392.1016 F 305.392.1019  
CORP. ID # 0000266



NORBERTO ROSENSTEIN  
ARCHITECT, INC.

ARCHITECTURE - INTERIOR DESIGN - PLANNING  
126 S. FEDERAL HIGHWAY SUITE #202  
DANIA BEACH, FLORIDA 33004  
P: (954) 922-6551  
NROSENSTEIN@ROSENSTEINARCHITECT.COM  
WWW.ROSENSTEINARCHITECT.COM

STATE REG. NO. ARO016674  
NATL. REG. NO. 69178  
COPYRIGHT © 2024  
NORBERTO ROSENSTEIN  
ARCHITECT, INC.  
ALL RIGHTS RESERVED. THIS  
DOCUMENT OR PARTS THEREOF,  
MAY NOT BE REPRODUCED IN ANY  
FORM WITHOUT PERMISSION.

| DESIGNED | DRAWN | CHECKED |
|----------|-------|---------|
| GSLA     | GSLA  | GSLA    |

I HEREBY CERTIFY THAT THESE  
PLANS WERE PREPARED BY ME  
OR UNDER  
MY SUPERVISION, AND TO THE  
BEST OF MY KNOWLEDGE,  
COMPLY WITH ALL APPLICABLE  
CODES.

|  |  |  |
|--|--|--|
|  |  |  |
|  |  |  |
|  |  |  |
|  |  |  |

| REVISIONS |          |
|-----------|----------|
| COMM.     | DATE     |
| 2024-30   | 09.27.24 |

TREEHOUSE HOTEL,  
MIAMI BEACH

1500 COLLINS +  
1509-1515  
WASHINGTON AVE,  
MIAMI BEACH,  
FL 33139

Proposed Plant Species -  
Trees





BAMBUSA LAKO



BAMBUSA VENTRICOSA



RAVENALA MADAGASCARIENSIS



STRELTZIA NICHOLAI



ACOELLORHAPHIS WRIGHTII



ATTALEA SPECIOSA



BISMARKIA NOBILIS



CARYOTA MITIS



CHAMBEYRONEA  
MACROCARPA



COCCOTHRINAX BORHIDRIANA



COCCOTHRINAX RADIATA



CHRYSTOSTACHIS RENDA



DICTYOSPERMUM ALBA



SABAL PALMETTO



VEITCHIA MONTGOMERIANA



GARDNER + SEMLER  
LANDSCAPE ARCHITECTURE  
WWW.GSLADESIGN.COM  
17670 NW 78th AVE., SUITE 214  
MIAMI, FL 33015  
P 305.392.1016 F 305.392.1019  
CORP. ID # 0000266



NORBERTO ROSENSTEIN  
ARCHITECT, INC.

ARCHITECTURE - INTERIOR DESIGN - PLANNING  
126 S. FEDERAL HIGHWAY SUITE #202  
DANIA BEACH, FLORIDA 33004  
P: (954) 922-6551  
NROSENSTEIN@ROSENSTEINARCHITECT.COM  
WWW.ROSENSTEINARCHITECT.COM

STATE REG. NO. ARO016674  
NATL. REG. NO. 69178  
COPYRIGHT © 2024  
NORBERTO ROSENSTEIN  
ARCHITECT, INC.  
ALL RIGHTS RESERVED. THIS  
DOCUMENT OR PARTS THEREOF,  
MAY NOT BE REPRODUCED IN ANY  
FORM WITHOUT PERMISSION.

| DESIGNED | DRAWN | CHECKED |
|----------|-------|---------|
| GSLA     | GSLA  | GSLA    |

I HEREBY CERTIFY THAT THESE  
PLANS WERE PREPARED BY ME  
OR UNDER  
MY SUPERVISION, AND TO THE  
BEST OF MY KNOWLEDGE,  
COMPLY WITH ALL APPLICABLE  
CODES.

|  |  |  |
|--|--|--|
|  |  |  |
|  |  |  |
|  |  |  |
|  |  |  |
|  |  |  |

REVISIONS

| COMM.   | DATE     |
|---------|----------|
| 2024-30 | 09.27.24 |

TREEHOUSE HOTEL,  
MIAMI BEACH

1500 COLLINS +  
1509-1515  
WASHINGTON AVE,  
MIAMI BEACH,  
FL 33139

Proposed Plant Species -  
Miscellaneous & Palms





ACALYPHA WILKESIANA

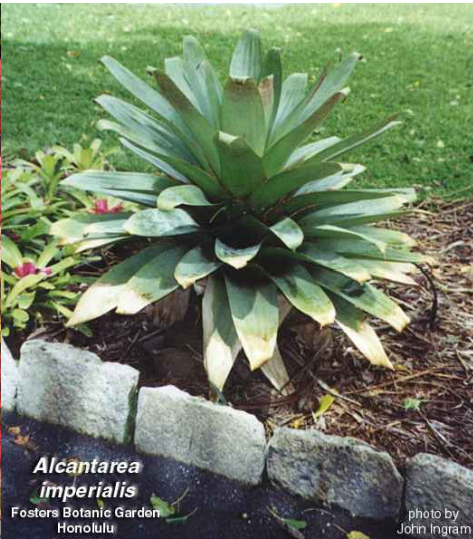

ALCANTAREA IMPERIALIS



ANTHERIUM SPP.



BREYNIA DISTICHA



CALLICARPA AMERICANA



BRUNFELSIA GRANDIFLORA



CALATHEA ROSEO-PICTA



CHRYSOBALANUS ICACO



CLUSIA GUTTIFERA



CORDYLINE FRUTICOSA



CYPERUS PAPYRUS



DIOON SPINULOSUM



DRACAENA MARGINATA



FICUS MICROCARPA "GREEN ISLAND"



GARDNER + SEMLER  
LANDSCAPE ARCHITECTURE  
WWW.GSADDESIGN.COM  
17670 NW 78th AVE., SUITE 214  
MIAMI, FL 33015  
P 305.392.1016 F 305.392.1019  
CORP. ID # 0000266



NORBERTO ROSENSTEIN  
ARCHITECT, INC.

ARCHITECTURE - INTERIOR DESIGN - PLANNING  
126 S. FEDERAL HIGHWAY SUITE #202  
DANIA BEACH, FLORIDA 33004  
P: (954) 922-6551  
NROSENSTEIN@ROSENSTEINARCHITECT.COM  
WWW.ROSENSTEINARCHITECT.COM

STATE REG. NO. ARO016674  
NATL. REG. NO. 69178  
COPYRIGHT © 2024  
NORBERTO ROSENSTEIN  
ARCHITECT, INC.  
ALL RIGHTS RESERVED. THIS  
DOCUMENT OR PARTS THEREOF,  
MAY NOT BE REPRODUCED IN ANY  
FORM WITHOUT PERMISSION.

| DESIGNED | DRAWN | CHECKED |
|----------|-------|---------|
| GSLA     | GSLA  | GSLA    |

I HEREBY CERTIFY THAT THESE  
PLANS WERE PREPARED BY ME  
OR UNDER  
MY SUPERVISION, AND TO THE  
BEST OF MY KNOWLEDGE,  
COMPLY WITH ALL APPLICABLE  
CODES.

|  |  |  |
|--|--|--|
|  |  |  |
|  |  |  |
|  |  |  |
|  |  |  |
|  |  |  |

| REVISIONS |          |
|-----------|----------|
| COMM.     | DATE     |
| 2024-30   | 09.27.24 |

TREEHOUSE HOTEL,  
MIAMI BEACH

1500 COLLINS +  
1509-1515  
WASHINGTON AVE,  
MIAMI BEACH,  
FL 33139

Proposed Plant Species -  
Shrubs & Groundcover





GARDENIA SPP.



HAMELIA CUPREA



LICUALA SPINOSA



ZAMIA PUMILA



NEOREGELIA "FIREBALL"



NEPHROLEPIS EXALTATA "BOSTONIENSIS"



PEPPEROMIA OBTUSIFOLIA



PHILODENDRON BURLE MARXII



PHILODENDRON PRINCE OF ORANGE



PODOCARPUS MACROPHYLLUS



PSYCHOTRIA NERVOSA



SANCHESIA TRIFASCIATA



LOROPETALUM CHINENSIS



GARDNER + SEMLER  
LANDSCAPE ARCHITECTURE  
WWW.GSLADDESIGN.COM  
17670 NW 78th AVE., SUITE 214  
MIAMI, FL 33015  
P 305.392.1016 F 305.392.1019  
CORP. ID # 0000266



NORBERTO ROSENSTEIN  
ARCHITECT, INC.

ARCHITECTURE - INTERIOR DESIGN - PLANNING  
126 S. FEDERAL HIGHWAY SUITE #202  
DANIA BEACH, FLORIDA 33004  
P: (954) 922-6551  
NROSENSTEIN@ROSENSTEINARCHITECT.COM  
WWW.ROSENSTEINARCHITECT.COM

STATE REG. NO. ARO016674  
NATL. REG. NO. 69178  
COPYRIGHT © 2024  
NORBERTO ROSENSTEIN  
ARCHITECT, INC.  
ALL RIGHTS RESERVED. THIS  
DOCUMENT OR PARTS THEREOF,  
MAY NOT BE REPRODUCED IN ANY  
FORM WITHOUT PERMISSION.

| DESIGNED | DRAWN | CHECKED |
|----------|-------|---------|
| GSLA     | GSLA  | GSLA    |

I HEREBY CERTIFY THAT THESE  
PLANS WERE PREPARED BY ME  
OR UNDER  
MY SUPERVISION, AND TO THE  
BEST OF MY KNOWLEDGE,  
COMPLY WITH ALL APPLICABLE  
CODES.

|  |  |  |
|--|--|--|
|  |  |  |
|  |  |  |
|  |  |  |
|  |  |  |

| REVISIONS |          |
|-----------|----------|
| COMM.     | DATE     |
| 2024-30   | 09.27.24 |

TREEHOUSE HOTEL,  
MIAMI BEACH

1500 COLLINS +  
1509-1515  
WASHINGTON AVE,  
MIAMI BEACH,  
FL 33139

Proposed Plant Species -  
Shrubs & Groundcover



|  |                      |          |  |  |
|--|----------------------|----------|--|--|
| CITY OF MIAMI BEACH  |                      |          |  |  |
| LANDSCAPE LEGEND   |                      |          |  |  |
| INFORMATION REQUIRED TO BE PERMANENTLY AFFIXED TO PLANS  |                      |          |  |  |
| Zoning District <b>CD-2</b> Lot Area <b>1.04</b> Acres <b>45,727</b>   |                      |          |  |  |
|  | REQUIRED/<br>ALLOWED | PROVIDED |  |  |
| <b>OPEN SPACE</b>  |                      |          |  |  |
| A. Square feet of required Open Space as indicated on site plan:<br>Lot Area = <b>45,727</b> s.f.x N/A % = N/A s.f.  | N/A                  | N/A      |  |  |
| B. Square feet of parking lot open space required as indicated on site   |                      |          |  |  |
| Number of parking spaces 0 x 10 s.f. parking space =   | 0                    | 0        |  |  |
| C. Total square feet of landscaped open space required: A+B=   | N/A                  | N/A      |  |  |
|  |                      |          |  |  |
| <b>LAWN AREA CALCULATION</b>   |                      |          |  |  |
| A. Square feet of landscaped open space required   |                      |          |  |  |
| B. Maximum lawn area (sod) permitted= 20% x xx s.f.  | N/A                  | N/A      |  |  |
|  |                      |          |  |  |
| <b>TREES</b>   |                      |          |  |  |
| A. Number of trees required per lot or net lot acre, less existing<br>number of trees meeting minimum requirements = <b>22</b> trees / acre<br>(22 x 1.04 acres = 23 trees | 23                   | 23       |  |  |
| B. % Natives required: Number of trees provided x 30% =  | 7                    | 7        |  |  |
| C. % Low maintenance / drought and salt tolerant required:<br>Number of trees provided x 50%=  | 12                   | 12       |  |  |
| D. Street Trees (maximum average spacing of 20' o.c.)<br><b>320</b> linear feet along street divided by 20'=   | 16                   | 16       |  |  |
| E. Street tree species allowed directly beneath power lines:<br>(maximum average spacing of 20' o.c.): 0 linear feet along street<br>divided by 20'=                       | N/A                  | N/A      |  |  |
|  |                      |          |  |  |
| <b>SHRUBS</b>  |                      |          |  |  |
| A. Number of shrubs required: Sum of lot and street trees required x   | 468                  | 468      |  |  |
| B. % Native shrubs required: Number of shrubs provided x 50%=  | 234                  | 365      |  |  |
|  |                      |          |  |  |
| <b>LARGE SHRUBS OR SMALL TREES</b>   |                      |          |  |  |
| A. Number of large shrubs or small trees required: Number of required<br>shrubs x 10%=   | 47                   | 47       |  |  |
| B. % Native large shrubs or small trees required: Number of large<br>shrubs or small trees provided x 50%=   | 24                   | 24       |  |  |

|  |                      |   |  |  |
|--|----------------------|---|--|--|
| CITY OF MIAMI BEACH  |                      |   |  |  |
| LANDSCAPE LEGEND   |                      |   |  |  |
| INFORMATION REQUIRED TO BE PERMANENTLY AFFIXED TO PLANS  |                      |   |  |  |
| Zoning District <b>MXE</b> Lot Area <b>0.85</b> Acres <b>37,330</b>  |                      |   |  |  |
|  | REQUIRED/<br>ALLOWED | PROVIDED  |  |  |
| <b>OPEN SPACE</b>  |                      |   |  |  |
| Square feet of required Open Space as indicated on site plan:<br>Lot Area = <b>37,330</b> s.f.x N/A % = N/A s.f.   | N/A                  | N/A   |  |  |
| Square feet of parking lot open space required as indicated on site  |                      |   |  |  |
| Number of parking spaces 0 x 10 s.f. parking space =   | 0                    | 0   |  |  |
| Total square feet of landscaped open space required: A+B=  | N/A                  | N/A   |  |  |
|  |                      |   |  |  |
| <b>LAWN AREA CALCULATION</b>   |                      |   |  |  |
| Square feet of landscaped open space required  |                      |   |  |  |
| Maximum lawn area (sod) permitted= 20% x N.A s.f.  | N/A                  | N/A   |  |  |
|  |                      |   |  |  |
| <b>TREES</b>   |                      |   |  |  |
| Number of trees required per lot or net lot acre, less existing<br>number of trees meeting minimum requirements = <b>22</b> trees / acre<br>(22 x <b>0.85</b> acres = 19 trees | 19                   | 19  |  |  |
| % Natives required: Number of trees provided x 30% =   | 6                    | 6   |  |  |
| % Low maintenance / drought and salt tolerant required:<br>Number of trees provided x 50%=   | 10                   | 10  |  |  |
| Street Trees (maximum average spacing of 20' o.c.)<br><b>172</b> linear feet along street divided by 20'=  | 9                    | 1<br>(insufficient room to add more due to utilities) |  |  |
| Street tree species allowed directly beneath power lines:<br>(maximum average spacing of 20' o.c.): 0 linear feet along street<br>divided by 20'=                              | N/A                  | N/A   |  |  |
|  |                      |   |  |  |
| <b>SHRUBS</b>  |                      |   |  |  |
| Number of shrubs required: Sum of lot and street trees required x  | 336                  | 336   |  |  |
| % Native shrubs required: Number of shrubs provided x 50%=   | 168                  | 168   |  |  |
|  |                      |   |  |  |
| <b>LARGE SHRUBS OR SMALL TREES</b>   |                      |   |  |  |
| Number of large shrubs or small trees required: Number of required<br>shrubs x 10%=  | 34                   | 34  |  |  |
| % Native large shrubs or small trees required: Number of large<br>shrubs or small trees provided x 50%=  | 17                   | 17  |  |  |



GARDNER + SEMLER  
LANDSCAPE ARCHITECTURE  
WWW.GSLADESIGN.COM  
17670 NW 78th AVE., SUITE 214  
MIAMI, FL 33015  
P 305.392.1016 F 305.392.1019  
CORP. ID # 0000266



NORBERTO ROSENSTEIN  
ARCHITECT, INC.

ARCHITECTURE - INTERIOR DESIGN - PLANNING  
126 S. FEDERAL HIGHWAY SUITE #202  
DANIA BEACH, FLORIDA 33004  
P: (954) 922-6551  
NROSENSTEIN@ROSENSTEINARCHITECT.COM  
WWW.ROSENSTEINARCHITECT.COM

STATE REG. NO. ARO016674  
NATL. REG. NO. 69178  
COPYRIGHT © 2024  
NORBERTO ROSENSTEIN  
ARCHITECT, INC.  
ALL RIGHTS RESERVED. THIS  
DOCUMENT OR PARTS THEREOF,  
MAY NOT BE REPRODUCED IN ANY  
FORM WITHOUT PERMISSION.

|          |       |         |
|----------|-------|---------|
| DESIGNED | DRAWN | CHECKED |
| GSLA     | GSLA  | GSLA    |

I HEREBY CERTIFY THAT THESE  
PLANS WERE PREPARED BY ME  
OR UNDER  
MY SUPERVISION, AND TO THE  
BEST OF MY KNOWLEDGE,  
COMPLY WITH ALL APPLICABLE  
CODES.

|  |  |  |
|--|--|--|
|  |  |  |
|  |  |  |
|  |  |  |
|  |  |  |
|  |  |  |

|           |          |
|-----------|----------|
| REVISIONS |          |
| COMM.     | DATE     |
| 2024-30   | 09.27.24 |

TREEHOUSE HOTEL,  
MIAMI BEACH

1509 COLLINS +  
1509-1515  
WASHINGTON AVE,  
MIAMI BEACH,  
FL 33139

Landscape Legend

LANDSCAPE SPECIFICATIONS  
PART 1 - GENERAL

1.1 SCOPE

A. Contractor shall provide all labor, materials, equipment, supervision, and related work necessary to complete the landscape work in accordance with the intent of the landscape plans, schedules and these specifications. The extent of work is shown on the drawings which are a part of this document.

1.2 CONTRACTOR QUALIFICATIONS

A. Landscape installation work to be performed by a Contractor Certified by the Florida Nurserymen, Growers and Landscape Association (FNGLA) as a Certified Landscape Contractor. Any pruning to be supervised by an Arborist, certified by the International Society of Arboriculture (ISA) and licensed in County where work is performed.

1.3 INVESTIGATION OF UTILITIES

A. Prior to beginning work, the Contractor shall be responsible to locate existing underground utilities. Check with all utility companies and Sunshine State, call (811).

1.4 SUBSTITUTIONS

A. Only materials specified will be accepted, unless approved in writing by the Landscape Architect in advance.

1.5 PLANT SIZES

A. All plant sizes shall equal or exceed the minimum sizes as specified in the plant list. If plant sizes of local codes and ordinances require larger plant material than specified on plans, then they shall supercede the sizes on the plan. When plant sizes are specified as a range of size, installed materials shall average the mean of the range specified. Plants shall be measured following pruning, with branches in normal position. All necessary pruning shall be done at the time of planting.

1.6 PLANT QUALITY

A. All plant material shall be equal to or better than Florida No. 1 as classified by “Grades and Standards for Nursery Plants” by the Division of Plant Industry, Florida Department of Agriculture. They shall have a growth habit that is normal for the species; healthy, vigorous, free from insects, disease and injury.

B. The Owner or Landscape Architect reserves the right to refuse any plant material which does not conform to the intent of the written specifications or design.

C. CIRCLING ROOTS FOUND ON CONTAINER-GROWN MATERIAL WILL NOT BE ACCEPTED UNLESS REMEDIAL ROOT PRUNING, APPROVED BY THE LANDSCAPE ARCHITECT IS DONE BEFORE PLANTING.

1.7 PLANT QUANTITY

A. The plant quantities shown on the plant list are to be used only as an aid to bidders. In the case of discrepancy between the plant list and the plan, the quantity on the plan shall override the plant list.

1.8 UNIT PRICES

A. The successful bidder shall furnish to the Owner and the Landscape Architect, a unit price breakdown for all materials. The Owner may, at his discretion, add to or delete from the materials utilizing the unit price breakdown submitted to and accepted by the Owner.

1.9 SUBMITTALS

A. Fertilizer: The Contractor shall submit to the Owner and Landscape Architect documentation that all the fertilizer used for the project is of the analysis specified and placed at the rates specified in section 2.2 FERTILIZER.

B. Planting soil: The Contractor shall submit a sample of the planting soil (approximately 1 cu. ft.) for approval by the Landscape Architect prior to delivery to the site.

1.10 CLEAN-UP & MAINTENANCE OF TRAFFIC

A. Follow procedures in FDOT Index 600 for maintenance of traffic during construction.

B. At the end of each work day, the Contractor shall remove debris and shall barricade the un-filled holes in a manner appropriate in the path of pedestrians and motorists.

C. Upon completion of the work or any major portion of the work or as directed by the Landscape Architect, all debris and surplus material from his work shall be removed from the job site.

1.11 MAINTENANCE PRIOR TO ACCEPTANCE

A. The Contractor is responsible to maintain the plantings until they are accepted under the provisions of 1.12 “ACCEPTANCE OF INSTALLATION”.

1. Plants: Begin maintenance immediately following the final plant installation operation for each plant and continue until all plant installation is complete and accepted. Maintenance shall include watering all plants, weeding, mulching, pest and disease control, tightening and repairing of guys, repair of braces, removal of dead growth, resetting of plants to proper grade or up-right position, restoration of plant saucer, litter pick-up in plant beds and other necessary operations to assure specified minimum grade of Florida No. 1.

2. Turf Areas: Begin maintenance of turf immediately following the placement of sod and continue until sod installation is complete and accepted. Maintenance shall include but not be limited to, watering, leveling, mowing, weed and pest control, fungus and disease control and other necessary operations as determined by the Landscape Architect and good nursery practice.

3. Re-setting or straightening trees and palms: The Contractor shall re-set and/or straighten trees and palms as required at no additional cost to the Owner unless caused by sustained winds of 75 mph or more. Then, the costs of the operations may be charged to the owner. Re-set trees within 48 hours.

1.12 ACCEPTANCE OF INSTALLATION

A. Inspection: Inspection of the work, to determine completion of contract work, exclusive of the possible replacement of plants and turf, will be made by the Landscape Architect at the conclusion of the maintenance period. Written notice requesting such an inspection and submitted by the Contractor at least ten (10) days prior to the anticipated date.

1.13 GUARANTEE

A. Guarantee all plants for a period of one year (CCD). Guarantee shall commence from the date of written acceptance. Plant material which is on the site and scheduled to be relocated is not covered by the guarantee except in the case of Contractor's negligence or work that has been done in an unworkman-like manner. The Contractor is not responsible for loss due to acts of god, (i.e.) sustained winds of 75 mph or more, floods, frost, lightning, vandalism or theft.

1.14 REPLACEMENT

A. Replacement shall be made during the guarantee period as directed by the Landscape Architect within ten (10) days from time of notification. For all replacement plant material, the guarantee period shall extend for an additional forty-five (45) days beyond the original guarantee period. The Contractor shall be responsible to provide water to the replacement plants in sufficient quantity to aid in their establishment. At the end of the guarantee period, inspection will be made by the Landscape Architect, upon written notice requesting such inspection and submitted by the Contractor at least five (5) days before the anticipated date. Replacement plants must meet the requirements of Florida No. 1 at time of inspection. Remove from the site all plants that are dead or in a state of unsatisfactory growth, as determined by the Landscape Architect. Replace these and any plants missing due to the Contractor's negligence as soon as conditions permit.

1. Materials and Operations: All replacement plants shall be of the same kind and size as indicated on the plant list. The Contractor shall supply and plant the plants as specified under planting operations.

2. Cost of Replacements: A sum sufficient to cover the estimated cost of possible replacements, including material and labor will be retained by the Owner and paid to the Contractor after all replacements have been satisfactorily made and approved by the Landscape Architect.

PART 2 - MATERIALS

2.1 PLANTING SOIL

A. Planting soil for trees, shrubs and ground covers shall be of the composition noted on the plans, measured by volume.

B. Soil for Sodded Areas: shall be coarse lawn sand.

2.2 FERTILIZER

A. Fertilizer for trees, palms, shrubs, and groundcovers shall be as follows: LESCO Palm Special 13-3-13 or equal, Sulfur coated with iron and other minor elements and maximum of 2% chlorine, or brand with equal analysis. The fertilizer shall be uniform in composition, dry and free flowing and shall be delivered to the site in the original unopened containers, bearing the manufacturer's guaranteed analysis. Fertilizer for sod and seeded areas shall be 8-6-8, 50% organically derived nitrogen, or equal.

2.3 WATER

A. The Contractor shall provide potable water on site, available from the start of planting. The Contractor is responsible to ascertain the location and accessibility of the water source. The Contractor is responsible to provide the means of distribution (i.e. water truck, hoses, etc.) for distribution of water to the planting areas.

2.4 MULCH

A. Mulch shall be as specified on the Plant List.

2.5 ROOT BARRIER MATERIAL

A. Root barrier material shall be 24" deep polypropolylene panels by DeepRoot or approved equal.

B. Install per details in the plans.

PART 3 - INSTALLATION PROCEDURES

3.1 LAYOUT

A. Verify location of all underground utilities and obstructions prior to excavation.

3.2 HERBICIDE TREATMENT

1. In all areas infected with weed and/or grass growth, a systemic herbicide shall be applied per manufacturer's rates. When it has been established where work will be done, the systemic herbicide shall be applied in accordance with manufacturer's labeling to kill all noxious growth. Contractor shall schedule his work to allow more than one application to obtain at least 95% kill of undesirable growth. If necessary, Contractor shall conduct a test to establish suitability of product and applicator to be used on this project, prior to execution of the full application.



NR  
architect

NORBERTO ROSENSTEIN  
ARCHITECT , INC.

ARCHITECTURE - INTERIOR DESIGN - PLANNING  
126 S. FEDERAL HIGHWAY SUITE #202  
DANIA BEACH, FLORIDA 33004  
P: (954) 922-6551  
NROSENSTEIN@ROSENSTEINARCHITECT.COM  
WWW.ROSENSTEINARCHITECT.COM

STATE REG. NO. AROO16674  
NATL. REG. NO. 69178  
COPYRIGHT © 2024  
NORBERTO ROSENSTEIN  
ARCHITECT, INC.  
ALL RIGHTS RESERVED. THIS  
DOCUMENT OR PARTS THEREOF,  
MAY NOT BE REPRODUCED IN ANY  
FORM WITHOUT PERMISSION.

| DESIGNED | DRAWN | CHECKED |
|----------|-------|---------|
| GSLA     | GSLA  | GSLA    |

I HEREBY CERTIFY THAT THESE  
PLANS WERE PREPARED BY ME  
OR UNDER  
MY SUPERVISION, AND TO THE  
BEST OF MY KNOWLEDGE,  
COMPLY WITH ALL APPLICABLE  
CODES.

|  |  |  |
|--|--|--|
|  |  |  |
|  |  |  |
|  |  |  |
|  |  |  |
|  |  |  |
|  |  |  |

| R E V I S I O N S |          |
|-------------------|----------|
| COMM.             | DATE     |
| 2024-30           | 09.27.24 |

TREEHOUSE HOTEL,  
MIAMI BEACH

1500 COLLINS +  
1509-1515  
WASHINGTON AVE,  
MIAMI BEACH,  
FL 33139

Landscape Specifications



3.3 PLANT PIT EXCAVATION AND BACKFILLING

A. Trees: See the Planting and Bracing Details and notes.

B. All planting holes shall be hand dug where machine dug holes may adversely affect utilities or improvements.

C. Shrubs and Groundcover: Shrubs and groundcover shall be planted in a soil bed as described in the notes and details. Space shrubs and provide setback from curb and pavements as shown in the plans.

D. Watering of field-grown plants: Thoroughly puddle in water to remove any air pockets in the plant hole.

3.4 WATERING

A. The Contractor is responsible to provide the water for all new plants and transplants and means of distribution (i.e. hand watering or water truck) during the maintenance period and extending into the period after acceptance until the full schedule as listed below is complete. Water for trees and other large field grown plants shall be supplemented by hand or water truck, in addition to the irrigation system, (if one is provided). Contractor can adjust watering schedule during heavy rain season upon approval of the Landscape Architect.

AMOUNT OF WATER PER APPLICATION

For trees up to 5 inch caliper - 5 gallons

From 5 to 8 inch caliper - 25 gallons

9 inch and up caliper - 50 gallons

FREQUENCY OF WATER

Daily for the first week

3 times per week for weeks 2 - 5

2 times per week for weeks 6 - 8

1 time per week for weeks 9 - 12

B. Water in plants by thoroughly soaking of the entire root ball immediately after planting. For large trees and shrubs, add water while backfilling hole to eliminate any air pockets in the soil around the root ball.

C. Water shrubs, sod and groundcover a minimum of once daily for a week or until an irrigation system is fully operational. If no irrigation system is to be installed, the Contractor shall be responsible for watering the shrub, sod, and groundcover for the time specified above, after installation of each section of the planting installed.

3.5 FERTILIZING

A. Add fertilizer on top of the surface of shrubs beds and tree and palms root balls two (2) months after installation. Fertilize sod within two (2) days after installing after planting of each segment of the job. Fertilizer shall be applied after soil has been well moistened. Fertilizer shall be washed off of plant leaves and stems immediately after application. Apply at the following rates:

1. Trees and Large Shrubs: One (1) pound per inch of trunk diameter, spread evenly over the root ball area.

2. Shrubs: One half (1/2) handful per shrub, spread evenly over the root ball area.

3. Groundcover: Twelve (12) pounds per 100 sq. ft. of bed area.

4. Sod: Twelve (12) pounds per 1,000 sq. ft. Wash fertilizer off blades immediately after spreading.

3.6 MULCHING

A. Spread mulch three (3) inches thick uniformly over the entire surface of shrubs and groundcover beds, depth measured after settling, unless otherwise specified in the plans. Provide 36” diameter bed of mulch, measured from outer edge of the trunk, for all trees and palms planted in sod areas. Keep mulch away from contact with the trunk. Create a 6” high ring of mulch at the outer edge of tree and palm holes.

3.7 GUYING AND BRACING

A. See the details bound herewith or made part of the plans.

3.8 SODDING

A. Provide a blanket of lawn sand as described in the notes in these plans. Prior to planting, remove stones, sticks, etc. from the sub-soil surface. Excavate existing non-conforming soil as required so that the finish grade of sod is flush with adjacent pavement or top of curb as well as adjacent sod in the case of sod patching.

B. Place sod on moistened soil, with edges tightly butted, in staggered rows at right angles to slopes. The sod shall be rolled with a 500 pound hand roller immediately after placing.

C. Keep edge of sod bed a minimum of 18” away from groundcover beds and 24” away from edge of shrub beds and 36” from trees, measured from the edge of plant or tree trunk.

D. Sod shall be watered immediately after installation to uniformly wet the soil to at least two inches below the bottom of sod strips.

E. Apply fertilizer to the sod as specified in Section 3.5.

F. Excavate and remove excess soil so top of sod is flush w/top of curb or adjacent pavement, or adjacent existing sod.

PLANT BED PREPARATION NOTES

1. In all areas where new sod and shrub and groundcover masses are to be planted, kill all existing weeds by treating with systemic herbicide prior to beginning soil preparation.

2. In all shrub and groundcover beds, excavate and backfill soil as described in "Plant List(s)". If no specific preparation is noted, prepare soil as described below for either condition, over the entire area to be planted:

Condition A:

If any compacted road base or asphalt or rocky soil is encountered, remove compacted material entirely to allow an 18” depth of planting soil per plant list unless otherwise stated. Backfill the entire area of the shrub and groundcover beds with 18” planting soil (as specified in Plans) to within 2 inches of the adjacent pavement or top of curb. Remove all debris and rocks and pebbles larger than 2 inches in size and level the grade before planting.

Condition B:

Where no compacted soil is encountered, thoroughly mix 6 inches of planting soil per plant list into the existing soil to a depth of 18 inches unless otherwise stated. If required, excavate and remove the existing soil to lower the grade, so that the prepared mix is finished to a minimum of 2 inches below top of curb or adjacent walkway. Remove all debris and rocks and pebbles larger than 2 inches in size and level the grade before planting.

For all sod areas, spread a 2” deep layer of lawn sand prior to sodding. Remove all debris and rocks and pebbles larger than 2 inchs in size and level the grade before sodding. Remove, if required, existing soil so that top of sod is flush with and adjacent top of curb or pavement.

For Trees and shrubs larger than 7 gallon, Add Diehard” transplant innoculant supplied by Horticultural Alliance, Inc. (800-628-6373) or equal. Mix into top 8-10 inches of planting hole, making sure it is contact with the root ball. Add at a rate specified by manufacturer (typically 4oz. per 1 inches of trunk caliper or 7 gallon can).

SPACING OF PLANTS (SEE PLANT SPACING DETAIL)

1. Plants shall be planted sufficiently away from edges of pavements or curbs, to allow for growth toward the edges of the bed.

PROTECTION OF PLANTS

1. The Contractor shall be responsible to protect existing trees and shrubs in and adjacent to the area of work. Erect barriers as necessary to keep equipment and materials, any toxic material, away from the canopy drip line of trees and shrubs. DO NOT PILE SOIL OR DEBRIS AGAINST TREE TRUNKS OR DEPOSIT NOXIOUS BUILDING SUPPLIES OR CHEMICALS WITHIN THE DRIP LINE.



GARDNER + SEMLER  
LANDSCAPE ARCHITECTURE  
WWW.GSLADesign.COM  
17670 NW 78th AVE., SUITE 214  
MIAMI, FL 33015  
P 305.392.1016 F 305.392.1019  
CORP. ID # 0000266



NORBERTO ROSENSTEIN  
ARCHITECT, INC.

ARCHITECTURE - INTERIOR DESIGN - PLANNING  
126 S. FEDERAL HIGHWAY SUITE #202  
DANIA BEACH, FLORIDA 33004  
P: (954) 922-6551  
NROSENSTEIN@ROSENSTEINARCHITECT.COM  
WWW.ROSENSTEINARCHITECT.COM

STATE REG. NO. AROO16674  
NATL. REG. NO. 69178  
COPYRIGHT © 2024  
NORBERTO ROSENSTEIN  
ARCHITECT, INC.  
ALL RIGHTS RESERVED. THIS  
DOCUMENT OR PARTS THEREOF,  
MAY NOT BE REPRODUCED IN ANY  
FORM WITHOUT PERMISSION.

| DESIGNED | DRAWN | CHECKED |
|----------|-------|---------|
| GSLA     | GSLA  | GSLA    |

I HEREBY CERTIFY THAT THESE  
PLANS WERE PREPARED BY ME  
OR UNDER  
MY SUPERVISION, AND TO THE  
BEST OF MY KNOWLEDGE,  
COMPLY WITH ALL APPLICABLE  
CODES.

|  |  |  |
|--|--|--|
|  |  |  |
|  |  |  |
|  |  |  |
|  |  |  |
|  |  |  |
|  |  |  |

| REVISIONS |          |
|-----------|----------|
| COMM.     | DATE     |
| 2024-30   | 09.27.24 |

TREEHOUSE HOTEL,  
MIAMI BEACH

1500 COLLINS +  
1509-1515  
WASHINGTON AVE,  
MIAMI BEACH,  
FL 33139

Landscape Specifications

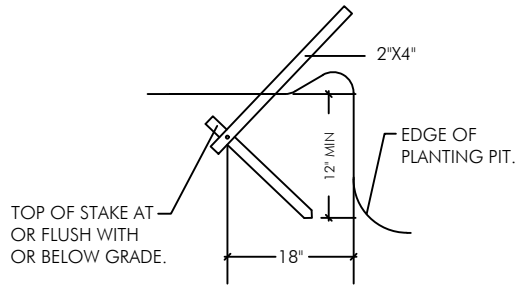

## DETAIL A

N.T.S.

CURVED TRUNK LEAN ANGLE AS NOTED ON PLAN/PLANT LIST

NOTE - USE 4" X 4" STAKES  
PALMS OVER 12" CALIPER.

PROVIDE FOUR 2' X 4' PINE STAKES  
90° APART (EXTRA STAKE IF  
NECESSARY TO SUPPORT LEAN).  
ATTACH W/NAILS TO BATTENS  
NO NAILS IN TREE.

SET ROOTBALL SO TRUNK FLARE  
OR TOP ROOT IS 2" ABOVE  
SURROUNDING GRADE.

INSTALL 3" OF MULCH OVER 3'  
DIAMETER CIRCLE AROUND THE  
TRUNK. DO NOT PLACE MULCH  
WITHIN 3" OF THE TRUNK.

REMOVE ANY PORTION OF WIRE  
BASKETS OR BURLAP ABOVE THE  
TOP HALF OF THE ROOTBALL.  
FOLD BACK BURLAP COVERINGS  
BELOW THE TOP HALF OF THE  
ROOTBALL. COMPLETELY REMOVE  
ALL SYNTHETIC ROOTBALL  
COVERING MATERIALS.

DETAIL A

WOOD STAKES TOP OF STAKES  
BELOW OR FLUSH WITH GRADE.

ANGLE SUBGRADE BASE AND  
ROOTBALL IF NECESSARY TO  
ACHIEVE SPECIFIED LEAN ANGLE.

## PLANTING & BRACING DETAIL FOR LEANING/CROOKED PALMS

N.T.S.

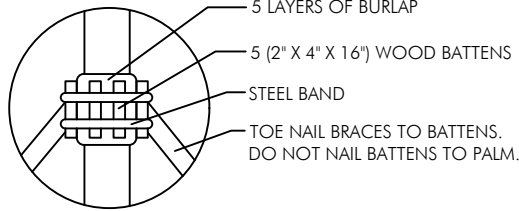
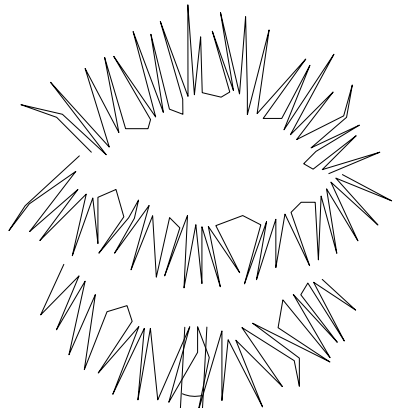

## BATTEN DETAIL B

N.T.S.

NOTE - SECURE BATTENS WITH 2-3/4" HI CARBON STEEL BANDS  
TO HOLD BATTENS IN PLACE DURING PLANTING PROCESS.  
DO NOT NAIL BATTENS TO PALM.  
THE HEIGHT OF THE BATTENS SHALL BE LOCATED IN RELATION  
TO THE HEIGHT OF THE PALM FOR ADEQUATE BRACING.  
PAINT ALL EXPOSED WOOD SURFACES, (COLOR TO BE  
APPROVED BY LANDSCAPE ARCHITECT).

ALL SUPPORT MATERIALS ARE TO BE REMOVED FROM THE  
PALMS ONCE THE TREES HAVE BECOME ESTABLISHED  
(NOT TO EXCEED 12 MONTHS FROM THE COMPLETION  
OF THE PROJECT).

6" HIGH TEMPORARY RETENTION RING OF SOIL TO ASSIST IN  
IRRIGATION OF THE TREE.  
REMOVE RING 3 MONTHS AFTER INSTALLATION.

FINISHED GRADE

HOLES TO ACCOMMODATE PLANTS SHALL BE A MINIMUM  
OF THREE TIMES THE SIZED OF THE PLANT ROOTBALL.

ALL BACKFILL FOR TREES SHALL BE PLANTING SOIL

FERTILIZER SHALL BE INSTALLED AS PER THE  
WRITTEN SPECIFICATIONS.

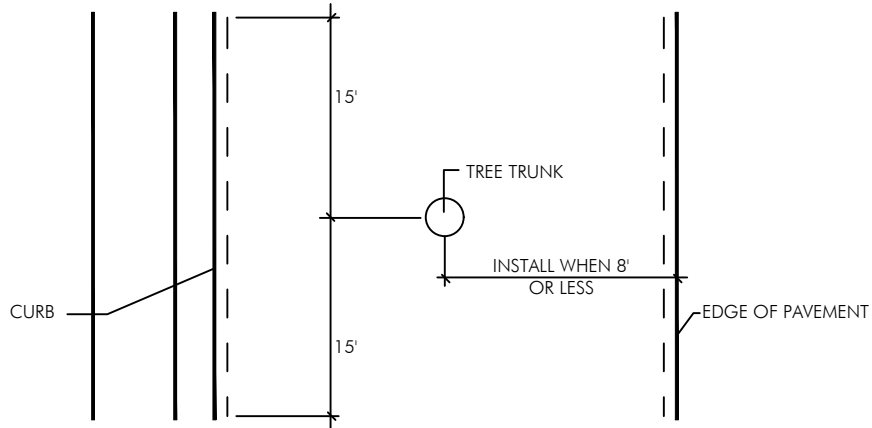

## PLAN VIEW

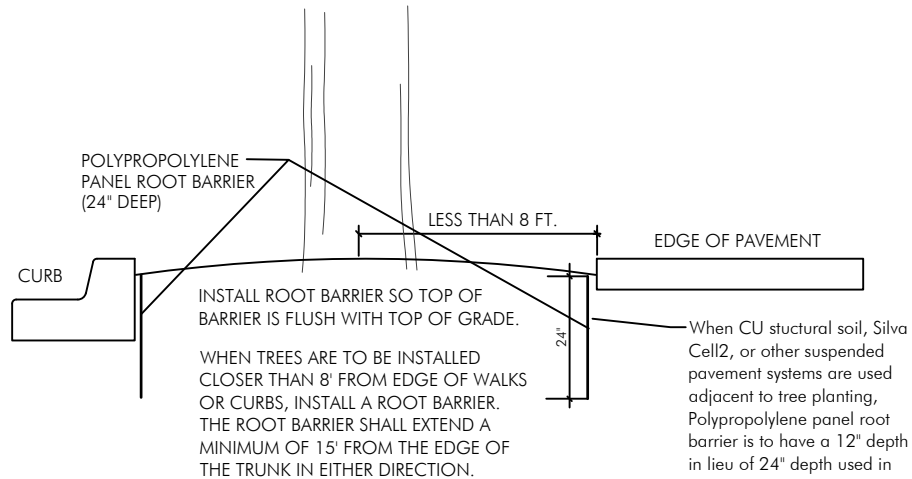

## ROOT BARRIER INSTALLATION DETAIL

N.T.S.



GARDNER + SEMLER  
LANDSCAPE ARCHITECTURE  
WWW.GSLADESIGN.COM  
17670 NW 78th AVE., SUITE 214  
MIAMI, FL 33015  
P 305.392.1016 F 305.392.1019  
CORP. ID # 0000266



NORBERTO ROSENSTEIN  
ARCHITECT, INC.

ARCHITECTURE - INTERIOR DESIGN - PLANNING  
126 S. FEDERAL HIGHWAY SUITE #202  
DANIA BEACH, FLORIDA 33004  
P: (954) 922-6551  
NROSENSTEIN@ROSENSTEINARCHITECT.COM  
WWW.ROSENSTEINARCHITECT.COM

STATE REG. NO. AR0016674  
NATL. REG. NO. 69178  
COPYRIGHT © 2024  
NORBERTO ROSENSTEIN  
ARCHITECT, INC.  
ALL RIGHTS RESERVED. THIS  
DOCUMENT OR PARTS THEREOF,  
MAY NOT BE REPRODUCED IN ANY  
FORM WITHOUT PERMISSION.

| DESIGNED | DRAWN | CHECKED |
|----------|-------|---------|
| GSLA     | GSLA  | GSLA    |

I HEREBY CERTIFY THAT THESE  
PLANS WERE PREPARED BY ME  
OR UNDER  
MY SUPERVISION, AND TO THE  
BEST OF MY KNOWLEDGE,  
COMPLY WITH ALL APPLICABLE  
CODES.

|  |  |  |
|--|--|--|
|  |  |  |
|  |  |  |
|  |  |  |
|  |  |  |
|  |  |  |

### REVISIONS

| COMM.   | DATE     |
|---------|----------|
| 2024-30 | 09.27.24 |

TREEHOUSE HOTEL,  
MIAMI BEACH

1500 COLLINS +  
1509-1515  
WASHINGTON AVE,  
MIAMI BEACH,  
FL 33139

Planting Details

L2-15



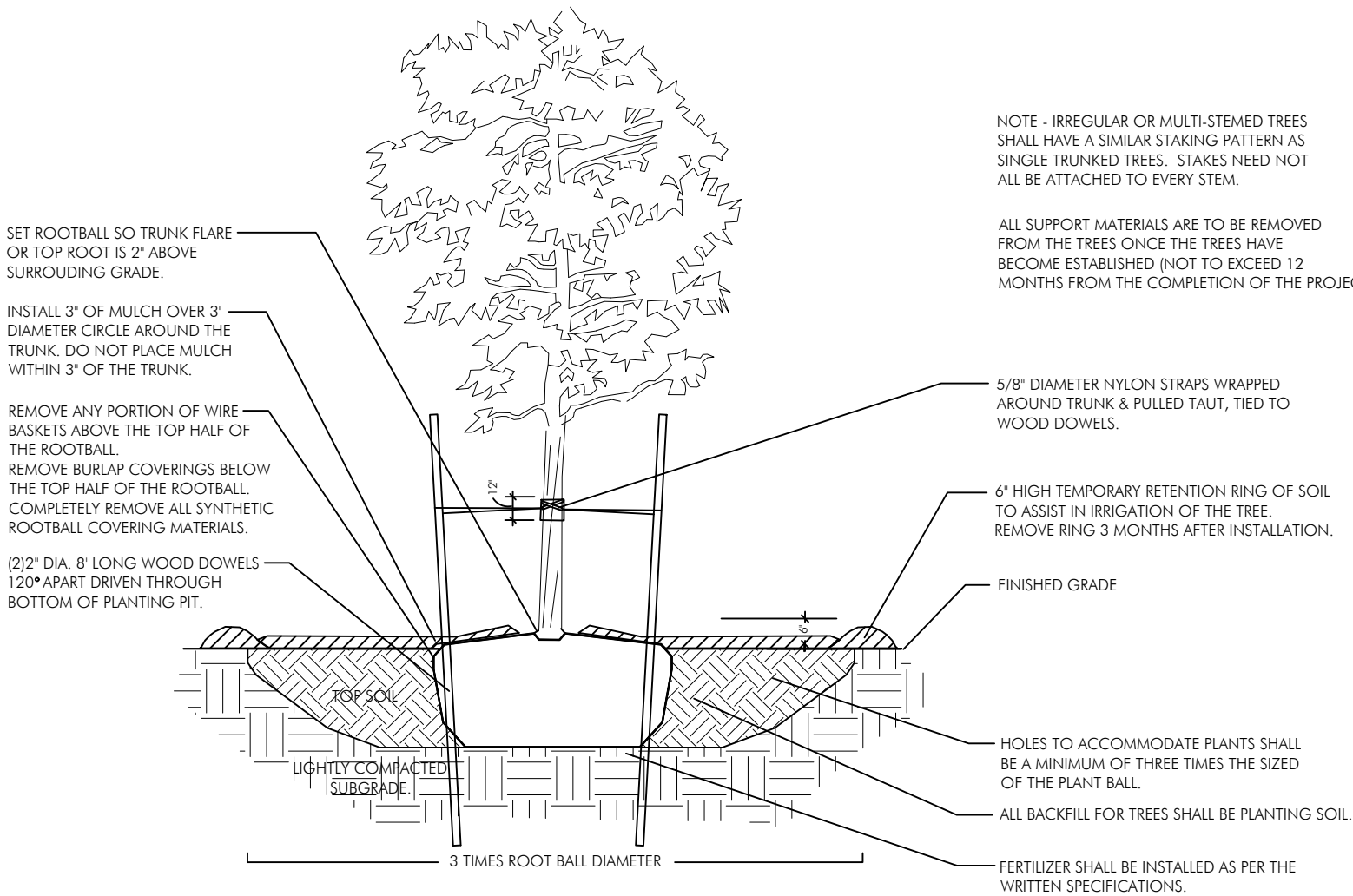

NOTE - IRREGULAR OR MULTI-STEMED TREES SHALL HAVE A SIMILAR STAKING PATTERN AS SINGLE TRUNKED TREES. STAKES NEED NOT ALL BE ATTACHED TO EVERY STEM.

ALL SUPPORT MATERIALS ARE TO BE REMOVED FROM THE TREES ONCE THE TREES HAVE BECOME ESTABLISHED (NOT TO EXCEED 12 MONTHS FROM THE COMPLETION OF THE PROJECT).

## PLANTING & BRACING DETAIL UNDER 3 1/2" CALIPER

N.T.S.

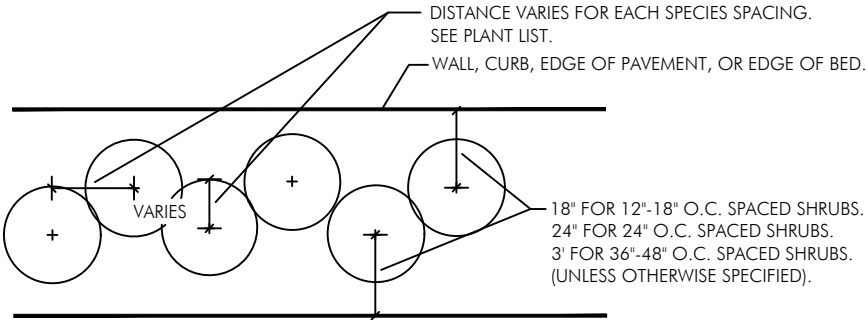

## SHRUB SPACING DIAGRAM

N.T.S.

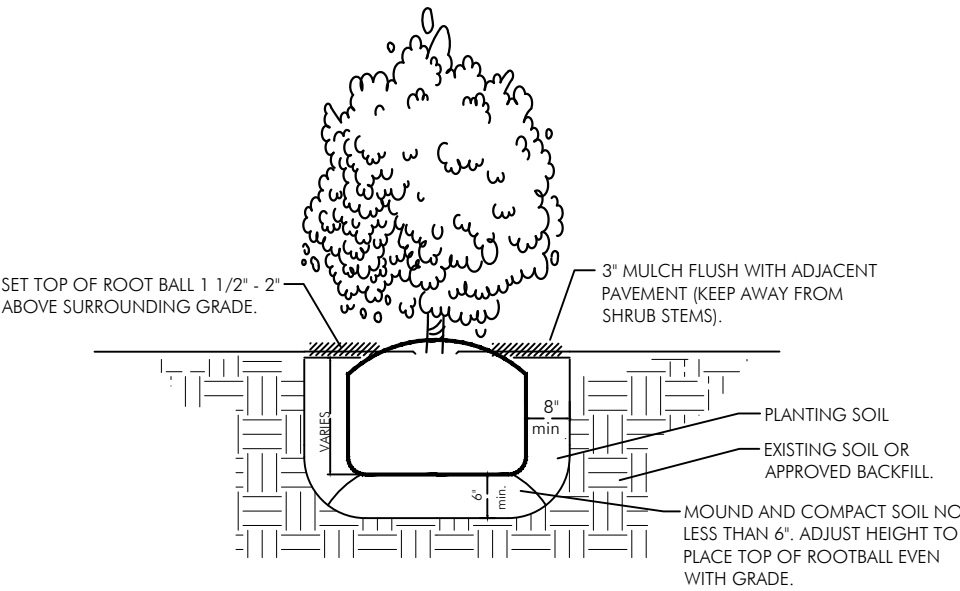

## SHRUB INSTALLATION DETAIL

N.T.S.

| DESIGNED | DRAWN | CHECKED |
|----------|-------|---------|
| GSLA     | GSLA  | GSLA    |

I HEREBY CERTIFY THAT THESE  
PLANS WERE PREPARED BY ME  
OR UNDER  
MY SUPERVISION, AND TO THE  
BEST OF MY KNOWLEDGE,  
COMPLY WITH ALL APPLICABLE  
CODES.

|  |  |  |
|--|--|--|
|  |  |  |
|  |  |  |
|  |  |  |
|  |  |  |
|  |  |  |

| REVISIONS |          |
|-----------|----------|
| COMM.     | DATE     |
| 2024-30   | 09.27.24 |

TREEHOUSE HOTEL,  
MIAMI BEACH

1500 COLLINS +  
1509-1515  
WASHINGTON AVE,  
MIAMI BEACH,  
FL 33139

Planting Details

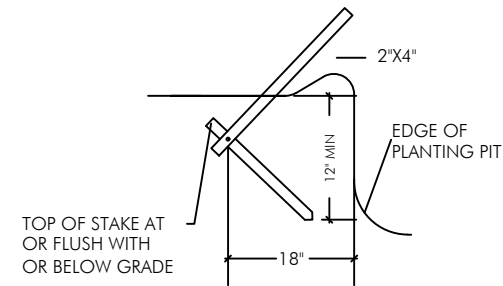

## DETAIL A

N.T.S.

NOTE - USE 4" X 4" STAKES  
PALMS OVER 12" CALIPER.

PROVIDE FOUR 2' X 4' PINE STAKES  
120° APART.  
ATTACH W/ NAILS TO BATTENS  
NO NAILS IN TREE.

SET ROOTBALL SO TRUNK FLARE  
OR TOP ROOT IS 2" ABOVE  
SURROUNDING GRADE.

INSTALL 3" OF MULCH OVER 3'  
DIAMETER CIRCLE AROUND THE  
TRUNK. DO NOT PLACE MULCH  
WITHIN 3" OF THE TRUNK.

REMOVE ANY PORTION OF WIRE  
BASKETS OR BURLAP ABOVE THE  
TOP HALF OF THE ROOTBALL.  
FOLD BACK BURLAP COVERINGS  
BELOW THE TOP HALF OF THE  
ROOTBALL. COMPLETELY REMOVE  
ALL SYNTHETIC ROOTBALL  
COVERING MATERIALS.

DETAIL A

WOOD STAKES TOP OF STAKES  
BELOW OR FLUSH WITH GRADE.

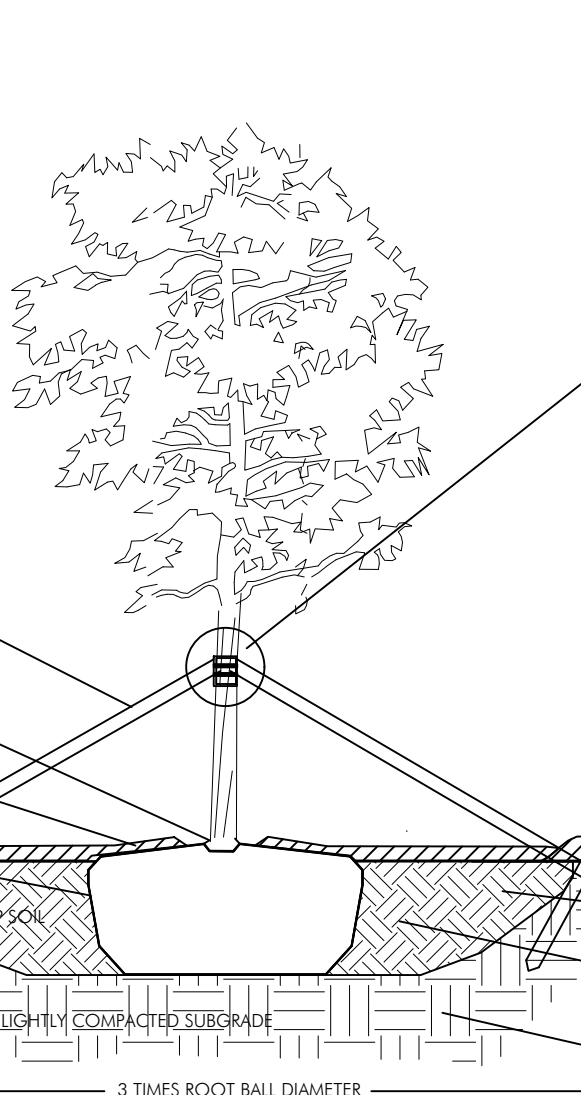

## PLANTING & BRACING DETAIL OVER 3 1/2" CALIPER

N.T.S.

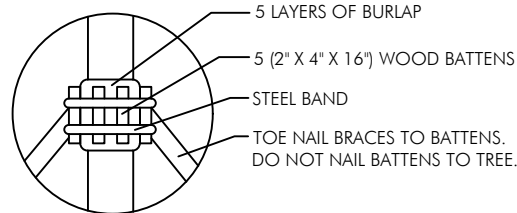

## BATTEN DETAIL B

N.T.S.

NOTE - SECURE BATTENS WITH 2-3/4" HI CARBON STEEL BANDS  
TO HOLD BATTENS IN PLACE DURING PLANTING PROCESS.  
DO NOT NAIL BATTENS TO TREE.  
THE HEIGHT OF THE BATTENS SHALL BE LOCATED IN RELATION  
TO THE HEIGHT OF THE TREE FOR ADEQUATE BRACING.  
PAINT ALL EXPOSED WOOD SURFACES, (COLOR TO BE  
APPROVED BY LANDSCAPE ARCHITECT).

NOTE - IRREGULAR OR MULTI-STEMED TREES  
SHALL HAVE A SIMILAR STAKING PATTERN AS  
SINGLE TRUNKED TREES. STAKES NEED NOT  
ALL BE ATTACHED TO EVERY STEM.

ALL SUPPORT MATERIALS ARE TO BE REMOVED  
FROM THE TREES ONCE THE TREES HAVE  
BECOME ESTABLISHED (NOT TO EXCEED 12  
MONTHS FROM THE COMPLETION OF THE PROJECT).

6" HIGH TEMPORARY RETENTION RING OF SOIL TO ASSIST IN  
IRRIGATION OF THE TREE.  
REMOVE RING 3 MONTHS AFTER INSTALLATION.

FINISHED GRADE

HOLES TO ACCOMMODATE PLANTS SHALL BE A MINIMUM  
OF THREE TIMES THE SIZED OF THE PLANT ROOTBALL.

ALL BACKFILL FOR TREES SHALL BE PLANTING SOIL

FERTILIZER SHALL BE INSTALLED AS PER THE  
WRITTEN SPECIFICATIONS.

| DESIGNED | DRAWN | CHECKED |
|----------|-------|---------|
| GSLA     | GSLA  | GSLA    |

I HEREBY CERTIFY THAT THESE  
PLANS WERE PREPARED BY ME  
OR UNDER  
MY SUPERVISION, AND TO THE  
BEST OF MY KNOWLEDGE,  
COMPLY WITH ALL APPLICABLE  
CODES.

|  |  |  |
|--|--|--|
|  |  |  |
|  |  |  |
|  |  |  |
|  |  |  |
|  |  |  |

| REVISIONS |          |
|-----------|----------|
| COMM.     | DATE     |
| 2024-30   | 09.27.24 |

**TREEHOUSE HOTEL,  
MIAMI BEACH**

1500 COLLINS +  
1509-1515  
WASHINGTON AVE,  
MIAMI BEACH,  
FL 33139

Planting Details





GARDNER + SEMLER  
LANDSCAPE ARCHITECTURE  
WWW.GSLADDESIGN.COM  
17670 NW 78th AVE., SUITE 214  
MIAMI, FL 33015  
P 305.392.1016 F 305.392.1019  
CORP. ID # 0000266



NORBERTO ROSENSTEIN  
ARCHITECT, INC.

ARCHITECTURE - INTERIOR DESIGN - PLANNING  
126 S. FEDERAL HIGHWAY SUITE #202  
DANIA BEACH, FLORIDA 33004  
P: (954) 922-6551  
NROSENSTEIN@ROSENSTEINARCHITECT.COM  
WWW.ROSENSTEINARCHITECT.COM

STATE REG. NO. AROO16674  
NATL. REG. NO. 69178  
COPYRIGHT © 2024  
NORBERTO ROSENSTEIN  
ARCHITECT, INC.  
ALL RIGHTS RESERVED. THIS  
DOCUMENT OR PARTS THEREOF,  
MAY NOT BE REPRODUCED IN ANY  
FORM WITHOUT PERMISSION.

| DESIGNED | DRAWN | CHECKED |
|----------|-------|---------|
| GSLA     | GSLA  | GSLA    |

I HEREBY CERTIFY THAT THESE  
PLANS WERE PREPARED BY ME  
OR UNDER  
MY SUPERVISION, AND TO THE  
BEST OF MY KNOWLEDGE,  
COMPLY WITH ALL APPLICABLE  
CODES.

|  |  |  |
|--|--|--|
|  |  |  |
|  |  |  |
|  |  |  |
|  |  |  |
|  |  |  |

REVISIONS

| COMM.   | DATE     |
|---------|----------|
| 2024-30 | 09.27.24 |

TREEHOUSE HOTEL,  
MIAMI BEACH

1500 COLLINS +  
1509-1515  
WASHINGTON AVE,  
MIAMI BEACH,  
FL 33139

Planting Details

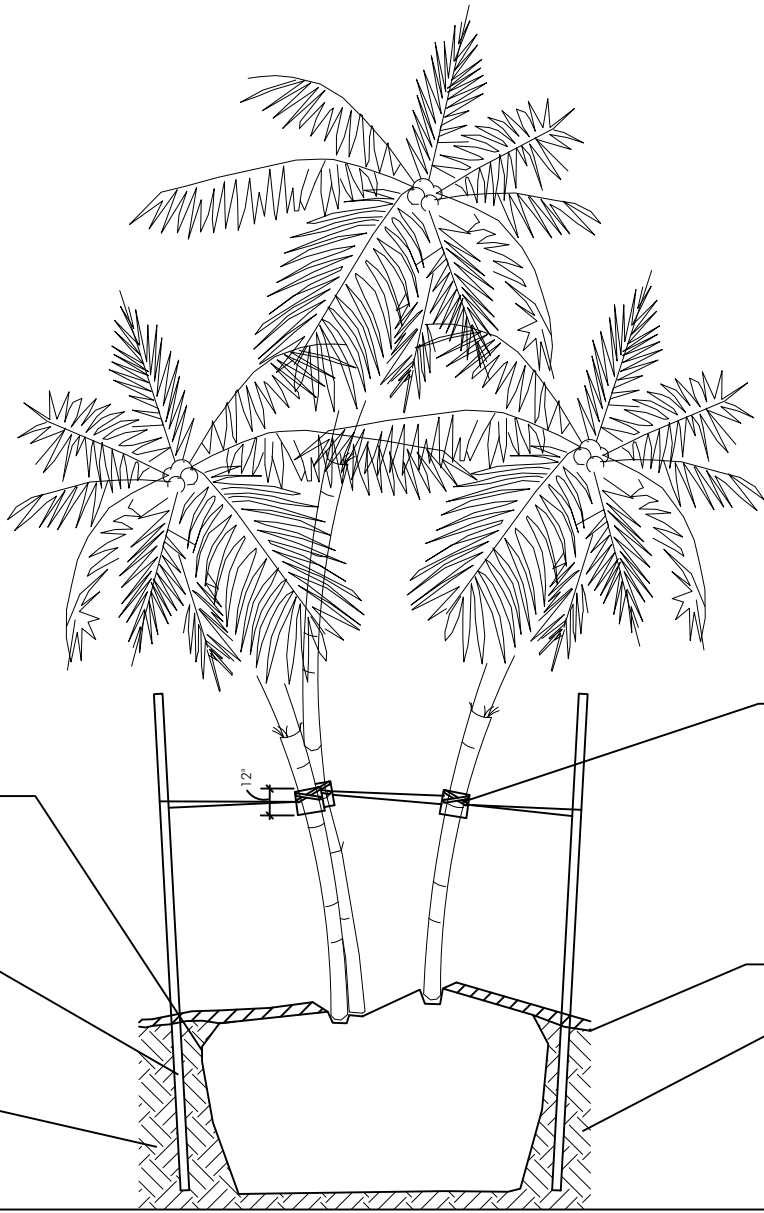

MULTI-TRUNKED TREE/PALM BRACING DETAIL

N.T.S.

NOTE - IRREGULAR OR MULTI-STEMED TREES  
SHALL HAVE A SIMILAR STAKING PATTERN AS  
SINGLE TRUNKED TREES. STAKES NEED NOT  
ALL BE ATTACHED TO EVERY STEM.

ALL SUPPORT MATERIALS ARE TO BE REMOVED  
FROM THE TREES ONCE THE TREES HAVE  
BECOME ESTABLISHED (NOT TO EXCEED 12  
MONTHS FROM THE COMPLETION OF THE PROJECT).

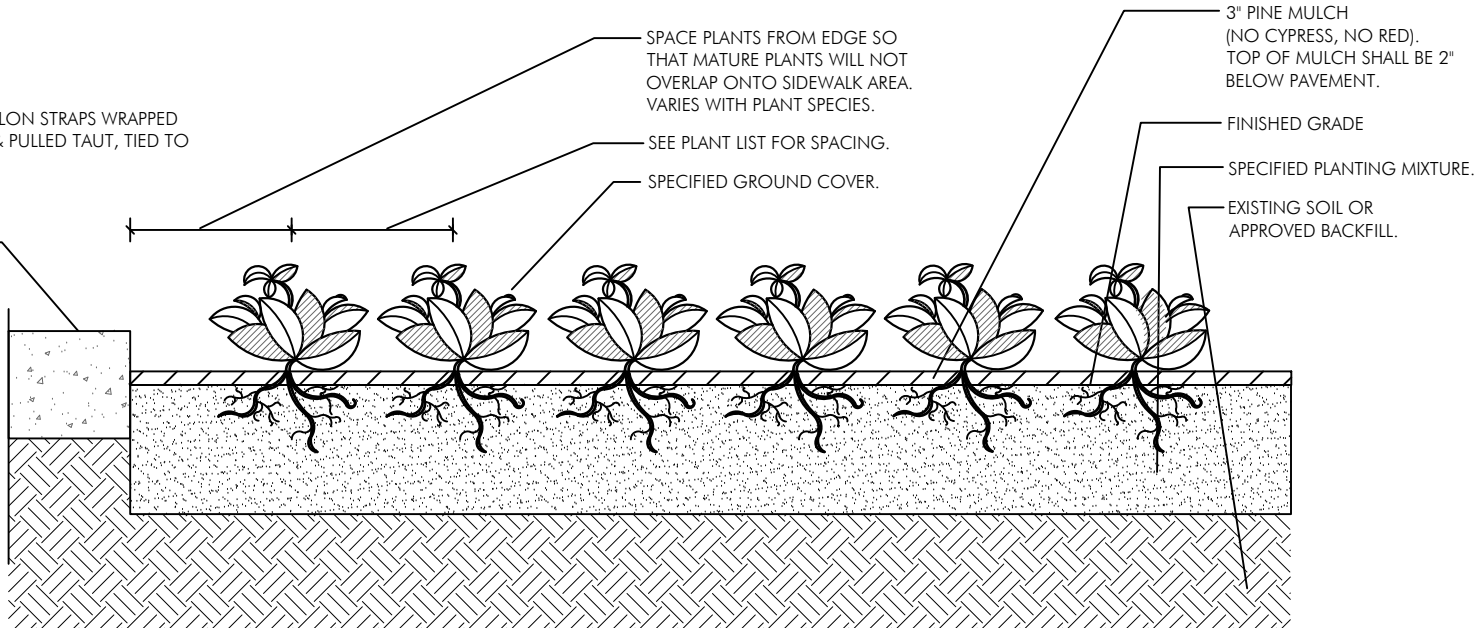

GROUND COVER PLANTING DETAIL

N.T.S.