

Tree #	Botanical Name	Common Name	DBH in inches	OAH in feet	Spread in feet	Notes/Condition (All are fair to good unless otherwise noted)
1	<i>Bursera simaruba</i>	Gumbo limbo	9.5	12-14	18-22	To remain
2	<i>Quercus virginiana</i>	Live oak	25	35-40	25-30	To remain
3	<i>Schefflera actinophylla</i>	Umbrella tree	15	25-30	20-25	Invasive species to be removed
4	<i>Quercus virginiana</i>	Live oak	12	30-35	15-20	To remain
5	<i>Quercus virginiana</i>	Live oak	11.5	35-40	20-25	To remain
6	<i>Washingtonia robusta</i>	Washingtonia palm	13	50-60	12-14	Exempt from permit requirements
7	<i>Washingtonia robusta</i>	Washingtonia palm	13	50-60	12-14	Exempt from permit requirements
8	<i>Washingtonia robusta</i>	Washingtonia palm	13	35-40	12-14	Exempt from permit requirements
9	<i>Quercus virginiana</i>	Live oak	14	35-40	30-35	To remain
10	<i>Quercus virginiana</i>	Live oak	16	35-40	30-35	To remain
11	<i>Washingtonia robusta</i>	Washingtonia palm	14	60-65	12-14	Exempt from permit requirements
12	<i>Cocos nucifera</i>	Coconut palm	9	40-45	20-25	To be removed
13	<i>Cocos nucifera</i>	Coconut palm	9	30-35	20-25	To be removed
14	<i>Cocos nucifera</i>	Coconut palm	9	35-40	20-25	To be removed
15	<i>Washingtonia robusta</i>	Washingtonia palm	14	60-65	12-14	Exempt from permit requirements
16	<i>Sabal palmetto</i>	Sabal palm	8	30-35	10-12	To be relocated
17	<i>Sabal palmetto</i>	Sabal palm	8	30-35	10-12	To be relocated
18	<i>Quercus virginiana</i>	Live oak	3	10-11	6-8	To remain
19	<i>Quercus virginiana</i>	Live oak	3	10-11	6-8	To remain
20	<i>Quercus virginiana</i>	Live oak	3	10-11	6-8	To remain
21	<i>Quercus virginiana</i>	Live oak	3	10-11	6-8	To remain
22	<i>Quercus virginiana</i>	Live oak	3	10-11	6-8	To remain
23	<i>Tabebuia heterophylla</i>	Pink trumpet tree	12	35-40	20-25	To be relocated on site
24	<i>Quercus virginiana</i>	Live oak	16	20-25	20-25	To remain
25	<i>Sabal palmetto</i>	Sabal palm	8	30-35	10-12	To be relocated on site
26	<i>Sabal palmetto</i>	Sabal palm	8	30-35	10-12	To be relocated on site
27	<i>Sabal palmetto</i>	Sabal palm	8	30-35	10-12	To be relocated on site
28	<i>Sabal palmetto</i>	Sabal palm	8	30-35	10-12	To be relocated on site
29	<i>Sabal palmetto</i>	Sabal palm	8	30-35	10-12	To be relocated on site
30	<i>Sabal palmetto</i>	Sabal palm	8	30-35	10-12	To be relocated on site
31	<i>Sabal palmetto</i>	Sabal palm	8	20-25	10-12	To be relocated on site
32	<i>Sabal palmetto</i>	Sabal palm	8	25-30	10-12	To be relocated on site
33	<i>Sabal palmetto</i>	Sabal palm	7	30-35	10-12	To be relocated on site
34	<i>Sabal palmetto</i>	Sabal palm	7	25-30	10-12	To be relocated on site
35	<i>Sabal palmetto</i>	Sabal palm	10	30-35	10-12	To be relocated on site
36	<i>Sabal palmetto</i>	Sabal palm	6	30-35	10-12	To be relocated on site
37	<i>Sabal palmetto</i>	Sabal palm	7	30-35	10-12	To be relocated on site
38	<i>Phoenix sylvestris</i>	Date palm	12	25-30	15-20	To be relocated on site
38A	<i>Schefflera actinophylla</i>	Umbrella tree	24	40-45	30-35	Invasive species to be removed
39	<i>Sabal palmetto</i>	Sabal palm	8	20-25	10-12	To be relocated on site
40	<i>Sabal palmetto</i>	Sabal palm	8	30-35	10-12	To be relocated on site
41	<i>Sabal palmetto</i>	Sabal palm	8	30-35	10-12	To be relocated on site
42	<i>Phoenix reclinata</i>	Senegal Date palm	40	25-30	30-35	To be removed. Category 1, no mitigation required
43	<i>Sabal palmetto</i>	Sabal palm	8	30-35	10-12	To be relocated on site
44	<i>Sabal palmetto</i>	Sabal palm	8	30-35	10-12	To be relocated on site
45	<i>Sabal palmetto</i>	Sabal palm	8	40-45	10-12	To be relocated on site
46	<i>Bucida buceras</i>	Black Olive	28	40-45	30-35	To remain. Recommended pruning off roadway
47	<i>Bucida buceras</i>	Black Olive	24	40-45	60-65	To remain
48	<i>Ravenala madagascariensis</i>	Travelers Palm	16	15-20	15-20	To be removed
49	<i>Bursera simaruba</i>	Gumbo limbo	7	12-14	15-20	To remain
50	<i>Washingtonia robusta</i>	Washingtonia palm	13.5	50-60	12-14	Exempt from permit requirements
51	<i>Quercus virginiana</i>	Live oak	21	30-35	45-50	To remain
52	<i>Washingtonia robusta</i>	Washingtonia palm	13	50-60	12-14	Exempt from permit requirements
53	<i>Washingtonia robusta</i>	Washingtonia palm	N/A	8-10	6-7	Exempt from permit requirements
54	<i>Washingtonia robusta</i>	Washingtonia palm	12	40-45	12-14	Exempt from permit requirements
54A	<i>Washingtonia robusta</i>	Washingtonia palm	N/A	6-7	5-6	Exempt from permit requirements
55	<i>Quercus virginiana</i>	Live oak	20	30-35	40-45	To remain
56	<i>Washingtonia robusta</i>	Washingtonia palm	13	40-45	12-14	Exempt from permit requirements
57	<i>Quercus virginiana</i>	Live oak	20	30-35	40-45	To remain
58	<i>Washingtonia robusta</i>	Washingtonia palm	13	40-45	12-14	Exempt from permit requirements
59	<i>Washingtonia robusta</i>	Washingtonia palm</				

EXISTING TREES TO REMAIN

EXISTING TREES TO BE RELOCATED

EXISTING TREES TO BE REMOVED

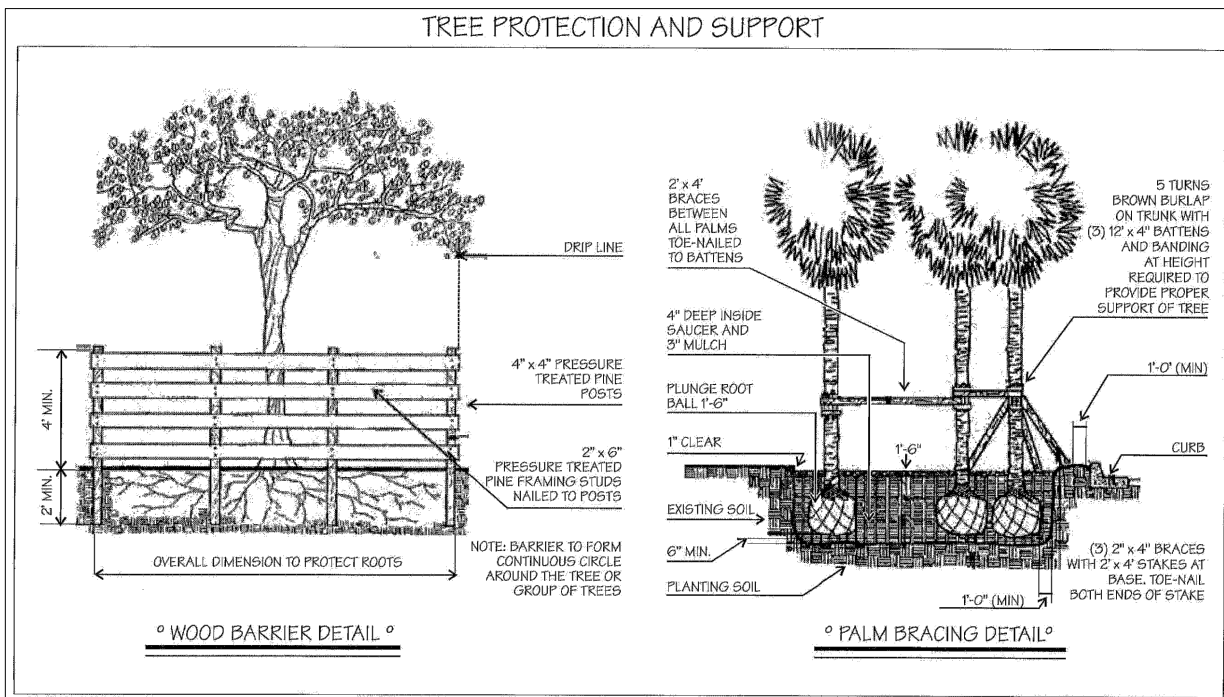

2ND LEVEL COMMERCIAL  
TENANT IMPROVEMENT  
1801 ALTON ROAD  
MIAMI BEACH, FLORIDA 33139

LD-1.0



PROPOSED PLANT LIST						
SYM	BOTANICAL NAME	COMMON NAME	SPEC	NATIVE	DROUGHT	QTY
TREES + PALMS						
Rre	Roystonea regia	Florida Royal Palm	45' OA 18' GW 20" CAL	*	*	5
Bsi	Bursera simaruba	Gumbo Limbo	20' HT 8"-10" DBH	*	*	3
Tba	Tabebuia bahamensis	Bahama Tabebuia Tree	14'-16" HT OA 4"-6" DBH	*	*	1
Cer1	Conocarpus erectus var. sericeus	Silver Buttonwood Tree	8'-10' OA STD. 2"-3" DBH	*	*	16
Cer2	Conocarpus erectus	Green Buttonwood Tree	18' OA 4"-6" DBH Multi w/ Character	*	*	3
SHRUBS + ACENTS						
PL	Psychotria ligustrifolia	Bahama Coffee	15G		*	27
SR	Serenoa Repens	Silver Saw Palmetto	25G @ 4' HT	*	*	4
TF	Tripsacum floridiana	Gamma Grass	7 GAL	*	*	20
AO	Silver odorata bromeliad	Alcantarea Odorata	30" X 30"		*	9
HP	Hamelia patens	Firebush	15G		*	56
CC	Capparis cynophallophora	Jamaican Caper	25G	*	*	25
CW	Carapa guianensis	Crabwood	25G	*	*	27
CG	Clusia guttifera Hedge	Small Leaf Clusia	25G		*	88
DS	Dioon spinulosum	Giant Dioon	4' HT		*	1
FK	Pennisetum fakahatchee	Fakahatchee Grass	7G	*	*	2
ZF	Zamia Floridana	Coontie Palm	15G	*	*	4
ZP	Zamia pumila	Coontie Palm	15G	*	*	33
GROUNDCOVERS						
EL	Emodea littoralis	Golden Creeper	1 GAL @ 18" OC	*	*	54
TD	Tripsacum floridiana	Gamma Grass	3 GAL @ 36" OC	*	*	452
AG	Perenninal Peanut	Wild Peanut	1 GAL @ 18" OC	*	*	1430
CM	Carissa	Emerald Blanket	3 GAL @ 24" OC	*	*	165
BM	Philodendron	Burle Marx	3 GAL @ 24" OC		*	116
ZP	Zamia pumila	Coontie	3 GAL @ 24" OC	*	*	70
SOD	Empire Zoysia		3,084 SF			



PLANT LIST

PROPOSED PLANT LIST						
SYM	BOTANICAL NAME	COMMON NAME	SPEC	NATIVE	DROUGHT	QTY
GROUNDCOVERS						
EL	<i>Emodia littoralis</i>	Golden Creeper	1 GAL @ 18" OC	*	*	1310
MULCH						
	Mulch	Pine Straw	2095 SQ FEET			

PLANT SYMBOL

- EL

GOLDEN CREEPER
- GENERAL PLANTING AREA
- PLANTING BED

GREEN ROOF COVERAGE

ROOF AREA	SQ. FEET
GREEN AREA	2339.5
ROOF	2339.5
TOTAL ROOF AREA	4679.46

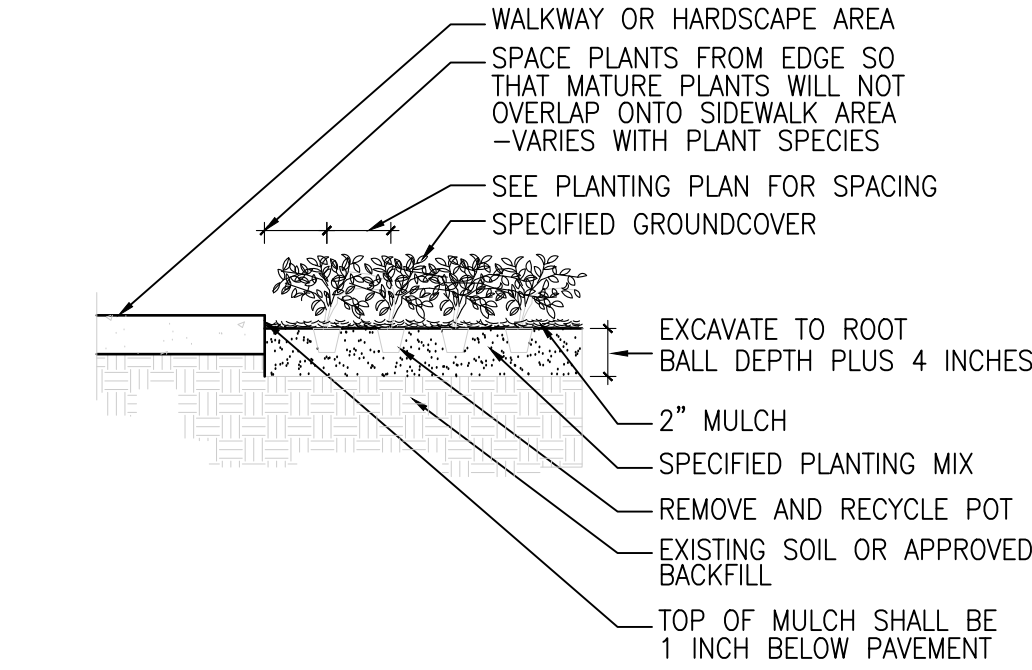

GROUNDCOVER EDGE PLANTING CONDITION  
SCALE: N.T.S.

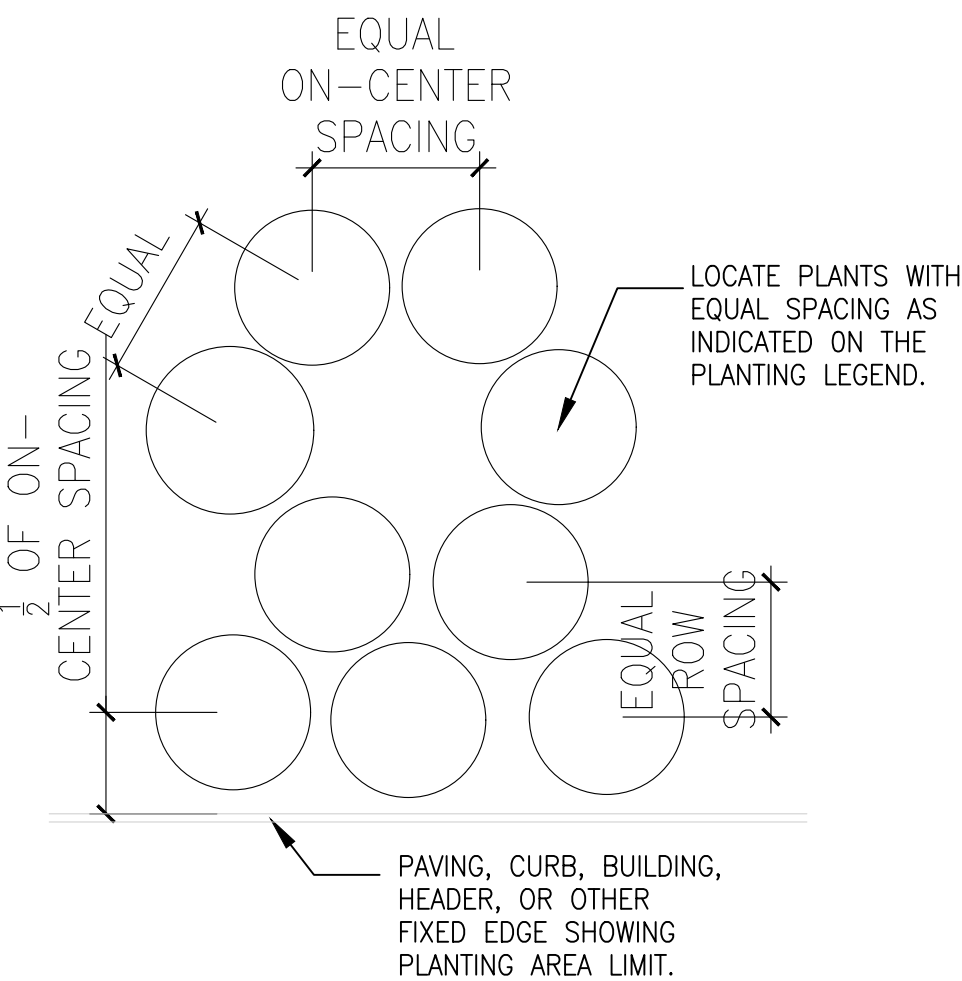

TYP SHRUB SPACING DETAIL

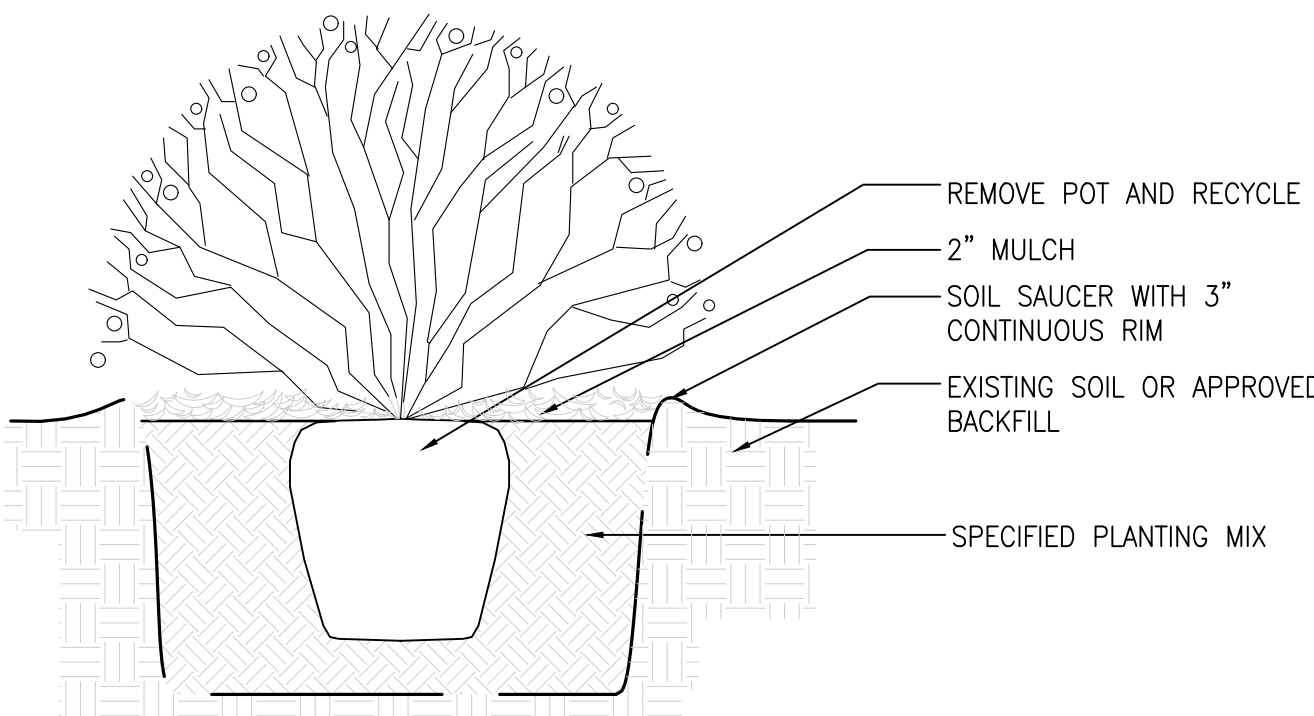

TYP SHRUB PLANTING DETAIL  
SCALE: N.T.S.

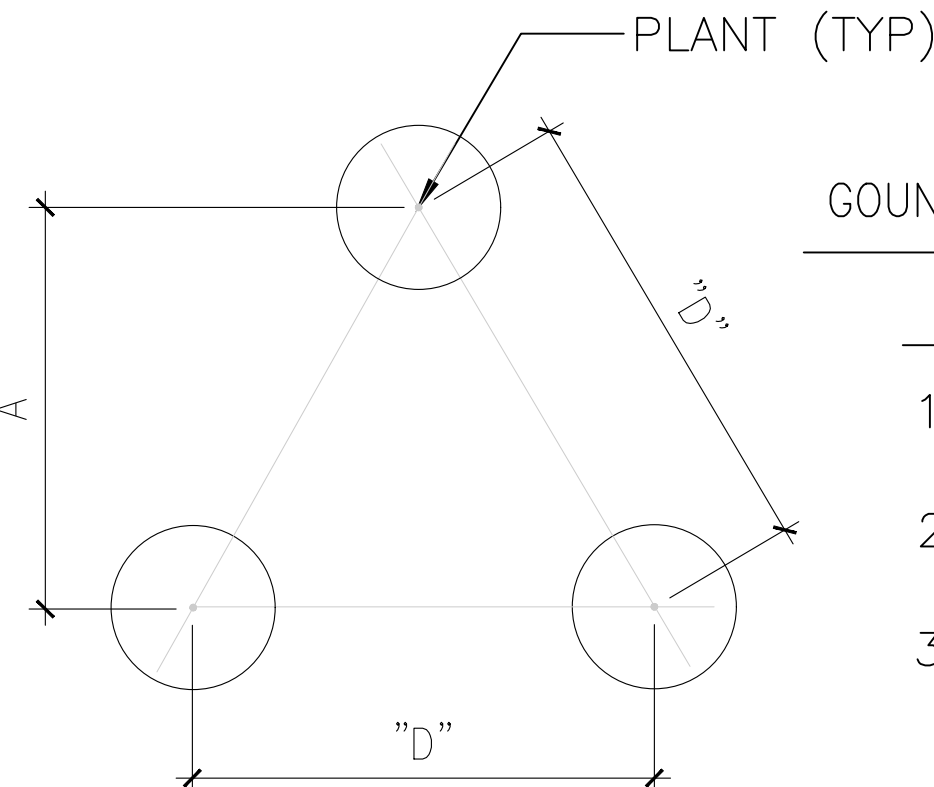

TYP TRIANGULAR PLANT SPACING CHART FOR GROUNDCOVERS  
SCALE: N.T.S.

GROUNDCOVER & PERENNIAL SPACING	
"D"	"A"
18" O.C.	15" O.C.
24" O.C.	21" O.C.
36" O.C.	31" O.C.

ALTON ROAD  
FLORIDA STATE ROAD 907

- 1
- 2
- 3
- 4

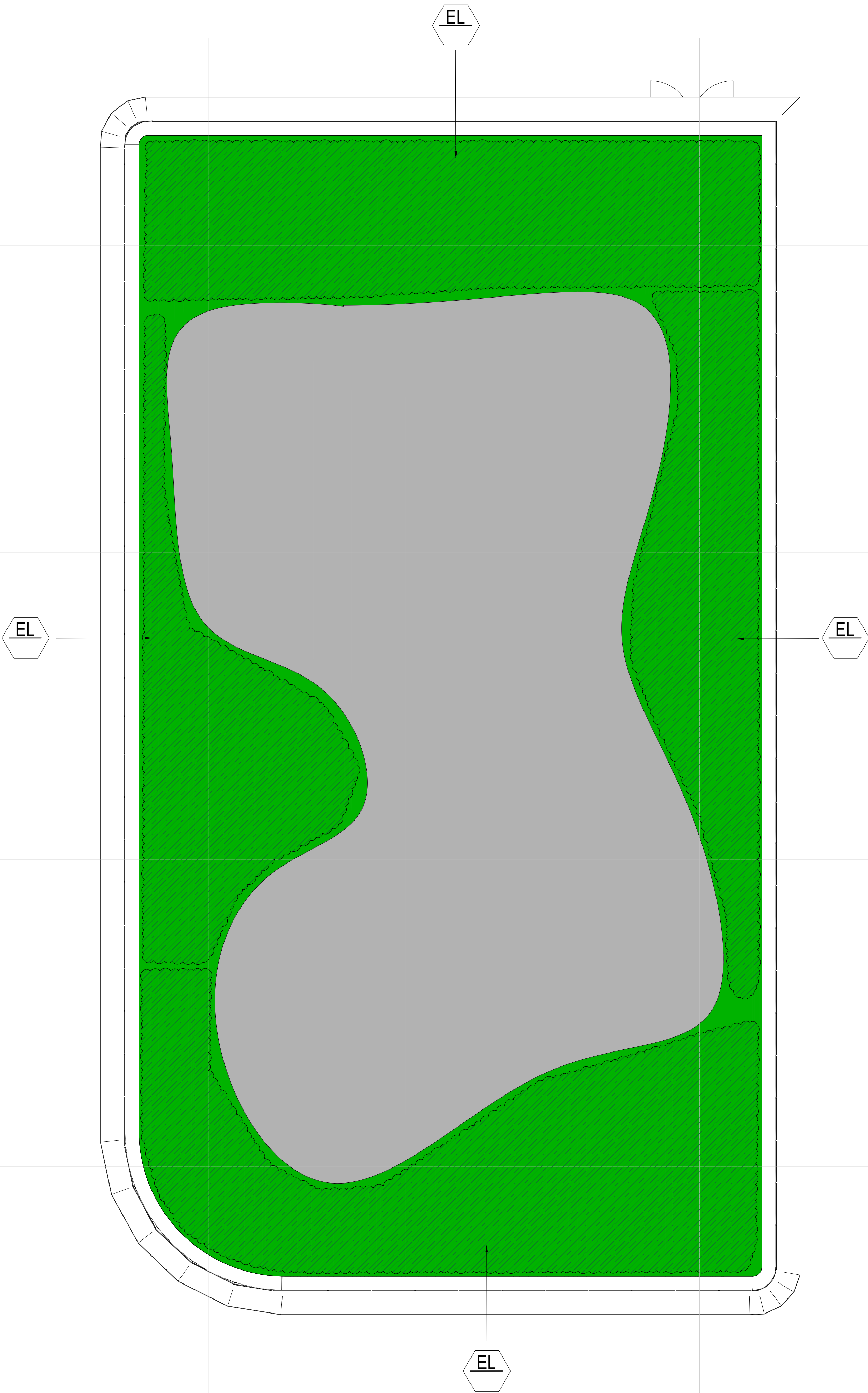

OVERALL ROOFTOP PLAN  
Scale: 3/32" = 1'-0"

VFD

VINCENT FILIGENZI DESIGN

LANDSCAPE ARCHITECTURE | PLANNING | APPLICATIONS

LANDSCAPE ARCHITECT

FL RLA LIC. #6667191

9822 NE 2ND AVE SUITE #10

MIAMI SHORES, FL 33138

P. 786.346.8009

www.VincentFiligenzi.com

PROFESSIONAL SEAL:

SEAL:

VINCENT A. FILIGENZI

LA #6667191

NOTE:

These architectural drawings and plans are prepared by the architect or its employee, architect, VFD INC. These drawings and plans shall not be reproduced for use by any individual or entity or any other project without the express written permission.

2ND LEVEL COMMERCIAL

TENANT IMPROVEMENT

1801 ALTON ROAD

MIAMI BEACH, FLORIDA 33139

SHEET ISSUE:

REV. #    DATE    DESCRIPTION

DRAWN BY: SJ  
CHECKED BY: VF  
DATE: 09.12.2024

DISCIPLINE / SHEET TITLE:

ROOFTOP PLAN

SHEET NUMBER:

LP-1.2