

- EXISTING TREE OUTSIDE PROPERTY LINE
- NEW TREE
- NEW PALM
- HEDGE
- SHRUBS & GROUNDCOVERS
- SOD

GRAPHIC SCALE
NORTH 0' 10' 20' 30'

Sunshine State
One Call

Know what's below.
Call before you dig.

RESERVED FOR CITY USE

ANDSTUDIO
ARCHITECTURE+DESIGN
2420 SW 27TH AVE, SUITE 3
MIAMI, FL 33145
WWW.ANDSTUDIO.DESIGN
FIRM LICENSE #AA26003820

PROJECT LOCATION
424 W DILIDO DRIVE | MIAMI BEACH | FL | 33139

PROJECT CLIENT/OWNER:
424 W DILIDO DRIVE LLC

ARCHITECT:
DAVID SCHWADE, RA/AIA, LICENSE # AR97772
DAKOTA HENDON, AIA, LICENSE #AR98269

INTERIOR DESIGNER
BEA INTERIORS DESIGN
6301 BISCAYNE BOULEVARD, SUITE 103, MIAMI, FL 33138

LANDSCAPE ARCHITECT:

ANDRES MONTERO
LANDSCAPE ARCHITECTURE
2300 E. OAKLAND PARK BLVD, SUITE 300
Fort Lauderdale, FL 33306
SIGNATURE / DATE / SEAL
ANDRES MONTERO, PLA, ASLA

STATE OF FLORIDA
REGISTRATION LA6666973
ALL DESIGNS AND DETAILS ON THIS DRAWING ARE THE PROPERTY OF ANDRES MONTERO LANDSCAPE ARCHITECTURE, LLC, AND SHALL NOT BE USED, COPIED OR REPRODUCED WITHOUT WRITTEN PERMISSION FROM ANDRES MONTERO LANDSCAPE ARCHITECTURE, LLC.

CONFIDENTIALITY NOTICE:
ALL IDEAS, DESIGNS, ARRANGEMENTS AND PLANS INDICATED OR REPRESENTED BY THIS DRAWING ARE OWNED BY AND PROPERTY OF THE ARCHITECT AND WERE CREATED, EVOLVED AND DEVELOPED FOR USE ON AND IN CONNECTION WITH THE SPECIFIC PROJECT. NONE OF SUCH IDEAS, DESIGNS, ARRANGEMENTS OR PLANS SHALL BE USED BY OR DISCLOSED TO ANY PERSON, FIRM OR CORPORATION FOR ANY PURPOSE WHATSOEVER WITHOUT WRITTEN PERMISSION OF THE ARCHITECT.

PROJECT NAME:
WEST DILIDO RESIDENCE

DATE: 1/5/2025
DRAWN BY: AEM/MEP

SHEET ISSUE / REVISION LOG

SHEET TITLE:
**ILLUSTRATIVE
LANDSCAPE PLAN**

SHEET NO:
L-00

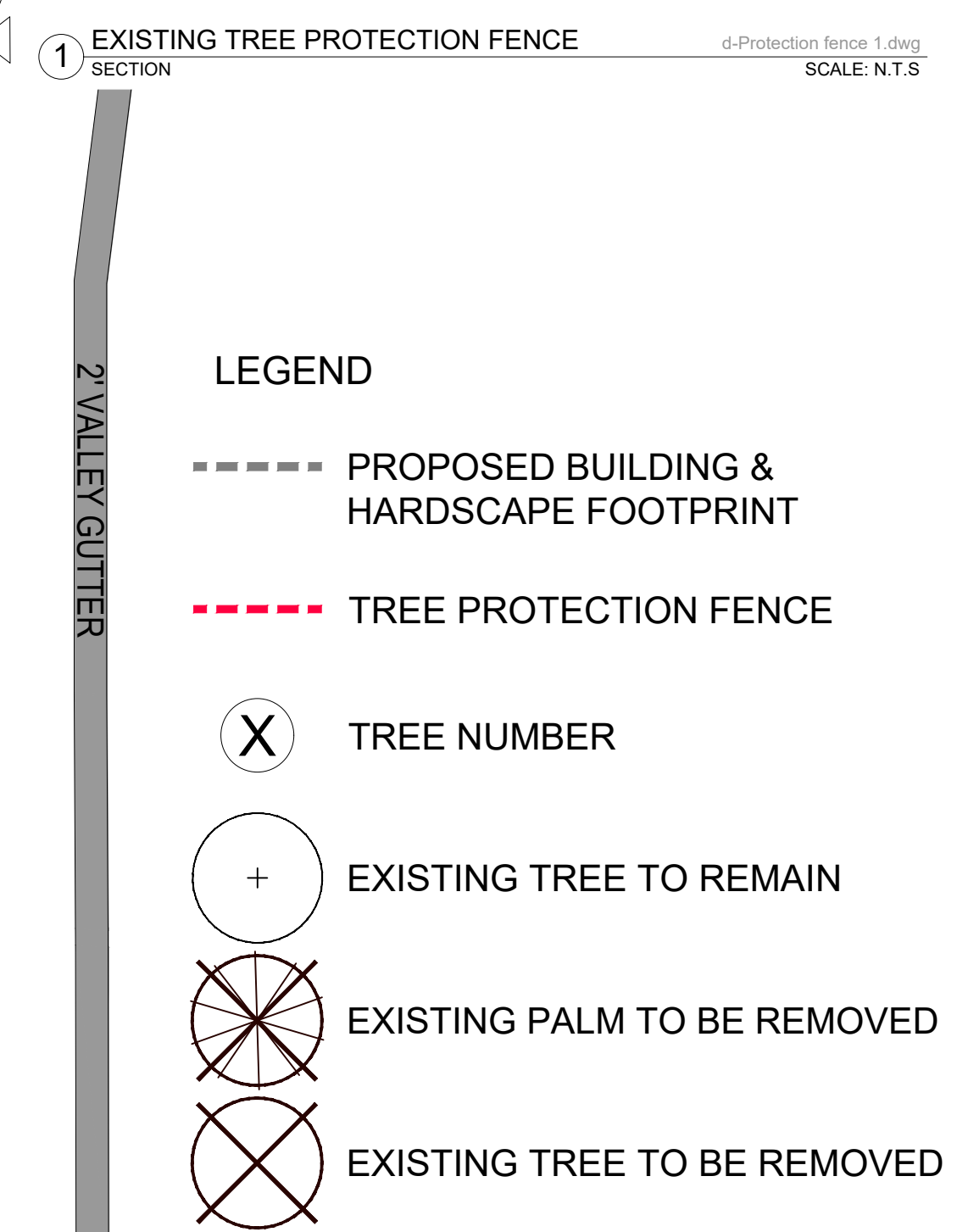
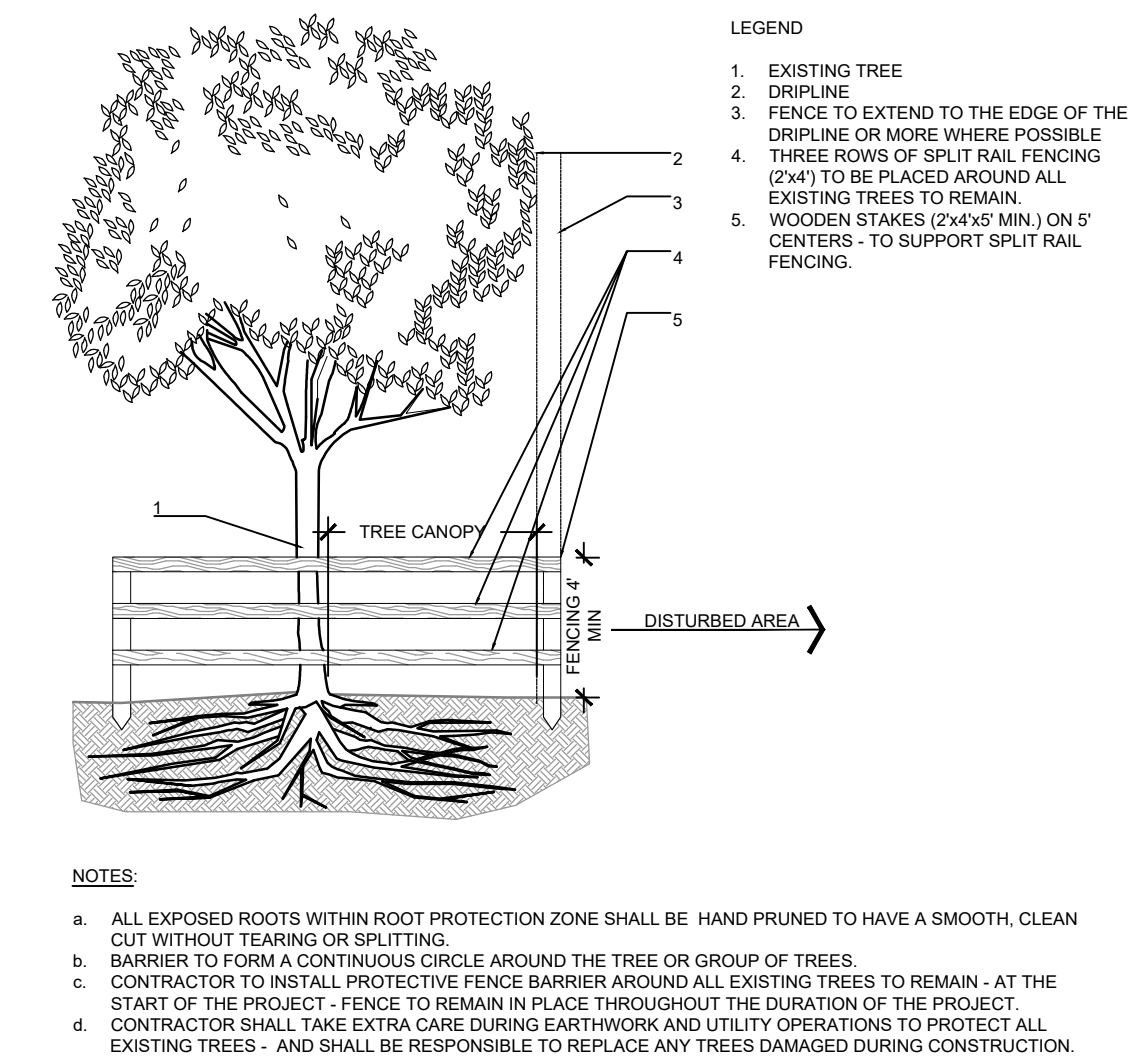
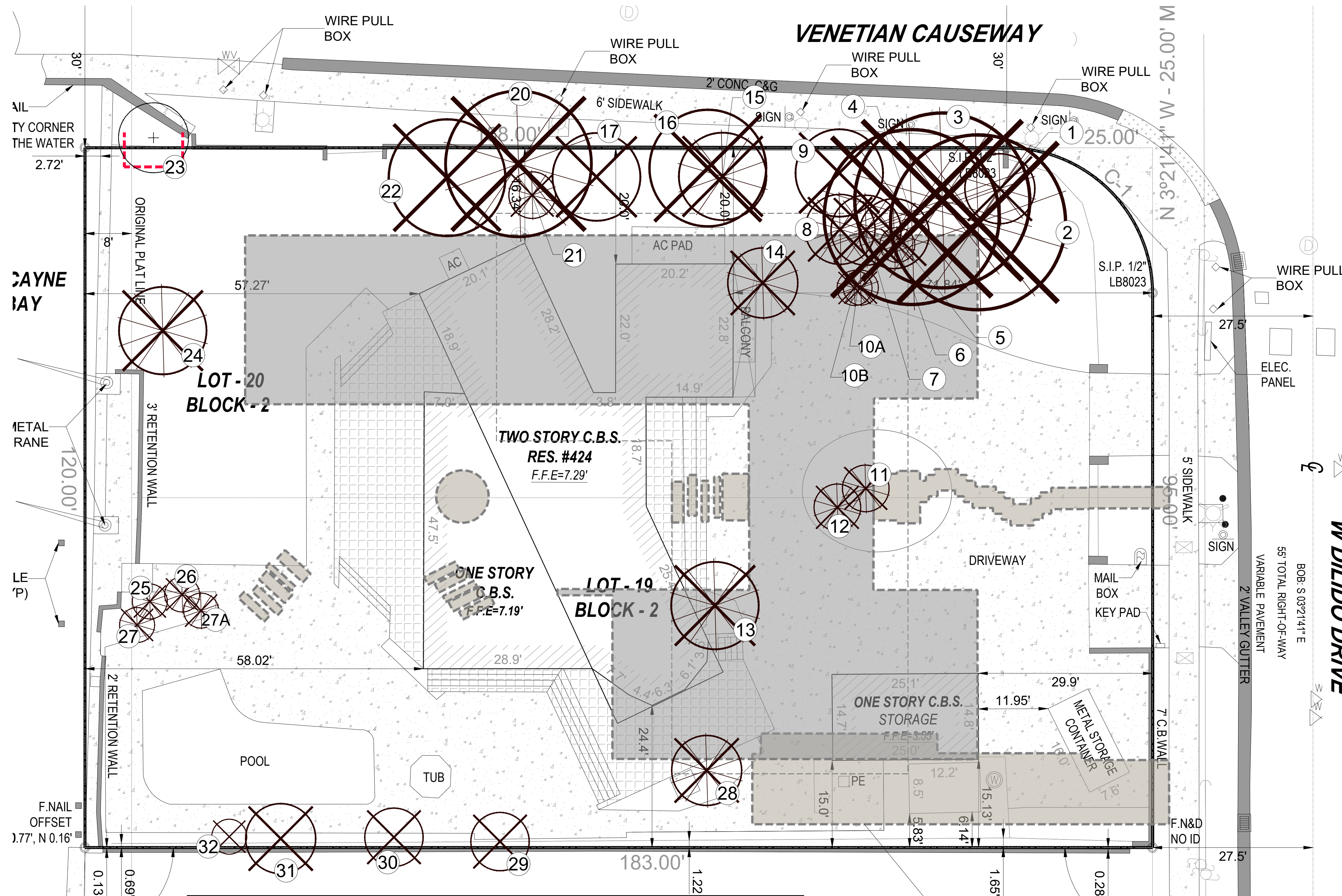

TREE DISPOSITION TABLE								
TREE #	BOTANICAL NAME	COMMON NAME	DBH (in)	HEIGHT (ft)	SPREAD (ft)	CRZ/TPZ (ft)	CONDITION	STATUS
1	Livistona chinensis	Chinese Fan Palm	9	12	12	4	Fair	REMOVE
2	Livistona chinensis	Chinese Fan Palm	27	30	30	6	Fair	REMOVE
3	Livistona chinensis	Chinese Fan Palm	27	30	30	6	Fair	REMOVE
4	Livistona chinensis	Chinese Fan Palm	25	28	30	6	Fair	REMOVE
5	Livistona chinensis	Chinese Fan Palm	10	30	12	5	Fair	REMOVE
6	Ptychosperma elegans	Solitaire Palm	3	28	6	3	Fair	REMOVE
7	Livistona chinensis	Chinese Fan Palm	9	30	12	5	Fair	REMOVE
8	Livistona chinensis	Chinese Fan Palm	11	30	12	5	Fair	REMOVE
9	Eugenia uniflora	Surinam Cherry	9	15	15	5	Fair	REMOVE
10A	Ptychosperma elegans	Solitaire Palm	4	28	6	4	Fair	REMOVE
10B	Ptychosperma elegans	Solitaire Palm	4	28	6	4	Fair	REMOVE
11	Phoenix reclinata	Senegal Date Palm	4	20	8	4	Fair	REMOVE
12	Phoenix reclinata	Senegal Date Palm	5	18	8	4	Fair	REMOVE
13	Ravstanea regia	Royal Palm	12	35	15	5	Poor	REMOVE
15	Livistona chinensis	Chinese Fan Palm	8	20	15	5	Fair	REMOVE
16	Prunus ilicifolia	Hollyleaf Cherry	12	18	20	6	Fair	REMOVE
17	Prunus ilicifolia	Hollyleaf Cherry	9	15	15	6	Fair	REMOVE
20	Ravenala madagascariensis	Traveler's Palm	45	35	25	10	Fair	REMOVE
21	Ptychosperma elegans	Solitaire Palm	4	25	8	4	Fair	REMOVE
22	Schefflera arboricola	Umbrella tree	multi	20	20	/	Invasive/Prohibited	REMOVE
23	Conocarpus erectus	Green Buttonwood	9	22	12	5	Poor	REMAIN
24	Livistona chinensis	Chinese Fan Palm	8	15	15	4	Fair	REMOVE
25	Ptychosperma elegans	Solitaire Palm	3	16	6	3	Poor	REMOVE
26	Ptychosperma elegans	Solitaire Palm	3	22	6	3	Poor	REMOVE
27	Ptychosperma elegans	Solitaire Palm	3	12	6	3	Poor	REMOVE
27A	Ptychosperma elegans	Solitaire Palm	3	18	6	3	Poor	REMOVE
28	Adonidia merrillii	Christmas Palm	5	18	8	3	Poor	REMOVE
29	Dracaena ssp.	Dragon Tree	22	15	10	3	Poor	REMOVE
30	Ficus benjamina	Weeping Fig	6	12	10	3	Invasive/Prohibited	REMOVE
31	Ficus benjamina	Weeping Fig	5	10	12	3	Invasive/Prohibited	REMOVE
32	Dracaena ssp.	Dragon Tree	4	12	6	3	Poor	REMOVE

- NOTES:
- THE APPROXIMATE LOCATION, SIZE AND CONDITIONS OF THE EXISTING TREES/PALMS WITHIN THE PROJECT LIMITS HAS BEEN COLLECTED FROM THE EXISTING TREE SURVEY PREPARED BY: SURVEY PROS, INC 4348 SW 74th AVENUE, MIAMI, FL 33155 Ph: 305.767.68022 AND THE ARBORIST REPORT PREPARED BY: TREAGE, LLC SEBASTIAN KOERBER. BOARD CERTIFIED MASTER ARBORIST ISA GA-0009B Ph: 305.606.5797.
 - CONTRACTOR SHALL OBTAIN A TREE REMOVAL PERMIT PRIOR TO THE REMOVAL OF TREES/PALMS PROPOSED TO BE REMOVED.
 - CONTRACTOR TO REMOVE ALL EXISTING SHRUBS AND GROUNDCOVERS UNLESS NOTED IN LANDSCAPE PLAN AS EXISTING TO REMAIN.
 - EXISTING TREES TO REMAIN TO BE PROTECTED DURING CONSTRUCTION - SEE EXISTING TREE PROTECTION FENCE DETAIL # 1- SHEET L-01

GRAPHIC SCALE
NORTH 0' 10' 20' 30'

Sunshine State
One Call

Know what's below.
Call before you dig.

811

RESERVED FOR CITY USE

ANDSTUDIO

ARCHITECTURE+DESIGN

2420 SW 27TH AVE, SUITE 3
MIAMI, FL 33145
WWW.ANDSTUDIO.DESIGN
FIRM LICENSE #AA26003820

PROJECT LOCATION

424 W DILIDO DRIVE | MIAMI BEACH | FL | 33139

PROJECT CLIENT/OWNER:

424 W DILIDO DRIVE LLC

ARCHITECT:

DAVID SCHWADE, RA/AIA, LICENSE # AR97772
DAKOTA HENDON, AIA, LICENSE #AR98269

INTERIOR DESIGNER

BEA INTERIORS DESIGN
6301 BISCAYNE BOULEVARD, SUITE 103, MIAMI, FL 33138

LANDSCAPE ARCHITECT:

ANDRES MONTERO
LANDSCAPE ARCHITECTURE
2300 E. OAKLAND PARK BLVD. SUITE 300
Fort Lauderdale, FL 33306

SIGNATURE / DATE / SEAL
ANDRES MONTERO, PLA, ASLA

STATE OF FLORIDA
REGISTRATION LA6666973

ALL DESIGNS AND DETAILS ON THIS DRAWING ARE THE PROPERTY OF ANDRES MONTERO LANDSCAPE ARCHITECTURE, LLC, AND SHALL NOT BE USED, COPIED OR REPRODUCED WITHOUT WRITTEN PERMISSION FROM ANDRES MONTERO LANDSCAPE ARCHITECTURE, LLC.

CONFIDENTIALITY NOTICE:

ALL IDEAS, DESIGNS, ARRANGEMENTS AND PLANS INDICATED OR REPRESENTED BY THIS DRAWING ARE OWNED BY AND PROPERTY OF THE ARCHITECT AND WERE CREATED, EVOLVED AND DEVELOPED FOR USE ON AND IN CONNECTION WITH THE SPECIFIC PROJECT. NONE OF SUCH IDEAS, DESIGNS, ARRANGEMENTS OR PLANS SHALL BE USED BY OR DISCLOSED TO ANY PERSON, FIRM OR CORPORATION FOR ANY PURPOSE WHATSOEVER WITHOUT WRITTEN PERMISSION OF THE ARCHITECT.

PROJECT NAME:

WEST DILIDO RESIDENCE

DATE: 1/5/2025 DRAWN BY: AEM/MEP

SHEET ISSUE / REVISION LOG

NO	DATE	DESCRIPTION

SHEET TITLE:

TREE DISPOSITION PLAN

SHEET NO:

L-01

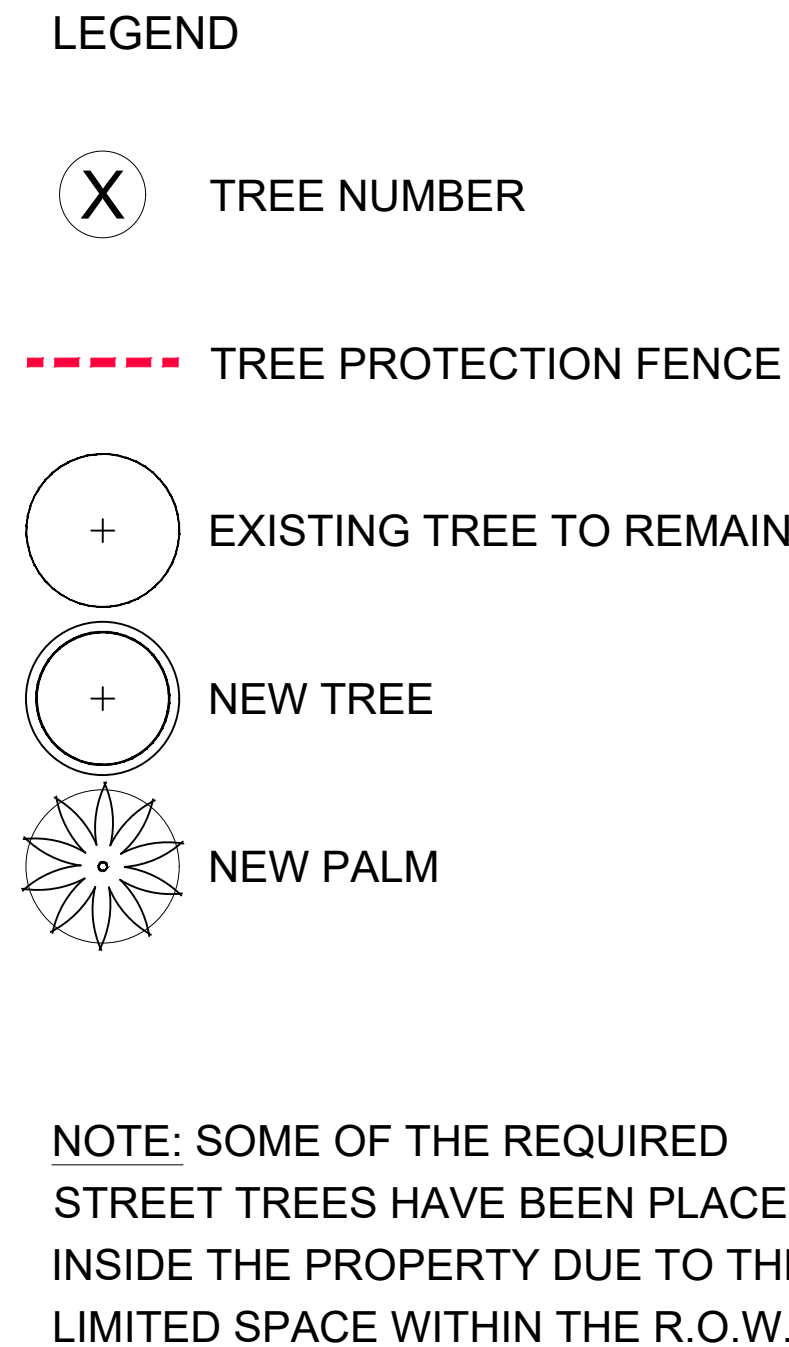

1. ROOT BARRIERS SHALL BE INSTALLED AT ALL TREES/PALMS THAT ARE PLANTED WITHIN FIVE (5) FEET OF UNDERGROUND UTILITIES OR UTILITY EASEMENT. SEE DETAIL #3 ON SHEET L-04.
2. ALL LANDSCAPE AREAS SHALL BE PROVIDED WITH A FULLY AUTOMATICALLY OPERATED IRRIGATION SYSTEM. IRRIGATION SYSTEM SHALL PROVIDE COMPLETE COVERAGE OF ALL PLANT MATERIALS. THIS SYSTEM SHOULD HAVE RAIN SENSOR AND SHOULD AUTOMATICALLY SHUT OFF WHEN RAINING.
4. ALL HEDGE, SHRUBS OR GROUNDCOVERS LOCATED WITHIN ANY CLEAR SIGHT TRIANGLES MUST BE MAINTAINED AT LESS THAN TWENTY FOUR (24) INCHES IN HEIGHT
5. THE SAFE SIGHT DISTANCE TRIANGLES AREA SHALL NOT CONTAIN OBSTRUCTIONS TO CROSS-VISIBILITY AT A HEIGHT BETWEEN TWO (2) FEET AND SIX (6) FEET ABOVE PAVEMENT.

TREE MITIGATION TABLE - LIST OF TREES TO BE MITIGATED			
TREE #	BOTANICAL NAME	COMMON NAME	DBH (inches)
9	<i>Eugenia uniflora</i>	Surinam Cherry	9
16	<i>Prunus ilicifolia</i>	Hollyleaf Cherry	12
17	<i>Prunus ilicifolia</i>	Hollyleaf Cherry	9
22	<i>Drosera</i> spp.	Dragon Tree	22
		Total tree DBH to be mitigated	62" DBH
TOTAL NUMBER OF REPLACEMENT TREES REQUIRED (40" DBH)			20 Trees (2" DBH x 6' spread in Canopy x 12" Ht) or 10 Trees (4" DBH x 8' spread in Canopy x 16" Ht.)
PALMS TO MITIGATE			
1	<i>Livistona chinensis</i>	Chinese Fan Palm	
2	<i>Livistona chinensis</i>	Chinese Fan Palm	
3	<i>Livistona chinensis</i>	Chinese Fan Palm	
4	<i>Livistona chinensis</i>	Chinese Fan Palm	
5	<i>Livistona chinensis</i>	Chinese Fan Palm	
7	<i>Livistona chinensis</i>	Chinese Fan Palm	
8	<i>Livistona chinensis</i>	Chinese Fan Palm	
13	<i>Roystonea regia</i>	Royal Palm	
15	<i>Livistona chinensis</i>	Chinese Fan Palm	
20	<i>Ravennia madagascariensis</i>	Traveler's Palm	
24	<i>Livistona chinensis</i>	Chinese Fan Palm	
		Total Palms to be mitigated	11
TOTAL NUMBER OF REPLACEMENT TREES REQUIRED FOR PALM MITIGATION (22" DBH)			11 Trees (2" DBH x 6' spread in canopy x 12" Ht.)
NEW TREES TO MITIGATE			
		Total DBH to be mitigated	62" DBH
3	<i>Burretia almitana</i>	Cumbo Limbo	16" Ht. 5" DBH, 8" Sprd. 4' CT. Std.
3	<i>Conocarpus erectus</i>	Green Buttonwood	16" ht. 3" DBH, 6" Spdrt. 6'CT. Std.
3	<i>Cespedium grandifolium</i>	Bridalveil	16" ht. 3" DBH, 6" Spdrt. 6' CT. Std.
6	<i>Coconcoloba unifera</i>	Seagrape Tree	16" ht. 4.5" DBH, 8" Spdrt. 6' CT. Std
1	<i>Conocarpus erectus "telfordii"</i>	Silver Buttonwood	12" ht. 2" DBH, 6" Spdrt. 6' CT. Std.
		Total new tree DBH to mitigate removed trees/palms	62" DBH
MITIGATION SCHEDULE			
Note: Any tree mitigation schedule shall be addressed by a temporary contribution to the city's tree trust fund by the property owner			

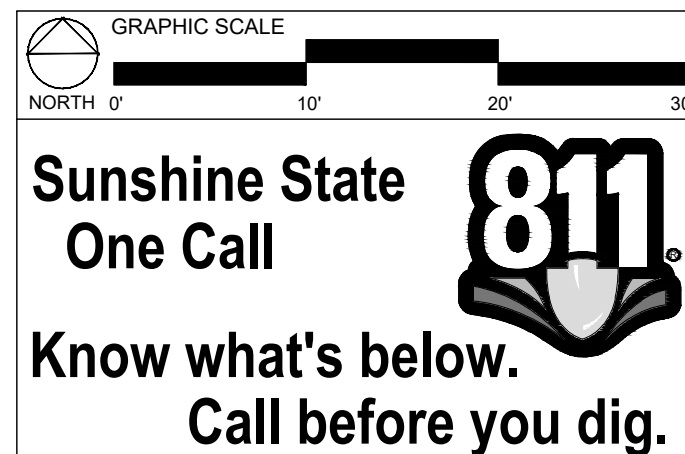

L-02

102

Acres	0.48
REQ/RET/ ALLOWED	PROVIDED
5250	14117
5250	14117
5250	14117
7059	6755
2	2
3	3
15	35
11	39
18	35
15	15
415	751
376	411
42	51
26	49

GENERAL NOTES

- Before construction begins, the Landscape Contractor is responsible for locating all underground utilities and must avoid damaging any services during construction. If any damage occurs by fault of the Contractor, the necessary repairs must take place at the Landscape Contractor's expense and under the supervision of the Owner's representative.
- All proposed trees and plant materials shall be graded as Nursery Grade Florida No. 1 or better as outlined by the Florida Department of Agriculture and Consumer Services, Division of Plant Industry "Grades and standards for Nursery Plants", most current edition. All planting shall be done in accordance with the Florida Nurserymen's and Grower's Association approved practices.
- In addition to these requirements the Landscape Contractor shall comply with all local landscape codes and requirements as part of this base bid and contract in order to satisfy the review and approval of the governing agency.
- All screening hedges shall be planted and maintained in a way that they form a continuous visual screen. Screening hedges at VUA to be maintained at a minimum height of thirty (30) inches.
- All planting beds shall be excavated to a minimum depth of twenty-four (24") inches and backfilled with a suitable soil. All plant material shall be planted in planting soil that is delivered to the site in a loose, clean and friable condition. The planting soil shall be the approximate proportions as follows: 50% sand and 50% organic material consisting of native peat, well-decomposed sawdust, leaf mold and top soil. It shall provide a good pliable and thoroughly mixed medium with adequate aeration, drainage and water-holding capacity. It shall also be free of all extraneous debris, such as roots, stones, weeds, etc.
- All trees/palms and shrubs shall be fertilized with "Agriform" 20-10-5 planting tablets as per the manufacturers specifications at the time of installation and prior completion of pit backfilling also in conjunction with note #5. Tablets to be placed uniformly around the root mass at a depth that is between the middle and bottom of root mass at an application rate of: One (1) - 21 gram tablet for 1 gal container, two (2)- tablets for 3 gal container, three (3)- tablets for 5 gal container, four (4)-tablets for 7 gal container, three (3)-tablets for each 1/2 inch of tree caliper, and seven (7) tablets for palms. Ground Cover areas shall receive fertilization with "Ozmocote" time release fertilizer as per manufacturer's specification.
- All plant beds shall receive a 3" layer of organic mulch, which is to be watered-in after installation. Mulch should be at least six (6) inches away from any portion of a structure or tree trunk and three (3) inches away from the base of shrubs. Only environmental friendly mulch shall be approved, Cypress mulch shall not be accepted.
- All plant material shall be thoroughly watered in at the time of planting and until landscape material is established. No dry material shall be permitted.
- The plant material schedule is presented for the convenience of the Landscape Contractor. In the event of a discrepancy between the plan and the plant key, the plan shall prevail.
- Plants shall meet size, container, and spacing specifications. Any material not meeting specifications shall be removed and replaced at the contractor's expense.
- All tree and shrub locations shall be approved by Landscape Architect prior to planting.
- The Landscape Contractor shall grade planting beds, as required, to provide positive drainage and promote optimum plant growth.
- The Landscape Contractor shall be responsible for examining fully both the site and bid documents. Discrepancies in the documents or the actual site conditions shall be reported to the Landscape Architect in writing at the time of bidding or discovery. No account shall be made after contract completion for failure by the Landscape Contractor to report such condition or for errors on the part of the Landscape Contractor at the time of bidding.
- The Landscape Contractor shall be responsible for securing all necessary applicable permits and licenses to perform the work set forth in this plan set and the specifications.
- Plant material shall be bid as specified unless unavailable, at which time the Landscape Architect shall be notified in writing of intended changes.
- All questions concerning the plan set and/or specifications shall be directed to the Landscape Architect.
- There shall be no additions, deletions or substitutions without written approval of the Landscape Architect.
- The Landscape Contractor shall guarantee, in writing, plant survivability. Trees and palms for twelve (12) months, shrubs and groundcovers for ninety (90) days and sod for sixty (60) days from final acceptance by the Owner or Owner's representative.
- All dimensions to be field-checked by the Landscape Contractor prior to landscape material installation. Discrepancies shall be reported immediately to the Landscape Architect.
- All materials must be as specified on the landscape plan. If materials or labor do not adhere to specifications, they will be rejected by the Landscape Architect with proper installation carried out by the Landscape Contractor at no additional cost.
- Existing sod shall be removed as necessary to accommodate new plantings
- All existing trees on site shall be protected from damage during construction - See existing tree protection fence detail.
- Any existing landscape and hardscape areas that are unnecessarily disturbed during the landscape installation shall be restored to original conditions by the Landscape Contractor.
- The Landscape Contractor will be responsible for the collection, removal, and proper disposal of any and all debris generated during the installation of this project.
- All landscape areas to have a positive drainage away from buildings and structures. Finished grade of landscape areas to be at or below the grade of adjacent sidewalks, slabs or VUA
- All shade and medium trees installed within 5' of a public infrastructure shall utilize a root barrier system.

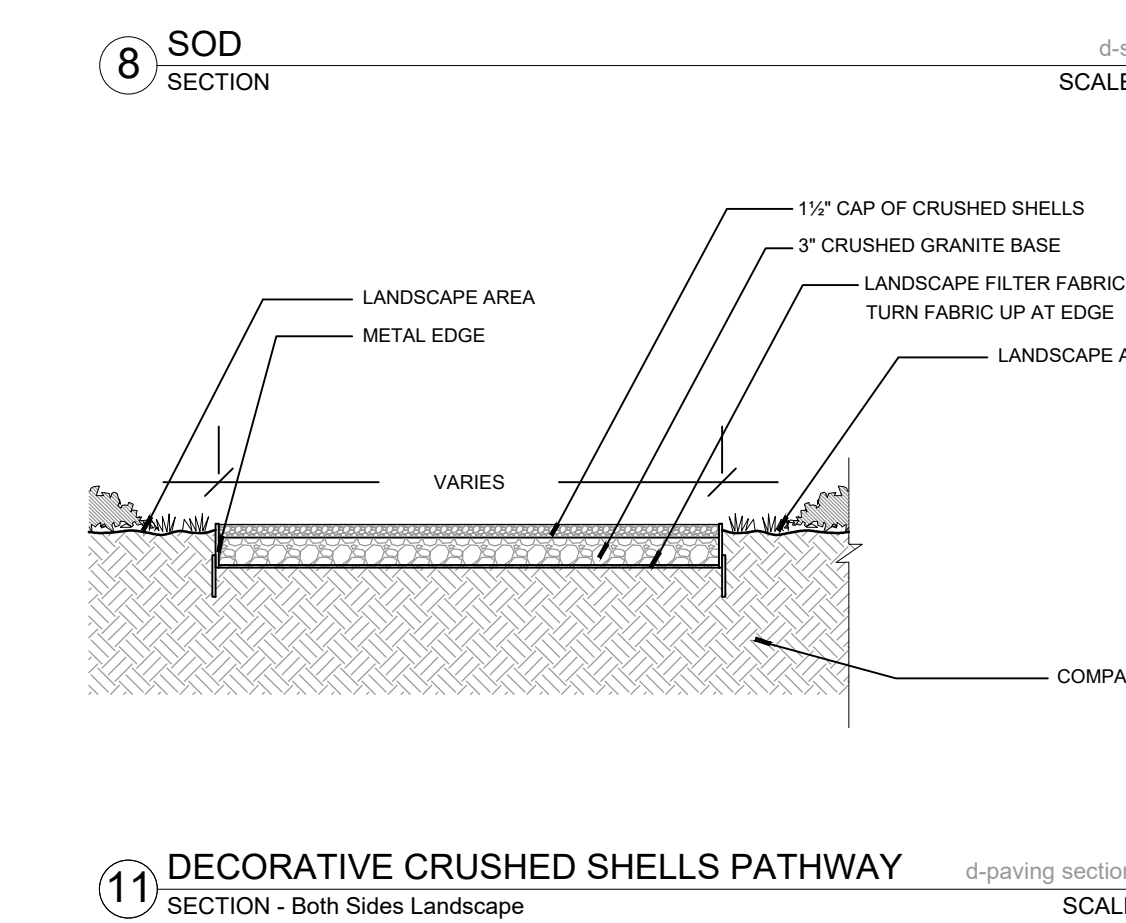
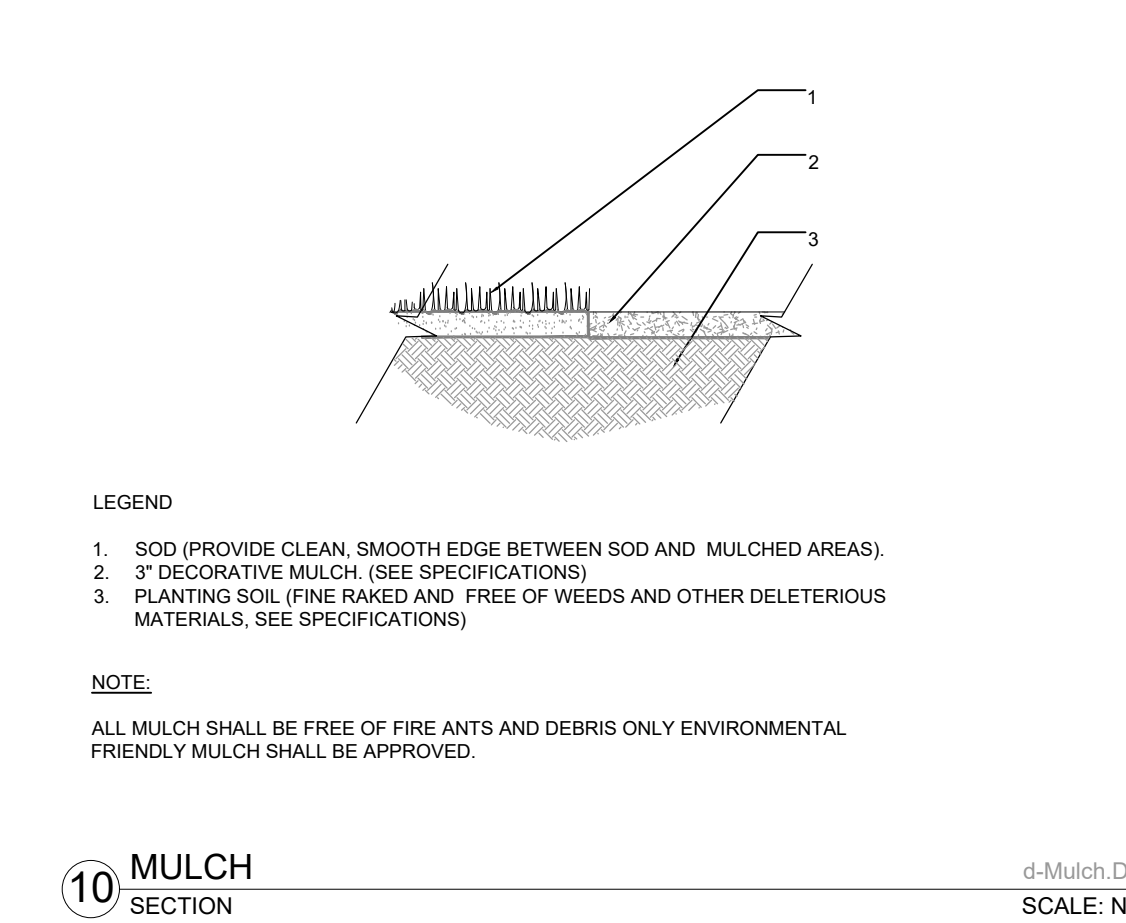
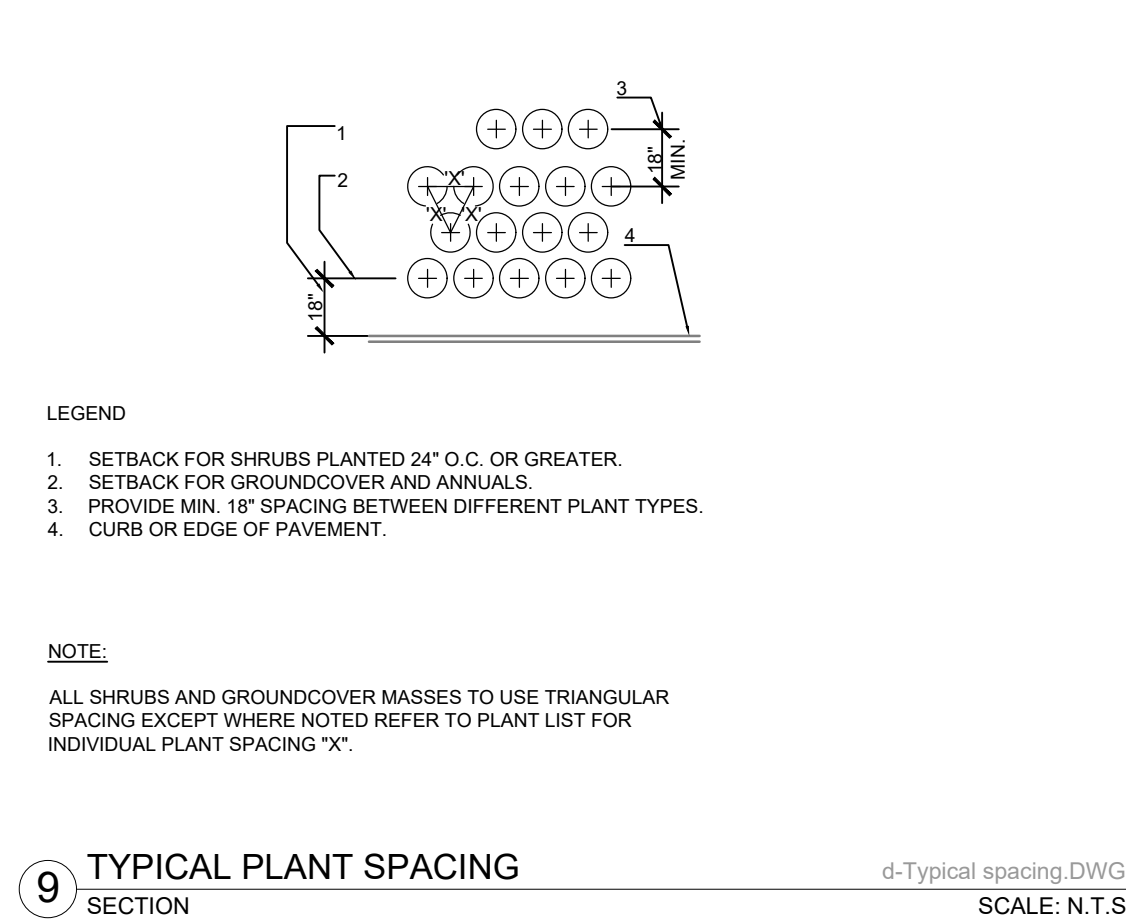
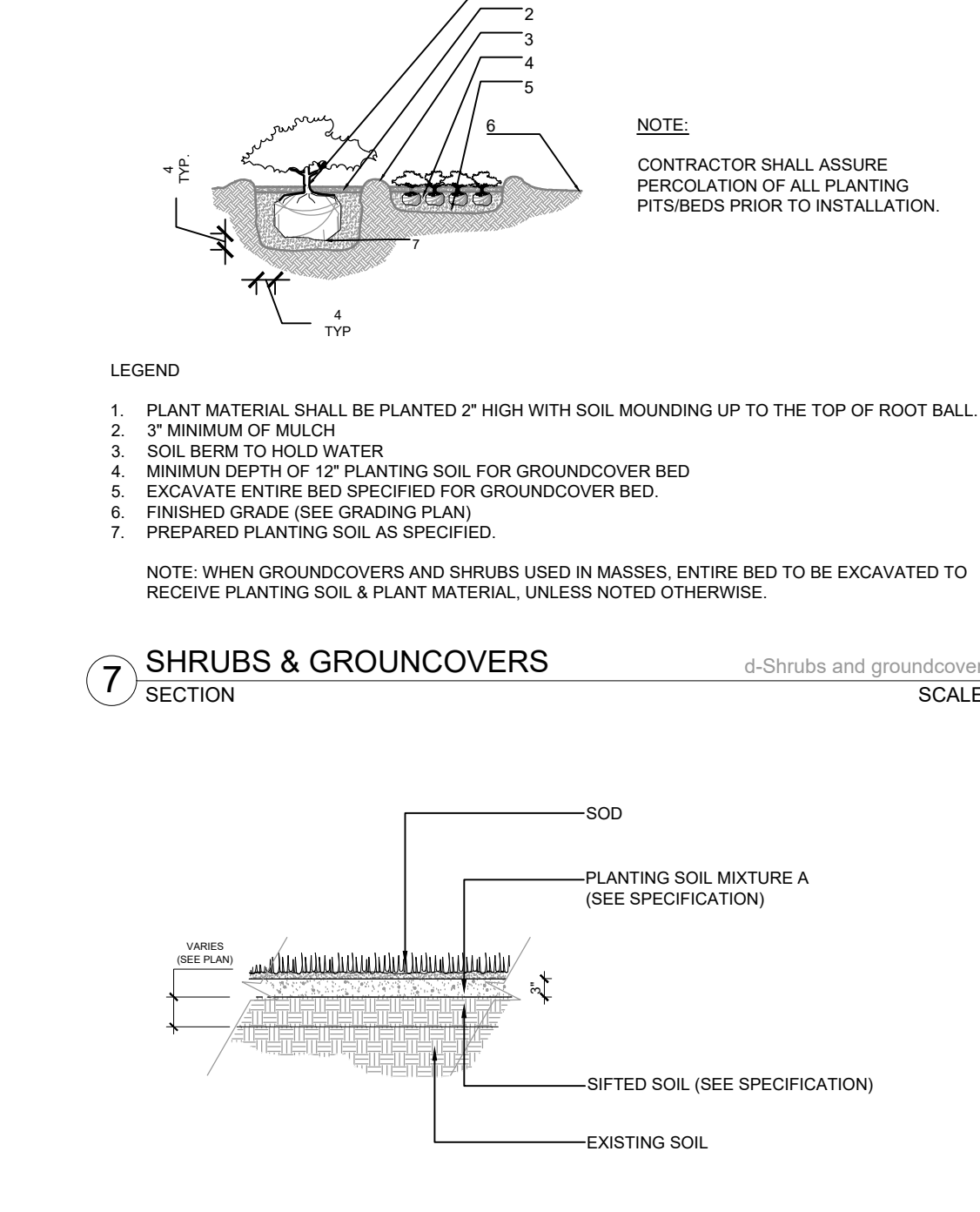
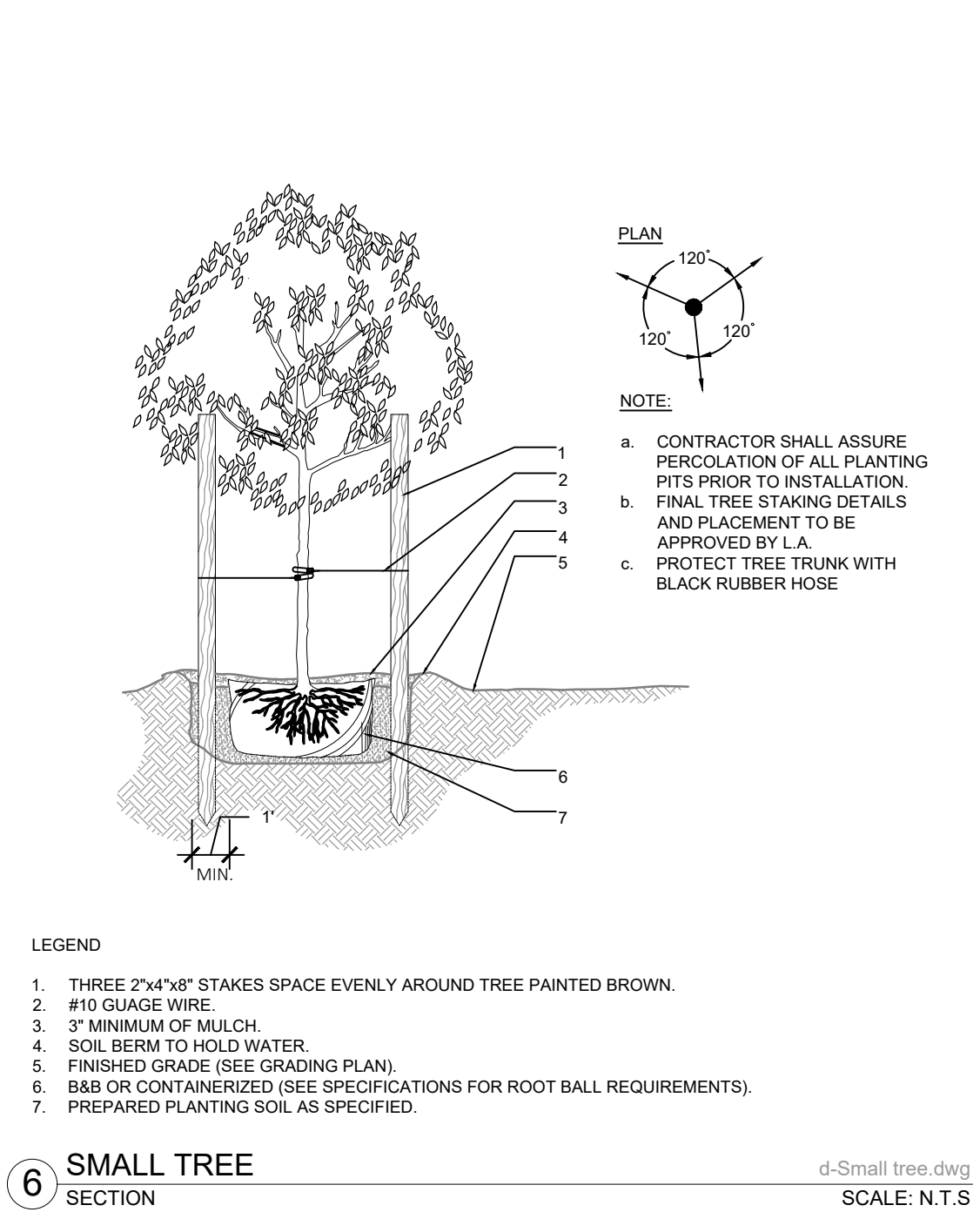
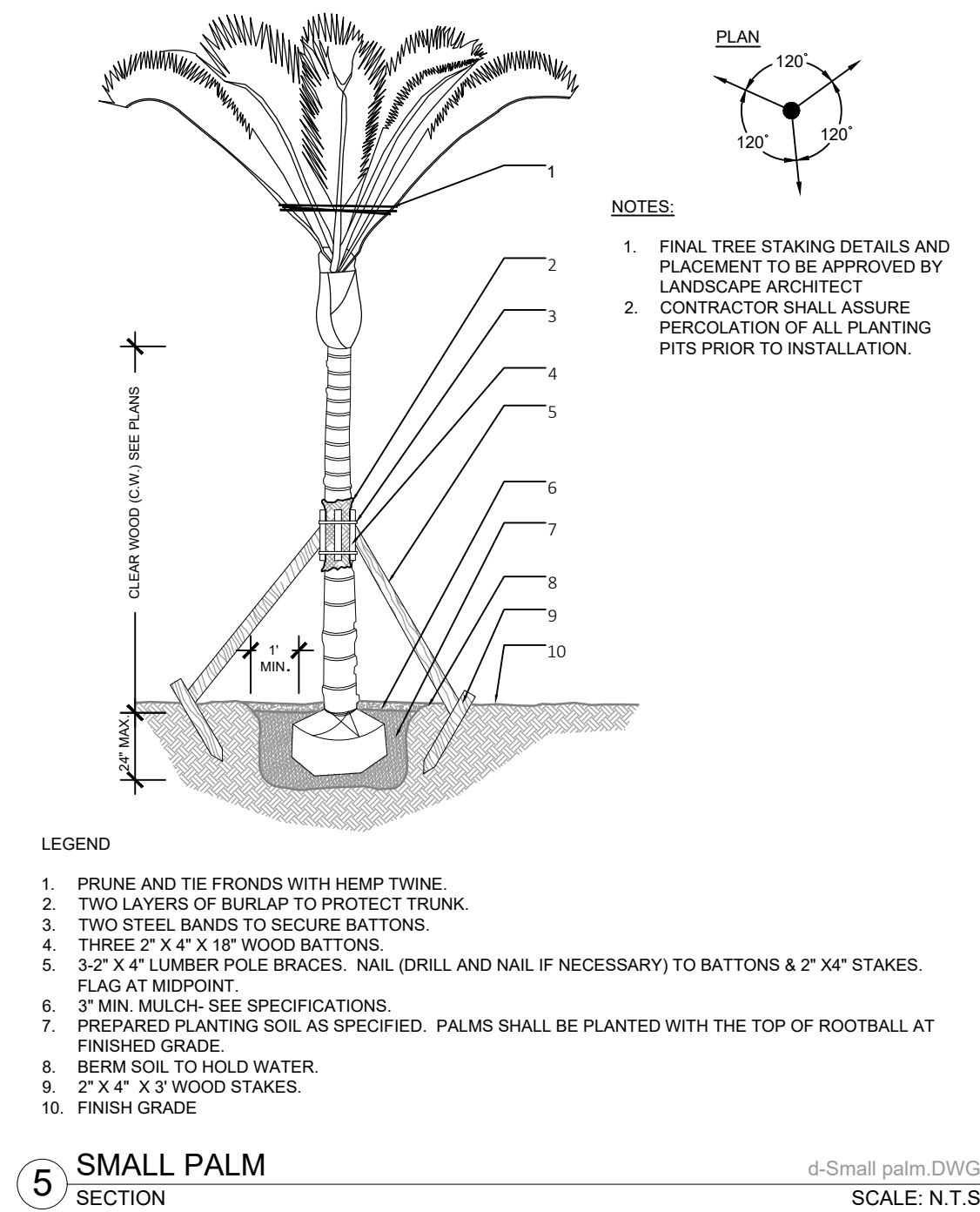
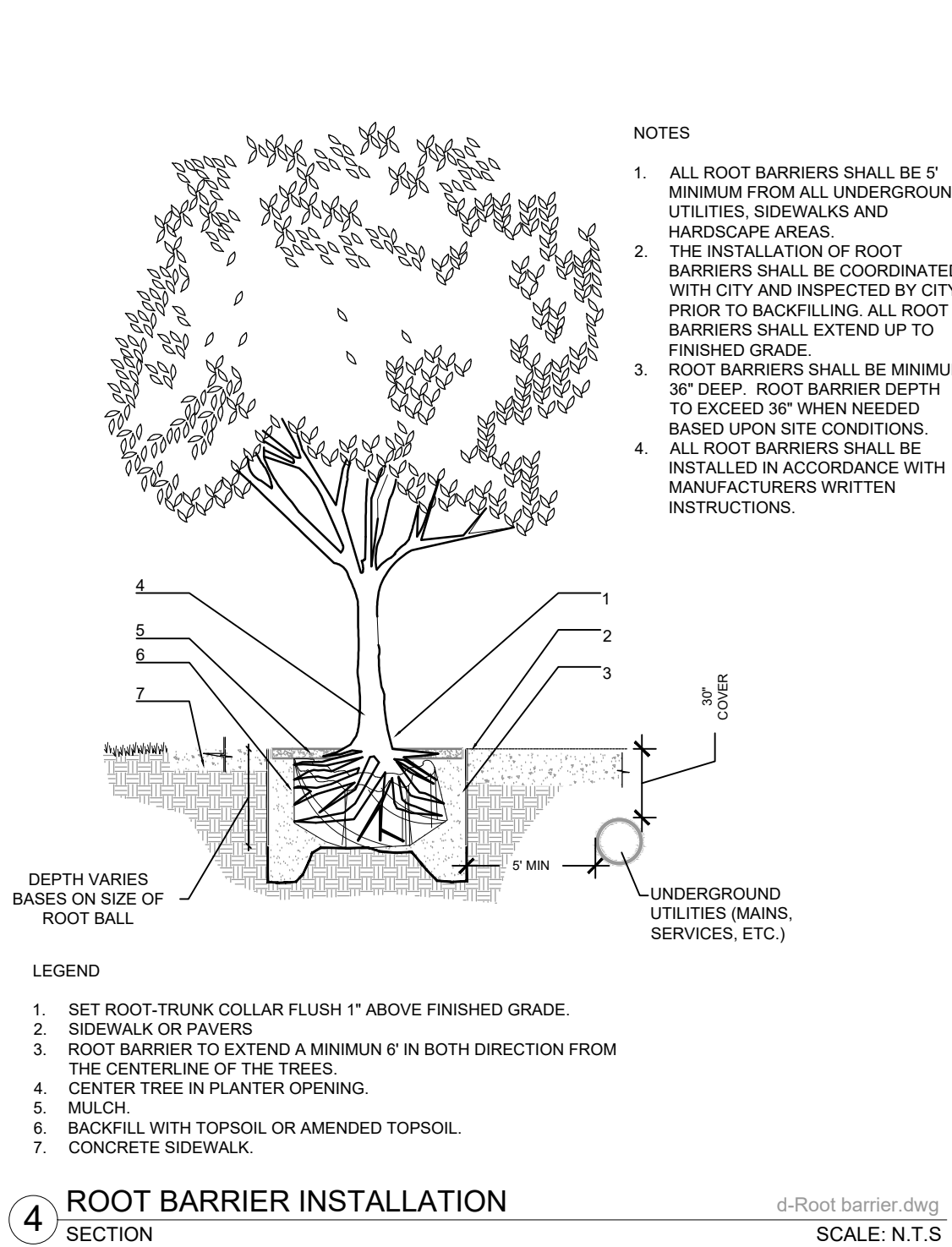
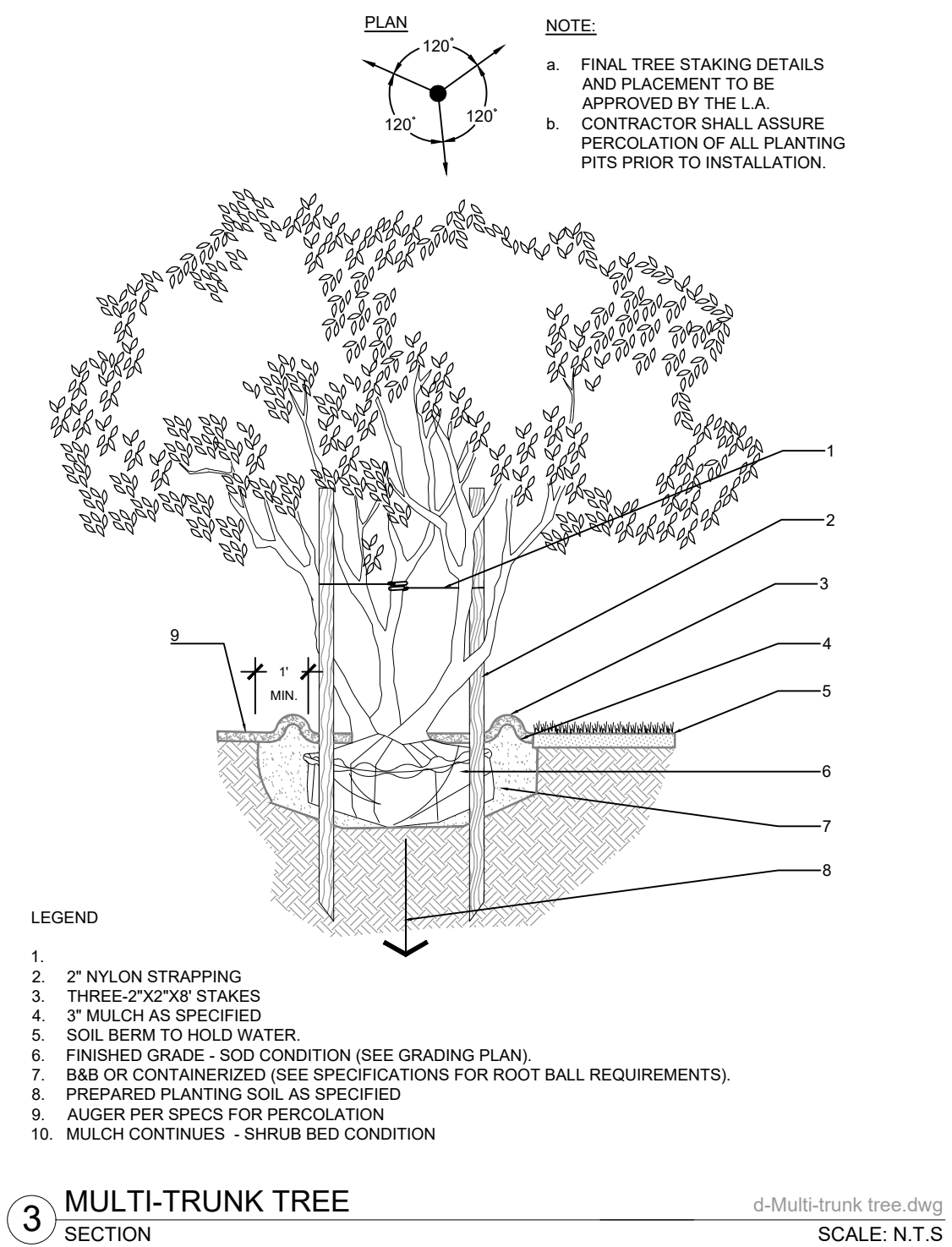
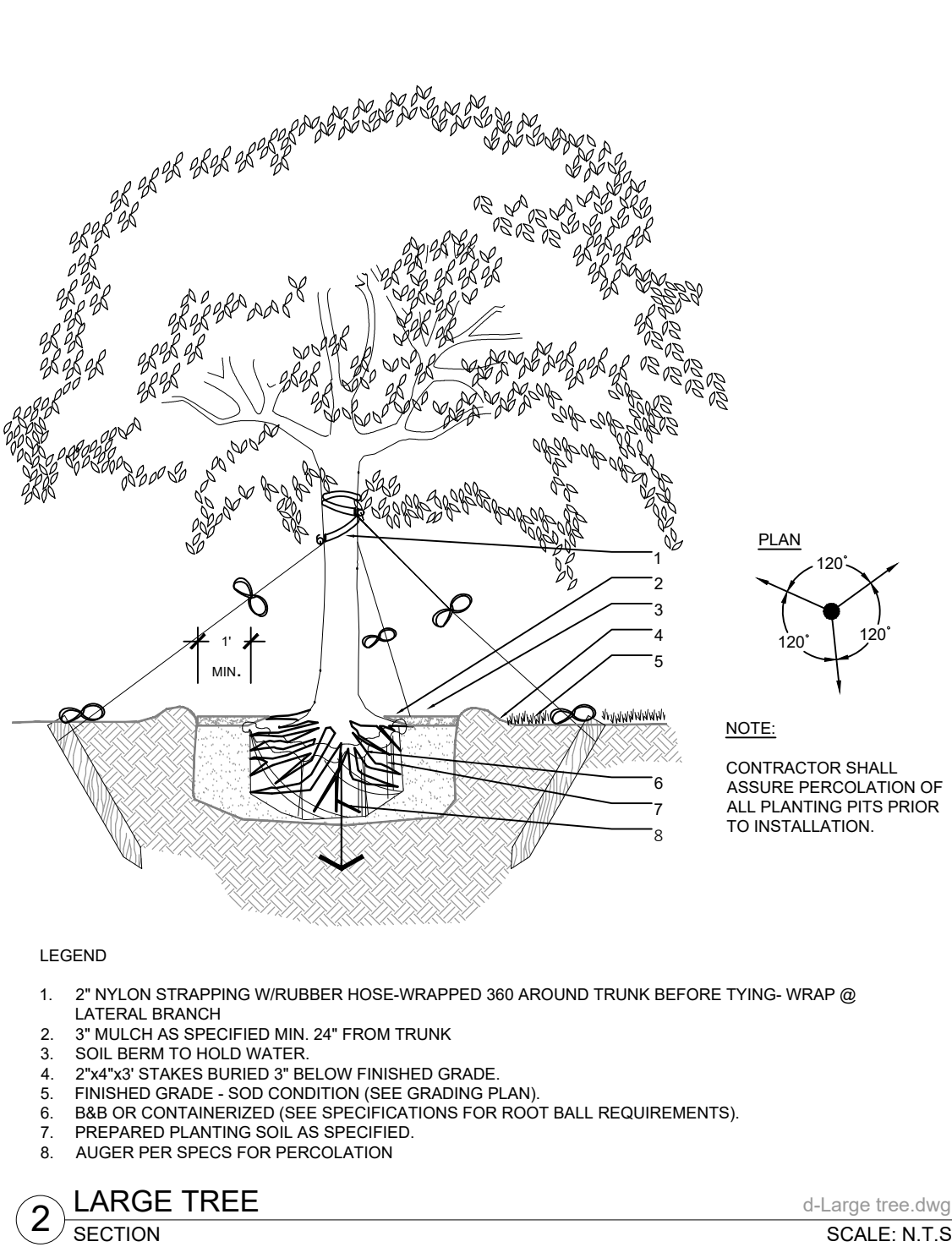

RESERVED FOR CITY USE

ANDSTUDIO
ARCHITECTURE+DESIGN
2420 SW 27TH AVE, SUITE 3
MIAMI, FL 33145
WWW.ANDSTUDIO.DESIGN
FIRM LICENSE #AA26003820

PROJECT LOCATION

424 W DILDO DRIVE | MIAMI BEACH | FL | 33139

PROJECT CLIENT/OWNER:

424 W DILDO DRIVE LLC

ARCHITECT:

DAVID SCHWADE, RA/AIA, LICENSE # AR97772
DAKOTA HENDON, AIA, LICENSE #AR98269

INTERIOR DESIGNER

BEA INTERIORS DESIGN
6301 BISCAYNE BOULEVARD, SUITE 103, MIAMI, FL 33138

LANDSCAPE ARCHITECT:

ANDRES MONTERO
LANDSCAPE ARCHITECTURE
2300 E. OAKLAND PARK BLVD. SUITE 300
Fort Lauderdale, FL 33306

SIGNATURE / DATE / SEAL
ANDRES MONTERO, P.L.A. ASLA

STATE OF FLORIDA
REGISTRATION LA6666973
ALL DESIGNS AND DETAILS ON THIS DRAWING ARE THE PROPERTY OF ANDRES MONTERO LANDSCAPE ARCHITECTURE, LLC, AND SHALL NOT BE USED, COPIED OR REPRODUCED WITHOUT WRITTEN PERMISSION FROM ANDRES MONTERO LANDSCAPE ARCHITECTURE, LLC.

CONFIDENTIALITY NOTICE:

ALL IDEAS, DESIGNS, ARRANGEMENTS AND PLANS INDICATED OR REPRESENTED BY THIS DRAWING ARE OWNED BY AND PROPERTY OF THE ARCHITECT AND WERE CREATED, EVOLVED AND DEVELOPED FOR USE ON AND IN CONNECTION WITH THE SPECIFIC PROJECT. NONE OF SUCH IDEAS, DESIGNS, ARRANGEMENTS OR PLANS SHALL BE USED BY OR DISCLOSED TO ANY PERSON, FIRM OR CORPORATION FOR ANY PURPOSE WHATSOEVER WITHOUT WRITTEN PERMISSION OF THE ARCHITECT.

PROJECT NAME:

WEST DILDO RESIDENCE

DATE: 1/5/2025
DRAWN BY: AEM/MEP

SHEET ISSUE / REVISION LOG

NO	DATE	DESCRIPTION

SHEET TITLE:

**LANDSCAPE DETAILS
& GENERAL NOTES**

SHEET NO:

L-03

Sunshine State
One Call



Know what's below.
Call before you dig.