

DADE BOULEVARD

COLLINS CANAL

ALTON ROAD  
S.R. 907

ALTON COURT

PROPOSED 'DEEPROOT SILVA  
CELLS' INSTALLATION SEE  
'DEEPROOT SILVA CELLS'  
INSTALLATION NOTES AND DETAILS,  
SHEET L-4.

PROP. PIV.  
(SEE MECH. PLANS)  
PROP. PDC  
(SEE MECH. PLANS)

PROPOSED 'DEEPROOT SILVA  
CELLS' INSTALLATION SEE  
'DEEPROOT SILVA CELLS'  
INSTALLATION NOTES AND DETAILS,  
SHEET L-4.

PROPOSED 'DEEPROOT SILVA  
CELLS' INSTALLATION SEE  
'DEEPROOT SILVA CELLS'  
INSTALLATION NOTES AND DETAILS,  
SHEET L-4.

### PLANTLIST

SYM.	NATIVE	*	NAME	BOTANICAL NAME	SPECIFICATION
PROPOSED TREES					
B5	YES	6	GUMBO LIMBO	Bursera emarubia	16' x 1" apr, 4' cal, 6' c.t.
CE	YES	3	GREEN BUTTWOOD	Conocarpus erectus	12' x 6' apr, 2 1/2' cal.

SHRUBS, GROUNDCOVERS AND ACCENT PLANTS					
AEC	15	AECHMEA BROMELIADS	Aechmea blanchetiana 'Orange'	3 gal, 18" x 18", BULL16	
ARA	150 s.f.	PERENNIAL PEANUT	Arachis glabrata 'EcoTurf'	SOLID SOD, price per s.f.	
CAT	1	CAT PALM	Chamaedorea cataractarum	1 gal, 30" x 21", 30" c.c.	
CRO	50	CROTON 'PETRA'	Codiaeum variegatum	3 gal, 18" x 18", 18" o.c., full	
BL3	15	BLUEBERRY PLAX LILY	Dianella laevis	3 gal, 12" x 18", 18" o.c., full	
FG3	85	'GREEN ISLAND' FICUS	Ficus 'Green Island'	3 gal, 18" x 18", 18" o.c., full	

TOPSOIL:			TOPSOIL:SAND MIX	50:50 TOPSOIL:SAND MIX, SPREAD IN PLACE
			12 C.Y.	TREES, PALMS, SHRUBS AND GROUNDCOVERS

MULCHING:			20 C.Y.-	'MINI-NUGGET' PINE BARK	3" DEPTH, SPREAD IN PLACE, ATLAS FEAT AND SOIL
			PROVIDE SAMPLE FOR APPROVAL PRIOR TO INSTALLATION		
			TOPSOIL, SOD AND MULCH QUANTITIES SHOWN ARE APPROXIMATE, CONTRACTOR		
			TO PROVIDE A UNIT PRICE PER UNIT AND WILL BE PAID ON THAT UNIT PRICE BASIS		
			UPON FINAL INSPECTION AND APPROVAL.		

A WRITTEN TREE REMOVAL PERMIT IS REQUIRED  
FROM THE CITY OF MIAMI BEACH PRIOR TO  
REMOVAL OF ANY TREES OR PALMS FROM THIS  
SITE.

SEE SHEET L-2 FOR ROOF LEVEL LANDSCAPE  
PLANTINGS.

SEE SHEET L-3 FOR LANDSCAPE DETAILS,  
NOTES, SPECIFICATIONS, ETC.

SEE SHEET L-4 FOR SILVA CELL DETAILS AND  
SPECIFICATIONS.

City of Miami Beach  
Fire Prevention Division  
PLANS APPROVED

SITE LANDSCAPE PLAN

PERMUY

ARCHITECTURE  
INTERIOR DESIGN  
PLANNING

2717 Ponce de Leon Blvd.  
Coral Gables, FL 33134  
Phone : 305.200.5302  
www.PermuyArchitecture.com

JFS JFS Design Inc.  
LANDSCAPE ARCHITECTURE  
LC 000363  
www.jfsdesigninc.com  
TEL: 781-414-1414 JFS  
TEL: 781-414-1414 JFS

STATE OF FLORIDA  
JESU MILAN ARCHITECT  
REGISTRATION BAR0004553

THESE DESIGNS AND DRAWINGS ARE  
THE COPYRIGHTED PROPERTY OF  
PERMUY ARCHITECTURE, INTERIOR  
DESIGN AND PLANNING, INC. AND MAY  
NOT BE REPRODUCED EXCEPT WITH  
SPECIFICATION WRITTEN CONSENT OF  
THE ARCHITECT. THE CONTRACTOR  
MUST CHECK AND VERIFY ALL  
DIMENSIONS OF THE JOB AND BE  
RESPONSIBLE FOR SAME. REPORTING  
ANY DISCREPANCIES TO THE ARCHITECT  
BEFORE COMMENCING WORK.  
DRAWINGS ARE NOT TO BE SCALED

KIMPTON HOTEL  
PALOMAR  
SOUTH BEACH  
1750 Alton Road, Miami Beach, FL 33139

FINVARB GROUP

1055 Kane Concourse, Suite 201, Bay Harbor Island, FL 33154

No.	DESCRIPTION	DATE
1	DERM CMNTS	04.13.17
2	REV. 2	05.31.17
3	REV. 3	12.18.17

PROJECT NO.  
1613

DATE:  
2-17-17

SHEET INDEX:

SCALE:

SHEET NO.

L-1



# ALTON COURT

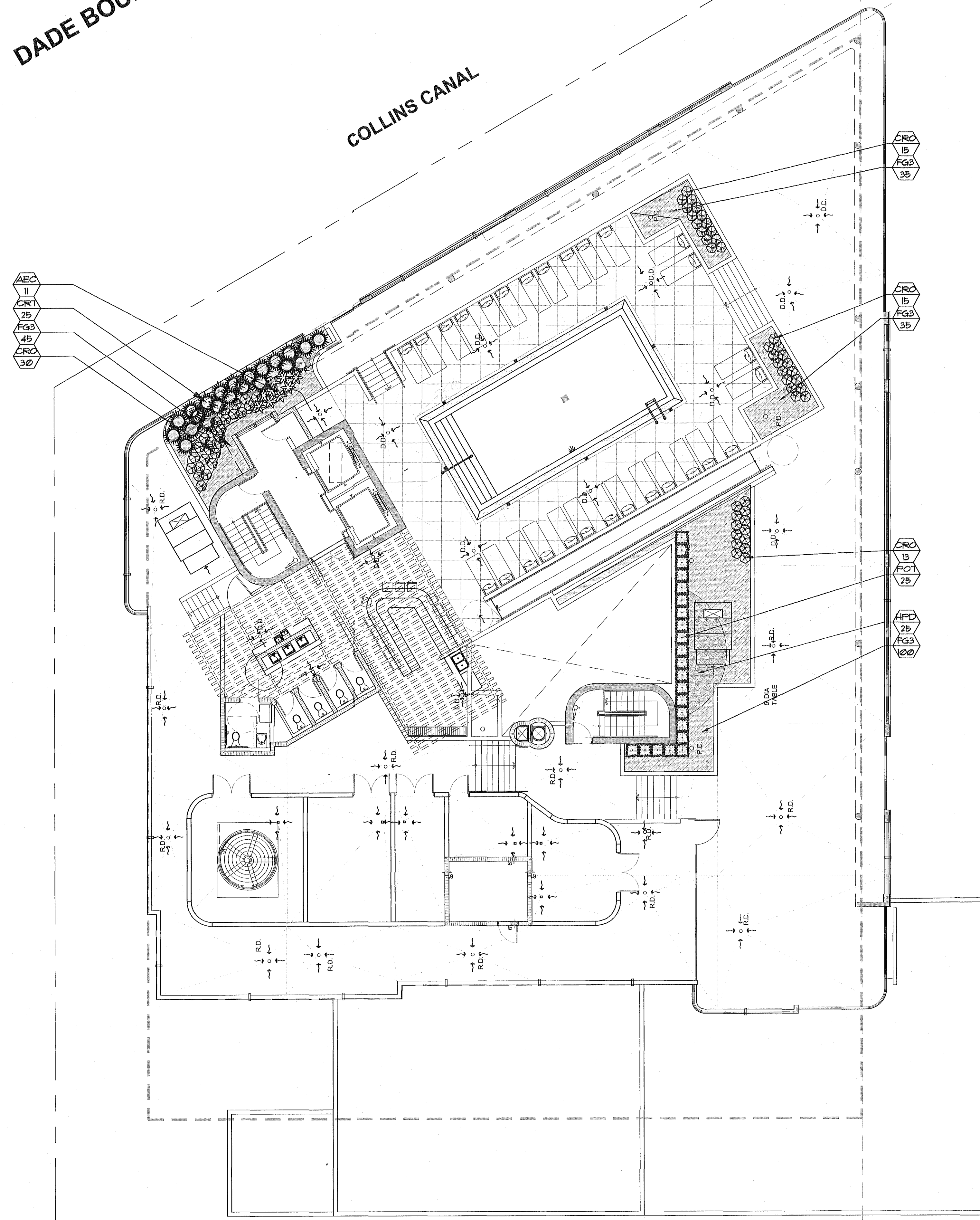

# ALTON ROAD

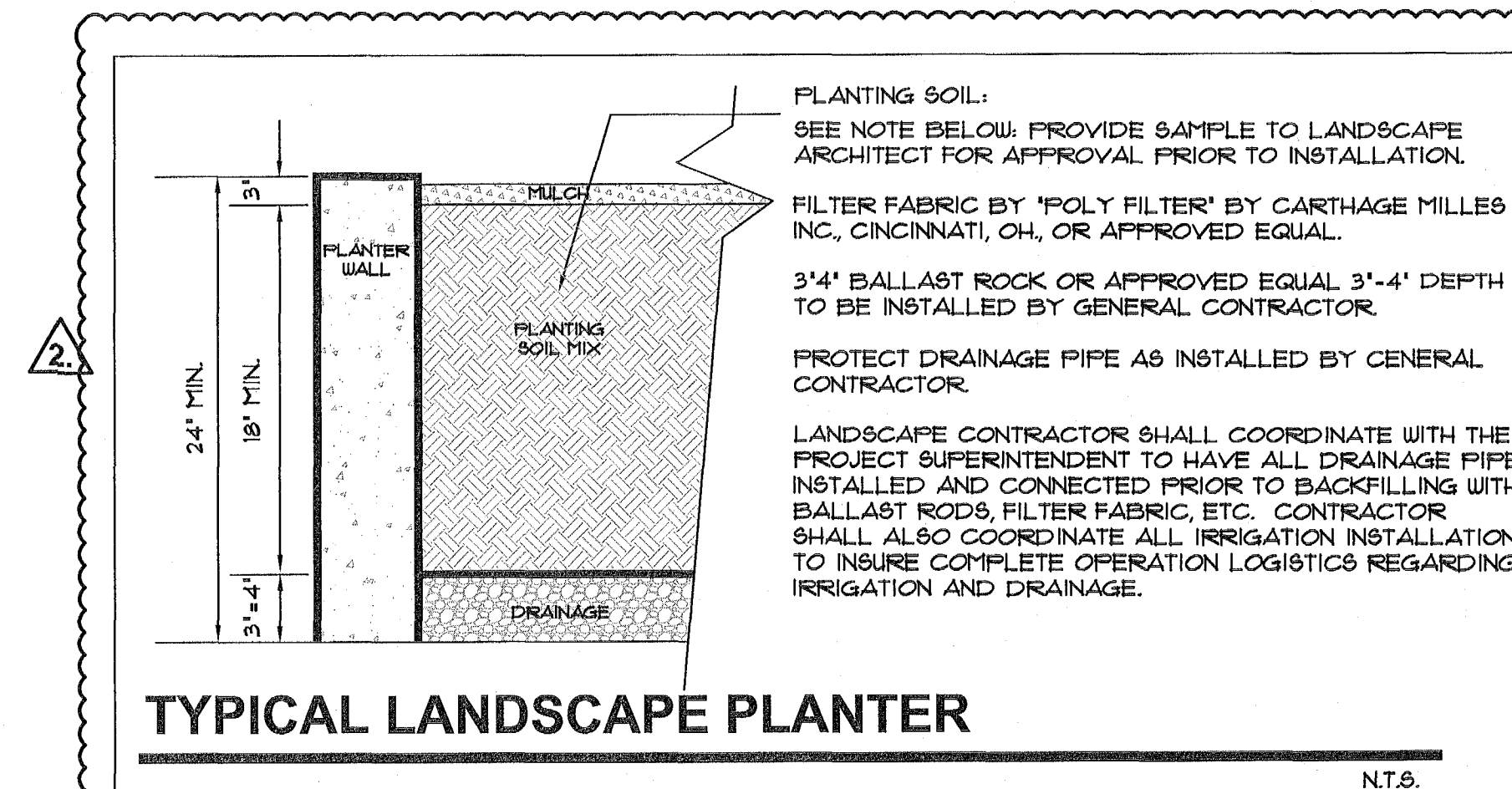

## TYPICAL LANDSCAPE PLANTER

THE LANDSCAPE CONTRACTOR SHALL PROVIDE THE PLANTERS WITH AN APPROVED SOIL MIX.

CONTRACTOR SHALL SUBMIT TO THE LANDSCAPE ARCHITECT A SOIL SAMPLE AND A SOIL MATERIAL RATIO CHART FOR APPROVAL PRIOR TO INSTALLATION OF THE SOIL. SOIL MIX SHALL BE A SPECIAL MIX TO PROVIDE, POROSITY FOR DRAINAGE, AND CONTAIN AMENDMENTS ( PERLITE ORS SIMILAR) TO REDUCE SOIL DENSITY AND WEIGHT. SOIL MIX SHALL BE AS PER ATLAS PEAT AND SOIL OR TOM WATERS INC. SOIL MIX OR AN APPROVED EQUAL TO CONTAIN EQUAL OR FORMULATED RATIOS OF THE FOLLOWING:

1. SILICA
2. SOIL
3. COMPOST
4. PERLITE
5. FLAVINGS

THE CONTRACTOR SHALL BE RESPONSIBLE TO FILL THE PLANTING MIX TO A DEPTH WHICH WILL BE 4" FROM THE TOP OF THE PLANTING WALL. SOIL & BALLAST ROCK QUANTITIES ARE APPROX. & WILL BE THE RESPONSIBILITY OF THE CONTRACTOR FOR FINAL GRADE AS PER THIS NOTE.

WALL IMPERMEABILIZATION, DRAINS AND EYE  
HOOKS SHALL BE PREPARED & INSTALLED BY  
THE GENERAL CONTRACTOR.

THE LANDSCAPE AND IRRIGATION CONTRACTORS SHALL COORDINATE ALL WORK WITH THE PROJECT MANAGER AND ALL PERTINENT SUBCONTRACTORS TO INSURE A PROFESSIONAL EXPEDITIOUS PROCESS.

ALL PLANTING BEDS SHALL BE MULCHED WITH AN APPROVED RECYCLED MULCH, OR AN APPROVED EQUAL. SEE "LANDSCAPE NOTES".

THE CONTRACTOR SHALL SUBMIT PHOTOS FOR ALL SPECIMEN PLANT MATERIAL (ALL PALMS AND TREES) TO THE L.A. FOR APPROVAL PRIOR TO PLANTING.

## PLANTLIST

SYM. NATIVE	NAME	BOTANICAL NAME	SPECIFICATION
-------------	------	----------------	---------------

### PROPOSED TREES

## PALMS

## SHRUBS, GROUNDCOVERS AND ACCENT PLANTS

AEC	II	AECHMEA BROMELIADs	<i>Aechmea blanchetiana</i> 'Orange'	3 gal, 18" x 18", BULLIS
CRT	YES	2B SMALL-LEAVED CLUSIA	<i>Clusia guttifera</i>	1 GAL., 36" H., 30" OC., FTE
CRO	"	13 CROTON 'PETRA'	<i>Codiaeum variegatum</i>	3 gal, 18" x 18", 18" oc., full
FG3	21B	"GREEN ISLAND" FICUS	<i>Ficus 'Green Island'</i>	3 gal, 18" x 18", 18" oc., full
HFD	YES	2B DWARF FIREBUSH	<i>Hamelia nodosa</i>	3 gal, 18" x 18", 18" oc.
P01		2B FODOCARPUS HEDGE	<i>Fodocarpus</i> spp.	1 gal, 30" x 24", full heavy

**TOPSOIL:**

71 C.Y. 2'100 MIX' FOR PLANTING-PER ATLAS PEAT AND SOIL FOR PLANTER BOXES  
BASED UPON A 2' DEPTH-CONTRACTOR SHALL VERIFY DEPTH PRIOR TO PLANTING.  
952 S.F. X 2' (depth) = 1,904/27 = 71 C.Y.

## MULCHING

9 C.Y./-	PINE BARK NUGGETS	3' DEPTH, SPREAD IN PLACE, ATLAS FEET AND SOIL PROVIDE SAMPLE FOR APPROVAL PRIOR TO INSTALLATION
---	TOPSOIL, SOD AND MULCH QUANTITIES SHOWN ARE APPROXIMATE, CONTRACTOR TO PROVIDE A UNIT PRICE PER UNIT AND WILL BE PAID ON THAT UNIT PRICE BASIS UPON FINAL INSPECTION AND APPROVAL.	

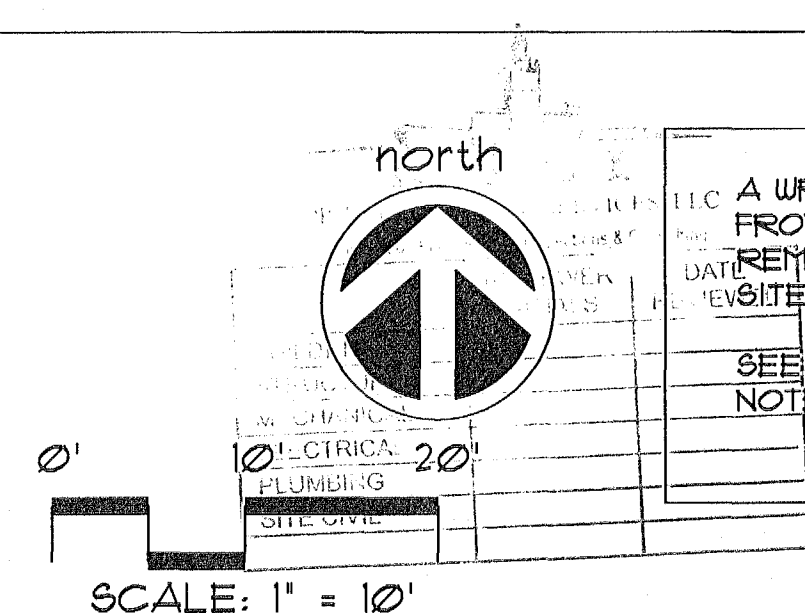

## ROOF LEVEL LANDSCAPE PLAN













PALOMAR-ALTON ROAD-17th STREET HOTEL LANDSCAPE FIXTURE SCHEDULE						
Type	Manufacturer	Model#	Lamp	Voltage	Accessories	Notes
1	LED BOLLARD	ACUITY	DSXB LED 12C 530 40K ASY MMOLT TBD	22W LED 4000K	MMOLT	FINISH TBD
2	ACCENT UP LIGHT	HYDREL	ASPEN A M50 12 NR WSL 350R STK C1 TBD	50W MR16	120	TRANSFORMER REQ. FINISH TBD
	contact					

JARRED FOX, LEED GREEN ASSOCIATE  
POWER AND LIGHTING SYSTEMS, INC.  
3832 SHIPPING AVE.  
MIAMI, FL. 33145  
  
TEL: 305 444-8520  
jfox@jp-ls.com

MECHANICAL

ELECTRICAL

PLUMBING

SITE CIVIL

08/06/2010

3A



