



CAPE JUPITER, LLC

208 BARBADOS DRIVE  
JUPITER, FLORIDA 33458  
PHONE: (561) 329-1514  
EMAIL: CAPELLC@OUTLOOK.COM  
CERTIFICATE OF AUTHORIZATION: 30993

CLAUDINE ALEXANDER, PROFESSIONAL ENGINEER,  
STATE OF FLORIDA, LICENSE NO. 53822

THIS PLAN SHEET HAS BEEN DIGITALLY SIGNED AND SEALED BY:  
CLAUDINE ALEXANDER, P.E. ON 06-28-2024.

PRINTED COPIES OF THIS DOCUMENT ARE NOT CONSIDERED  
SIGNED AND SEALED AND THE SIGNATURE MUST BE VERIFIED  
ON ANY ELECTRONIC COPIES.



10805 GLENEAGLES ROAD BOYNTON BEACH, FLORIDA, 33436  
561.736.6642 pattontnt@earthlink.net

Digitally signed by  
Claudine R  
Alexander  
Date: 2024.06.28  
19:16:42 -04'00'

RENDERING: NORTHWEST VIEW  
PICKLEBALL IMPROVEMENTS  
CITY OF MIAMI BEACH FLAMINGO PARK  
1245 MERIDIAN AVENUE, MIAMI BEACH, FLORIDA





BENCH:  
MANUFACTURED BY DUMOR, INC.  
DUMOR MODEL NO.447-60APLG-3AR-6" CAST ALUMINUM BENCH,  
(3) ARMS, GREY RECYCLED PLASTIC SLATS  
INSTALL PER MANUFACTURER'S INSTRUCTIONS.  
CONTACT REP SERVICES (407) 831-9658

NOTE:  
ALL HARDWARE SUPPLIED BY CONTRACTOR SHALL BE STAINLESS  
STEEL. ANCHOR BOLTS SHALL BE STUD TYPE EXPANSION ANCHOR  
MIN. 3/4"x3 3/8". EXACT LOCATION TO BE DETERMINED IN FIELD.  
ALL ALUMINUM TO BE COATED WITH ZINC RICH EPOXY THEN  
FINISHED WITH POLYESTER POWDER COATING. COLOR TO MATCH  
MIAMI BEACH BLUE.  
CONTRACTOR SHALL SALVAGE EXISTING CITY BENCHES AND  
PROVIDE TO CITY FOR FUTURE USE.

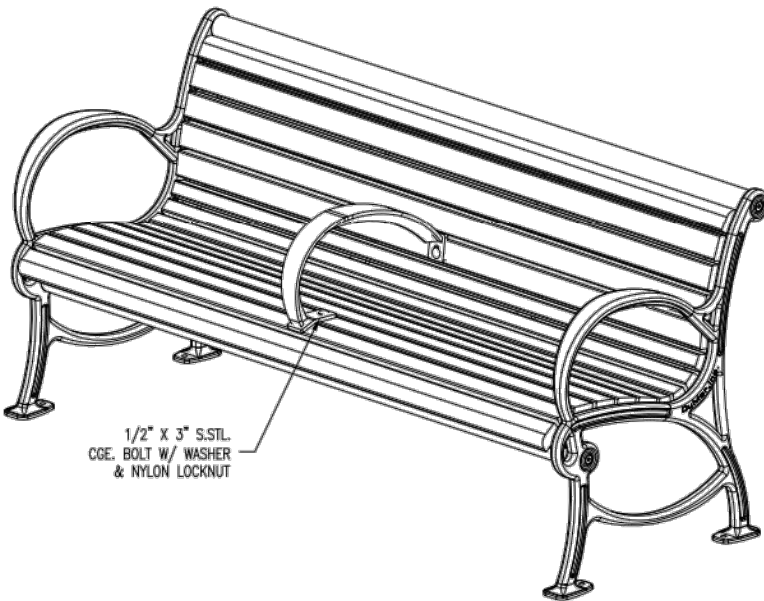
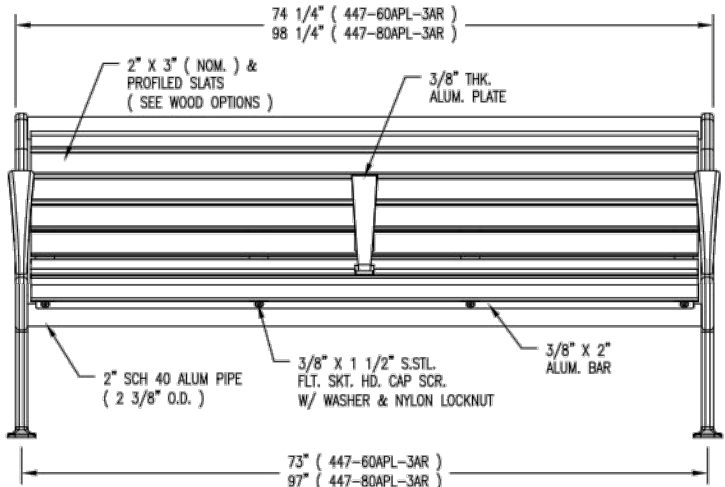
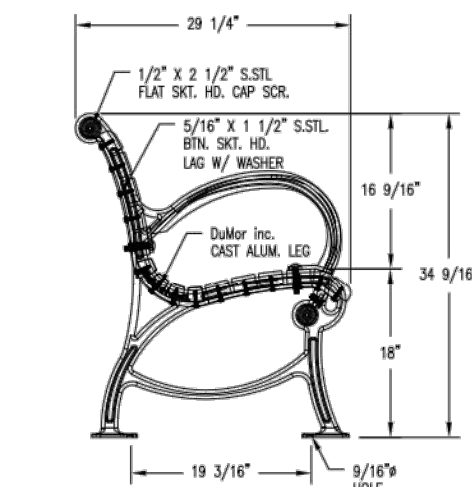

- LENGTH OPTIONS  
☒ 6" BENCH  
☐ 8" BENCH
- SLAT OPTIONS  
☐ "CEDAR" RECYCLED PLASTIC  
☒ "GREY" RECYCLED PLASTIC  
☐ "REDWOOD" RECYCLED PLASTIC  
☐ "WALNUT" RECYCLED PLASTIC  
☐ OTHER \_\_\_\_\_
- NOTES  
1.) ALL ALUM. MEMBERS COATED W/ ZINC RICH EPOXY THEN  
FINISHED W/ POLYESTER POWDER COATING.  
2.) 1/2" X 3 3/4" EXPANSION ANCHOR BOLTS PROVIDED.

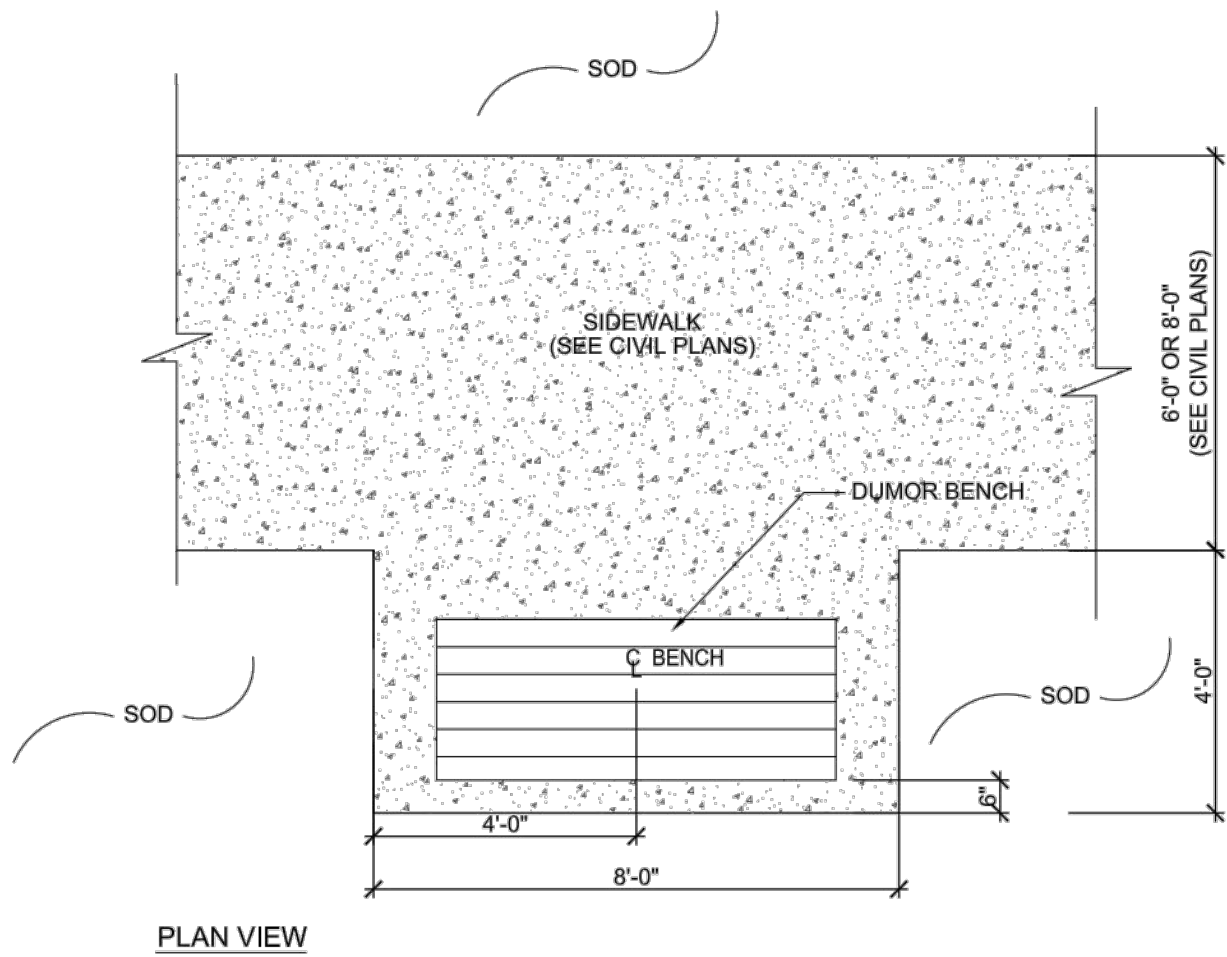

A BENCH  
L2.3 (22 TOTAL)

Not to Scale

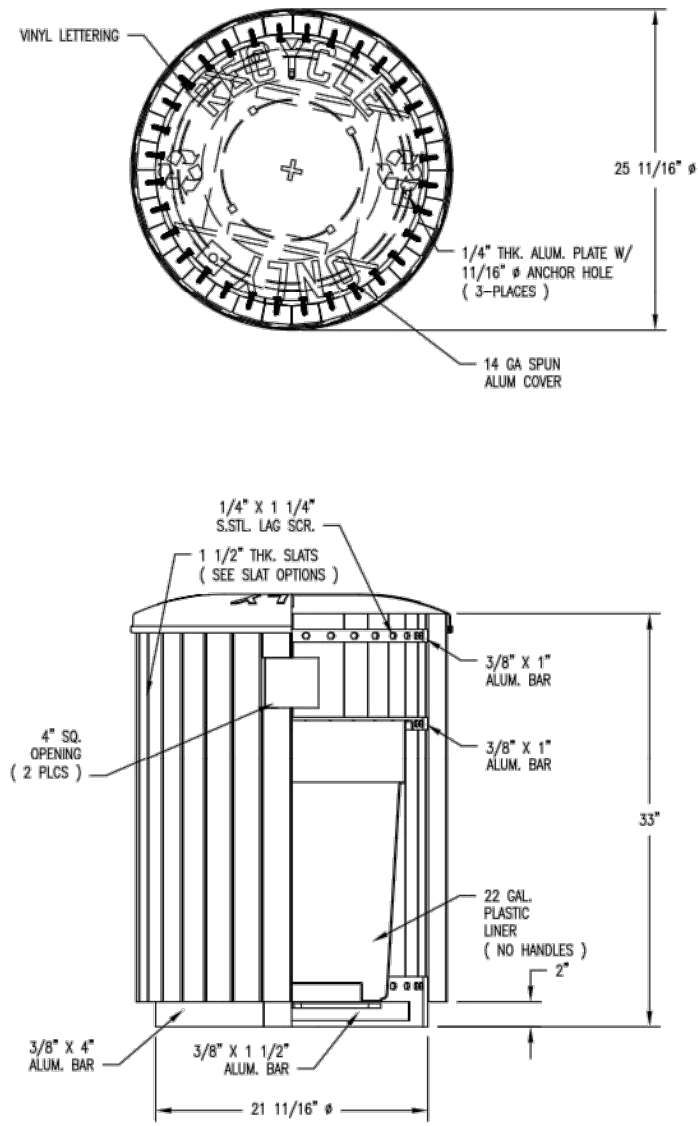

RECYCLE TRASH RECEPTACLE (5 Total)

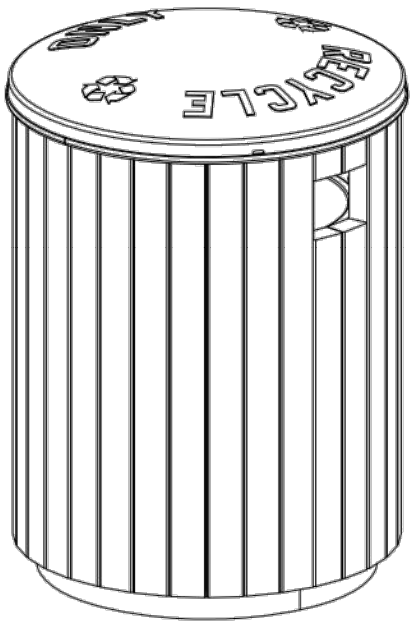

- SLAT OPTIONS  
☐ "CEDAR" RECYCLED PLASTIC  
☒ "GREY" RECYCLED PLASTIC  
☐ "REDWOOD" RECYCLED PLASTIC  
☐ "WALNUT" RECYCLED PLASTIC  
☐ OTHER \_\_\_\_\_
- NOTES  
1.) ALL ALUM. MEMBERS COATED W/ ZINC RICH EPOXY  
THEN FINISHED W/ POLYESTER POWDER COATING.  
2.) 1/2" X 3 3/4" EXPANSION ANCHOR BOLTS PROVIDED.

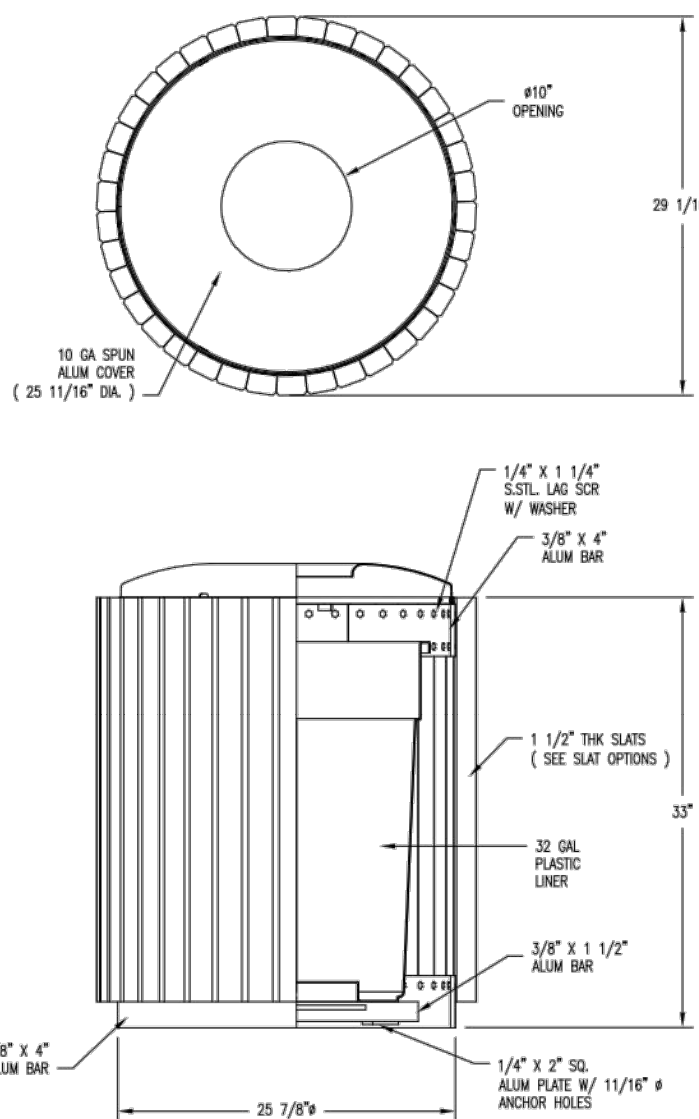

TRASH RECEPTACLE (5 Total)

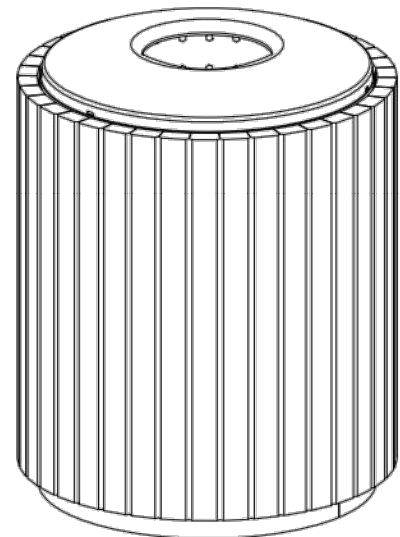

- SLAT OPTIONS  
☐ "CEDAR" RECYCLED PLASTIC  
☒ "GREY" RECYCLED PLASTIC  
☐ "REDWOOD" RECYCLED PLASTIC  
☐ "WALNUT" RECYCLED PLASTIC  
☐ OTHER \_\_\_\_\_
- NOTES  
1.) ALL ALUM. MEMBERS COATED W/ ZINC RICH EPOXY THEN FINISHED  
W/ POLYESTER POWDER COATING.  
2.) 1/2" X 3 3/4" EXPANSION ANCHOR BOLTS PROVIDED



TRASH RECEPTACLES:  
MANUFACTURED BY DUMOR, INC.  
RECYCLE- DUMOR MODEL NO. 69-365-22PL WITH CVR-30A-RC-0165  
22 GAL. ALUMINUM RECEPTACLE WITH GREY RECYCLED PLASTIC WITH  
WITH 25 3/8" DIAMETER FLAT COVER.  
REGULAR: DUMOR MODEL NO. 70-32APL WITH CVR-30A-FTD  
32 GAL. ALUMINUM RECEPTACLE WITH GREY RECYCLED PLASTIC WITH  
LARGE SPUN ALUMINUM COVER WITH OPENING AND CABLE  
INSTALL PER MANUFACTURER'S INSTRUCTIONS.  
CONTACT REP SERVICES (407) 831-9658  
NOTE:  
ALL HARDWARE SUPPLIED BY CONTRACTOR SHALL BE STAINLESS STEEL.  
ANCHOR BOLTS SHALL BE STUD TYPE EXPANSION ANCHOR MIN. 3/4"x3 3/8".  
EXACT LOCATION TO BE DETERMINED IN FIELD.  
ALL ALUMINUM TO BE COATED WITH ZINC RICH EPOXY THEN FINISHED  
WITH POLYESTER POWDER COATING. COLOR TO MATCH MIAMI BEACH  
BLUE.  
EXACT LOCATIONS TO BE DETERMINED IN FIELD BY CITY.

B TRASH RECEPTACLES

Not to Scale



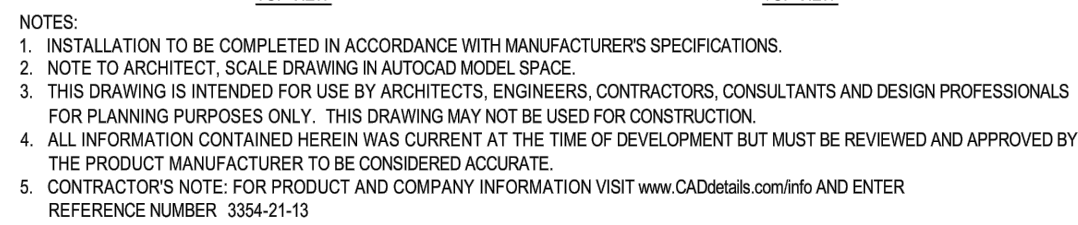

SHOWN W/ REMOTE CHILLER, SHOWN W/ OPTIONAL TEMPLATE

3354-21-13 CADDetailsPLUS™ REVISION DATE 22/08/2017  
PROTECTED BY COPYRIGHT © 2017 CADDDETAILS.COM LTD. CADDetails.com

NOTES:

1. USE 1-1/2" SCHEDULE 40, SATIN #4 POLISH, STAINLESS STEEL PIPE 316 GRADE.
2. USE 1/2"-13 x 1" STAINLESS STEEL FLAT HEAD SOCKET CAP SCREW WITH 1/2" HDI, CARBON STEEL, HILTI ANCHOR DROP-IN (PART #336427) OR EQUAL TO SECURE BIKE RACK TO MOUNTING SURFACE.
3. WHEN USING MORE THAN ONE LOOP, SEPARATION BETWEEN EACH LOOP SHALL BE A MINIMUM OF 30" CENTER TO CENTER.

**MIAMI BEACH**  
**PUBLIC WORKS DEPARTMENT**  
1709 CONVENTION CENTER DRIVE, MIAMI BEACH, FL 33139

APPROVED	REVISED 07/2020 08/2020	BICYCLE RACK	DETAIL 10-4
----------	-------------------------------	--------------	----------------



## DETAILS: ACCESSORIES AND LIGHTING

DETAILS: ACCESSORIES AND LIGHTING

PICKLEBALL IMPROVEMENTS  
CITY OF MIAMI BEACH FLAMINGO PARK  
1245 MERIDIAN AVENUE, MIAMI BEACH, FLORIDA

DATE	JUNE 2024
DWG	SD 6

SD-6

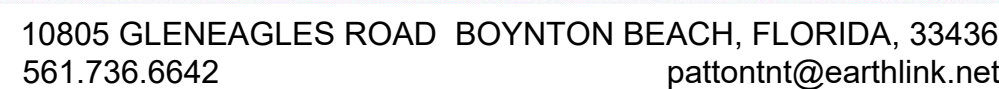



Luminaire and Driver – TLC-LED-550

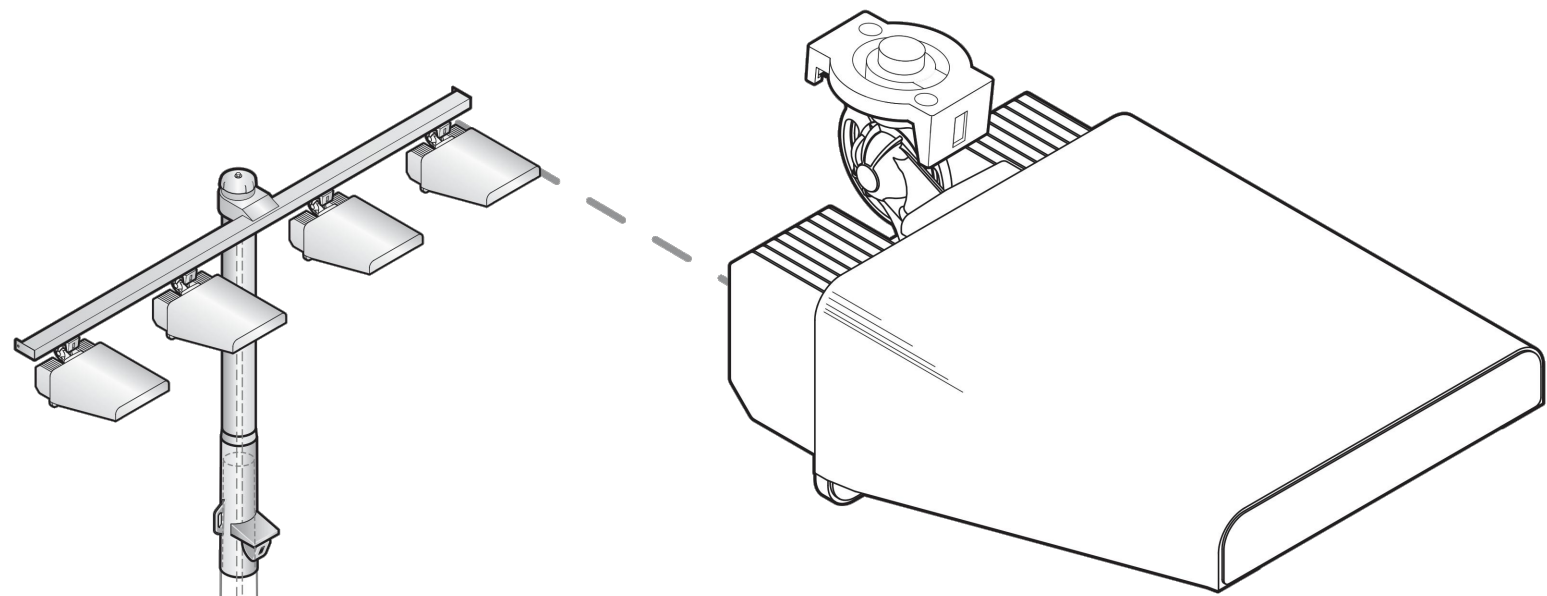

Luminaire Data

Weight (luminaire)	25 lb (11 kg)
UL listing number	E338094
UL listed for USA/Canada	UL1598 CSA-C22.2 No.250.0
CE Declaration	LVD, EMC, RoHS
Ingress protection (luminaire)	IP65
Impact rating	IK07
Material and finish	Aluminum, powder-coat painted
Wind speed rating (aiming only)	150 mi/h (67 m/s)
UL, IEC ambient temperature rating (luminaire)	50°C (122°F)

Photometric Characteristics

Projected lumen maintenance per IES TM-21-11	
L90 (20k)	>120,000 h
L80 (20k)	>120,000 h
L70 (20k)	>120,000 h
Lumens¹	67,000
CIE correlated color temperature	5700 K
Color rendering index (CRI)	75 typ, 70 min
LED binning tolerance	7-step MacAdam Ellipse

Footnotes:

1) Incorporates appropriate dirt depreciation factor for life of luminaire.

All components from foundation to poletop are designed to work together in Light-Structure System™ to ensure reliable, trouble-free operation.

Luminaire and Driver – TLC-LED-550

Driver Data

Electrical Data

Rated wattage¹	
Per driver	1080 W
Per luminaire	540 W
Number of luminaires per driver	2
Starting (inrush) current	<40 A, 256 µs
Fuse rating	15 A
UL, IEC ambient temperature rating, electrical components enclosure	50°C (122°F)
Ingress protection, electrical components enclosure	IP54
Efficiency	95%
Dimming mode	optional
Range, energy consumption	15 - 100%
Range, light output	20 - 100%
Flicker	<2%
Total harmonic distortion (THD) at full output	<20%

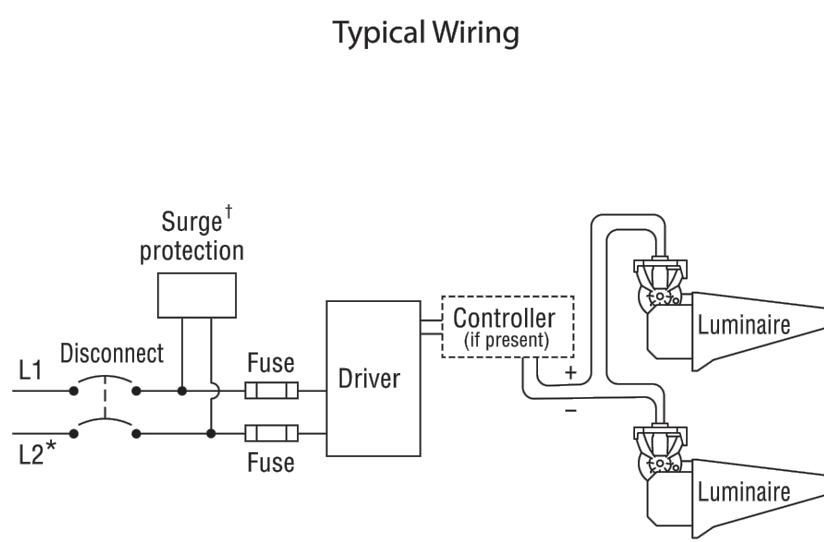

\* If L2 is neutral then not switched or fused.  
† Not present if indoor installation.

	200 Vac 50/60 Hz	208 Vac 60 Hz	220 Vac 50/60 Hz	230 Vac 50 Hz	240 Vac 50/60 Hz	277 Vac 60 Hz	347 Vac 60 Hz	380 Vac 50/60 Hz	400 Vac 50 Hz	415 Vac 50 Hz	480 Vac 60 Hz
Max operating current per luminaire²	3.32 A	3.19 A	3.02 A	2.89 A	2.77 A	2.40 A	1.92 A	1.75 A	1.66 A	1.60 A	1.39 A

Footnotes:

- 1) Rated wattage is the power consumption, including driver efficiency losses, at stabilized operation in 25°C ambient temperature environment.  
2) Operating current includes allowance for 0.90 minimum power factor, operating temperature, and LED light source manufacturing tolerances.

Notes

1. Use thermal magnetic HID-rated or D-curve circuit breakers.  
2. See *Musco Control System Summary* for circuit information.

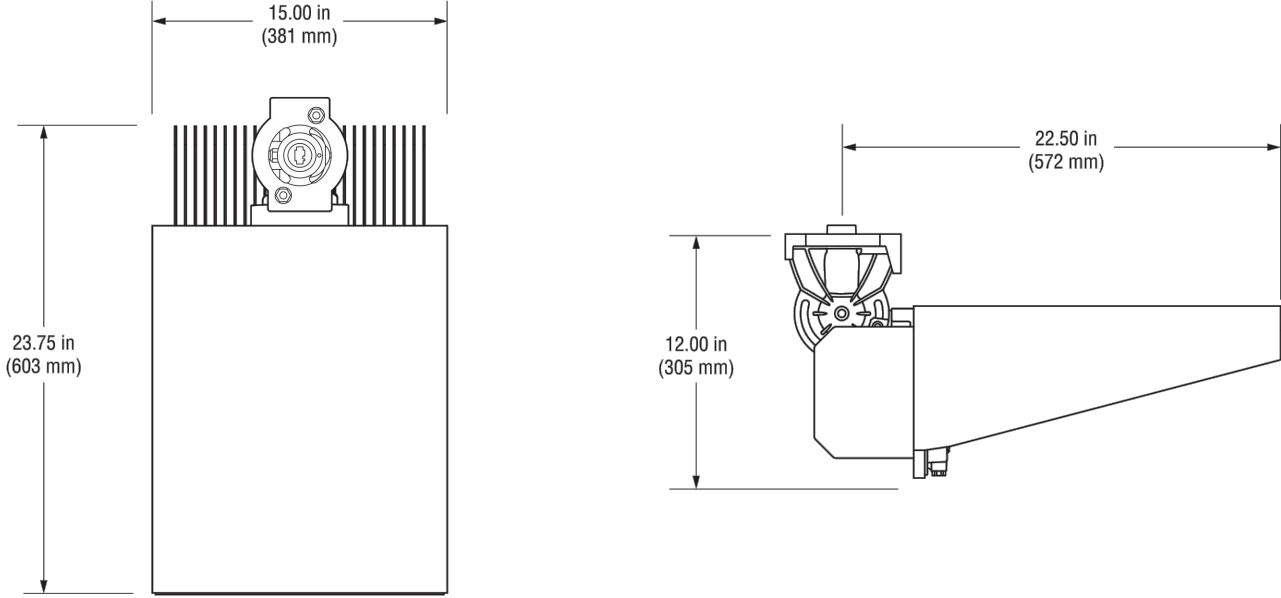

Light-Structure System™ MIAMI BEACH

5 Easy Pieces™

Complete System from Foundation to Poletop



TLC for LED  
Total Light Control™

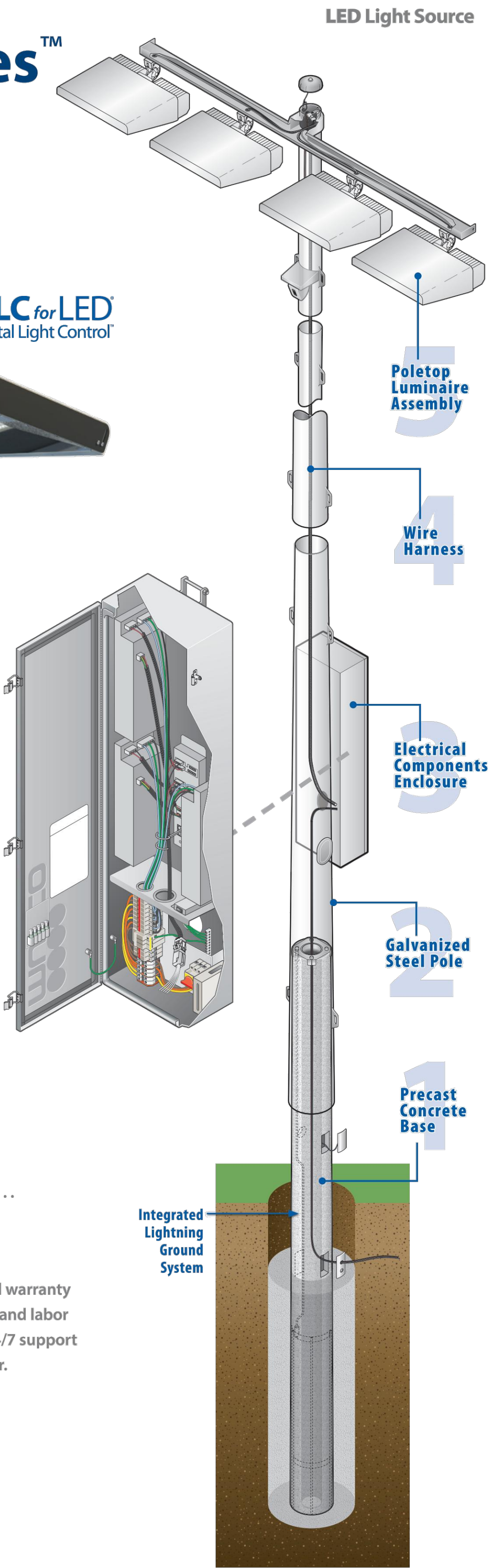

All components designed to work together . . .  
factory built, wired, aimed, and tested  
to assure reliable, trouble-free operation

Covered by a 25-year product assurance and warranty  
program with guaranteed light levels, parts and labor  
for maintenance, system monitoring, and 24/7 support  
from our Control-Link Central™ service center.

For your  
**BUDGET,**  
for the  
**ENVIRONMENT.**

DETAILS: ACCESSORIES AND LIGHTING  
PICKLEBALL IMPROVEMENTS  
CITY OF MIAMI BEACH FLAMINGO PARK  
1245 MERIDIAN AVENUE, MIAMI BEACH, FLORIDA



10805 GLENEAGLES ROAD BOYNTON BEACH, FLORIDA, 33436  
561.736.6642 pattonnt@earthlink.net







